

PROJECT REFERENCE NO.	SHEET NO.
B-4863	1C-3
Location and Surveys	
NEW BERN LOCATION & SURVEYS	

SURVEY CONTROL SHEET B-4863

W/ EXISTING CENTERLINE ALIGNMENTS PRIOR TO CONSTRUCTION

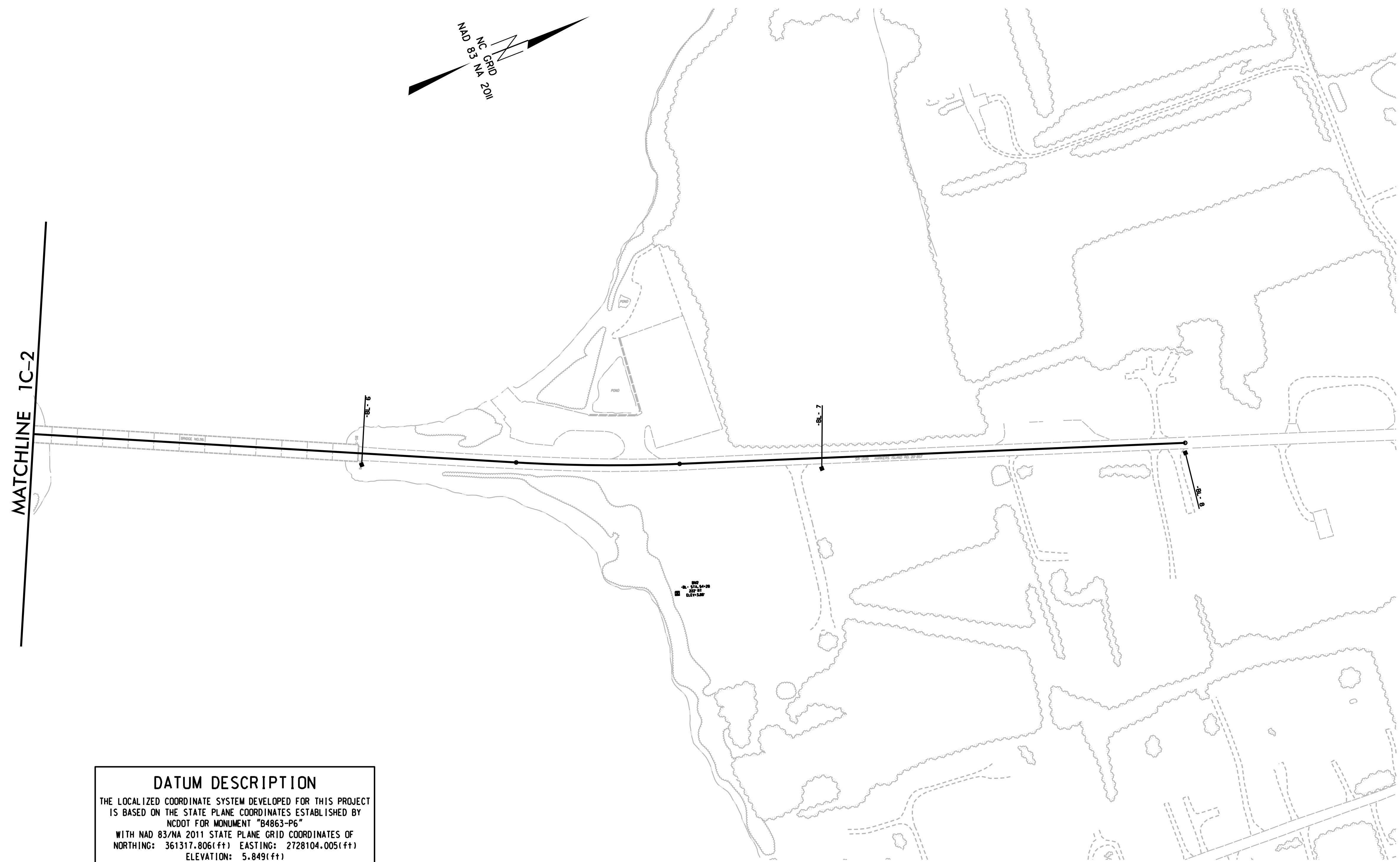
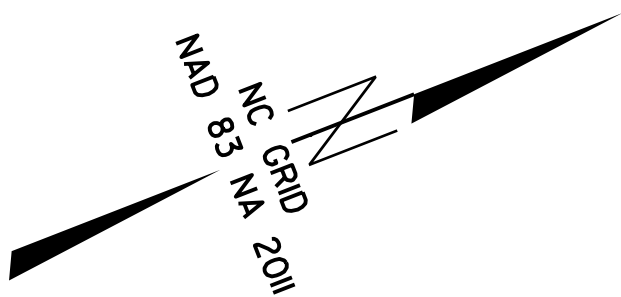

DATUM DESCRIPTION

THE LOCALIZED COORDINATE SYSTEM DEVELOPED FOR THIS PROJECT IS BASED ON THE STATE PLANE COORDINATES ESTABLISHED BY NCDOT FOR MONUMENT "B4863-P6"

WITH NAD 83/NA 2011 STATE PLANE GRID COORDINATES OF
 NORTHING: 361317.8061(ft) EASTING: 2728104.0051(ft)
 ELEVATION: 5.8491(ft)

THE AVERAGE COMBINED GRID FACTOR USED ON THIS PROJECT (GROUND TO GRID) IS: 0.99992130

THE N.C. LAMBERT GRID BEARING AND LOCALIZED HORIZONTAL GROUND DISTANCE FROM "B4863-P6" TO -L- STATION 10+00.00 IS
 S16°44'15"W 2598.00 (ft)

ALL LINEAR DIMENSIONS ARE LOCALIZED HORIZONTAL DISTANCES
 VERTICAL DATUM USED IS NAVD 88

- NOTES:**
- PROJECT CONTROL WAS ESTABLISHED USING GNSS, THE GLOBAL NAVIGATION SATELLITE SYSTEM.
 - THE SURVEY CONTROL DATA FOR THIS PROJECT HAS BEEN COMPILED FROM VARIOUS SOURCES. IF FURTHER INFORMATION REGARDING PROJECT CONTROL IS NEEDED, PLEASE CONTACT THE LOCATION AND SURVEYS UNIT.

REVISIONS

13-DEC-2018 07:29
 N:\BRIDGE\085\B4863\Control_Sheets\B4863-LS-1C-3.dgn
 mchodes AT LS02-299767