

PROJECT REFERENCE NO. 1-5986B	SHEET NO. 45
RW SHEET NO.	
ROADWAY DESIGN ENGINEER SEAL 027373 SUNAN C LANCASTER	HYDRAULICS ENGINEER SEAL 26971 JOSHUA G. DARTON
6/28/2021	6/28/2021
DOCUMENT NOT CONSIDERED FINAL UNLESS ALL SIGNATURES COMPLETED	
Michael Baker Engineering, Inc. 1000 Prosperity Place Suite 800 Raleigh, NC 27618 Tel: 919.876.1000 Fax: 919.876.1001 www.michaelbaker.com	SUNGATE DESIGN GROUP, P.A. 1088ADBC14904C3 1088ADBC14904C3 6/28/2021

-Y19RPCA-

Pls Sta 11+08.02 Os = 3° 05' 38.3" Ls = 162.00' LT = 108.02' ST = 54.02'	Pls Sta 14+19.77 Δ = 19° 30' 05.2" (RT) D = 3° 49' 11.0" L = 510.55' T = 257.77' R = 1,500.00' SE = 0.06 RUNOFF = 162'	Pls Sta 17+26.56 Os = 3° 05' 38.3" Ls = 162.00' LT = 108.02' ST = 54.02'
--	---	--

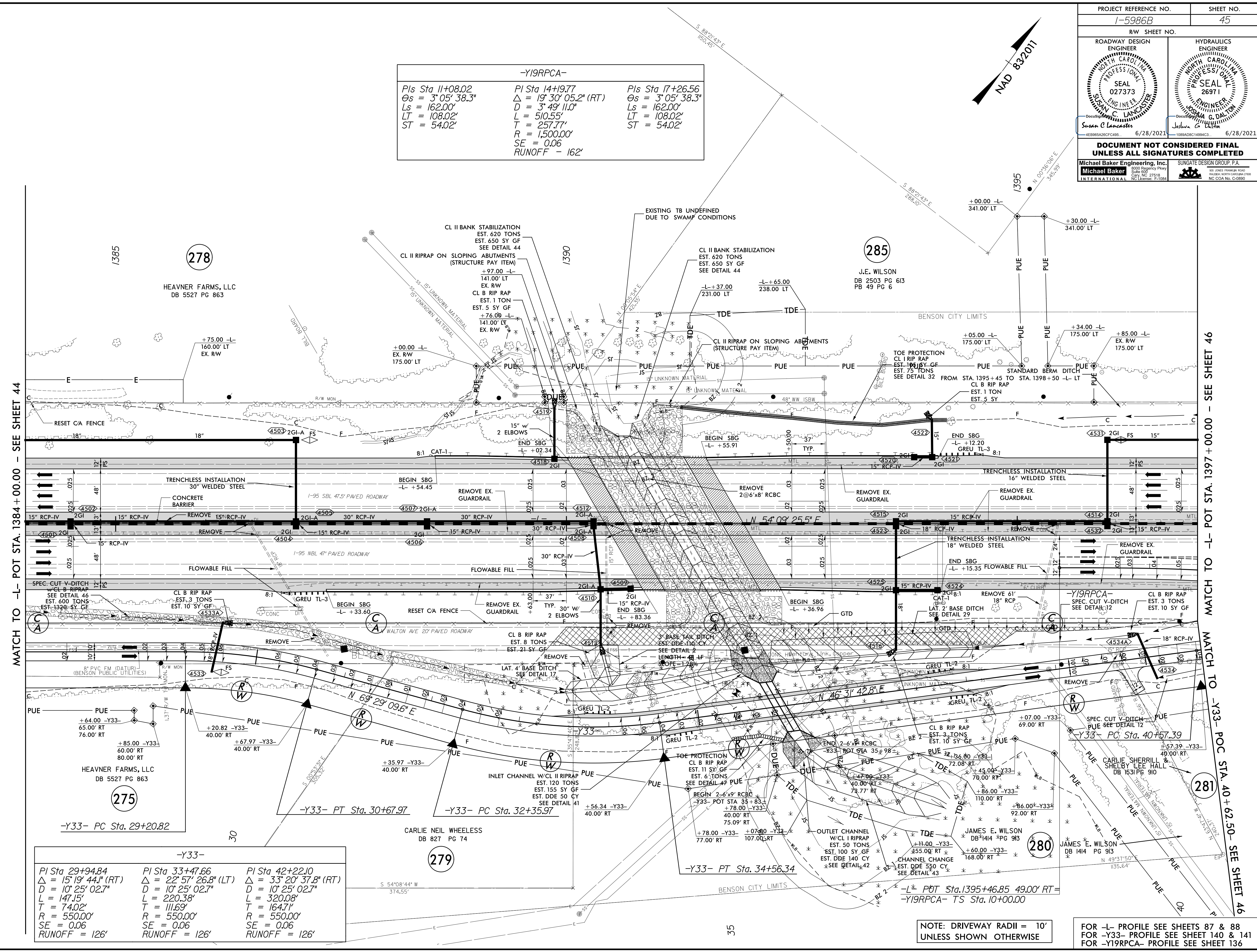

-Y33-

PI Sta 29+94.84 Δ = 15° 19' 44.1" (RT) D = 10° 25' 02.7" L = 147.15' T = 74.02' R = 550.00' SE = 0.06 RUNOFF = 126'	PI Sta 33+47.66 Δ = 22° 57' 26.8" (LT) D = 10° 25' 02.7" L = 220.38' T = 111.69' R = 550.00' SE = 0.06 RUNOFF = 126'	PI Sta 42+22.10 Δ = 33° 20' 37.8" (RT) D = 10° 25' 02.7" L = 320.08' T = 164.71' R = 550.00' SE = 0.06 RUNOFF = 126'
--	---	---

NOTE: DRIVEWAY RADII = 10'
UNLESS SHOWN OTHERWISE

FOR -L- PROFILE SEE SHEETS 87 & 88
FOR -Y33- PROFILE SEE SHEET 140 & 141
FOR -Y19RPCA- PROFILE SEE SHEET 136

REVISIONS

MATCH TO -L- POT STA. 1384+00.00 - SEE SHEET 44

MATCH TO -L- POT STA. 1397+00.00 - SEE SHEET 46

MATCH TO -Y33- POC STA. 40+62.50 - SEE SHEET 46

6/25/2021 10:18:12 1-5986B_Rdly_psh_45.dgn
 3:33:30 PM
 5/14/99