

PROJECT REFERENCE NO. 1-5986B	SHEET NO. 44
RW SHEET NO.	
ROADWAY DESIGN ENGINEER SUSAN C LANCASTER SEAL 027373 6/28/2021	HYDRAULICS ENGINEER JOSHUA G. DARTON SEAL 26971 6/28/2021
<p>DOCUMENT NOT CONSIDERED FINAL UNLESS ALL SIGNATURES COMPLETED</p> <p>Michael Baker Engineering, Inc. 1088AD8C14904C3 SUNGATE DESIGN GROUP, P.A. 1088AD8C14904C3</p>	

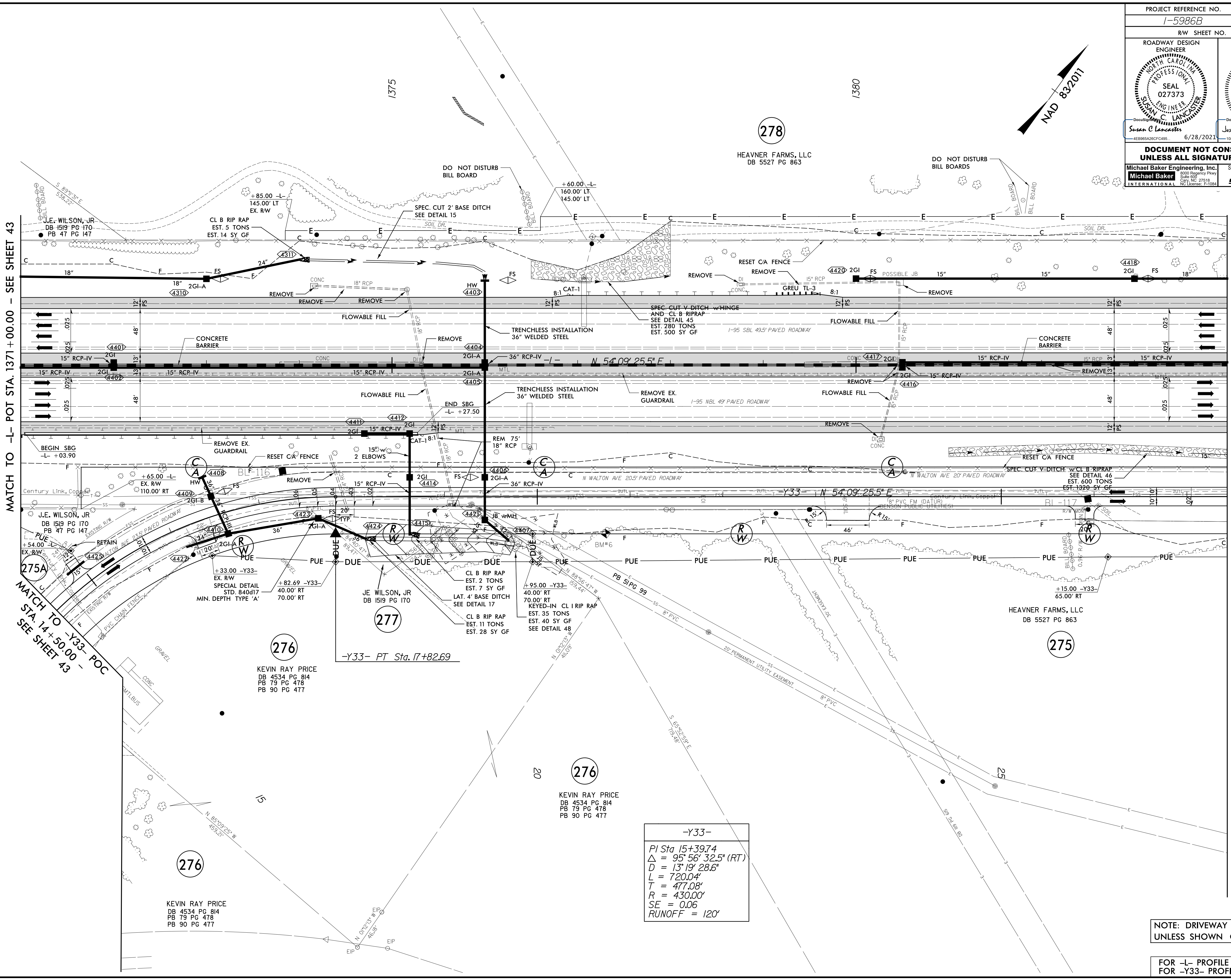
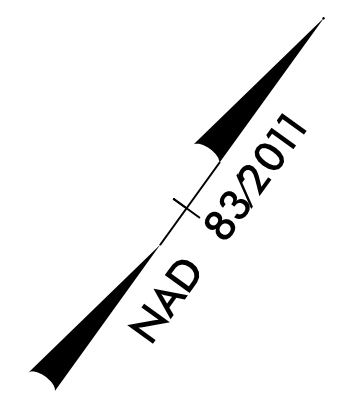

MATCH TO -L- POT STA. 1371 + 00.00 - SEE SHEET 43

MATCH TO -L- POT STA. 1384 + 00.00 - SEE SHEET 45

MATCH TO -Y33- POC STA. 14 + 50.00 - SEE SHEET 43

REVISIONS

15-JUN-2021 17:50 - 5986B_Rdly_psh_44.dgn

-Y33-
 PI Sta 15+39.74
 $\Delta = 95^\circ 56' 32.5''$ (RT)
 $D = 13' 19'' 28.6''$
 $L = 720.04'$
 $T = 477.08'$
 $R = 430.00'$
 $SE = 0.06$
 $RUNOFF = 120'$

NOTE: DRIVEWAY RADII = 10'
UNLESS SHOWN OTHERWISE

FOR -L- PROFILE SEE SHEETS 87
FOR -Y33- PROFILE SEE SHEET 140