

REVISIONS	

-YTRPB-			
PI Sta 11+85.02 G _o = 2.58 3/4" L _s = 180.00' LT = 126.00' T = 213.43' R = 180.000' SE = 0.02 RUNOFF = SEE PLANS	PI Sta 14+02.43 G _o = 13.28 3/4" (LT) L _s = 180.00' LT = 126.00' T = 213.43' R = 180.000' SE = 0.02 RUNOFF = SEE PLANS	PI Sta 16+16.75 G _o = 14.13 3/4" L _s = 180.00' LT = 126.00' T = 213.43' R = 180.000' SE = 0.02 RUNOFF = SEE PLANS	PI Sta 18+31.07 G _o = 3.09 2 1/4" L _s = 216.00' LT = 144.00' T = 213.43' R = 180.000' SE = 0.02 RUNOFF = SEE PLANS

-YTRPA-		
PI Sta 14+51.25 G _o = 5.09 2 1/4" L _s = 216.00' LT = 144.00' T = 213.43' R = 180.000' SE = 0.02 RUNOFF = SEE PLANS	PI Sta 17+46.80 G _o = 17.43 2 1/4" (RT) L _s = 216.00' LT = 144.00' T = 213.43' R = 180.000' SE = 0.02 RUNOFF = SEE PLANS	PI Sta 19+73.07 G _o = 3.09 2 1/4" L _s = 216.00' LT = 144.00' T = 213.43' R = 180.000' SE = 0.02 RUNOFF = SEE PLANS

-YTRPD-			
PI Sta 14+40.05 G _o = 4.35 0" L _s = 144.00' LT = 144.00' T = 126.00' R = 180.000' SE = 0.02 RUNOFF = SEE PLANS	PI Sta 16+17.20 G _o = 4.35 0" L _s = 144.00' LT = 144.00' T = 126.00' R = 180.000' SE = 0.02 RUNOFF = SEE PLANS	PI Sta 18+31.41 G _o = 14.13 3/4" (RT) L _s = 180.00' LT = 126.00' T = 213.43' R = 180.000' SE = 0.02 RUNOFF = SEE PLANS	PI Sta 20+46.80 G _o = 3.09 2 1/4" (RT) L _s = 216.00' LT = 144.00' T = 213.43' R = 180.000' SE = 0.02 RUNOFF = SEE PLANS

-S16-		
PI Sta 65+09.03 G _o = 23.19 0" (LT) L _s = 810.00' LT = 405.00' T = 200.000' SE = 0.06 RUNOFF = SEE PLANS	PI Sta 76+05.87 G _o = 32.49 1/2" (LT) L _s = 810.00' LT = 405.00' T = 200.000' SE = 0.06 RUNOFF = SEE PLANS	PI Sta 82+24.82 G _o = 38.58 5/8" (RT) L _s = 810.00' LT = 405.00' T = 200.000' SE = 0.06 RUNOFF = SEE PLANS

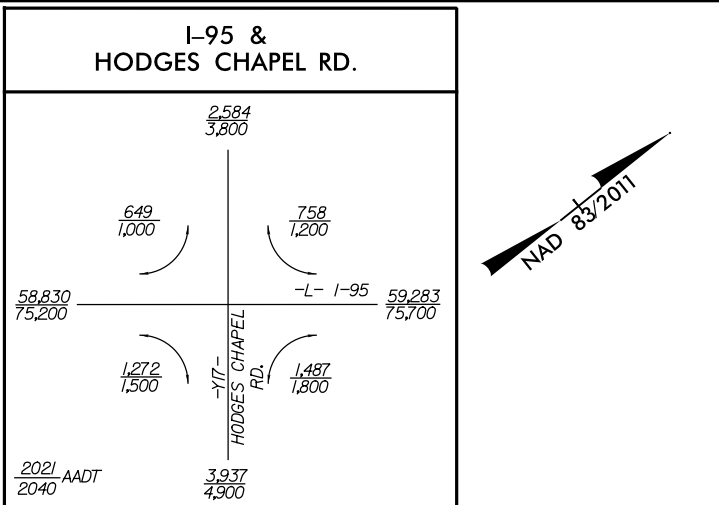
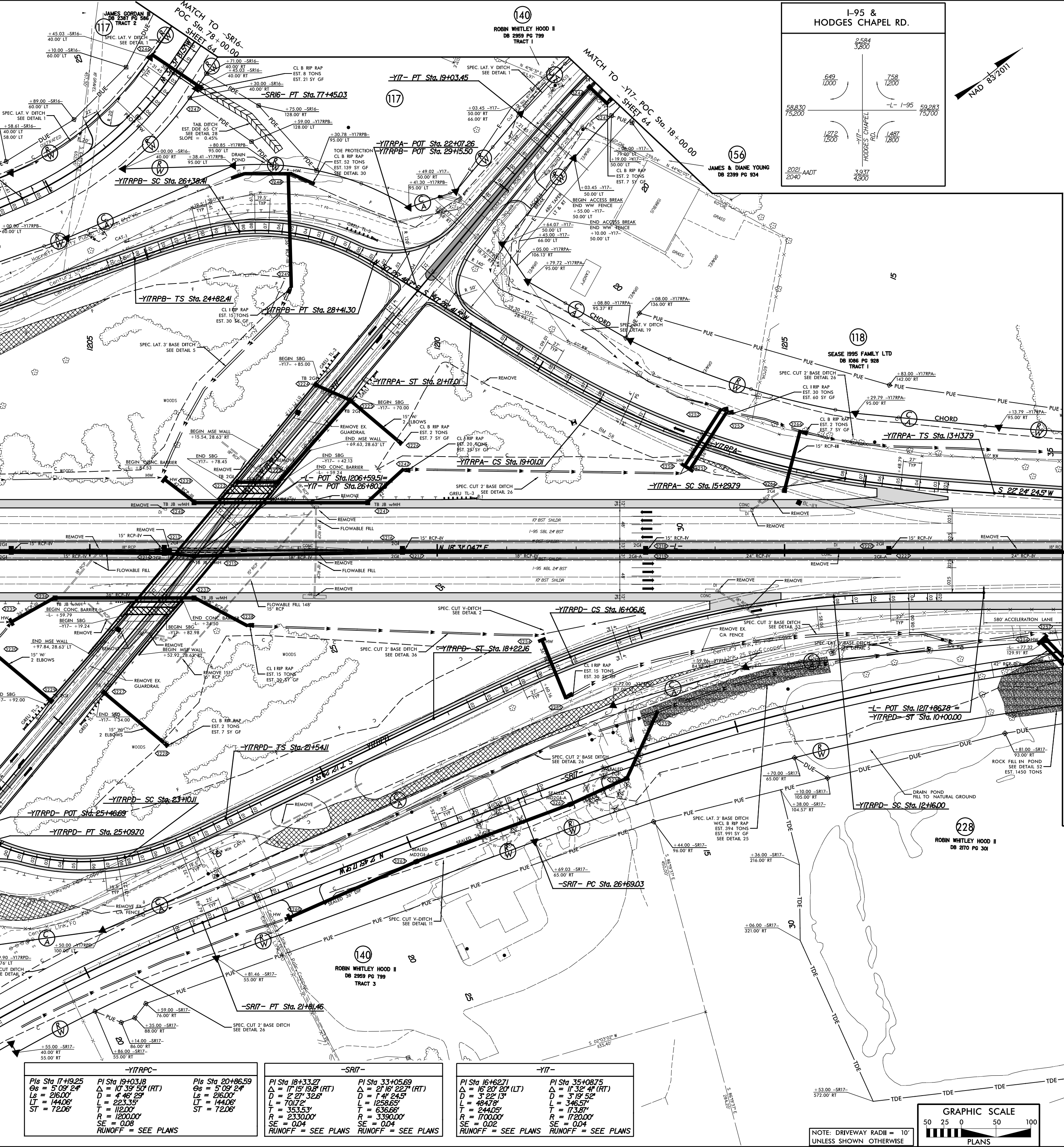

PROJECT REFERENCE NO. 7-5887
SHEET NO. 32

ROADWAY DESIGN ENGINEER
C. L. YOUNG
027373
02/28/2021

HYDRAULICS ENGINEER
C. L. YOUNG
027373
02/28/2021

DOCUMENT NOT CONSIDERED FINAL UNLESS ALL SIGNATURES COMPLETED

MATCH TO -L- POT Sta. 1193+00.00 - SHEET 31

MATCH TO -L- POT Sta. 1219+00.00 - SHEET 33

MATCH TO -L- POT Sta. 98+31.31

MATCH TO -YTR- PC Sta. 25+00.00 - SHEET 65

MATCH TO -S17- PC Sta. 17+00.00 - SHEET 65

-YTRPC-	
PI Sta 17+49.25 G _o = 5.09 2 1/4" L _s = 216.00' LT = 144.00' T = 213.43' R = 180.000' SE = 0.02 RUNOFF = SEE PLANS	PI Sta 19+03.18 G _o = 10.39 5/8" (RT) L _s = 216.00' LT = 144.00' T = 213.43' R = 180.000' SE = 0.02 RUNOFF = SEE PLANS

-S17-	
PI Sta 18+33.27 G _o = 17.18 3/8" (RT) L _s = 216.00' LT = 144.00' T = 213.43' R = 180.000' SE = 0.04 RUNOFF = SEE PLANS	PI Sta 33+05.69 G _o = 27.16 2 1/4" (RT) L _s = 216.00' LT = 144.00' T = 213.43' R = 180.000' SE = 0.04 RUNOFF = SEE PLANS

-YTR-	
PI Sta 16+62.71 G _o = 16.80 2 1/4" (LT) L _s = 324.00' LT = 162.00' T = 213.43' R = 180.000' SE = 0.02 RUNOFF = SEE PLANS	PI Sta 35+08.75 G _o = 17.32 4" (RT) L _s = 324.00' LT = 162.00' T = 213.43' R = 180.000' SE = 0.04 RUNOFF = SEE PLANS

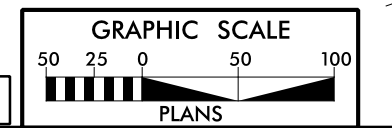

NOTE: DRIVEWAY RADIUS = 10' UNLESS SHOWN OTHERWISE

FOR -L- PROFILE SEE SHEET 80 & 81
FOR -YTR- PROFILE SEE SHEET 102
FOR -YTRPB- PROFILE SEE SHEET 113
FOR -YTRPA- PROFILE SEE SHEET 114
FOR -YTRPD- PROFILE SEE SHEET 115
FOR -S16- PROFILE SEE SHEET 123
FOR -S17- PROFILE SEE SHEET 125 & 126
FOR -S18- PROFILE SEE SHEET 126 & 127