

MATCHLINE - SHEET CRP-008

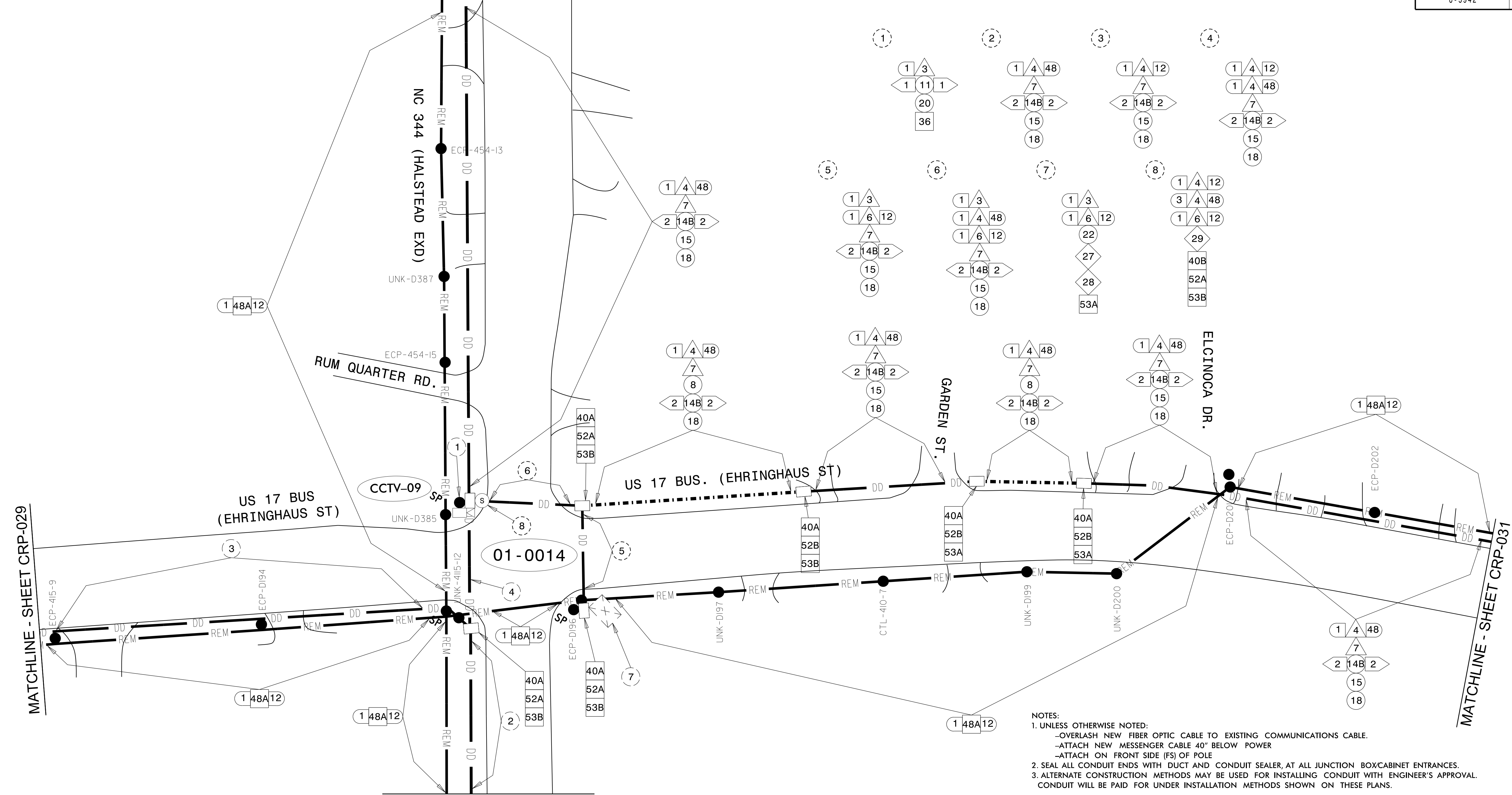

NOTES:  
 1. UNLESS OTHERWISE NOTED:  
 -OVERLASH NEW FIBER OPTIC CABLE TO EXISTING COMMUNICATIONS CABLE.  
 -ATTACH NEW MESSENGER CABLE 40" BELOW POWER  
 -ATTACH ON FRONT SIDE (FS) OF POLE  
 2. SEAL ALL CONDUIT ENDS WITH DUCT AND CONDUIT SEALER, AT ALL JUNCTION BOX/CABINET ENTRANCES.  
 3. ALTERNATE CONSTRUCTION METHODS MAY BE USED FOR INSTALLING CONDUIT WITH ENGINEER'S APPROVAL.  
 CONDUIT WILL BE PAID FOR UNDER INSTALLATION METHODS SHOWN ON THESE PLANS.

1 NOT USED	15 DIRECTIONAL DRILL CONDUIT	29 INSTALL UNDERGROUND SPICE ENCLOSURE	43 NOT USED	55 LASH CABLE(S) TO EXISTING MESSENGER CABLE
2 NOT USED	16 NOT USED	30 INSTALL AERIAL SPICE ENCLOSURE	44 INSTALL AERIAL GUY ASSEMBLY	56 LASH CABLE(S) TO NEW MESSENGER CABLE
3 INSTALL ETHERNET CABLE	17 INSTALL CABLE(S) IN EXISTING CONDUIT	31 NOT USED	45 INSTALL STANDARD GUY ASSEMBLY	57 HANDLASH AND INSTALL AERIAL CABLE PROTECTOR
4 INSTALL SMFO CABLE	18 INSTALL CABLE(S) IN NEW CONDUIT	32 NOT USED	46 INSTALL SIDEWALK GUY ASSEMBLY	58 NOT USED
5 NOT USED	19 INSTALL CABLE(S) IN EXISTING RISER	33 NOT USED	47 INSTALL MESSENGER CABLE	59 BOND TRACER WIRE TO EQUIPMENT GROUND BUS
6 INSTALL FIBER OPTIC DROP CABLE	20 INSTALL CABLE(S) IN NEW RISER	34 NOT USED	48A REMOVE EXISTING COMMUNICATIONS CABLE AND MESSENGER CABLE	60 DO NOT BOND TRACER WIRE TO EQUIPMENT GROUND BUS
7 INSTALL TRACER WIRE	21 INSTALL CABLE(S) IN EXISTING CONDUIT STUBOUTS	35 NOT USED	48B REMOVE EXISTING COMMUNICATIONS CABLE	61 BOND RISER AND MESSENGER CABLE TO POLE GROUND
8 TRENCH	22 INSTALL NEW CONDUIT INTO EXISTING CABINET BASE (USE EXISTING CONDUIT STUB-OUTS WHEN AVAILABLE)	36 INSTALL CCTV CAMERA ASSEMBLY	49 NOT USED	62 BOND RISER TO POLE GROUND
9 INSTALL PVC CONDUIT	23 INSTALL NEW RISER INTO EXISTING CABINET BASE (USE EXISTING CONDUIT STUB-OUTS WHEN AVAILABLE)	37 INSTALL CCTV CAMERA 50' WOOD POLE	50 NOT USED	63 BOND MESSENGER CABLE TO POLE GROUND
10 INSTALL RIGID, GALVANIZED STEEL CONDUIT	24 INSTALL NEW CONDUIT INTO EXISTING POLE MOUNTED CABINET	38 NOT USED	51 INSTALL CABLE STORAGE RACKS (SNOW SHOES) AND STORE 100 FEET OF EACH CABLE	64 INSTALL MOLDABLE DUCT SEAL
11 INSTALL RIGID, GALVANIZED STEEL RISER WITH WEATHERHEAD	25 INSTALL NEW RISER INTO EXISTING POLE MOUNTED CABINET	39 INSTALL JUNCTION BOX	52A INSTALL DELINEATOR MARKER	65 SLACK SPAN
12 INSTALL RIGID, GALVANIZED STEEL RISER WITH FIBER OPTIC CABLE SEAL	26A MODIFY EXISTING INTERCONNECT CENTER /SPICE ENCLOSURE	40A INSTALL OVERSIZED JUNCTION BOX	52B INSTALL JUNCTION BOX MARKER	
13 INSTALL HEAT SHRINK TUBING RETROFIT KIT	26B MODIFY/RELOCATE EXISTING FIBER OPTIC TRANSCEIVER	40B INSTALL SPECIAL OVERSIZED JUNCTION BOX (36" x 24" x 24")	53A STORE 30 FEET OF COMMUNICATIONS CABLE	
14A NOT USED	27 INSTALL NEW ETHERNET EDGE SWITCH IN CABINET	41 REMOVE EXISTING JUNCTION BOX	53B STORE 50 FEET OF EACH COMMUNICATIONS CABLE	
14B INSTALL POLYETHYLENE CONDUIT	28 INSTALL INTERCONNECT CENTER, PATCH PANEL, JUMPERS, AND FUSION SPICE CABLE IN CABINET	42 INSTALL WOOD POLE		

Plans Prepared By: **DRMP**  
 DRMP, Inc.  
 8000 Regency Parkway, Suite 175  
 Cary, NC 27518  
 NC License No. C-2213 (919) 650-1038

DOCUMENT NOT CONSIDERED FINAL UNLESS ALL SIGNATURES COMPLETED

Elizabeth City Signal System Cable Routing Plans  
 Division 1 Pasquotank County Elizabeth City  
 PLAN DATE: April 2018 REVIEWED BY: LM Moon  
 PREPARED BY: RD Lawton REVIEWED BY:

750 N. Greenfield Pkwy., Garner, NC 27529  
 SCALE: 0 50  
 1" = 50'

SEAL  
 NORTH CAROLINA PROFESSIONAL ENGINEER  
 SEAL 022516  
 LISA M. MOON  
 DATE: 8/22/2018  
 CADD File name: CRP-030.dgn

22-AUG-2018 10:55 AM C:\Users\lmoon\OneDrive\Documents\Projects\2018\CRP-030.dgn