

5/14/99

-Y1-

PI Sta 20+95.40
 $\Delta = 31^{\circ} 51' 37.8" (LT)$
 $D = 4' 35" 01.2"$
 $L = 695.09'$
 $T = 356.79'$
 $R = 1,250.00'$
 $e = 8\%$
 RUNOFF = 216'

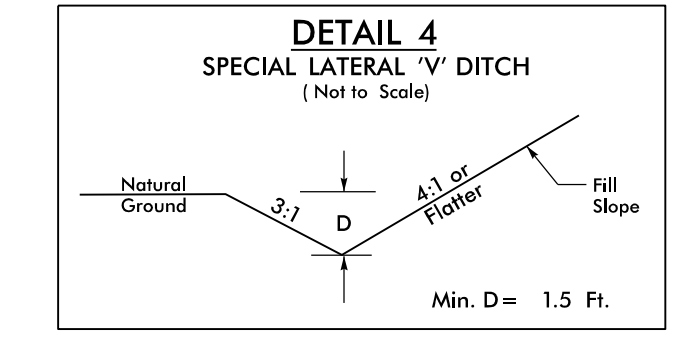

FROM -Y1- STA. 18+00 LT TO -Y1- STA. 20+50 LT

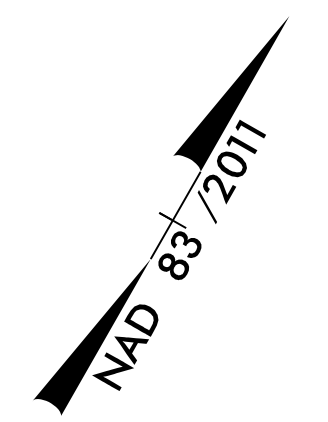

PROJECT REFERENCE NO. B-5980		SHEET NO. 7	
ROADWAY DESIGN ENGINEER		HYDRAULICS ENGINEER	
Prepared in the Office of:		NC FIRM LICENSE No: F-0342 701 Corporate Center Drive, Suite 475 Raleigh, NC 27603 (919) 854-6200 / (919) 854-6291(FAX)	
DOCUMENT NOT CONSIDERED FINAL UNLESS ALL SIGNATURES COMPLETED			

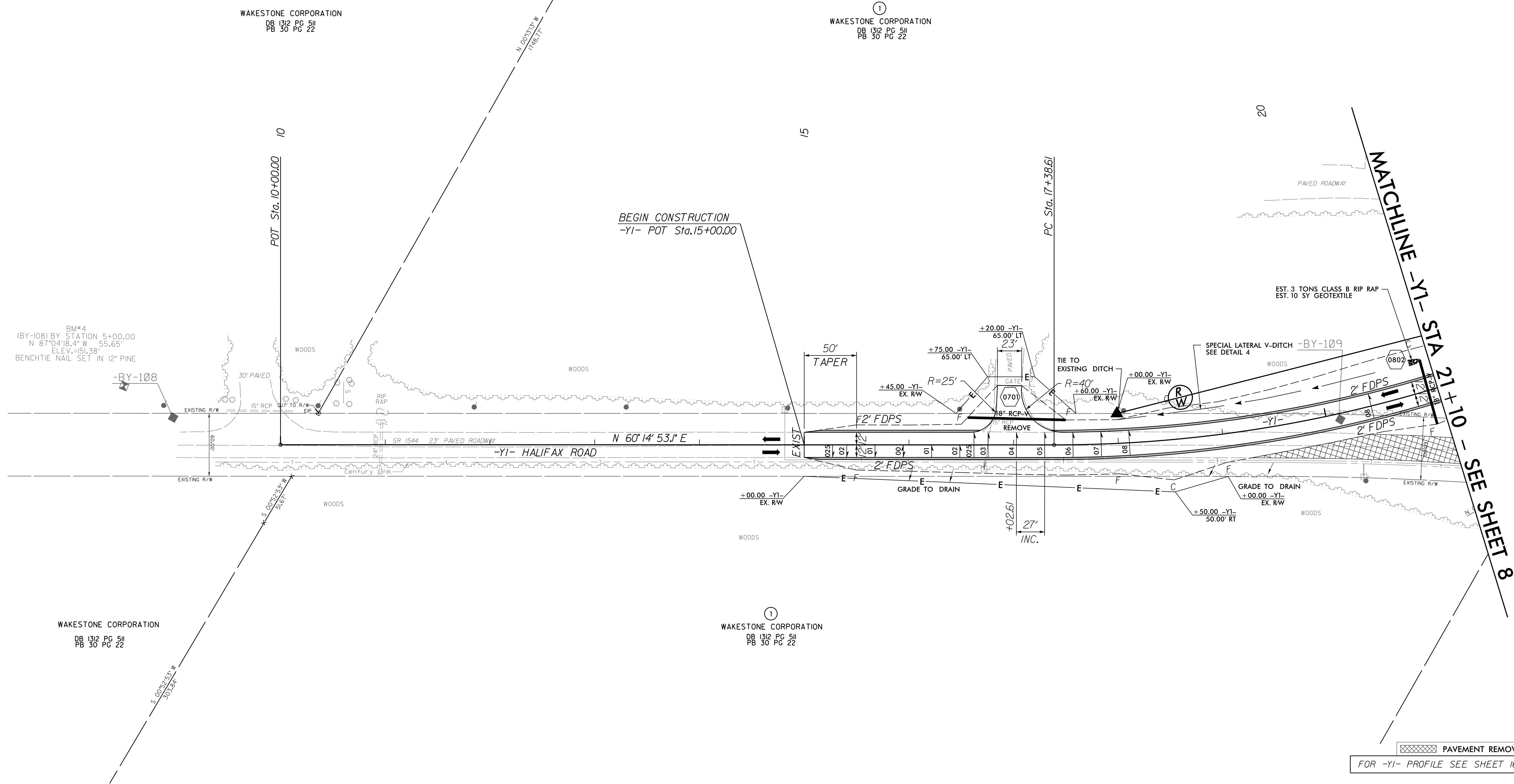

PAVEMENT REMOVAL
 FOR -Y1- PROFILE SEE SHEET 16

R:\Roadway\Proj\B5980_rdy_psh\07.dgn