

PROJECT REFERENCE NO. <i>B-5626</i>	SHEET NO. <i>EC-05/CONST.04</i>
RW SHEET NO.	
ROADWAY DESIGN ENGINEER	HYDRAULICS ENGINEER

IMPERVIOUS DIKE MAY BE MODIFIED AND/OR ELIMINATED AS DIRECTED.

NAD 83, NA 2011

FINAL GRADING EROSION CONTROL FOR CONSTRUCTION SHEET 04

NOTE: UTILIZE SPECIAL STILLING BASIN(S) AS STILLING BASIN WHERE APPLICABLE.

NOTE: UTILIZE COIR FIBER MATTING ADJACENT TO WETLANDS/JURISDICTIONAL AREAS, AND AS DIRECTED.

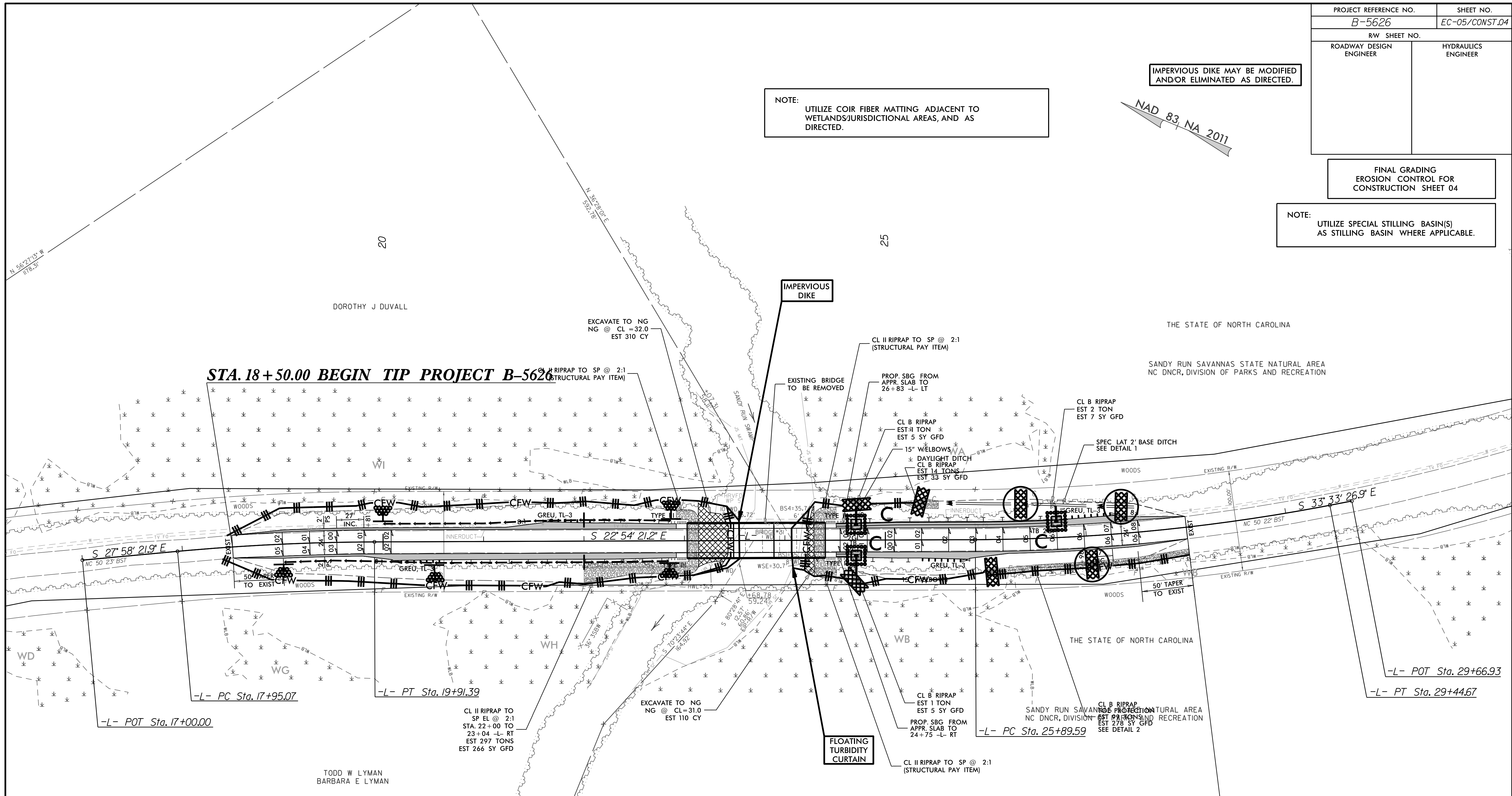

STA. 18+50.00 BEGIN TIP PROJECT B-5626

STA. 28+00.00 END TIP PROJECT B-5626

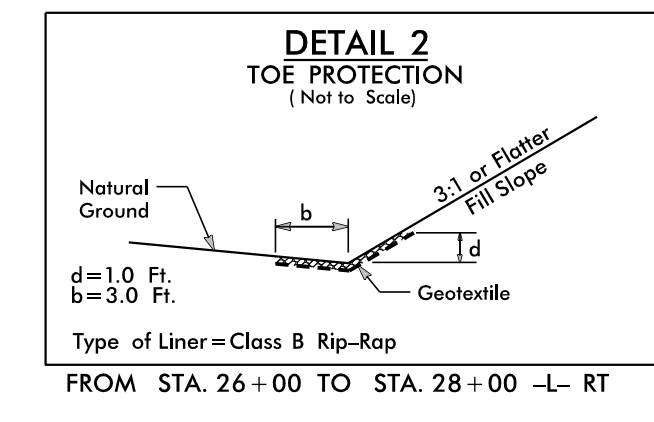
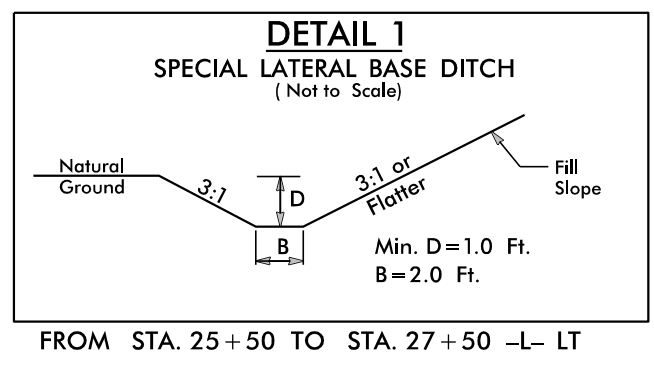
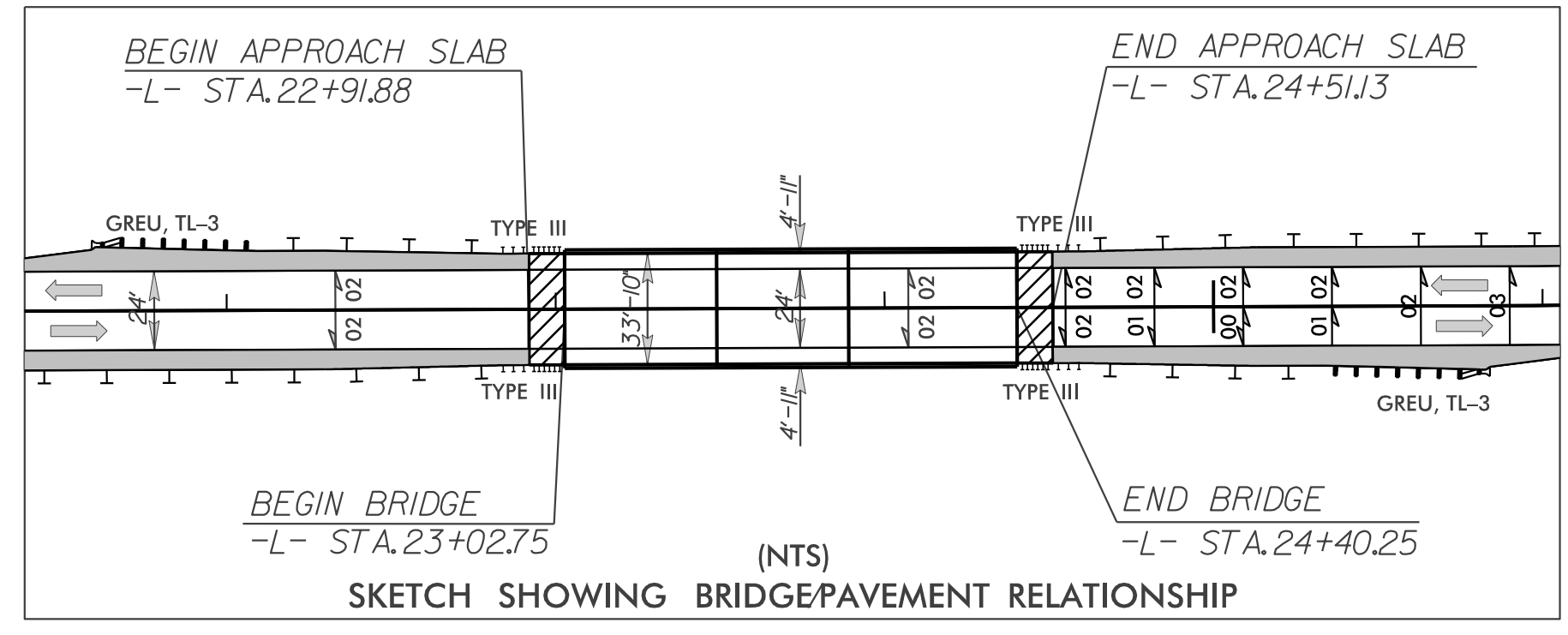

Place Matting for Erosion Control on Slope as Work Allows.
Sta. 20+00 to Sta. 23+00 -L- LT
Sta. 19+00 to Sta. 23+00 -L- RT
Sta. 26+15 to Sta. 27+50 -L- RT

APPROACH SLABS

* NOTE: DIVISION OF MITIGATION SERVICES CONSERVATION EASEMENT (SANDY RUN SAVANNAS STATE NATURAL AREA), NO DISTURBANCE OR ENCROACHMENT ALLOWED.

* NOTE: USE ROCK PLATING FROM -L- STA. 21+75 +/- TO STA. 22+90 +/-, RIGHT AND CARRY ROCK PLATING TO 2.5:1 (H:V) SLOPE. USE ROCK PLATING DETAIL NO. 1 OF ROADWAY STANDARD DRAWING NO. 275.01.

FOR -L- PROFILE, SEE SHEET 5