

PROJECT REFERENCE NO. <b>B-5626</b>	SHEET NO. <b>4</b>
RW SHEET NO.	
ROADWAY DESIGN ENGINEER <b>SEAL 27391</b> MOTT MACDONALD 1 & E, LLC 4/7/2020	HYDRAULICS ENGINEER <b>SEAL 26971</b> MOTT MACDONALD 1 & E, LLC 4/7/2020
<b>DOCUMENT NOT CONSIDERED FINAL UNLESS ALL SIGNATURES COMPLETED</b>	
Prepared in the Office of: <b>MOTT MACDONALD</b> PO Box 700 Fuquay-Varina, NC 27526 www.mottmac.com/mcmeicos	
<b>SUNGATE DESIGN GROUP, P.A.</b> 305 JONES FRANKLIN ROAD RALEIGH, NORTH CAROLINA 27608 TEL: (919) 859-2244 ENG FIRM LICENSE NO. C-890	

NAD 83, NA 2011

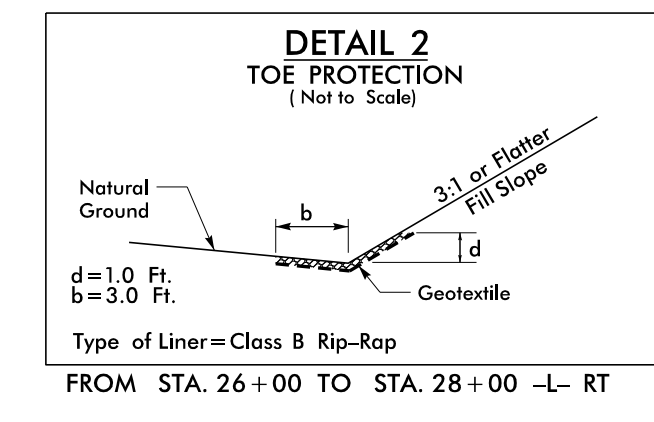
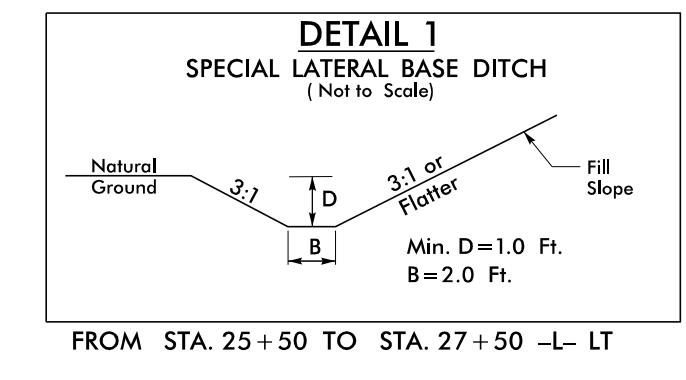
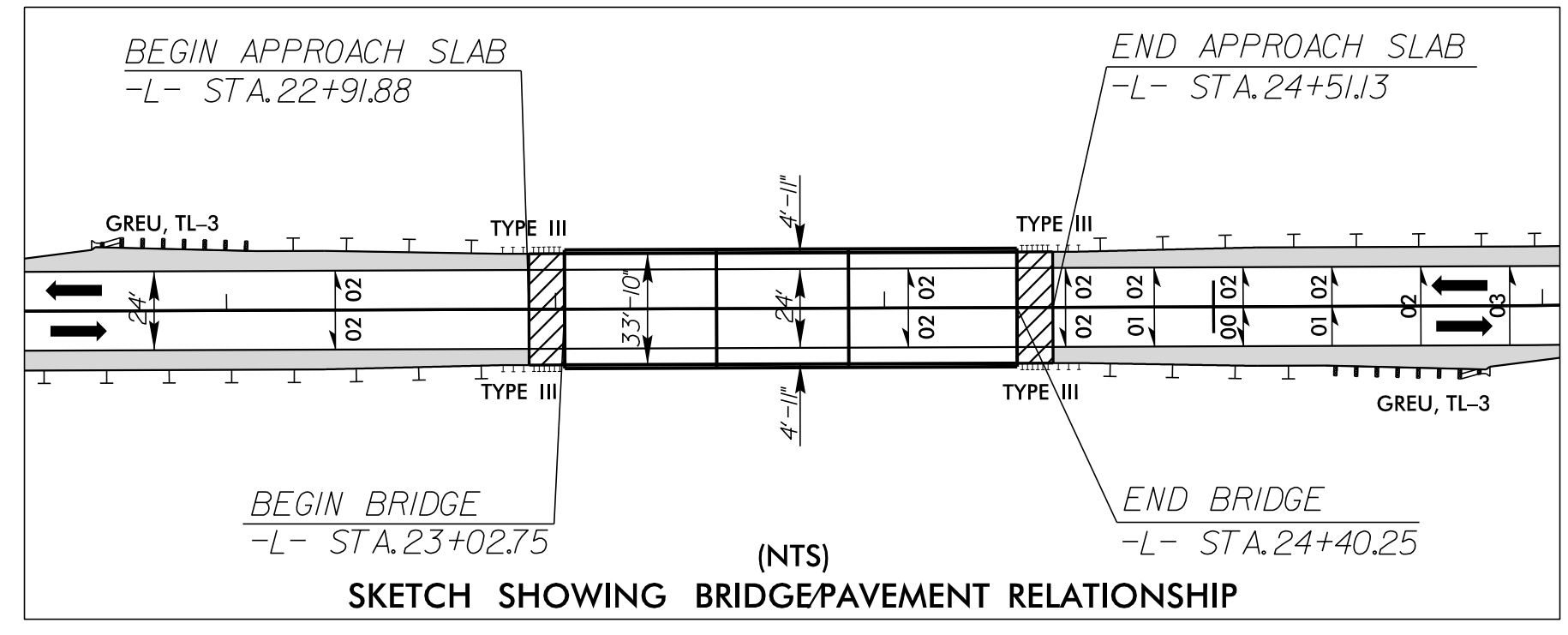
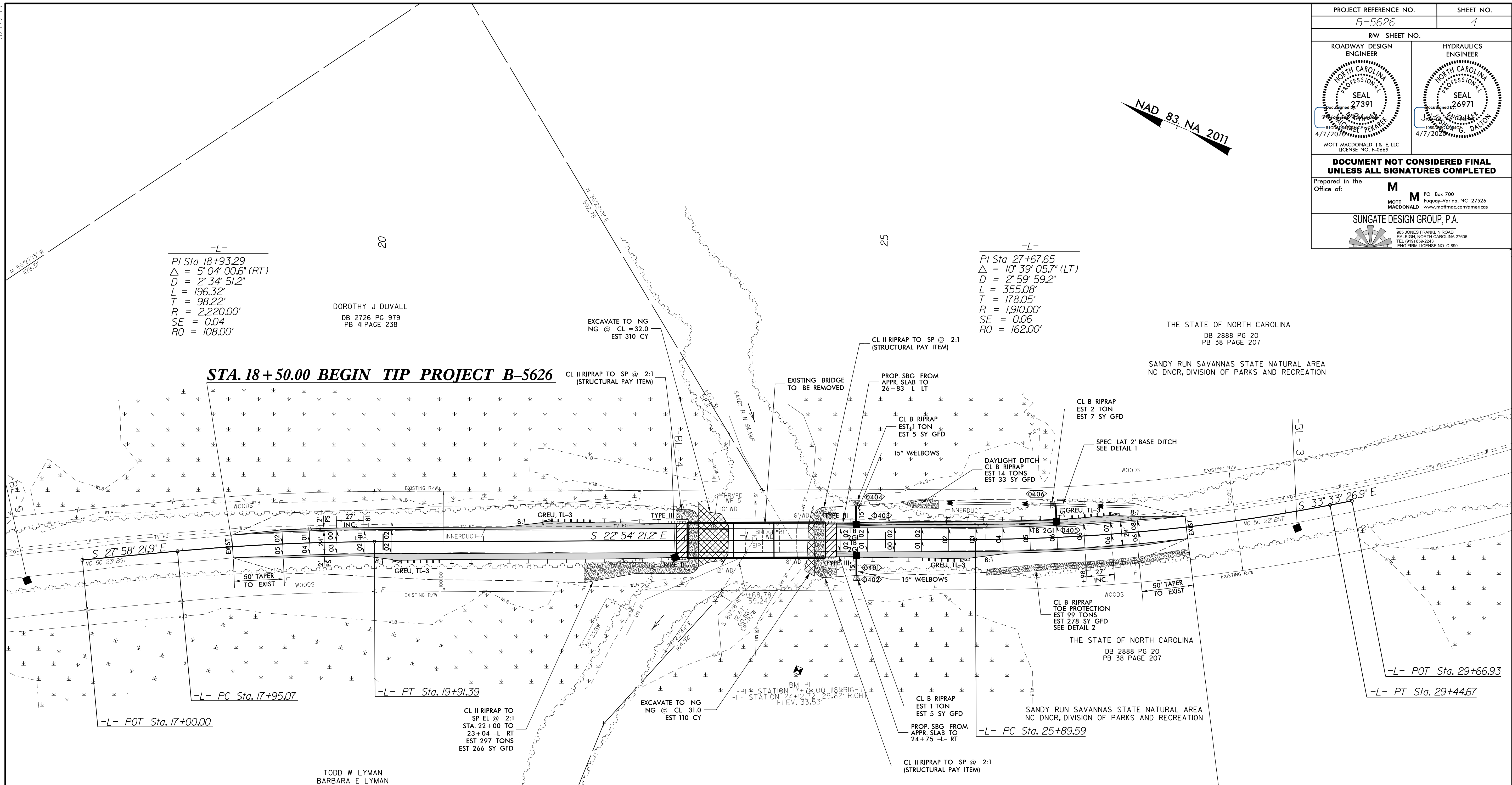

APPROACH SLABS

\* NOTE: DIVISION OF MITIGATION SERVICES CONSERVATION EASEMENT (SANDY RUN SAVANNAS STATE NATURAL AREA), NO DISTURBANCE OR ENCROACHMENT ALLOWED.

\* NOTE: USE ROCK PLATING FROM -L- STA. 21+75 +/- TO STA. 22+90 +/-, RIGHT AND CARRY ROCK PLATING TO 2.5:1 (H:V) SLOPE. USE ROCK PLATING DETAIL NO. 1 OF ROADWAY STANDARD DRAWING NO. 275.01.

FOR -L- PROFILE, SEE SHEET 5

8.17.99  
10.12.25 PM  
C:\Users\psh.dgn\Projects\B5626\B5626.rdw\_psh.dgn  
PK:56884