

**STATE OF NORTH CAROLINA
DIVISION OF HIGHWAYS**

PROJ. REFERENCE NO.	SHEET NO.
B-5619	X-1A

Approximate quantities only. Unclassified excavation, borrow excavation, fine grading, clearing and grubbing, and removal of existing pavement will be paid for at the lump sum price for "Grading".

NOTE: EMBANKMENT COLUMN DOES NOT INCLUDE BACKFILL FOR UNDERCUT

CROSS-SECTION SUMMARY

Station	Uncl. Exc.	Embt
L	(cu. yd.)	(cu. yd.)
20+50.00	0	0
21+00.00	5	3
21+50.00	7	8
22+00.00	40	154
22+00.19	0	1

Station	Uncl. Exc.	Embt
L	(cu. yd.)	(cu. yd.)
24+12.81	0	0
24+50.00	30	72
25+00.00	12	7
25+50.00	3	13
26+00.00	1	13
26+50.00	1	9
27+00.00	1	8
27+50.00	3	12
28+00.00	2	29
28+49.21	8	259

Station	Uncl. Exc.	Embt
L	(cu. yd.)	(cu. yd.)
33+10.79	0	0
33+50.00	7	167
34+00.00	0	39
34+50.00	1	19
35+00.00	3	12
35+50.00	7	5

Station	Uncl. Exc.	Embt
DR1	(cu. yd.)	(cu. yd.)
11+00.00	0	0
11+20.00	9	36
11+40.00	4	121
11+60.00	4	87
11+67.86	2	0

Station	Uncl. Exc.	Embt
DR2	(cu. yd.)	(cu. yd.)
10+18.84	0	0
10+20.00	0	0
10+40.00	0	138
10+60.00	0	234
10+80.00	0	116
10+95.00	2	21

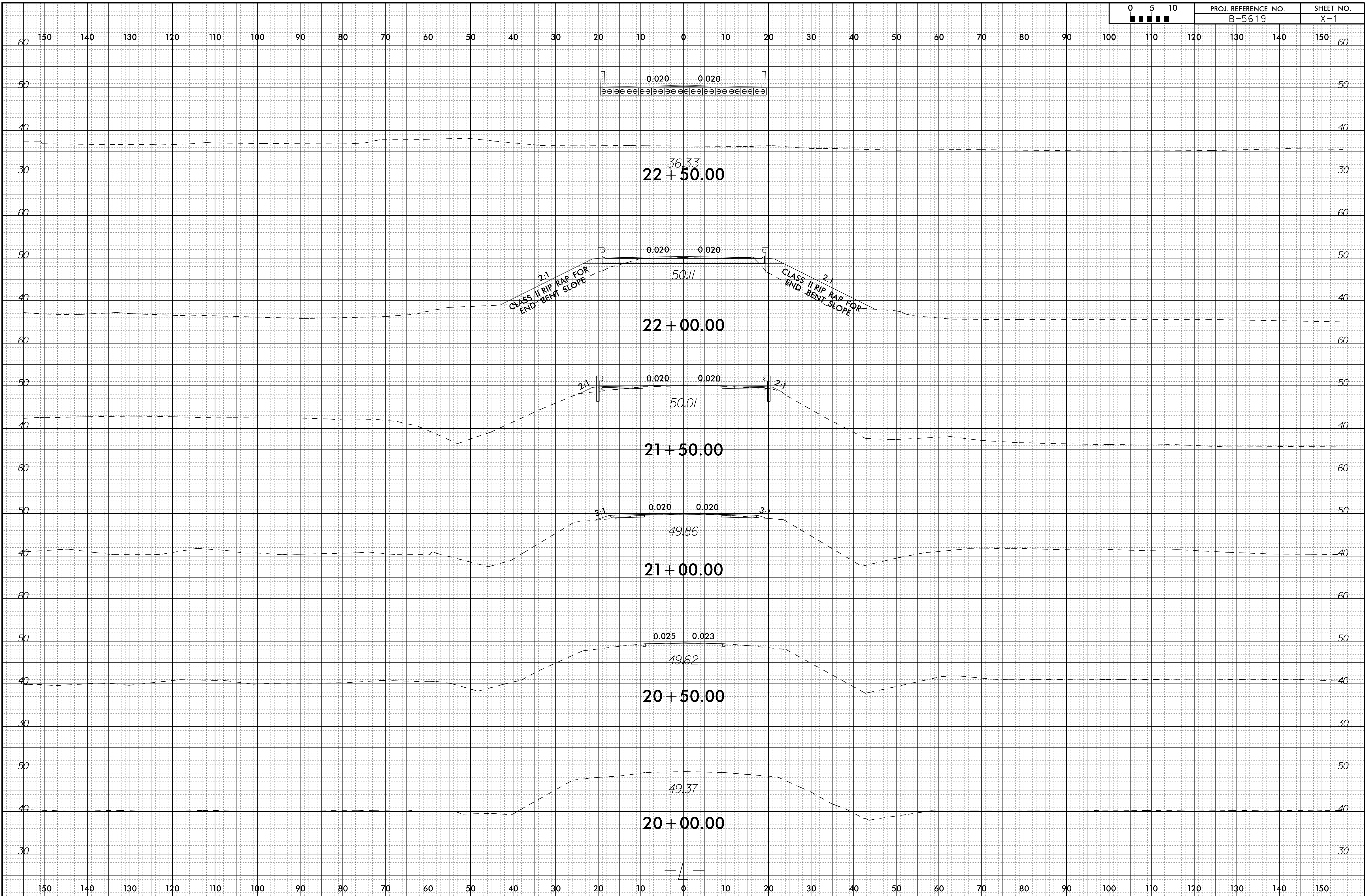

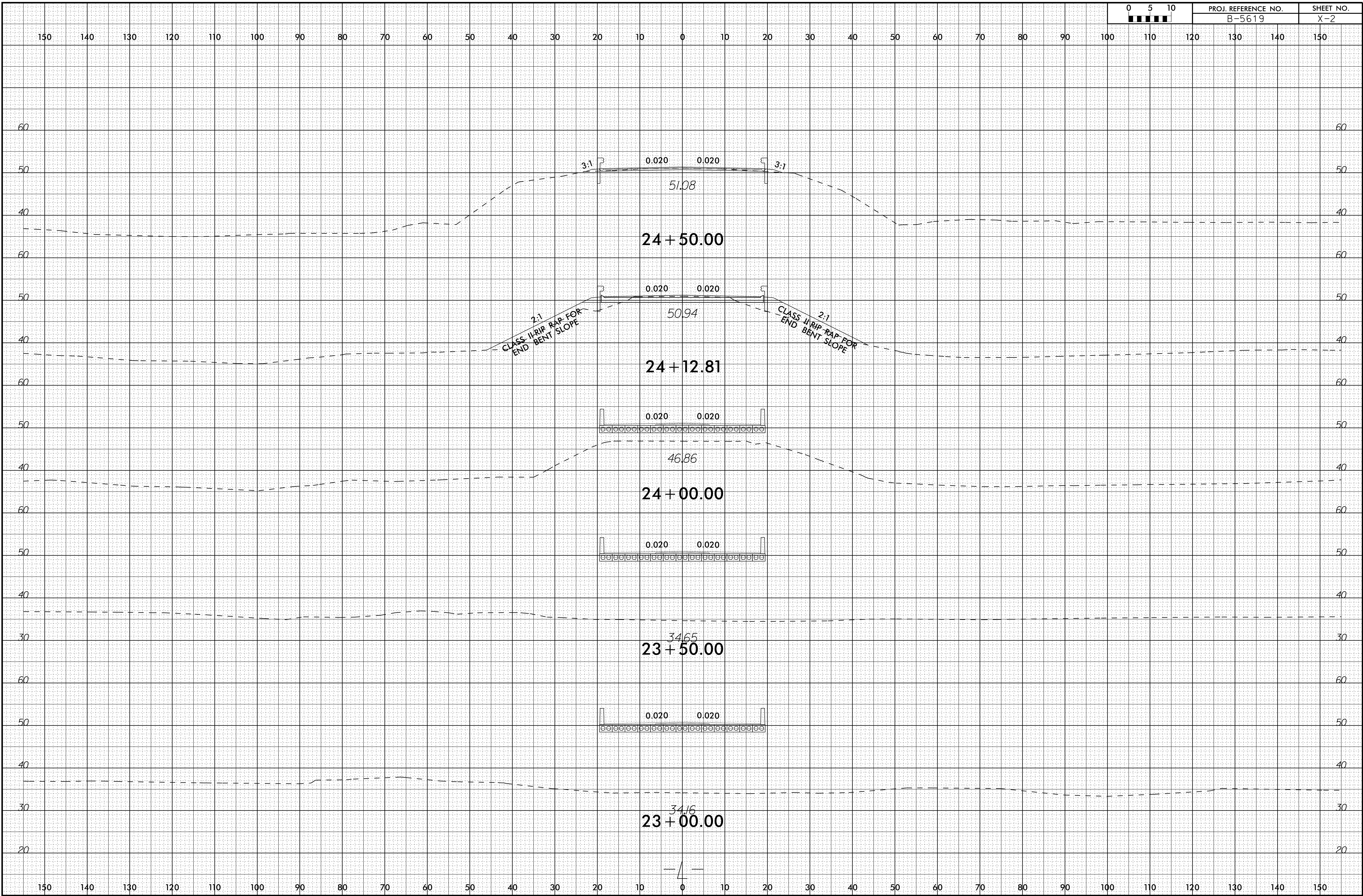

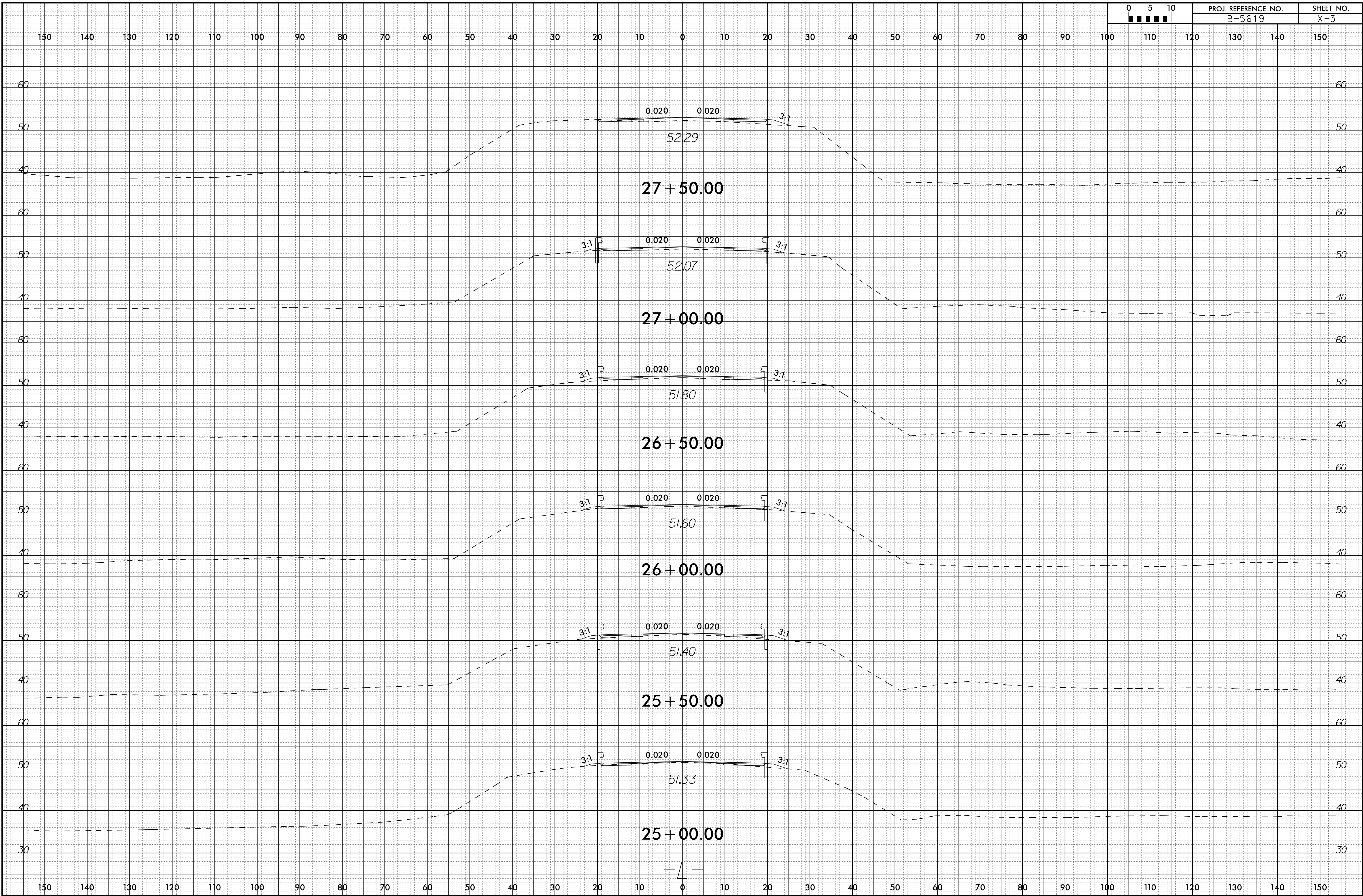

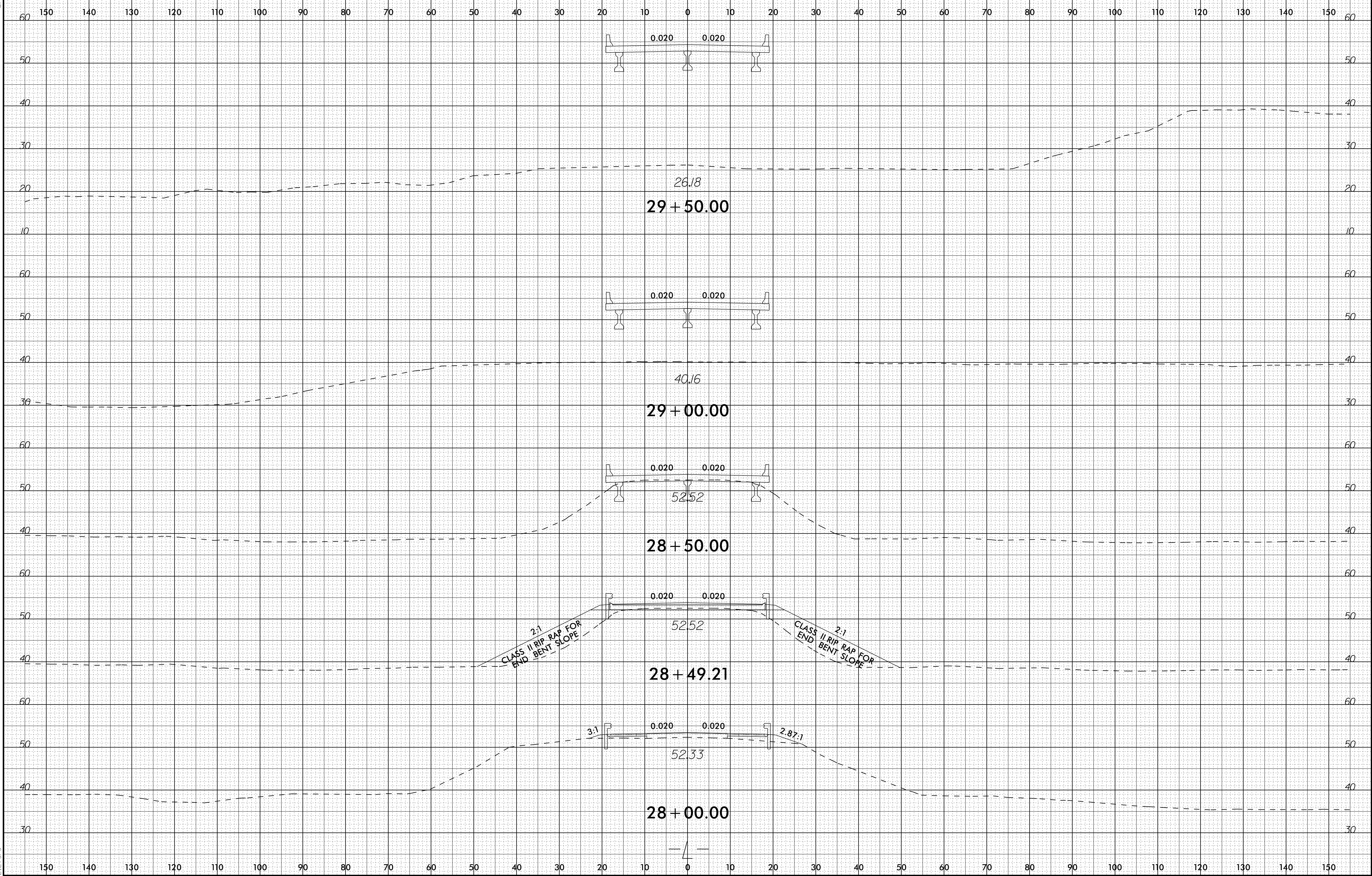

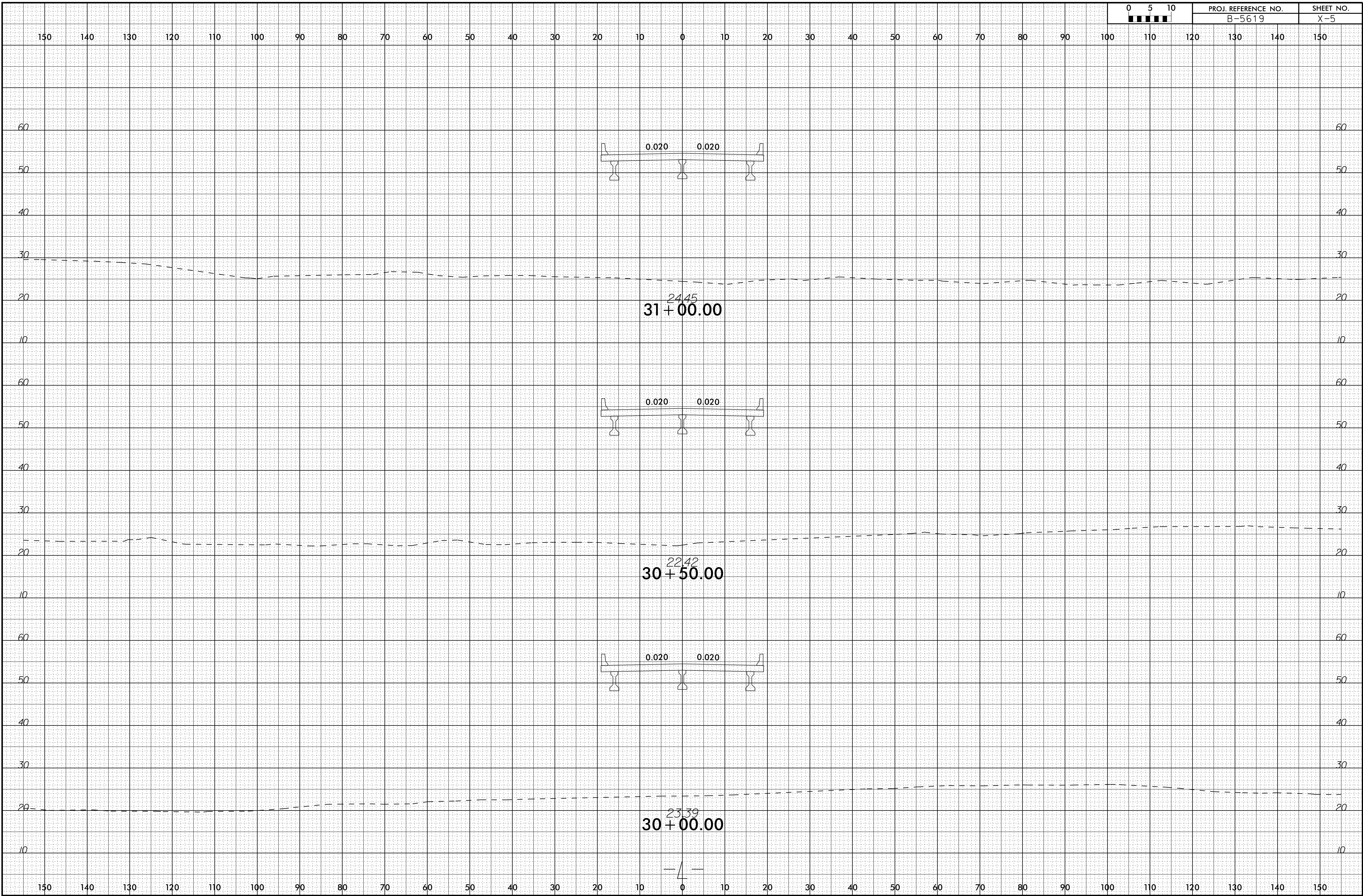

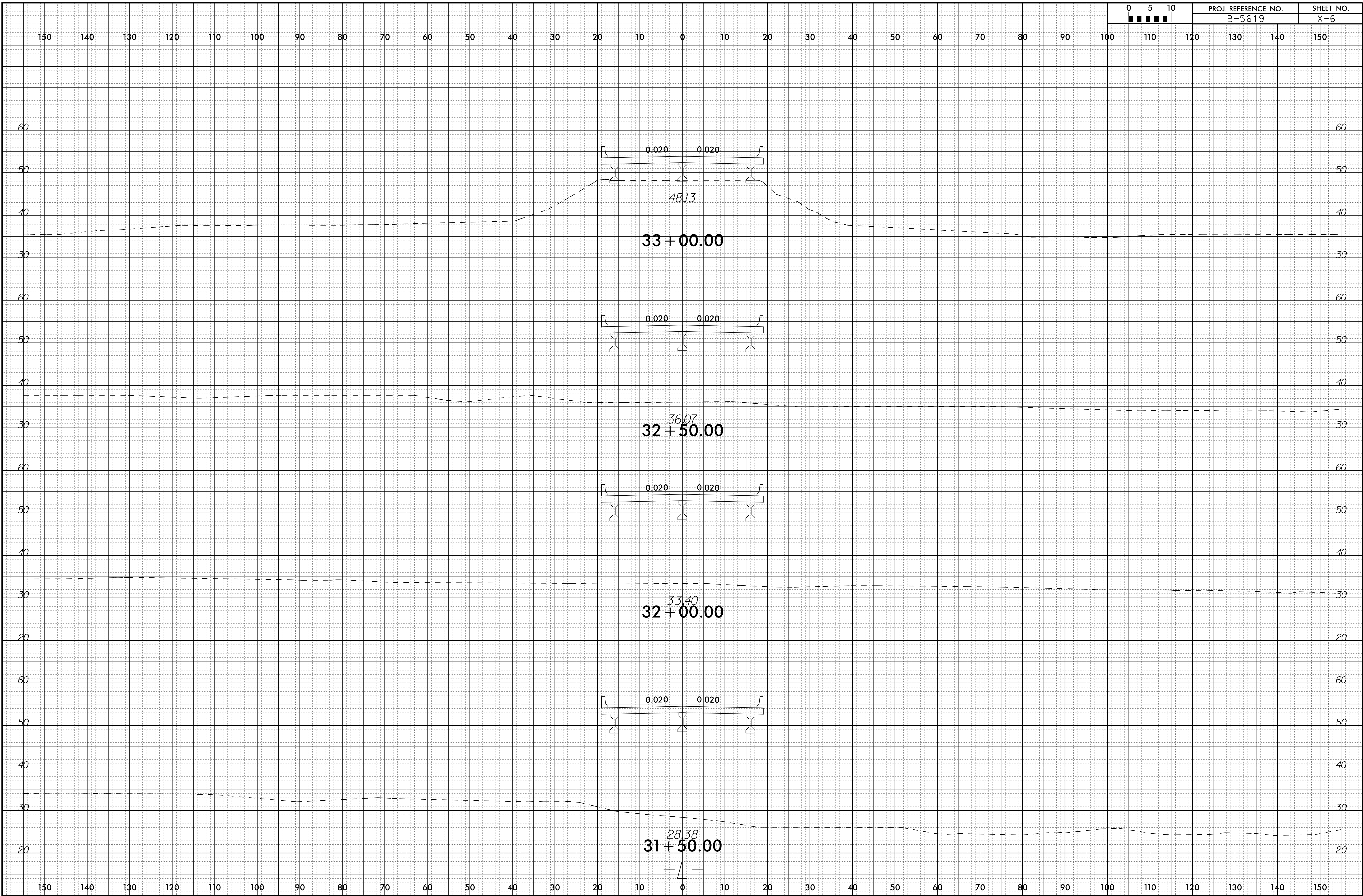

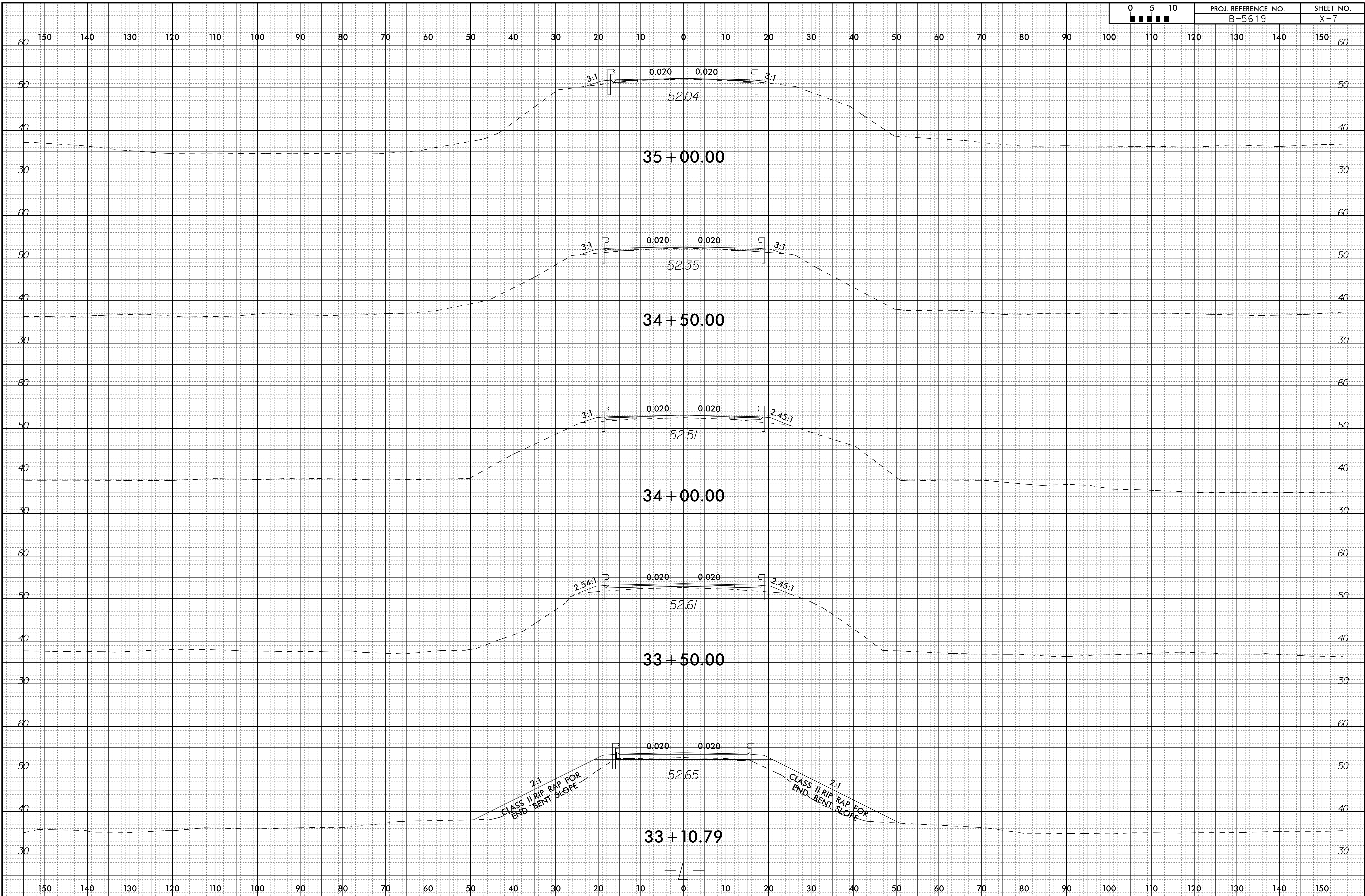

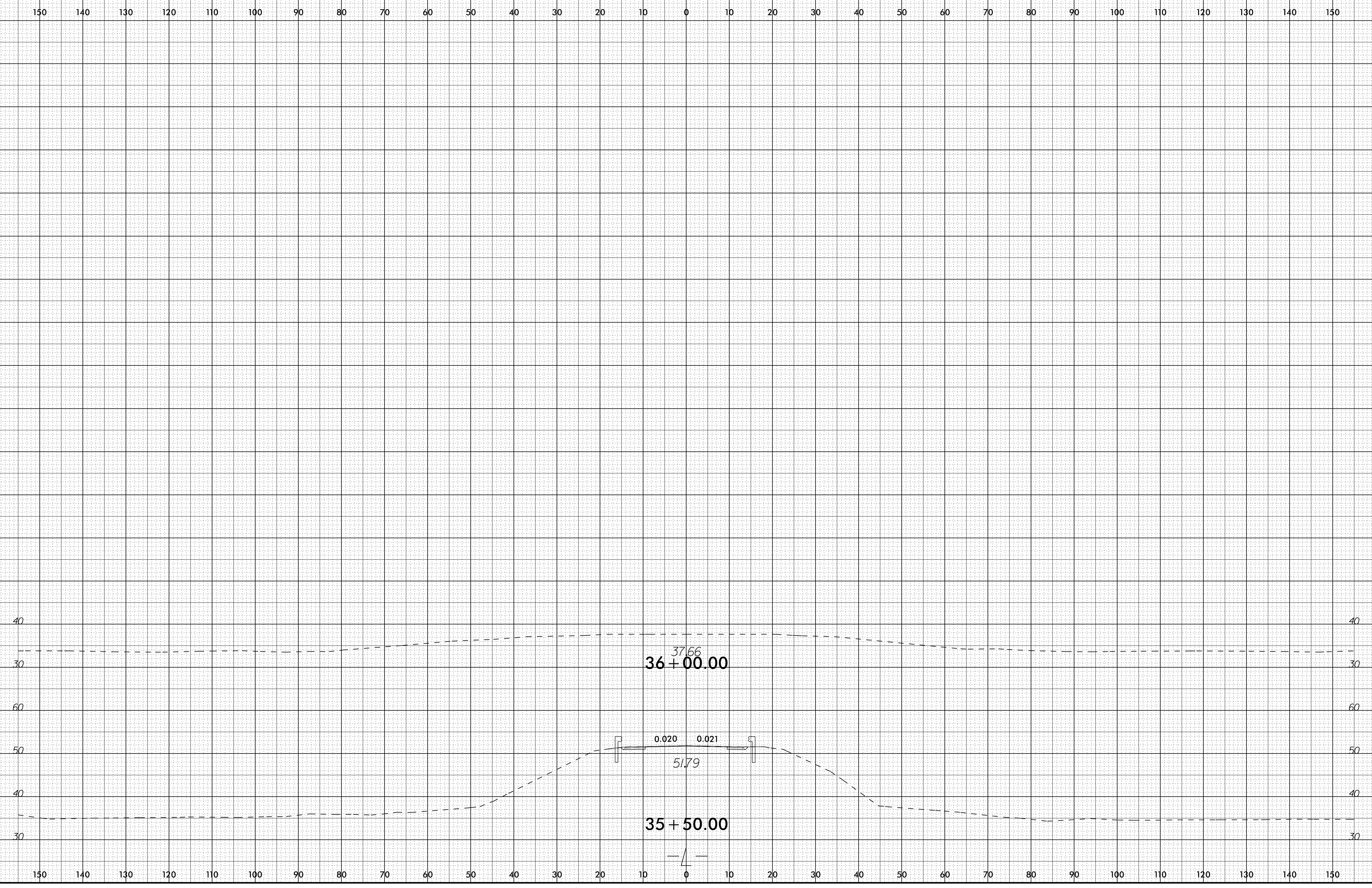

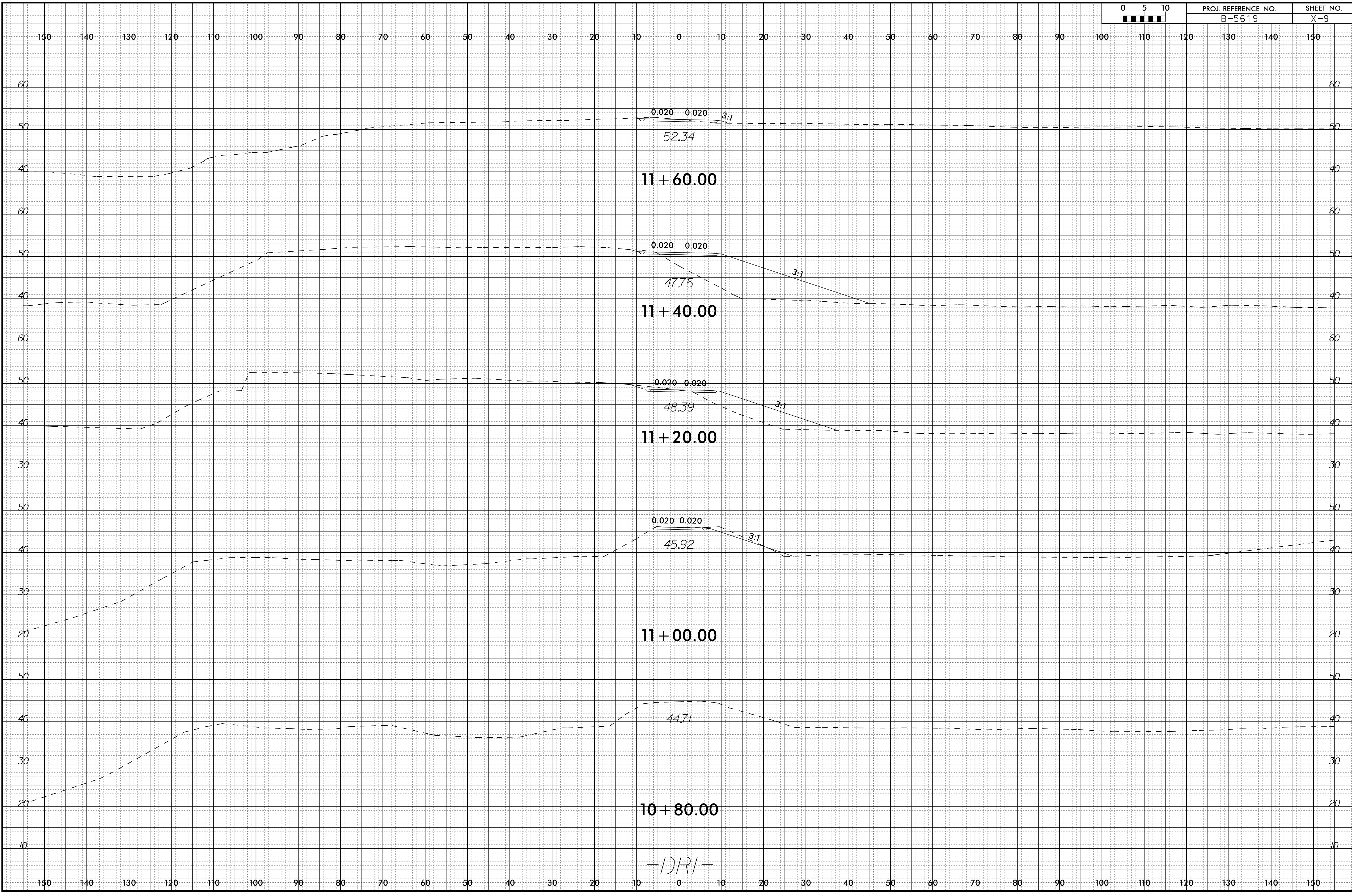

6/23/16

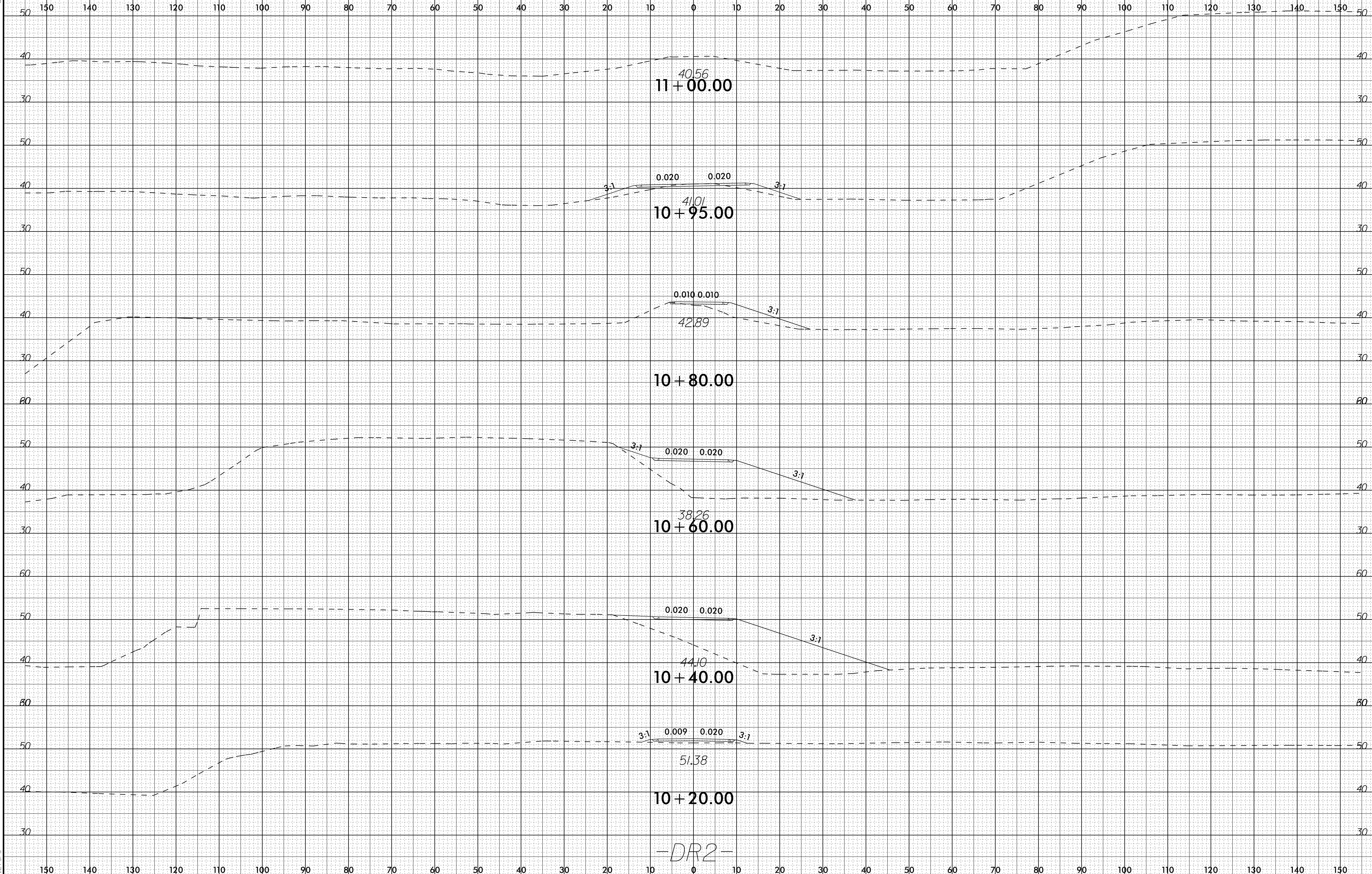

-DR2-

29-JAN-2021 10:28
X:\4305200\180804.01\TECH\Roadway\XSC\B5619_Rdy.xpl_DR2.dgn
2/27/16