

LOAD AND RESISTANCE FACTOR RATING (LRFD) SUMMARY FOR PRESTRESSED CONCRETE GIRDERS

LEVEL	VEHICLE	WEIGHT (W) (TONS)	CONTROLLING LOAD RATING	MINIMUM RATING FACTORS (RF)	TONS = W X RF	STRENGTH I LIMIT STATE										SERVICE III LIMIT STATE					COMMENT NUMBER			
						LIVELOAD FACTORS	MOMENT					SHEAR					LIVELOAD FACTORS	MOMENT						
							DISTRIBUTION FACTORS (DF)	RATING FACTOR	SPAN	GIRDER LOCATION	DISTANCE FROM LEFT END OF SPAN (ft)	DISTRIBUTION FACTORS (DF)	RATING FACTOR	SPAN	GIRDER LOCATION	DISTANCE FROM LEFT END OF SPAN (ft)		DISTRIBUTION FACTORS (DF)	RATING FACTOR	SPAN		GIRDER LOCATION	DISTANCE FROM LEFT END OF SPAN (ft)	
DESIGN LOAD RATING	HL-93(Inv)	N/A	1	2.073	--	1.75	0.28	3.04	60'	EL	24.5	0.534	2.07	60'	EL	2.45	0.80	0.28	2.85	60'	EL	24.5		
	HL-93(Opr)	N/A	--	2.687	--	1.35	0.28	3.93	60'	EL	24.5	0.534	2.69	60'	EL	2.45	N/A	--	--	--	--	--		
	HS-20(Inv)	36.000	2	2.479	89.25	1.75	0.28	3.76	60'	EL	24.5	0.534	2.48	60'	EL	2.45	0.80	0.28	3.52	60'	EL	24.5		
	HS-20(Opr)	36.000	--	3.214	115.694	1.35	0.28	4.88	60'	EL	24.5	0.534	3.21	60'	EL	2.45	N/A	--	--	--	--	--		
LEGAL LOAD RATING	SV	SNSH	13.500	--	6.997	94.455	1.4	0.28	9.57	60'	EL	24.5	0.534	7	60'	EL	2.45	0.80	0.28	7.20	60'	EL	24.5	
		SNGARBS2	20.000	--	5.091	101.826	1.4	0.28	7.56	60'	EL	24.5	0.534	5.09	60'	EL	2.45	0.80	0.28	5.65	60'	EL	24.5	
		SNAGRIS2	22.000	--	4.772	104.98	1.4	0.28	7.26	60'	EL	19.6	0.534	4.77	60'	EL	2.45	0.80	0.28	5.45	60'	EL	19.6	
		SNCOTTS3	27.250	--	3.505	95.499	1.4	0.28	4.78	60'	EL	24.5	0.534	3.5	60'	EL	2.45	0.80	0.28	3.59	60'	EL	24.5	
		SNAGGRS4	34.925	--	2.991	104.445	1.4	0.28	4.15	60'	EL	24.5	0.534	2.99	60'	EL	2.45	0.80	0.28	3.12	60'	EL	24.5	
		SNS5A	35.550	--	3.044	108.209	1.4	0.28	4.05	60'	EL	24.5	0.534	3.07	60'	EL	2.45	0.80	0.28	3.04	60'	EL	24.5	
		SNS6A	39.950	--	2.84	113.453	1.4	0.28	3.79	60'	EL	24.5	0.534	2.84	60'	EL	2.45	0.80	0.28	2.85	60'	EL	24.5	
	SNS7B	42.000	--	2.712	113.918	1.4	0.28	3.61	60'	EL	24.5	0.534	2.84	60'	EL	2.45	0.80	0.28	2.71	60'	EL	24.5		
	TTST	TNAGRIT3	33.000	--	3.351	110.572	1.4	0.28	4.64	60'	EL	24.5	0.534	3.35	60'	EL	2.45	0.80	0.28	3.49	60'	EL	24.5	
		TNT4A	33.075	--	3.228	106.768	1.4	0.28	4.68	60'	EL	24.5	0.534	3.23	60'	EL	2.45	0.80	0.28	3.52	60'	EL	24.5	
		TNT6A	41.600	--	2.93	121.871	1.4	0.28	3.9	60'	EL	24.5	0.534	3.1	60'	EL	2.45	0.80	0.28	2.93	60'	EL	24.5	
		TNT7A	42.000	--	2.892	121.477	1.4	0.28	3.96	60'	EL	24.5	0.534	2.89	60'	EL	2.45	0.80	0.28	2.97	60'	EL	24.5	
		TNT7B	42.000	--	2.736	114.922	1.4	0.28	4.12	60'	EL	24.5	0.534	2.74	60'	EL	2.45	0.80	0.28	3.08	60'	EL	24.5	
		TNAGRIT4	43.000	--	2.637	113.381	1.4	0.28	3.91	60'	EL	24.5	0.534	2.64	60'	EL	2.45	0.80	0.28	2.94	60'	EL	24.5	
TNAGT5A		45.000	--	2.676	120.405	1.4	0.28	3.66	60'	EL	24.5	0.534	2.68	60'	EL	2.45	0.80	0.28	2.75	60'	EL	24.5		
TNAGT5B	45.000	3	2.502	112.57	1.4	0.28	3.58	60'	EL	24.5	0.534	2.5	60'	EL	2.45	0.80	0.28	2.69	60'	EL	24.5			

LOAD FACTORS:

DESIGN LOAD RATING FACTORS	LIMIT STATE	γ_{DC}	γ_{DW}
	STRENGTH I	1.25	1.50
	SERVICE III	1.00	1.00

NOTES:

MINIMUM RATING FACTORS ARE BASED ON THE STRENGTH I AND SERVICE III LIMIT STATES.

ALLOWABLE STRESSES FOR SERVICE III LIMIT STATE ARE AS REQUIRED FOR DESIGN.

CONTROLLING LOAD RATING

① DESIGN LOAD RATING (HL-93)

② DESIGN LOAD RATING (HS-20)

③ LEGAL LOAD RATING ***

*** SEE CHART FOR VEHICLE TYPE

GIRDER LOCATION

I - INTERIOR GIRDER
EL - EXTERIOR LEFT GIRDER
ER - EXTERIOR RIGHT GIRDER

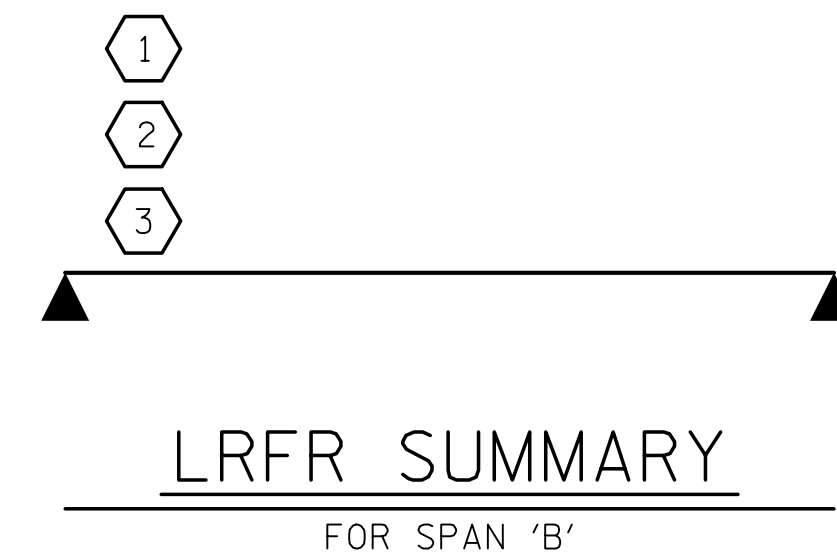

111 E. Hargett Street
Suite 300
Raleigh, NC 27601
919-714-8670
meadhunt.com
NC License No. F-1235



DocuSigned by:
Jack S. Hobson
02/10/2021

DOCUMENT NOT CONSIDERED
FINAL UNLESS ALL
SIGNATURES COMPLETED

PROJECT NO. B-5619
LENOIR COUNTY
STATION: 23+06.50 -L-

SHEET 2 OF 2

STATE OF NORTH CAROLINA
DEPARTMENT OF TRANSPORTATION
RALEIGH
STANDARD
LRFR SUMMARY FOR
60' CORED SLAB UNIT
90° SKEW
(NON-INTERSTATE TRAFFIC)

REVISIONS						SHEET NO.
NO.	BY:	DATE:	NO.	BY:	DATE:	S2-04
1			3			TOTAL SHEETS
2			4			23

ASSEMBLED BY : D.J. CARTE	DATE :12/08/20
CHECKED BY : J.S. HOBSON	DATE :12/29/20
DRAWN BY : CVC 6/10	
CHECKED BY : DNS 6/10	