

LOAD FACTORS:

DESIGN LOAD RATING FACTORS	LIMIT STATE	$\gamma_{DC}$	$\gamma_{DW}$
	STRENGTH I	1.25	1.50
	SERVICE III	1.00	1.00

LOAD AND RESISTANCE FACTOR RATING (LRFD) SUMMARY FOR PRESTRESSED CONCRETE GIRDERS

LEVEL	VEHICLE	WEIGHT (W) (TONS)	CONTROLLING LOAD RATING	MINIMUM RATING FACTORS (RF)	TONS = W X RF	STRENGTH I LIMIT STATE										SERVICE III LIMIT STATE					COMMENT NUMBER			
						LIVELOAD FACTORS	MOMENT					SHEAR					LIVELOAD FACTORS	MOMENT						
							DISTRIBUTION FACTORS (DF)	RATING FACTOR	SPAN	GIRDER LOCATION	DISTANCE FROM LEFT END OF SPAN (ft)	DISTRIBUTION FACTORS (DF)	RATING FACTOR	SPAN	GIRDER LOCATION	DISTANCE FROM LEFT END OF SPAN (ft)		DISTRIBUTION FACTORS (DF)	RATING FACTOR	SPAN		GIRDER LOCATION	DISTANCE FROM LEFT END OF SPAN (ft)	
DESIGN LOAD RATING	HL-93(Inv)	N/A	1	2.053	--	1.75	0.276	2.26	50'	EL	29.5	0.52	<b>2.05</b>	50'	EL	<b>5.9</b>	0.80	0.276	2.22	50'	EL	29.5		
	HL-93(0pr)	N/A	--	2.661	--	1.35	0.276	2.93	50'	EL	29.5	0.52	2.66	50'	EL	5.9	N/A	--	--	--	--	--		
	HS-20(Inv)	36.000	2	2.47	88.93	1.75	0.276	2.86	50'	EL	29.5	0.52	<b>2.47</b>	50'	EL	<b>5.9</b>	0.80	0.276	2.81	50'	EL	29.5		
	HS-20(0pr)	36.000	--	3.202	115.279	1.35	0.276	3.71	50'	EL	29.5	0.52	3.2	50'	EL	5.9	N/A	--	--	--	--	--		
LEGAL LOAD RATING	SV	SNSH	13.500	--	6.053	81.711	1.4	0.276	7.7	50'	EL	29.5	0.52	7.14	50'	EL	5.9	0.80	0.276	6.05	50'	EL	29.5	
		SNGARBS2	20.000	--	4.634	92.672	1.4	0.276	5.89	50'	EL	29.5	0.52	5.14	50'	EL	5.9	0.80	0.276	4.63	50'	EL	29.5	
		SNAGRIS2	22.000	--	4.43	97.466	1.4	0.276	5.65	50'	EL	29.5	0.52	4.8	50'	EL	5.9	0.80	0.276	4.43	50'	EL	29.5	
		SNCOTTS3	27.250	--	3.015	82.171	1.4	0.276	3.84	50'	EL	29.5	0.52	3.57	50'	EL	5.9	0.80	0.276	3.02	50'	EL	29.5	
		SNAGGRS4	34.925	--	2.567	89.643	1.4	0.276	3.27	50'	EL	29.5	0.52	3.01	50'	EL	5.9	0.80	0.276	2.57	50'	EL	29.5	
		SNS5A	35.550	--	2.507	89.116	1.4	0.276	3.19	50'	EL	29.5	0.52	3.07	50'	EL	5.9	0.80	0.276	2.51	50'	EL	29.5	
		SNS6A	39.950	--	2.32	92.685	1.4	0.276	2.95	50'	EL	29.5	0.52	2.82	50'	EL	5.9	0.80	0.276	2.32	50'	EL	29.5	
	SNS7B	42.000	--	2.21	92.825	1.4	0.276	2.81	50'	EL	29.5	0.52	2.8	50'	EL	5.9	0.80	0.276	2.21	50'	EL	29.5		
	TTST	TNAGRIT3	33.000	--	2.835	93.559	1.4	0.276	3.61	50'	EL	29.5	0.52	3.34	50'	EL	5.9	0.80	0.276	2.84	50'	EL	29.5	
		TNT4A	33.075	--	2.853	94.369	1.4	0.276	3.63	50'	EL	29.5	0.52	3.24	50'	EL	5.9	0.80	0.276	2.85	50'	EL	29.5	
		TNT6A	41.600	--	2.352	97.863	1.4	0.276	2.99	50'	EL	29.5	0.52	3.03	50'	EL	5.9	0.80	0.276	2.35	50'	EL	29.5	
		TNT7A	42.000	--	2.375	99.744	1.4	0.276	3.02	50'	EL	29.5	0.52	2.89	50'	EL	5.9	0.80	0.276	2.37	50'	EL	29.5	
		TNT7B	42.000	--	2.475	103.971	1.4	0.276	3.16	50'	EL	29.5	0.52	2.71	50'	EL	5.9	0.80	0.276	2.48	50'	EL	29.5	
		TNAGRIT4	43.000	--	2.343	100.737	1.4	0.276	2.98	50'	EL	29.5	0.52	2.62	50'	EL	5.9	0.80	0.276	2.34	50'	EL	29.5	
TNAGT5A		45.000	--	2.2	98.988	1.4	0.276	2.8	50'	EL	29.5	0.52	2.63	50'	EL	5.9	0.80	0.276	2.20	50'	EL	29.5		
TNAGT5B	45.000	3	2.165	97.428	1.4	0.276	2.75	50'	EL	29.5	0.52	2.49	50'	EL	5.9	0.80	0.276	<b>2.17</b>	50'	EL	<b>29.5</b>			

NOTES:

MINIMUM RATING FACTORS ARE BASED ON THE STRENGTH I AND SERVICE III LIMIT STATES.

ALLOWABLE STRESSES FOR SERVICE III LIMIT STATE ARE AS REQUIRED FOR DESIGN.

# CONTROLLING LOAD RATING

1 DESIGN LOAD RATING (HL-93)

2 DESIGN LOAD RATING (HS-20)

3 LEGAL LOAD RATING \*\*\*

\*\*\* SEE CHART FOR VEHICLE TYPE

---

GIRDER LOCATION

I - INTERIOR GIRDER  
EL - EXTERIOR LEFT GIRDER  
ER - EXTERIOR RIGHT GIRDER

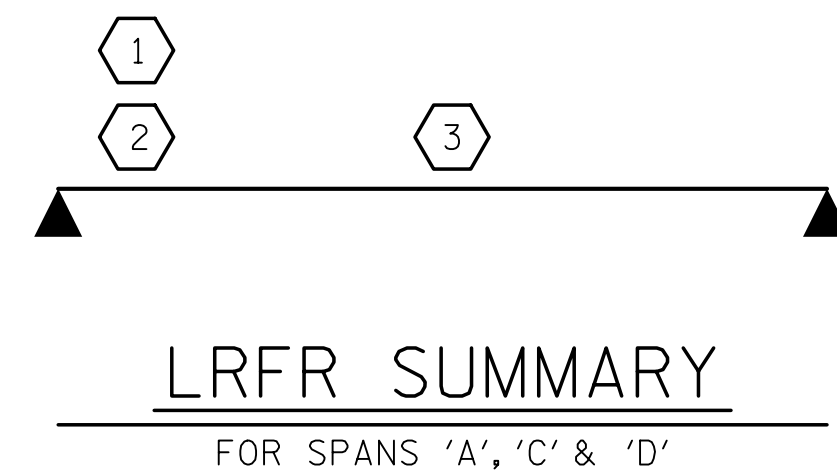

111 E. Hargett Street  
Suite 300  
Raleigh, NC 27601  
919-714-8670  
meadhunt.com  
NC License No. F-1235



DocuSigned by:  
Jack S. Hobson  
02/10/2021  
SEAL 043177  
ENGINEER  
DOCUMENT NOT CONSIDERED  
FINAL UNLESS ALL  
SIGNATURES COMPLETED

PROJECT NO. B-5619  
LENOIR COUNTY  
STATION: 23+06.50 -L-

SHEET 1 OF 2

STATE OF NORTH CAROLINA DEPARTMENT OF TRANSPORTATION RALEIGH					
STANDARD LRFR SUMMARY FOR 50' CORED SLAB UNIT 90° SKEW (NON-INTERSTATE TRAFFIC)					
REVISIONS					SHEET NO.
NO.	BY:	DATE:	NO.	BY:	DATE:
1			3		
2			4		
					TOTAL SHEETS 23

ASSEMBLED BY : D.J. CARTE DATE :12/08/20  
CHECKED BY : J.S. HOBSON DATE :12/29/20  
DRAWN BY : CVC 6/10  
CHECKED BY : DNS 6/10