

8/17/99

PROJECT REFERENCE NO. <i>B-5619</i>		SHEET NO. 4	
RW SHEET NO.		HYDRAULICS ENGINEER	
ROADWAY DESIGN ENGINEER		SEAL 21656	
DocuSigned by: <i>R S DeGolia</i> 03/18/2021		DocuSigned by: <i>Roger Wadon</i> 03/19/2021	
<b>DOCUMENT NOT CONSIDERED FINAL UNLESS ALL SIGNATURES COMPLETED</b>			
<b>Mead&amp;Hunt</b>		111 E. Hargett Street, Suite 300 Raleigh, North Carolina 27601 919-774-8870   mead@mh.com NC License No. F-1235	

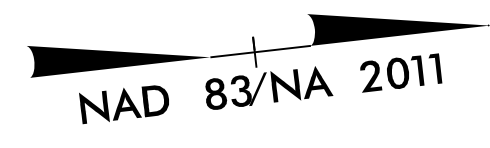

-L- CURVE DATA  
 PI Sta 13+65.31  
 $\Delta = 26^{\circ} 29' 00.0''$  (LT)  
 D = 3' 53' 04.1"  
 L = 681.78'  
 T = 347.09'  
 R = 1,475.00'

REVISIONS

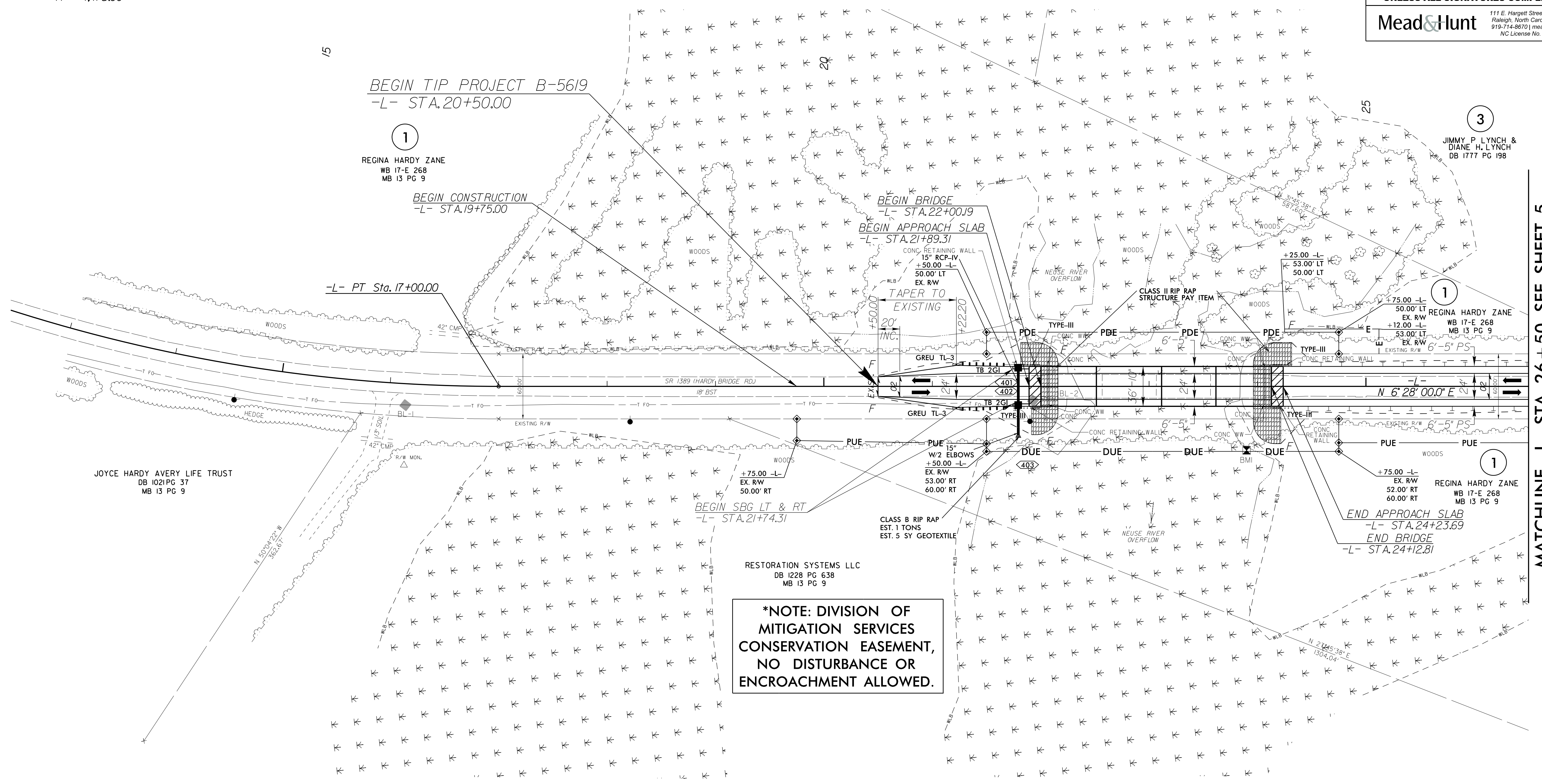

BEGIN TIP PROJECT B-5619  
 -L- STA.20+50.00

1  
 REGINA HARDY ZANE  
 WB 17-E 268  
 MB 13 PG 9

BEGIN CONSTRUCTION  
 -L- STA.19+75.00

-L- PT Sta. 17+00.00

BEGIN BRIDGE  
 -L- STA.22+00.19  
 BEGIN APPROACH SLAB  
 -L- STA.21+89.31

BEGIN SBG LT & RT  
 -L- STA.21+74.31

RESTORATION SYSTEMS LLC  
 DB 1228 PG 638  
 MB 13 PG 9

1  
 REGINA HARDY ZANE  
 WB 17-E 268  
 MB 13 PG 9

1  
 REGINA HARDY ZANE  
 WB 17-E 268  
 MB 13 PG 9

END APPROACH SLAB  
 -L- STA.24+23.69  
 END BRIDGE  
 -L- STA.24+12.81

**\*NOTE: DIVISION OF MITIGATION SERVICES CONSERVATION EASEMENT, NO DISTURBANCE OR ENCROACHMENT ALLOWED.**

3  
 JIMMY P. LYNCH &  
 DIANE H. LYNCH  
 DB 1777 PG 198

18-MAR-2021 07:36  
 R:\Roadway\Proj\B5619\_Rdy\_psh\_4.dgn  
 2/27/21

MATCHLINE -L- STA. 26 + 50 SEE SHEET 5

FOR -L- PROFILE, SEE SHEET 6



FOR STRUCTURE PLANS, SEE SHEET S2-1 THRU S2-23