

25% PLANS 11/29/18
DUKE ENERGY REV. PLANS ADDED: 4/15/19
MBB PLANS ADDED: 1/15/20
AT&T PLANS ADDED: 1/29/20
DOMINION ENERGY PLANS ADDED: 3/24/20
AT&T REV. POLE AT AIR SWITCH SITE 4/30/20
DOMINION ENERGY PLANS ADDED: 5/17/20
AT&T REV. PLANS ADDED: 6/11/20
NEW AT&T PLANS ADDED: 7/20/20

- 0701 TOP=2115.00
INV. IN=2111.50 (0706)
INV. OUT=2110.00 (0726)
- 0703 TOP=2116.50
INV. OUT=2113.2 (0725)
- 0705 TOP=2123.38
INV. OUT=2121.88 (0706)
- 0706 TOP=2123.50
INV. IN=2120.58 (0705)
INV. OUT=2120.08 (0701)
- 0707 TOP=2138.83
INV. IN=2134.82 (0708)
INV. OUT=2134.82 (0706)
- 0708 TOP=2138.32
INV. OUT=2134.90 (0707)
- 0709 PIPE INLET=2145.87
- 0710 PIPE OUTLET=2145.48
- 0711 TOP=2145.98
INV. OUT=2142.75 (0712)
- 0712 TOP=2146.23
INV. IN=2138.40 (0711)
INV. OUT=2138.40 (0714)
INV. OUT=2138.40 (0713)
- 0713 PIPE OUTLET=2137.98
- 0714 TOP=2147.47
INV. IN=2138.57 (0715)
INV. IN=2138.57 (0716)
INV. OUT=2138.57 (0712)
- 0715 TOP=2146.89
INV. IN=2141.08 (0717)
INV. OUT=2141.08 (0714)
- 0716 TOP=2142.05
INV. OUT=2138.72 (0714)
- 0717 TOP=2144.36
INV. IN=2141.19 (0718)
INV. OUT=2141.19 (0715)
- 0718 TOP=2144.91
INV. OUT=2141.74 (0717)
- 0719 TOP=2147.66
INV. OUT=2145.16 (0720)
- 0720 TOP=2146.14
INV. IN=2142.89 (0719)
INV. OUT=2142.89 (0722)
- 0721 INV.=2142.13 (0722)
- 0722 TOP=2144.68
INV. IN=2140.79 (07230)
INV. OUT=2140.79 (0801)
- 0723 TOP=2145.76
INV. IN=2140.63 (723A)
INV. OUT=2140.63 (0722)
- 0723A INV. IN=2141.25 (0724)
INV. OUT=2141.25 (07230)
- 0724 TOP=2145.43
INV. OUT=2142.18 (0723A)
- 0725 TOP=2150.50
INV. IN=2111.10 (0701)
INV. OUT=2111.10 (0618)
- 0726 PIPE INLET=2107.25
PIPE OUTLET=2107.00

- TOP=2124.28
INV=2118.28

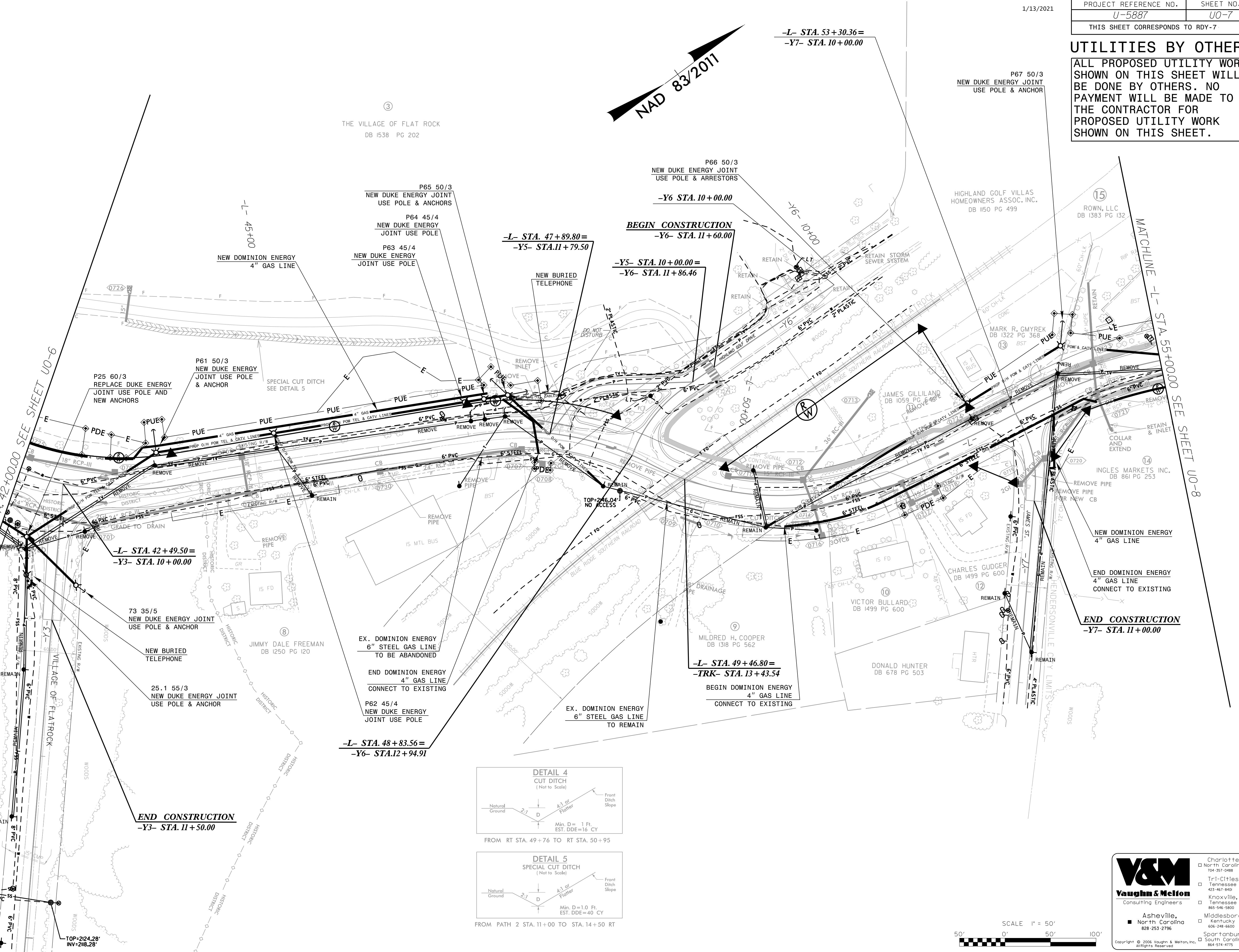

PROJECT REFERENCE NO. U-5887	SHEET NO. U0-7
THIS SHEET CORRESPONDS TO RDY-7	

UTILITIES BY OTHERS
ALL PROPOSED UTILITY WORK SHOWN ON THIS SHEET WILL BE DONE BY OTHERS. NO PAYMENT WILL BE MADE TO THE CONTRACTOR FOR PROPOSED UTILITY WORK SHOWN ON THIS SHEET.

MATCHLINE -L- STA. 42+00.00 SEE SHEET U0-6

MATCHLINE -L- STA. 55+00.00 SEE SHEET U0-8

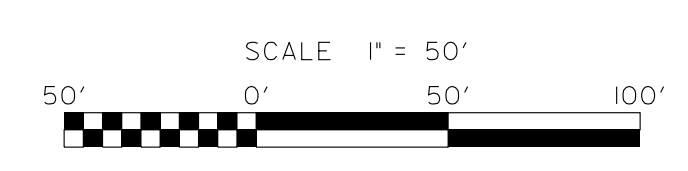
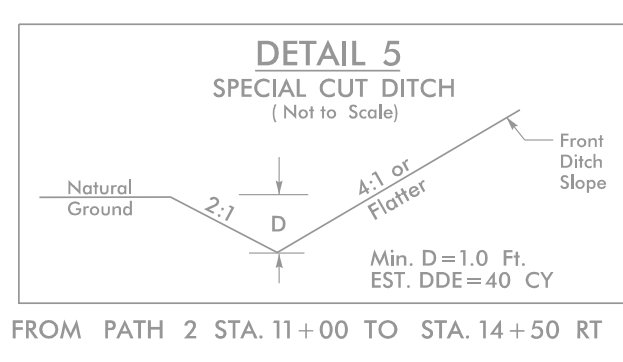
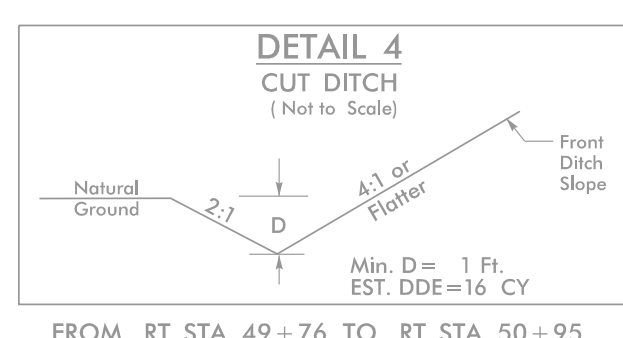

V&M
Vaughn & Melton
Consulting Engineers

Asheville, North Carolina 828-253-2796
Middleboro, Kentucky 606-248-6600
Spartanburg, South Carolina 864-574-4775

Charlotte, North Carolina 704-357-0488
Tri-Cities, Tennessee 423-461-9400
Knoxville, Tennessee 865-546-5800

Copyright © 2006 Vaughn & Melton, Inc. All Rights Reserved

TRANSPORTATION 31535-06 U-5887 UTILITIES U-5887-UTL-U07.DGN