

PROJECT REFERENCE NO. U-5887	SHEET NO. UC-4
DESIGNED BY: SSD	
DRAWN BY: BAB	
CHECKED BY: JDN	
APPROVED BY: JDN	
REVISED:	
NORTH CAROLINA DEPARTMENT OF TRANSPORTATION	
UTILITIES ENGINEERING SEC. PHONE: (919) 707-6690 FAX: (919) 1250-4151	
UTILITY CONSTRUCTION PLANS ONLY	

DOCUMENT NOT CONSIDERED FINAL UNTIL ALL SIGNATURES ARE COMPLETED  
UTILITY CONSTRUCTION

THE ESTIMATED QUANTITY OF DUCTILE IRON WATER PIPE FITTINGS ON THIS PLAN SHEET IS 1060 POUNDS. THE ACTUAL QUANTITY AND TYPE OF FITTINGS WILL VARY BASED ON FIELD CONDITIONS.

SUSAN T. RINDAL  
DB 1534 PG 601

BEGIN 8" WL CONSTRUCTION  
-WL-1- STA. 10+00.00=  
-L- STA. 9+75.26, 31.22 LT  
CONNECT TO EXISTING  
WL TEE

8" GATE VALVE  
-WL-1- STA. 10+13.00

AIR RELEASE & VACUUM VALVE  
-WL-1- STA. 10+90.00

8"x6" TEE  
6" GATE VALVE  
5 LF FIRE HYDRANT LEG  
FIRE HYDRANT  
-WL-1- STA. 11+34.64  
=-L- STA. 11+09.66

BEGIN WALL NOJ  
-L- STA. 11+25.00, 30' LT.  
-WALLI- STA. 10+00.00

END WALL NOJ  
-L- STA. 13+30.00, 19' LT.  
-WALLI- STA. 11+95.52

813 LF 8" WATER LINE  
DIP, PC 350

RECONNECT WATER METER  
48 LF 1" SERVICE LINE  
FIELD VERIFY

ABANDON 816 LF  
6" UTILITY PIPE

8"x6" TEE  
6" GATE VALVE  
FIRE HYDRANT  
5 LF FIRE HYDRANT LEG  
-WL-1- STA. 15+99.21  
=-L- STA. 15+86.03

MATCH LINE -L- STA 18+00.00  
SEE SHEET UC-5

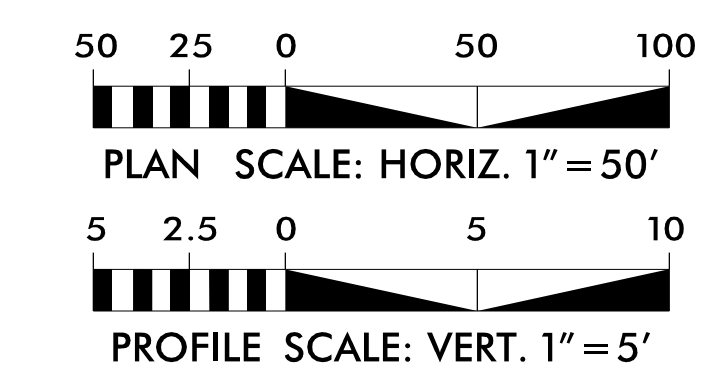

**V&M**  
Vaughn & Melton  
Consulting Engineers

Boone, NC 828-265-9933  
 Tri-Cities, TN 423-627-9400  
 Knoxville, TN 865-546-1800  
 Spartanburg, SC 864-574-4775  
 Charleston, SC 843-974-5650  
 Asheville, NC 828-253-2796  
 North Carolina 919-977-9405  
 Raleigh, NC 919-977-9405  
 Charlotte, NC 704-351-0488  
 Atlanta, GA 770-421-3009

Copyright © 2020 Vaughn & Melton, Inc. All Rights Reserved.

REVISIONS

### WATER LINE -WL-1- PROFILE

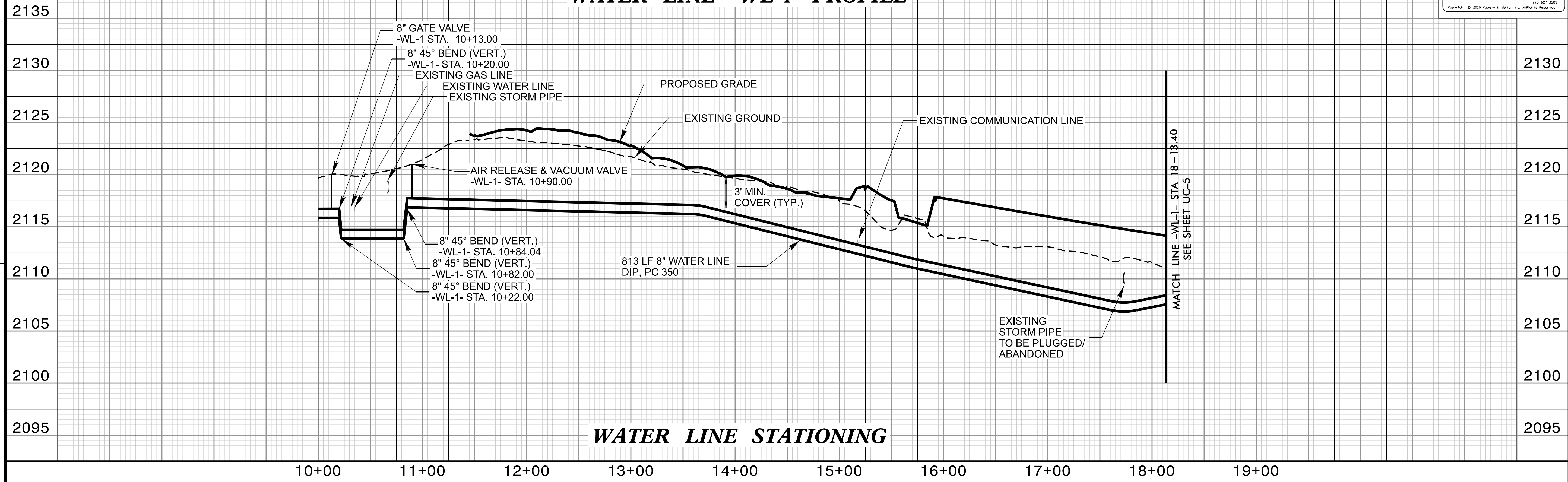

### WATER LINE STATIONING