

12/17/2023 10:58:55 AM U-5887-Env.EC12.dgn

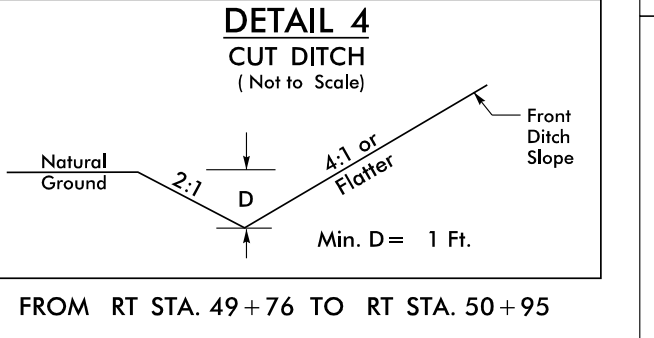
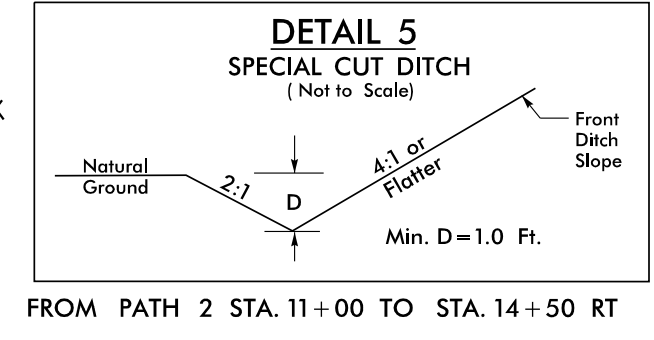
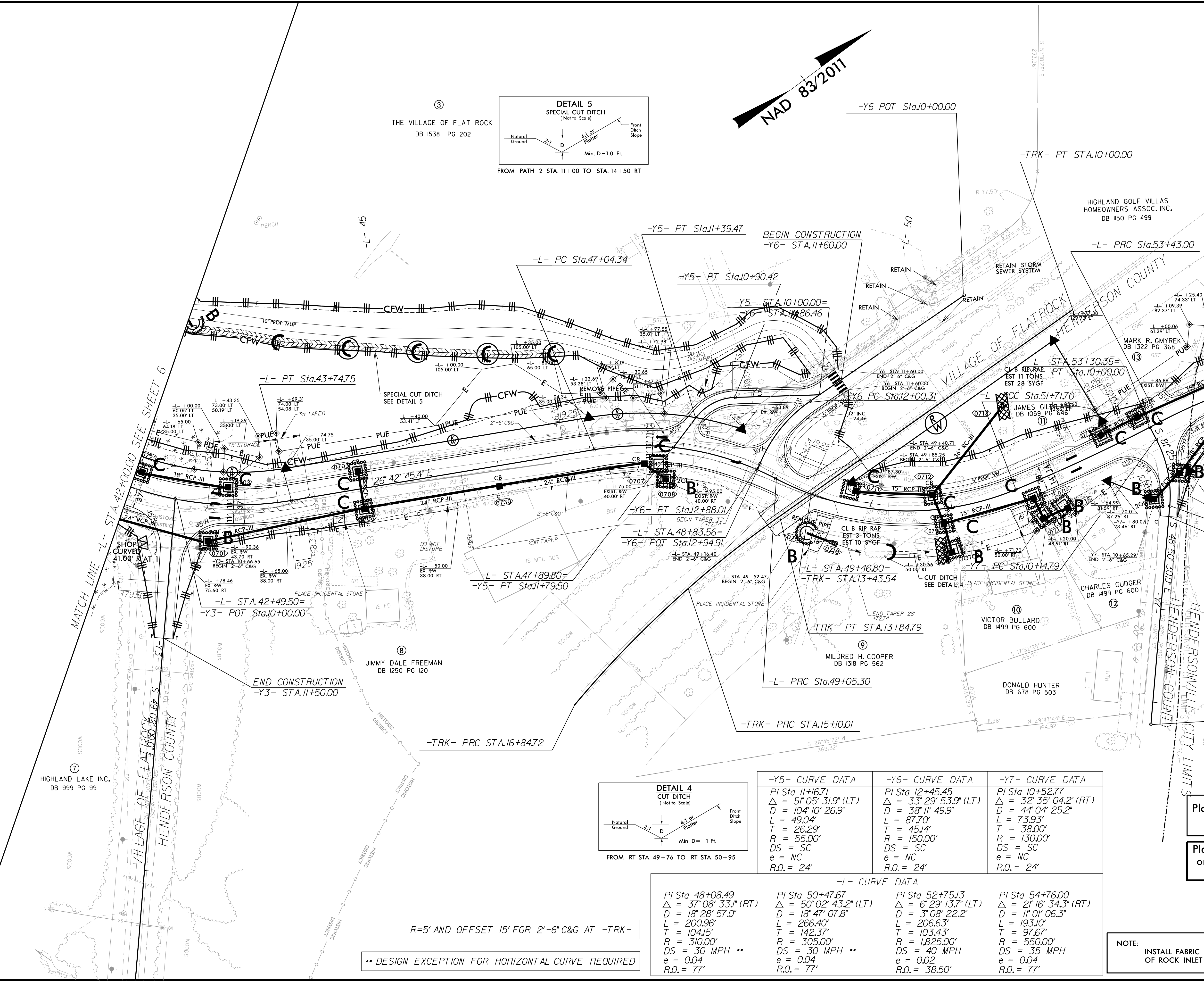

-Y5- CURVE DATA	-Y6- CURVE DATA	-Y7- CURVE DATA
PI Sta 11+16.71	PI Sta 12+45.45	PI Sta 10+52.77
$\Delta = 51^{\circ} 05' 31.9" (LT)$	$\Delta = 33^{\circ} 29' 53.9" (LT)$	$\Delta = 32^{\circ} 35' 04.2" (RT)$
$D = 104^{\circ} 10' 26.9"$	$D = 38^{\circ} 11' 49.9"$	$D = 44^{\circ} 04' 25.2"$
$L = 49.04'$	$L = 87.70'$	$L = 73.93'$
$T = 26.29'$	$T = 45.14'$	$T = 38.00'$
$R = 55.00'$	$R = 150.00'$	$R = 130.00'$
$DS = SC$	$DS = SC$	$DS = SC$
$e = NC$	$e = NC$	$e = NC$
$R.O. = 24'$	$R.O. = 24'$	$R.O. = 24'$

-L- CURVE DATA			
PI Sta 48+08.49	PI Sta 50+47.67	PI Sta 52+75.13	PI Sta 54+76.00
$\Delta = 37^{\circ} 08' 33.1" (RT)$	$\Delta = 50^{\circ} 02' 43.2" (LT)$	$\Delta = 6^{\circ} 29' 13.7" (LT)$	$\Delta = 2^{\circ} 16' 34.3" (RT)$
$D = 18^{\circ} 28' 57.0"$	$D = 18^{\circ} 47' 07.8"$	$D = 3^{\circ} 08' 22.2"$	$D = 1^{\circ} 01' 06.3"$
$L = 200.96'$	$L = 266.40'$	$L = 206.63'$	$L = 193.10'$
$T = 104.15'$	$T = 142.37'$	$T = 103.43'$	$T = 97.67'$
$R = 310.00'$	$R = 305.00'$	$R = 1,825.00'$	$R = 550.00'$
$DS = 30 MPH **$	$DS = 30 MPH **$	$DS = 40 MPH$	$DS = 35 MPH$
$e = 0.04$	$e = 0.04$	$e = 0.02$	$e = 0.04$
$R.O. = 77'$	$R.O. = 77'$	$R.O. = 38.50'$	$R.O. = 77'$

R=5' AND OFFSET 15' FOR 2'-6" C&G AT -TRK-

** DESIGN EXCEPTION FOR HORIZONTAL CURVE REQUIRED

FINAL GRADE EROSION CONTROL FOR CONSTRUCTION SHEET 07

Place Matting for Erosion Control on Slopes as Work Allows.

Place Matting for Erosion Control on Slopes Adjacent to Permitted Wetlands as Work Allows.

INSTALL MATTING FOR EROSION CONTROL IN THE PROPOSED DITCH LINE.

NOTE: INSTALL FABRIC INSERT INLET PROTECTION DEVICE IN LIEU OF ROCK INLET SEDIMENT TRAP TYPE 'C' AS DIRECTED.