

-PATH- CURVE DATA						-L- CURVE DATA	
PI Sta 10+47.80 Δ = 7° 35' 17.9" (LT) D = 7° 56' 55.5" L = 95.47' T = 47.80' R = 720.82'	PI Sta 11+46.85 Δ = 14° 47' 16.1" (RT) D = 14° 28' 14.3" L = 102.19' T = 51.38' R = 395.95'	PI Sta 12+13.96 Δ = 10° 15' 15.0" (RT) D = 31° 32' 20.5" L = 32.51' T = 16.30' R = 181.67'	PI Sta 13+25.14 Δ = 5° 23' 15.4" (LT) D = 4° 29' 16.5" L = 120.05' T = 60.07' R = 1,276.67'	PI Sta 14+19.79 Δ = 0° 54' 59.4" (RT) D = 1° 19' 18.8" L = 69.33' T = 34.67' R = 4,334.39'	PI Sta 14+73.67 Δ = 15° 12' 19.1" (LT) D = 39° 47' 48.2" L = 38.21' T = 19.22' R = 143.97'	PI Sta 25+51.45 Δ = 31° 13' 26.0" (RT) D = 7° 09' 43.1" L = 435.97' T = 223.54' DS = 40 MPH e = 0.04 R.O. = 77'	PI Sta 29+89.65 Δ = 5° 40' 53.6" (LT) D = 1° 15' 33.3" L = 451.19' T = 225.78' DS = 40 MPH e = 0.02 R.O. = 38.50'

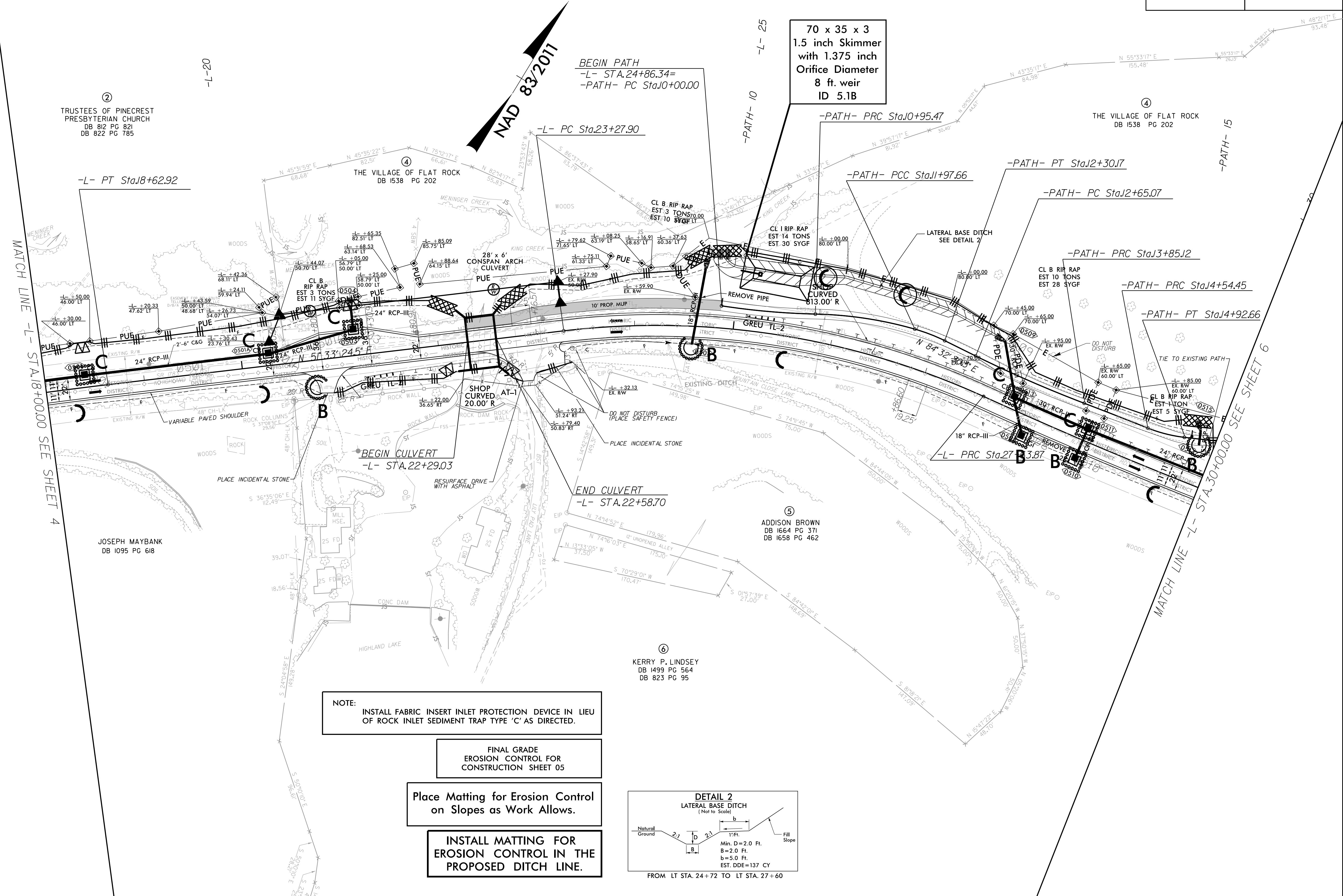

NOTE:
INSTALL FABRIC INSERT INLET PROTECTION DEVICE IN LIEU OF ROCK INLET SEDIMENT TRAP TYPE 'C' AS DIRECTED.

FINAL GRADE
EROSION CONTROL FOR
CONSTRUCTION SHEET 05

Place Matting for Erosion Control
on Slopes as Work Allows.

INSTALL MATTING FOR
EROSION CONTROL IN THE
PROPOSED DITCH LINE.

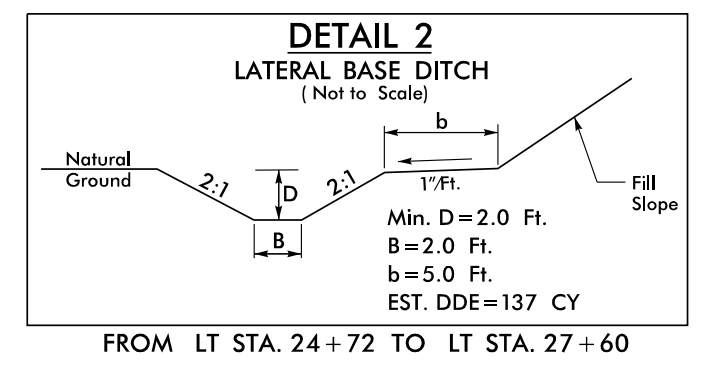

8/6/2020 11:21:28 PM U-5887-Env.EC10.dgn 5/14/99