

(A)

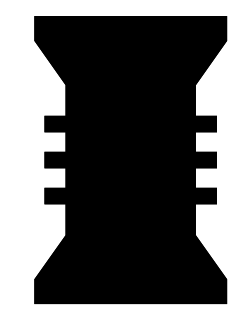

(B)

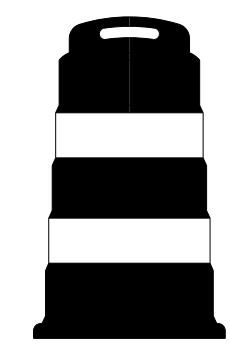

(C)

MESSAGE NO. 1	UTILITY WORK AHEAD	DATE
MESSAGE NO. 2	CHANGEABLE MESSAGE SIGN	DATE

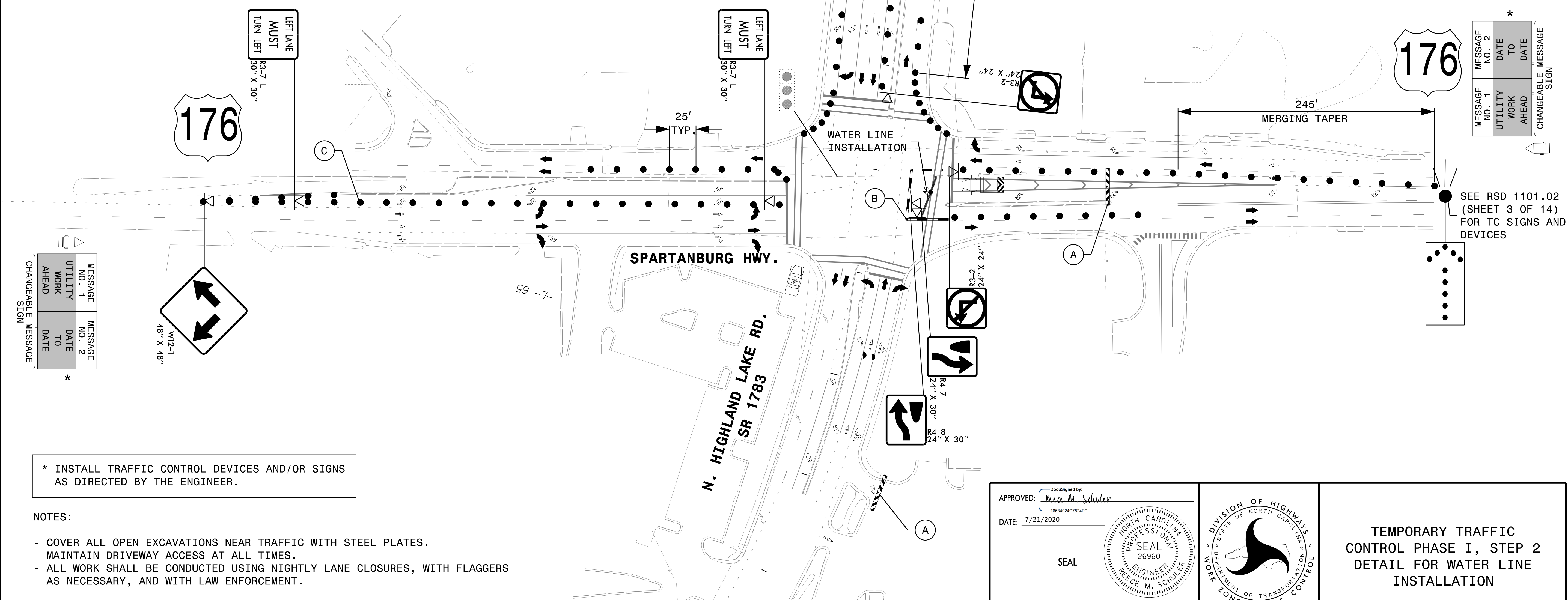

MESSAGE NO. 1	UTILITY WORK AHEAD	DATE
MESSAGE NO. 2	CHANGEABLE MESSAGE SIGN	DATE

\* INSTALL TRAFFIC CONTROL DEVICES AND/OR SIGNS AS DIRECTED BY THE ENGINEER.

NOTES:

- COVER ALL OPEN EXCAVATIONS NEAR TRAFFIC WITH STEEL PLATES.
- MAINTAIN DRIVEWAY ACCESS AT ALL TIMES.
- ALL WORK SHALL BE CONDUCTED USING NIGHTLY LANE CLOSURES, WITH FLAGGERS AS NECESSARY, AND WITH LAW ENFORCEMENT.

MESSAGE NO. 1	UTILITY WORK AHEAD	DATE
MESSAGE NO. 2	CHANGEABLE MESSAGE SIGN	DATE

SEE RSD 1101.02 (SHEET 3 OF 14) FOR TC SIGNS AND DEVICES

APPROVED: *Reece M. Schuler*  
 DATE: 7/21/2020

SEAL

DOCUMENT NOT CONSIDERED FINAL UNLESS ALL SIGNATURES COMPLETED



TEMPORARY TRAFFIC CONTROL PHASE I, STEP 2  
 DETAIL FOR WATER LINE INSTALLATION

7/21/2020 V:\Asheville\Transportation\31535-06 U-5887\TrafficControl\TCP\U5887\_TMP\_SHEET3B.dgn User:tcjmar-tell