

B.17/199

**-L- CURVE DATA**

PI Sta 20+65.38  
Δ = 23° 31' 00.6" (RT)  
D = 2' 17" 30.6"  
L = 1,026.12'  
T = 520.38'  
R = 2,500.00'  
SE = .05  
Ds = 60 mph

**-YI- CURVE DATA**

PI Sta 10+98.66  
Δ = 56° 59' 18.3" (RT)  
D = 44' 04" 25.2"  
L = 129.30'  
T = 70.57'  
R = 130.00'

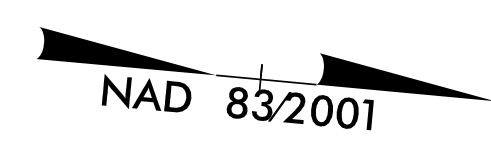

PROJECT REFERENCE NO. B-4407	SHEET NO. 4
RW SHEET NO.	
ROADWAY DESIGN ENGINEER SEAL 26960 3/26/2021	HYDRAULICS ENGINEER SEAL 033023 3/26/2021
DOCUMENT NOT CONSIDERED FINAL UNLESS ALL SIGNATURES COMPLETED	

SEE SHEET 7 FOR -L- PROFILE

REVISIONS

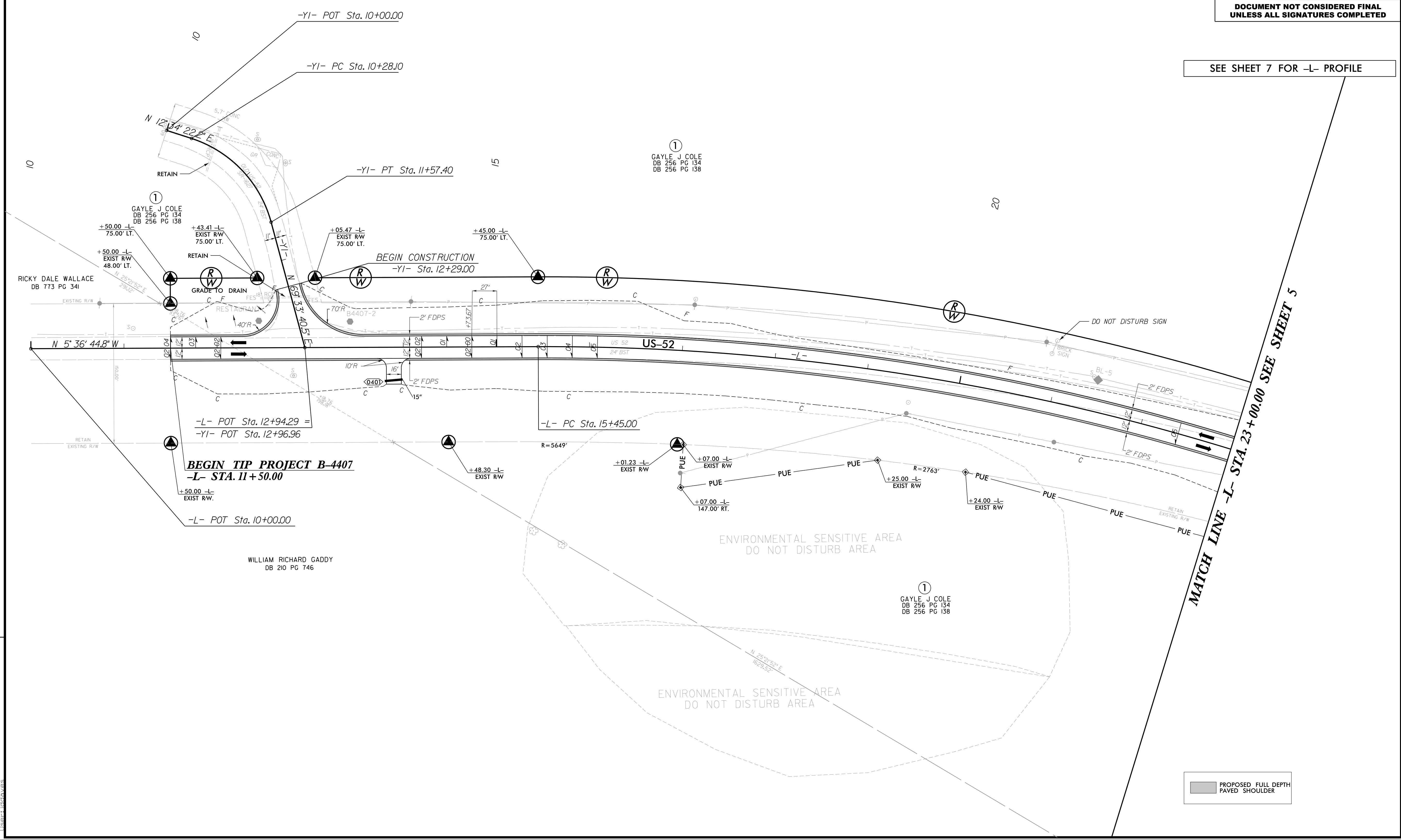

MATCH LINE -L- STA. 23+00.00 SEE SHEET 5

PROPOSED FULL DEPTH PAVED SHOULDER

2/23/2021 8:43:37 AM  
C:\Users\B4407\OneDrive\Documents\B4407\pesh\_04.dgn

WILLIAM RICHARD GADDY  
DB 210 PG 746

1  
GAYLE J COLE  
DB 256 PG 134  
DB 256 PG 138

1  
GAYLE J COLE  
DB 256 PG 134  
DB 256 PG 138