

TRANSVERSE CONSTRUCTION JOINT DETAIL

NOTE: REINFORCING STEEL IN SLAB NOT SHOWN. LONGITUDINAL REINFORCING STEEL SHALL BE CONTINUOUS THRU JOINT

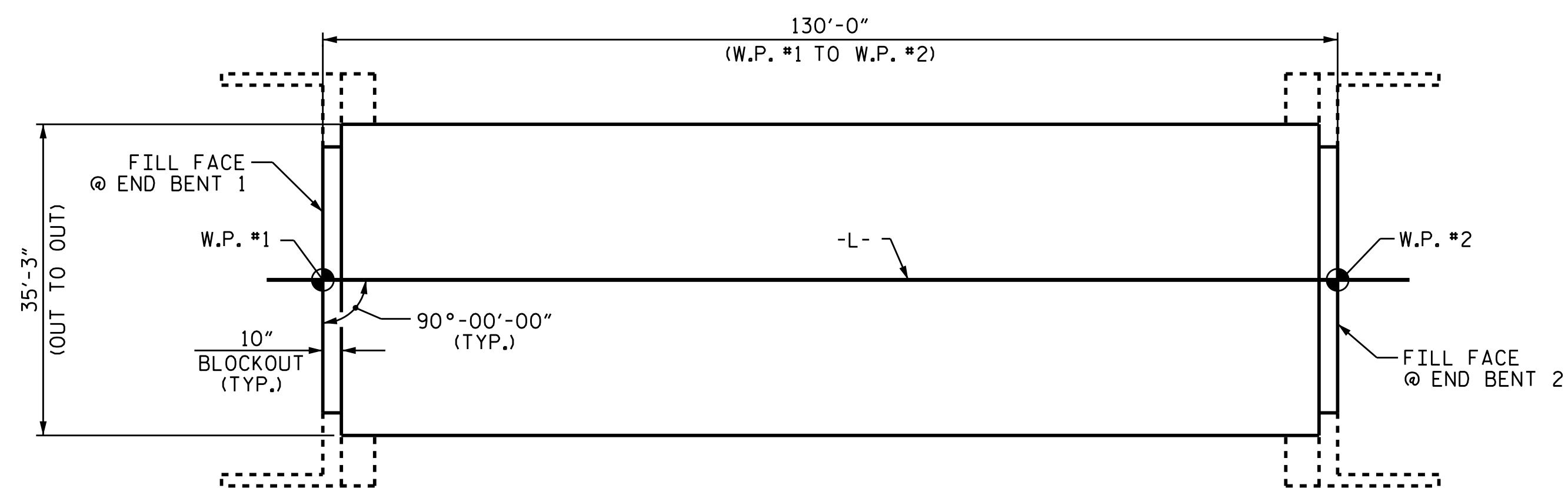

LAYOUT FOR COMPUTING AREA REINFORCED CONCRETE DECK SLAB
(SQ. FT. = 4,524)

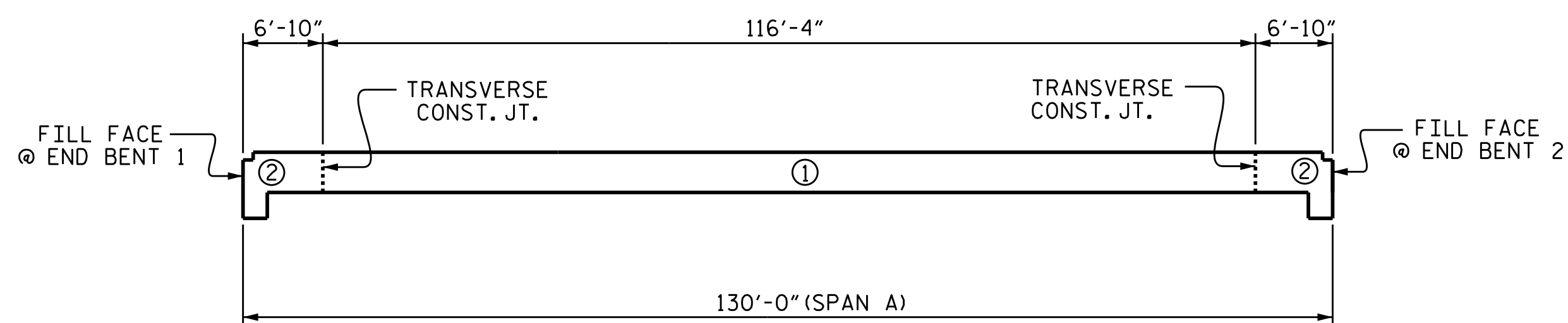

POUR SEQUENCE

BILL OF MATERIAL					
BAR	NO.	SIZE	TYPE	LENGTH	WEIGHT
* A1	205	#5	STR	34'-11"	7466
A2	205	#5	STR	34'-11"	7466
* B1	186	#5	STR	26'-0"	5044
* B2	72	#4	STR	28'-3"	1359
B3	66	#5	STR	44'-0"	3029
K1	14	#4	STR	34'-11"	327
K2	4	#4	STR	2'-10"	8
K3	20	#4	STR	3'-8"	49
K4	4	#4	STR	2'-0"	5
K5	6	#4	STR	6'-6"	26
K6	30	#4	STR	8'-1"	162
K7	6	#4	STR	5'-1"	20
* S1	44	#4	1	11'-10"	348
* S2	44	#4	1	11'-11"	350
U1	38	#4	2	13'-11"	353
U2	16	#4	2	12'-1"	129
REINFORCING STEEL				LBS.	11,574
* EPOXY COATED REINFORCING STEEL				LBS.	14,567

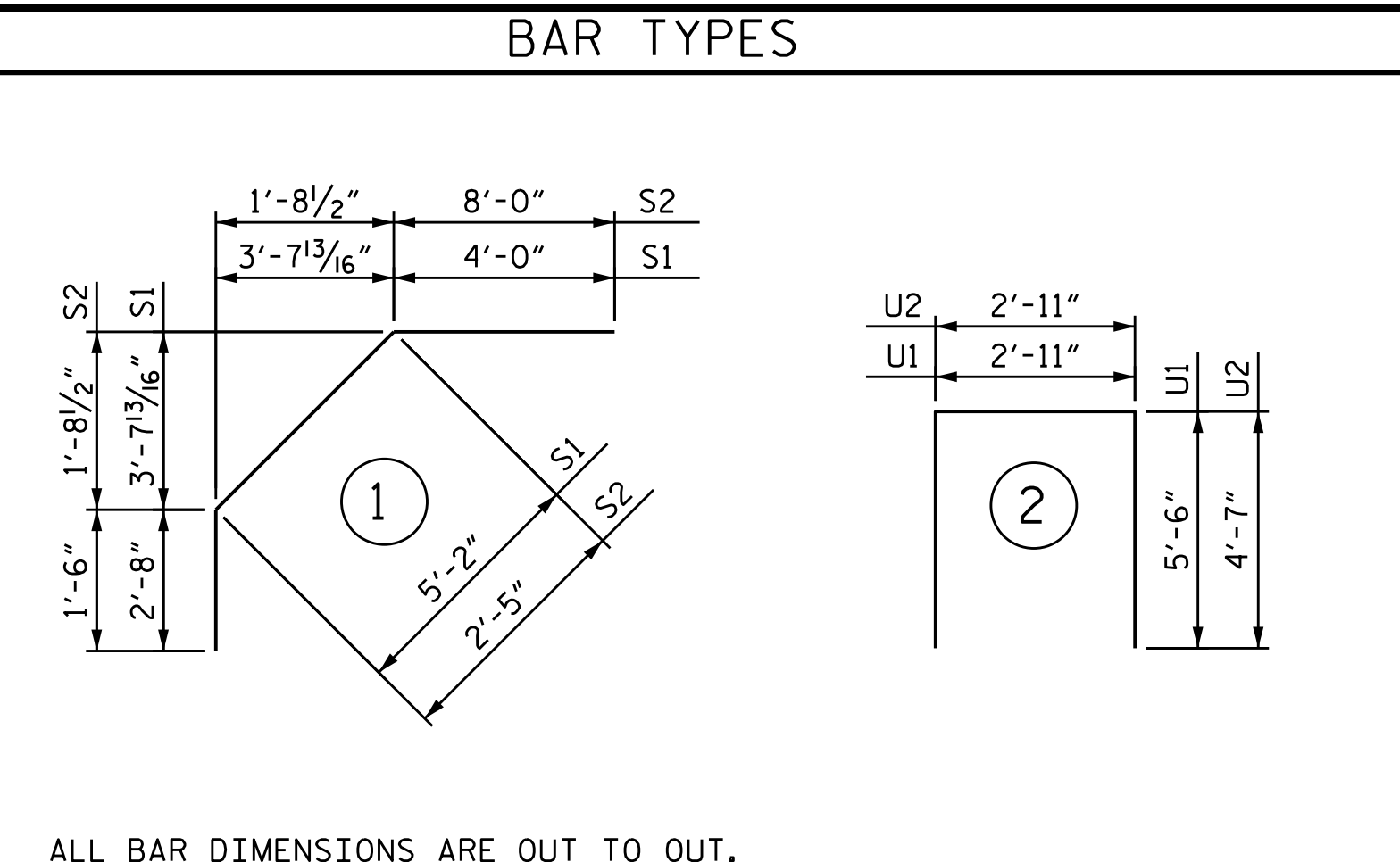

ALL BAR DIMENSIONS ARE OUT TO OUT.

SUPERSTRUCTURE REINFORCING STEEL LENGTHS ARE BASED ON THE FOLLOWING MINIMUM SPLICE LENGTHS

BAR SIZE	SUPERSTRUCTURE EXCEPT APPROACH SLABS, PARAPETS, AND BARRIER RAILS		APPROACH SLABS		PARAPETS AND BARRIER RAILS
	EPOXY COATED	UNCOATED	EPOXY COATED	UNCOATED	
#4	1'-11"	1'-7"	1'-11"	1'-7"	2'-6"
#5	2'-5"	2'-0"	2'-5"	2'-0"	3'-1"
#6	2'-10"	2'-5"	3'-7"	2'-5"	3'-8"
#7	4'-2"	2'-9"			
#8	4'-9"	3'-2"			

—SUPERSTRUCTURE BILL OF MATERIAL—			
	CLASS AA CONCRETE	REINFORCING STEEL	EPOXY COATED REINFORCING STEEL
	(CU. YDS.)	(LBS.)	(LBS.)
POUR #1	134.5		
POUR #2	62.2	11,574	14,567
TOTALS	196.7	11,574	14,567

GROOVING BRIDGE FLOORS

APPROACH SLABS	841 SQ.FT.
BRIDGE DECK	3722 SQ.FT.
TOTAL	4563 SQ.FT.

PROJECT NO. B-5818
ANSON COUNTY
 STATION: 27+79.00 -L-

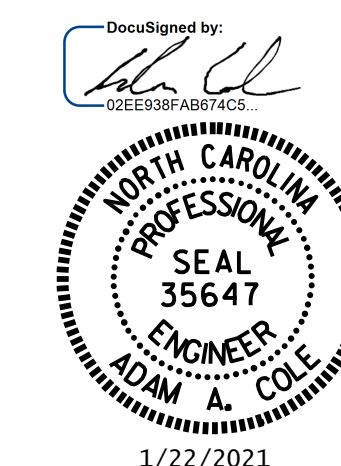

STATE OF NORTH CAROLINA
 DEPARTMENT OF TRANSPORTATION
 RALEIGH
 SUPERSTRUCTURE
 BILL OF MATERIAL

DRAWN BY : M. G. SHAIKH DATE: 01/2020
 CHECKED BY : H. LOCKLEAR DATE: 02/2020
 DESIGN ENGINEER OF RECORD : REZA KAUCHEKI DATE: 11/2019

REVISIONS						SHEET NO.
NO.	BY:	DATE:	NO.	BY:	DATE:	S-15
1			3			TOTAL SHEETS
2			4			24