

RIGHT ANGLE SECTION OF BARREL
LEFT EXTENSION - PHASE I (LOOKING DOWNSTREAM)
 THERE ARE 63 "C" BARS IN SECTION OF BARREL

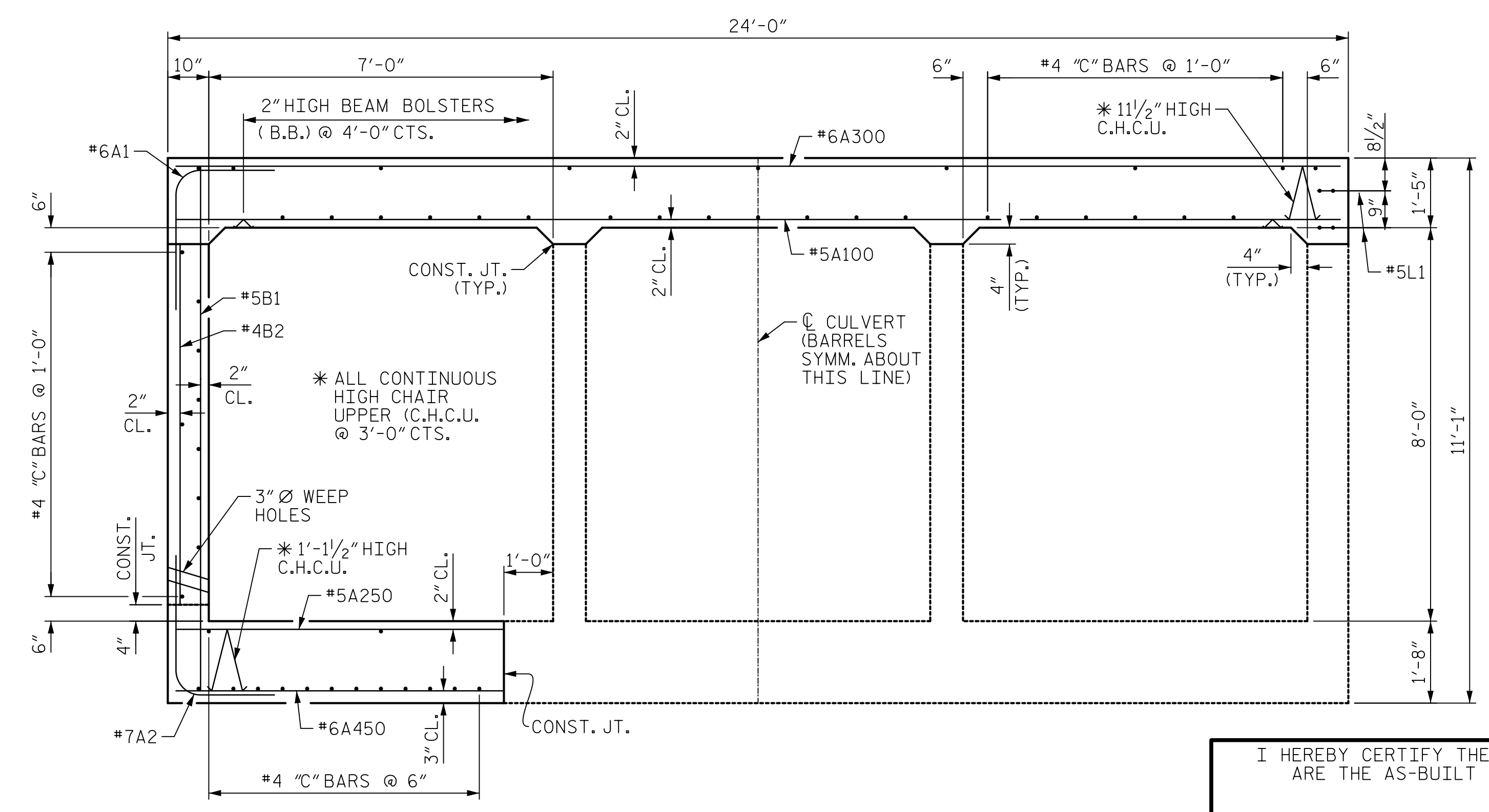

RIGHT ANGLE SECTION OF BARREL
LEFT EXTENSION - PHASE II (LOOKING DOWNSTREAM)
 THERE ARE 51 "C" BARS IN SECTION OF BARREL

I HEREBY CERTIFY THESE PLANS ARE THE AS-BUILT PLANS

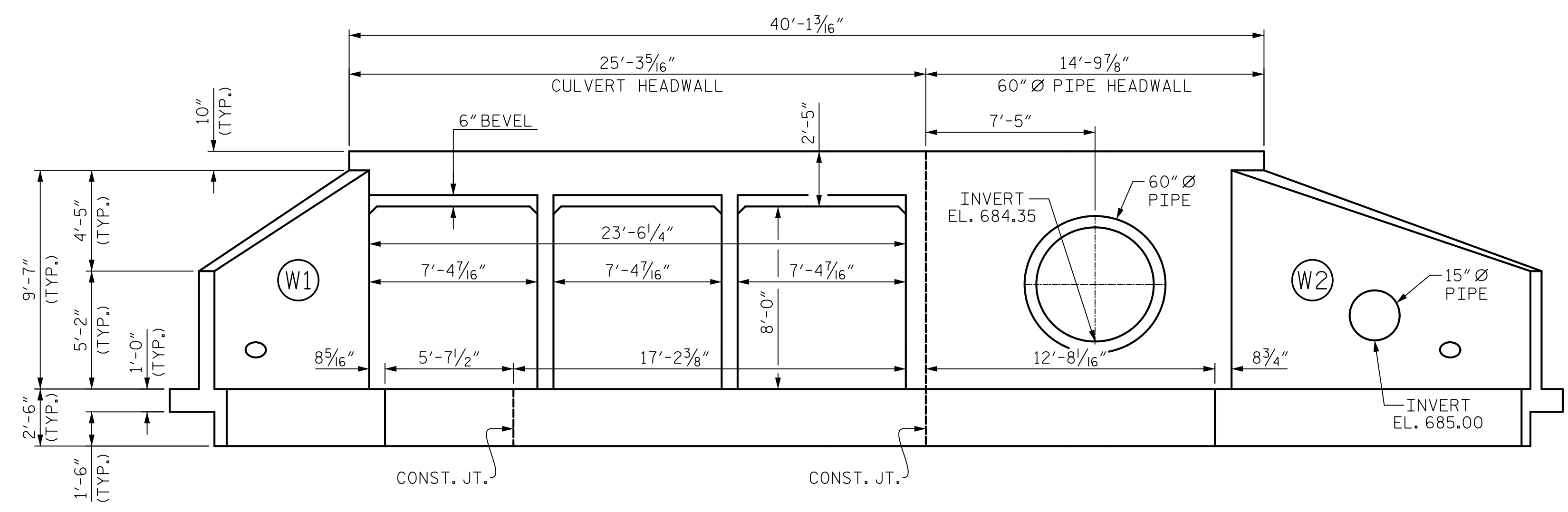

LEFT END ELEVATION NORMAL TO SKEW
(LOOKING DOWNSTREAM)

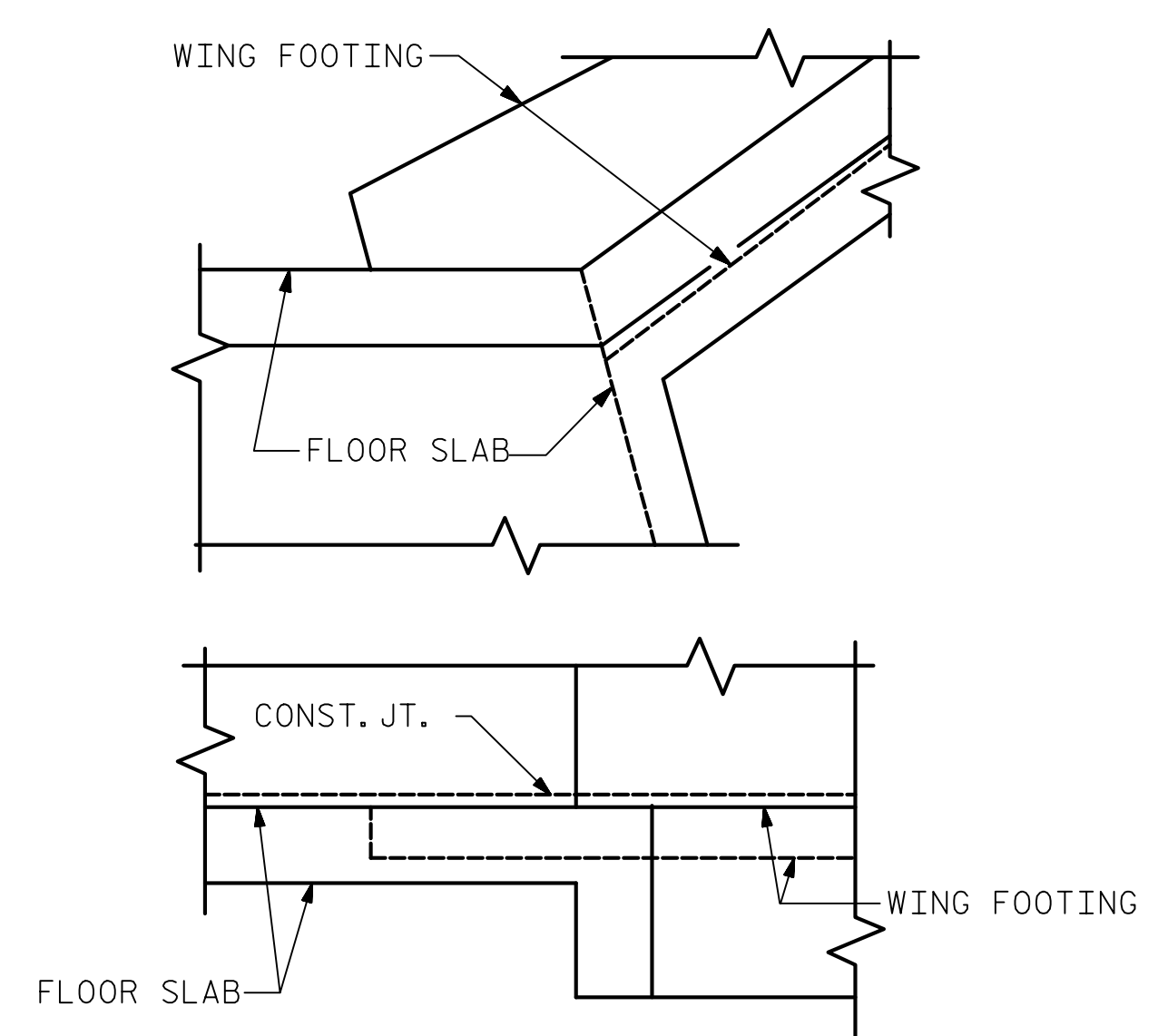

DETAIL
CONNECTION OF WING FOOTING AND FLOOR SLAB WHEN SLAB IS THICKER THAN FOOTING

Mead & Hunt
 111 E. Hargett Street
 Suite 300
 Raleigh, NC 27601
 919-714-8670
 meadhunt.com
 NC License No. F-1235

SEAL
 043177
 ENGINEER
 JOHN S. HOBSON
 Jack Hobson
 4/16/2020
 DOCUMENT NOT CONSIDERED FINAL UNLESS ALL SIGNATURES COMPLETED

PROJECT NO. R-4707
GUILFORD COUNTY
 STATION: 56+34.85 -L-
 SHEET 2 OF 16

STATE OF NORTH CAROLINA
 DEPARTMENT OF TRANSPORTATION
 RALEIGH
TRIPLE 7 FT. x 8 FT. REINFORCED CONCRETE BOX CULVERT
 (LEFT EXTENSION)

DRAWN BY : J.S. HOBSON DATE : 03/28/19
 CHECKED BY : J.A. LEE DATE : 04/15/19
 DESIGN ENGINEER OF RECORD : J.S. HOBSON DATE : 04/26/19

REVISIONS						SHEET NO.
NO.	BY:	DATE:	NO.	BY:	DATE:	C1-10
1			3			TOTAL SHEETS
2			4			24