

PHASING DIAGRAM

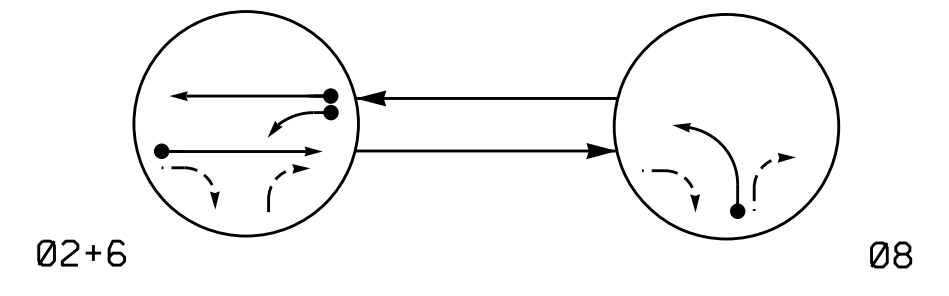

PHASING DIAGRAM DETECTION LEGEND

- ←● DETECTED MOVEMENT
- ← UNDETECTED MOVEMENT (OVERLAP)
- UNSIGNALIZED MOVEMENT
- ←--- PEDESTRIAN MOVEMENT

TABLE OF OPERATION

SIGNAL FACE	PHASE		
	02+6	08	LEAVE
21, 22	G	R	Y
61	F	R	Y
62, 63	G	R	Y
81, 82	R	Y	R

OASIS 2070 LOOP & DETECTOR INSTALLATION CHART

LOOP	SIZE (FT)	DISTANCE FROM STOPBAR (FT)	TURNS	NEW LOOP	DETECTOR PROGRAMMING							
					PHASE	CALLING	EXTENSION	FULL TIME DELAY	STRETCH TIME	DELAY TIME	SYSTEM LOOP	NEW CARD
2A/S3	6X6	300	5	-	2	Y	Y	-	-	-	Y	-
6A/S4	6X6	300	5	-	6	Y	Y	-	-	-	Y	-
6B	6X40	0	2-4-2	-	6	Y	Y	Y	-	3	-	-
8A	6X40	0	2-4-2	-	8	Y	Y	-	-	-	-	-

2 Phase
Fully Actuated
SR 2526 (Summit Avenue) CLS

NOTES

- Refer to "Roadway Standard Drawings NCDOT" dated January 2018 and "Standard Specifications for Roads and Structures" dated January 2018.
- Do not program signal for late night flashing operation unless otherwise directed by the Engineer.
- Set all detector units to presence mode.
- Maximum times shown in timing chart are for free-run operation only. Coordinated signal system timing values supersede these values.
- Closed loop system data: Controller Asset #: 1533.

SIGNAL FACE I.D.

All Heads L.E.D.

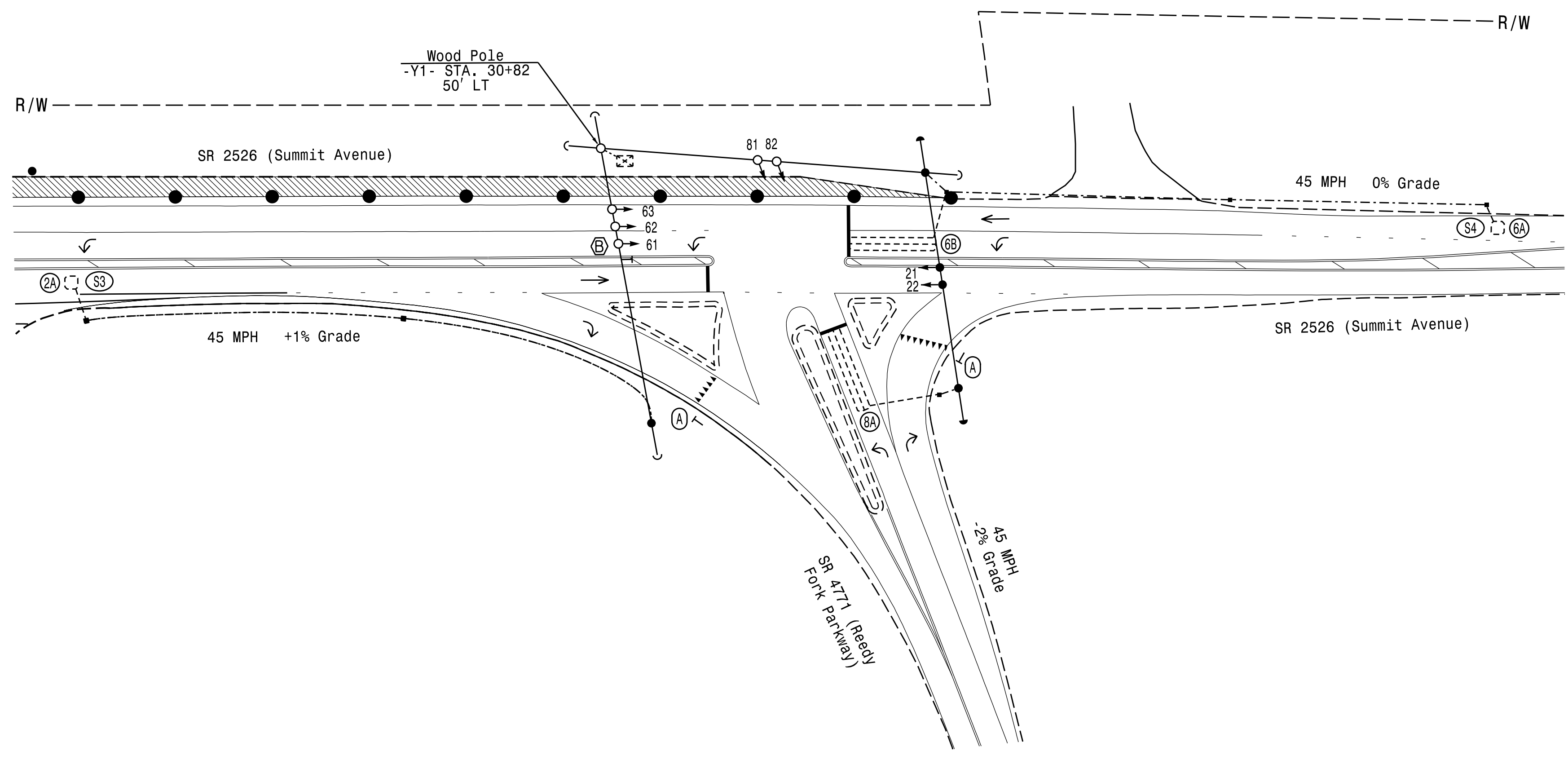
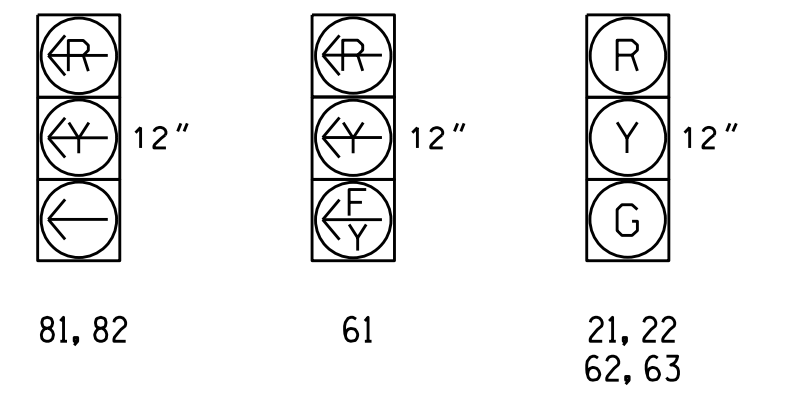

OASIS 2070 TIMING CHART

FEATURE	PHASE		
	2	6	8
Min. Green 1 *	12	12	7
Extension 1 *	6.0	6.0	2.0
Max Green 1 *	60	60	35
Yellow Clearance	4.5	4.5	3.3
Red Clearance	1.0	1.0	2.1
Red Revert	2.0	2.0	2.0
Walk 1 *	-	-	-
Don't Walk 1	-	-	-
Seconds Per Actuation *	2.5	2.5	-
Max Variable Initial *	34	34	-
Time Before Reduction *	15	15	-
Time To Reduce *	30	30	-
Minimum Gap	3.0	3.0	-
Recall Mode	MIN RECALL	MIN RECALL	-
Vehicle Call Memory	YELLOW	YELLOW	-
Dual Entry	-	-	-
Simultaneous Gap	ON	ON	ON

* These values may be field adjusted. Do not adjust Min Green and Extension times for phases 2 and 6 lower than what is shown. Min Green for all other phases should not be lower than 4 seconds.

LEGEND

- | PROPOSED | | EXISTING |
|----------|--|----------|
| ○ | Traffic Signal Head | ● |
| ● | Modified Signal Head | N/A |
| — | Sign | — |
| ⊞ | Pedestrian Signal Head With Push Button & Sign | ⊞ |
| ○ | Signal Pole with Guy | ● |
| ○ | Signal Pole with Sidewalk Guy | ● |
| ⊞ | Inductive Loop Detector | ⊞ |
| ⊞ | Controller & Cabinet | ⊞ |
| □ | Junction Box | ■ |
| --- | 2-in Underground Conduit | --- |
| N/A | Right of Way | --- |
| → | Directional Arrow | → |
| ▨ | Construction Zone | N/A |
| ● | Construction Barrel | N/A |
| Ⓐ | "YIELD" Sign (R1-2) | Ⓐ |
| Ⓟ | Left Arrow "ONLY" Sign (R3-5L) | Ⓟ |

Signal Upgrade
Temporary Design 1 (TMP Phase I - Step 2)

DOCUMENT NOT CONSIDERED FINAL UNLESS ALL SIGNATURES COMPLETED

Project #: 180914

DAVENPORT

HOME OFFICE:
119 BROOKSTOWN AVENUE, SUITE PH1
WINSTON-SALEM, NC 27101
336.744.1636 www.davenportworld.com
NCBELS FIRM LICENSE NO. C-2522

	SR 2526 (Summit Avenue) at SR 4771 (Reedy Fork Parkway)		
	Division 7 Guilford County Greensboro	PLAN DATE: April 2020	
PREPARED BY: A. Hayes	REVIEWED BY:	REVISIONS	INIT. DATE
SCALE: 1" = 40'	DocuSigned by: R. Royal Hinshaw	DATE: 4/20/2020	SIG. INVENTORY NO. 07-153311