

PROJECT REFERENCE NO.	SHEET NO.
R-4707	EC-6B/CONST.06
RW SHEET NO.	
ROADWAY DESIGN ENGINEER	HYDRAULICS ENGINEER

CULVERT CONSTRUCTION SEQUENCE STA. 46+08 -Y-

PHASE I

1. Construct Stilling Basin #3, Diversion Channel, and Impervious Dikes H and I.
 2. Pump Effluent into Stilling Basin and divert flow to Diversion Channel.
- Note: Upstream Diversion into existing stream in place from construction of previous culvert.

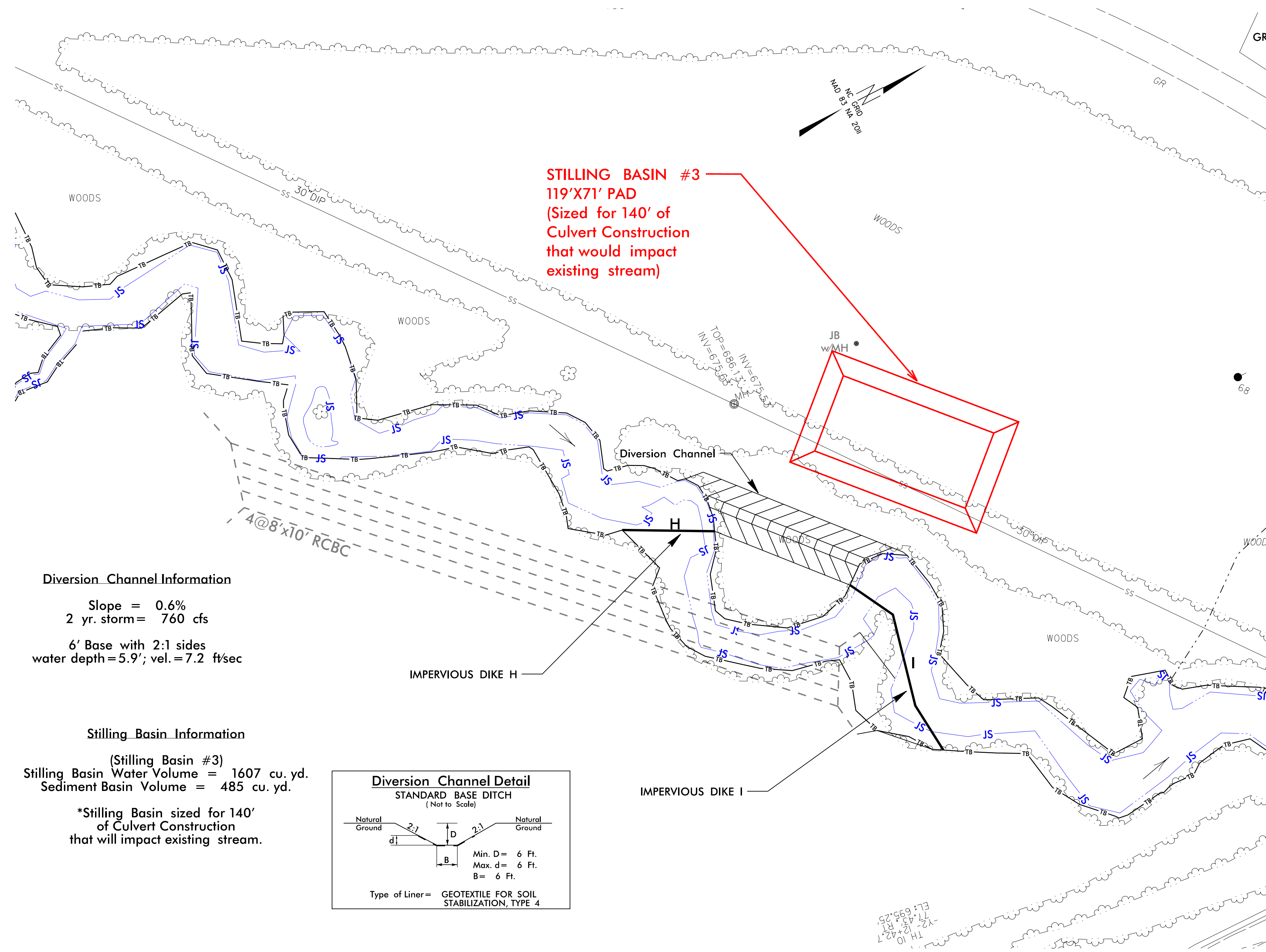

Diversion Channel Information

Slope = 0.6%
 2 yr. storm = 760 cfs
 6' Base with 2:1 sides
 water depth = 5.9'; vel. = 7.2 ft/sec

Stilling Basin Information

(Stilling Basin #3)
 Stilling Basin Water Volume = 1607 cu. yd.
 Sediment Basin Volume = 485 cu. yd.

*Stilling Basin sized for 140' of Culvert Construction that will impact existing stream.

