

5/14/99

PROJECT REFERENCE NO. U-2579BA	SHEET NO. EC-5A/CONST.5
ROADWAY DESIGN ENGINEER	HYDRAULICS ENGINEER

CULVERT CONSTRUCTION SEQUENCE STA. 45 + 63.83 -Y4- 3 @ 8' X 9' RCBC EXTENSION

PHASE 1

- 1.) UTILIZE SPECIAL STILLING BASIN(S) AS NEEDED THROUGHOUT CULVERT CONSTRUCTION.
- 2.) CONSTRUCT IMPERVIOUS DIKES 1 AND 2, DIVERTING FLOW THROUGH BARREL 1.
- 3.) CONSTRUCT PROPOSED 8' X 9' RCBC CULVERT EXTENSIONS FOR BARRELS 2 AND 3.
- 4.) REMOVE IMPERVIOUS DIKES 1 AND 2 AFTER DOWNSTREAM IMPROVEMENTS HAVE BEEN MADE

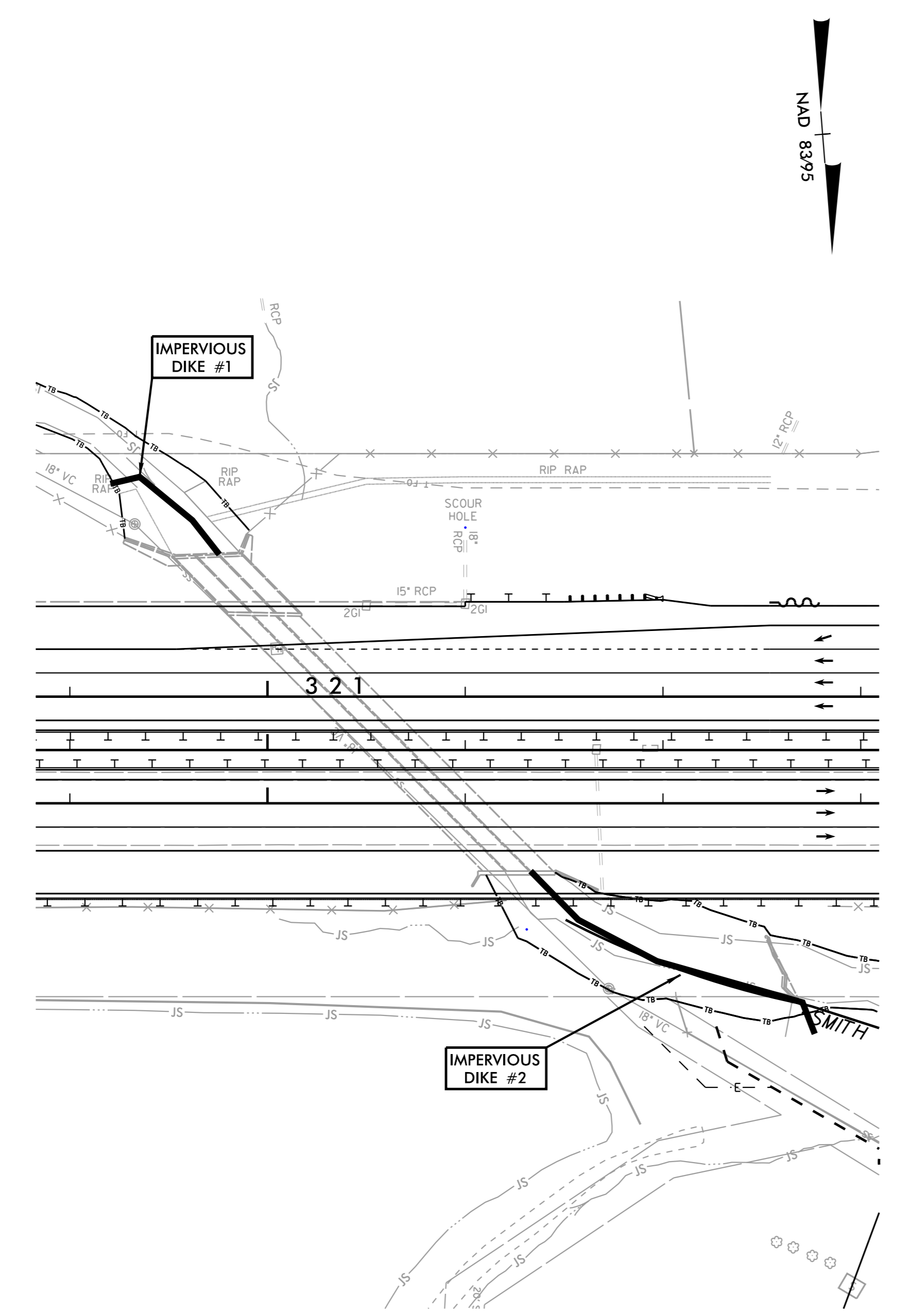

PHASE 2

- 5.) CONSTRUCT IMPERVIOUS DIKES 3 AND 4, DIVERTING FLOW THROUGH COMPLETED BARRELS 2 AND 3.
- 6.) CONSTRUCT PROPOSED 8' X 9' RCBC CULVERT EXTENSIONS FOR BARREL 1.
- 7.) REMOVE IMPERVIOUS DIKES 3 AND 4 AFTER DOWNSTREAM IMPROVEMENTS HAVE BEEN MADE, ALLOWING NORMAL FLOW THROUGH CULVERT.

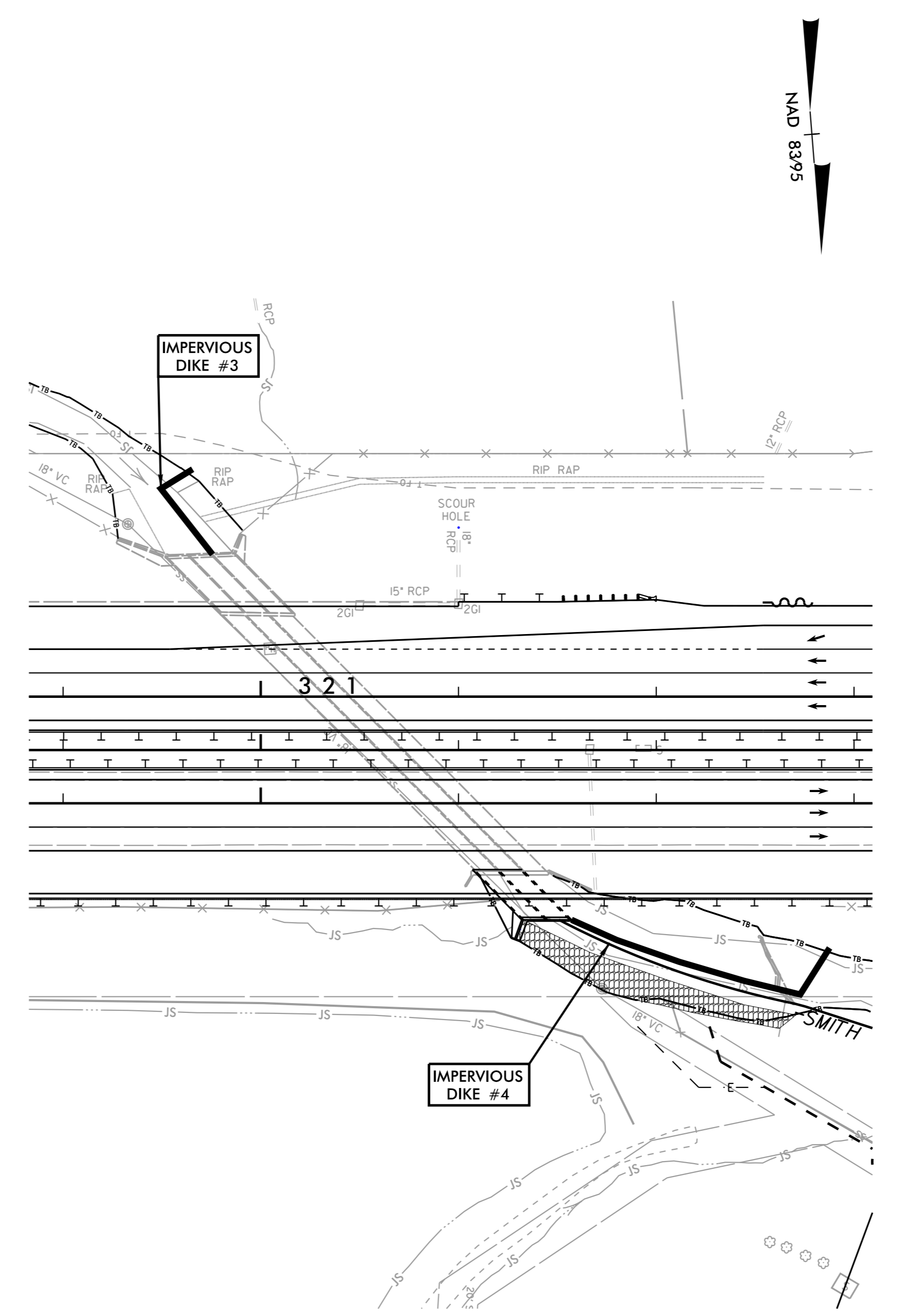

PHASE 3

- 8.) REMOVE ANY REMAINING SPECIAL STILLING BASIN(S).
- 9.) CONSTRUCT OUTLET CHANNEL IMPROVEMENTS ALONGSIDE STREAM RELOCATION.
- 11.) COMPLETE ROADWAY AND DRAINAGE IMPROVEMENTS.

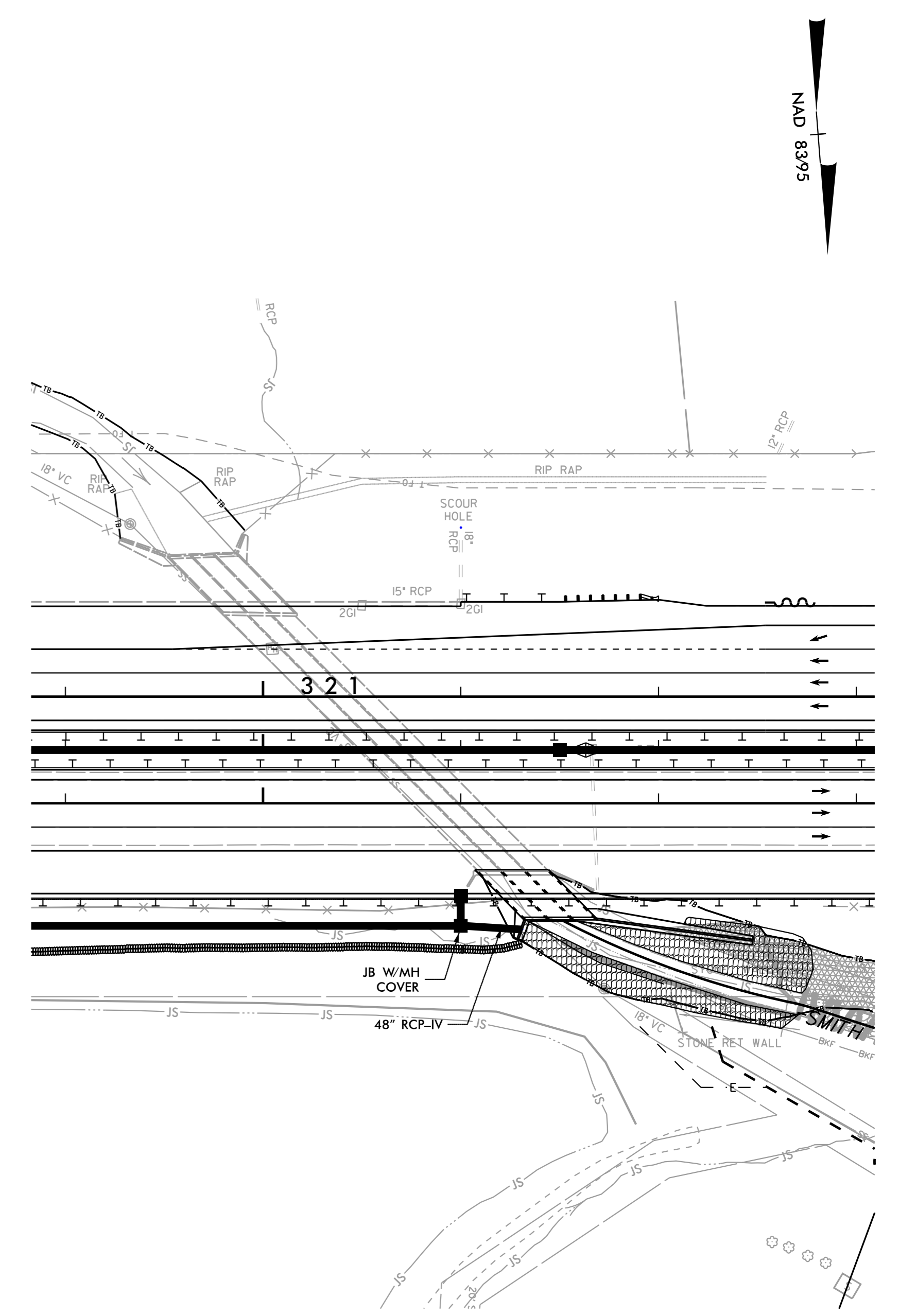

2/3/2020