

BEGIN CONSTRUCTION
 -Y4EB- POT Sta. 23+50.00
 -Y4WB- POT Sta. 23+50.00
 TIE TO EXIST PAVEMENT

RESET EXISTING PORTABLE CONCRETE BARRIER
 UPON COMPLETION OF GUARDRAIL INSTALLATION
 AND PALACEMENT OF FINAL SURFACE COURSE
 (REFER TO THE PHASING NOTES AND ROADWAY PLANS)

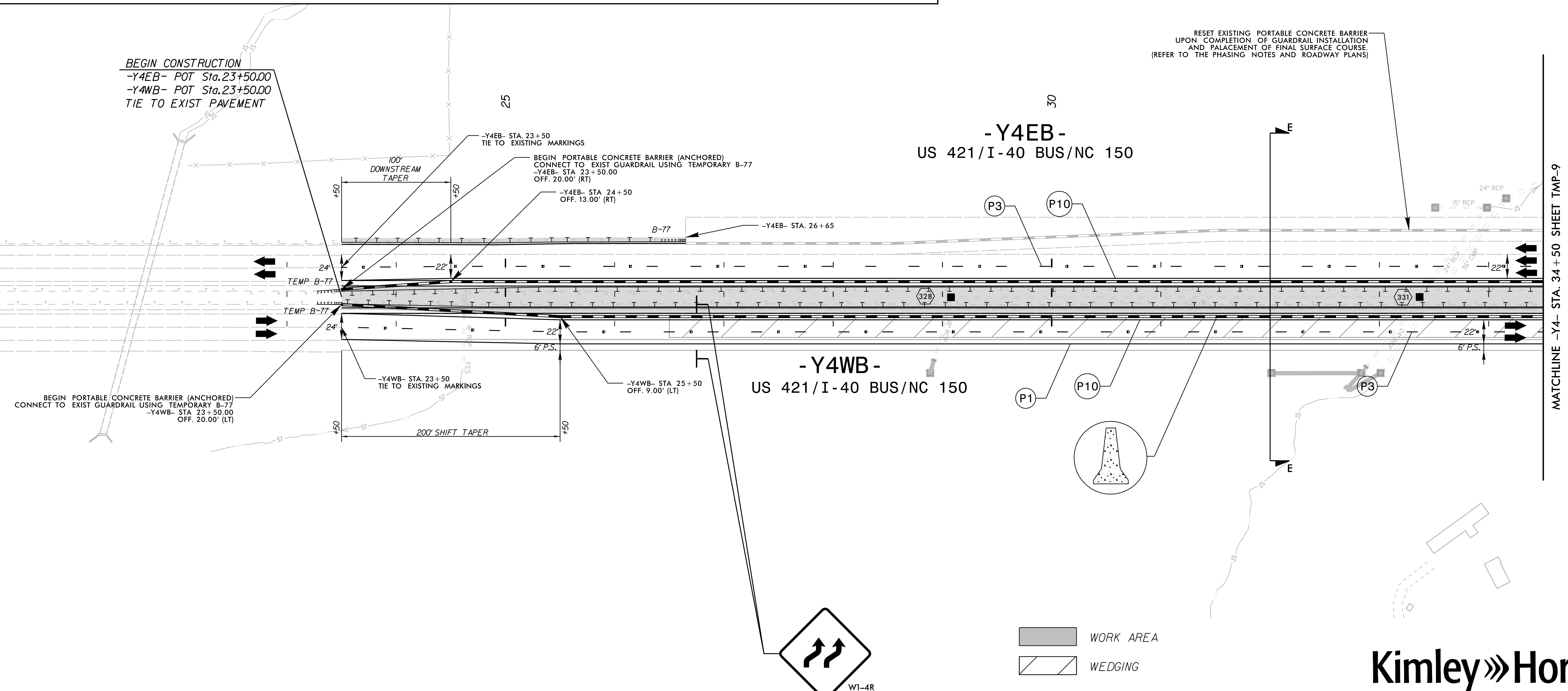

MATCHLINE -Y4- STA. 34+50 SHEET TMP-9

K:\RAL_Roadway\01036466 - U-2579BA\TrafficControl\TrafficControl\Phase 2\U-2579ba_tmp_pst08.dgn 1/27/2021

Kimley»Horn

APPROVED: *Rhodes Hunt*
 DATE: 1/27/2021

SEAL

**DOCUMENT NOT CONSIDERED FINAL
UNLESS ALL SIGNATURES COMPLETED**

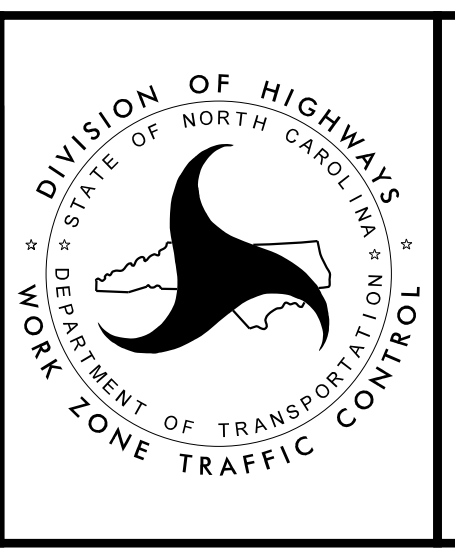

**PHASE 2
TRAFFIC CONTROL
DETAILS**