

R-5797

CONTRACT:

**STATE OF NORTH CAROLINA
DEPARTMENT OF TRANSPORTATION**

**PAVEMENT MARKING PLAN
COLUMBUS COUNTY**

LOCATION: US 74 AT SR 1506 (OLD BOARDMAN RDMACEDONIA CHURCH RD)

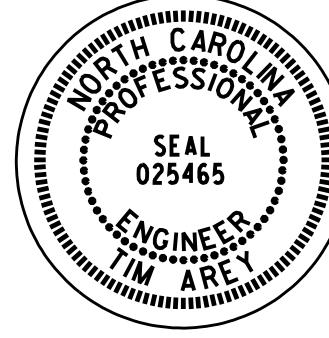
TIP NO. R-5797	SHEET NO. PM-1
APPROVED: <u>Tim Arey</u>	
DATE: 12/10/20	
	
SEAL DOCUMENT NOT CONSIDERED FINAL UNLESS ALL SIGNATURES COMPLETED	

ROADWAY STANDARD DRAWING

THE FOLLOWING ROADWAY STANDARDS AS APPEAR IN "ROADWAY STANDARD DRAWINGS" - PROJECT SERVICES UNIT - N.C. DEPARTMENT OF TRANSPORTATION - RALEIGH, N.C., DATED JANUARY 2018 ARE APPLICABLE TO THIS PROJECT AND BY REFERENCE HEREBY ARE CONSIDERED A PART OF THESE PLANS:

STD. NO.	TITLE
1205.01	PAVEMENT MARKINGS - LINE TYPES AND OFFSETS
1205.02	PAVEMENT MARKINGS - TWO-LANE AND MULTILANE ROADWAYS
1205.03	PAVEMENT MARKINGS - EXIT AND ENTRANCE RAMP
1205.04	PAVEMENT MARKINGS - INTERSECTIONS
1205.05	PAVEMENT MARKINGS - TURN LANES
1205.08	PAVEMENT MARKINGS - SYMBOLS AND WORD MESSAGES
1205.12	PAVEMENT MARKINGS - BRIDGES
1205.14	PAVEMENT MARKINGS - ROUNDABOUTS
1250.01	RAISED PAVEMENT MARKERS - INSTALLATION SPACING
1251.01	RAISED PAVEMENT MARKERS - PERMANENT AND TEMPORARY
1261.01	GUARDRAIL AND BARRIER DELINEATORS - INSTALLATION SPACING
1261.02	GUARDRAIL AND BARRIER DELINEATORS - TYPES AND MOUNTING
1262.01	GUARDRAIL END DELINEATION
1264.01	OBJECT MARKERS - TYPES
1264.02	OBJECT MARKERS - INSTALLATION

GENERAL NOTES

- THE FOLLOWING GENERAL NOTES APPLY AT ALL TIMES FOR THE DURATION OF THE CONSTRUCTION PROJECT, EXCEPT WHEN OTHERWISE NOTED IN THE PLAN, OR DIRECTED BY THE ENGINEER.
- A) INSTALL PAVEMENT MARKINGS AND PAVEMENT MARKERS ON THE FINAL SURFACE AS FOLLOWS:

ROAD NAME	MARKING	MARKER
ALL	THERMOPLASTIC	PERMANENT RAISED
BRIDGES	POLYUREA	
 - B) TIE PROPOSED PAVEMENT MARKING LINES TO EXISTING PAVEMENT MARKING LINES.
 - C) REMOVE/REPLACE ANY CONFLICTING/DAMAGED PAVEMENT MARKINGS AND MARKERS.
 - D) STOP BAR LOCATION AT NON-SIGNALIZED INTERSECTIONS MAY BE ADJUSTED AS DIRECTED BY THE ENGINEER.
 - E) REMOVE ALL RESIDUE AND SURFACE LAITANCE BY ACCEPTABLE METHODS ON CONCRETE BRIDGE DECKS PRIOR TO PLACING POLYUREA PAVEMENT MARKING MATERIAL.
 - F) UNLESS OTHERWISE SPECIFIED, HEATED-IN-PLACE THERMOPLASTIC MAY BE USED IN LIEU OF EXTRUDED THERMOPLASTIC FOR STOP BARS, SYMBOLS, CHARACTERS AND DIAGONALS. IF HEATED-IN-PLACE IS USED, IT SHALL BE PAID FOR USING THE EXTRUDED THERMOPLASTIC PAY ITEM.

INDEX

SHEET NO.	DESCRIPTION
PM-1	PAVEMENT MARKING PLAN TITLE AND SCHEDULE SHEET
PM-2 THRU PM-9	PAVEMENT MARKING DETAIL

PAVEMENT MARKING SCHEDULE

SYMBOL	DESCRIPTION
	<u>THERMOPLASTIC (6", 90 MILS)</u>
T20	WHITE EDGELINE
T21	WHITE SOLID LANE LINE
T22	10 FT. WHITE SKIP
T23	3 FT. - 9 FT./SP WHITE MINISKIP
T24	2 FT. - 6 FT./SP WHITE MINISKIP
T30	YELLOW EDGELINE
T33	YELLOW DOUBLE CENTER
	<u>THERMOPLASTIC(12", 90 MILS)</u>
T50	WHITE GORELINE
T55	3 FT. - 3 FT./SP WHITE MINISKIP
	<u>THERMOPLASTIC(24", 90 MILS)</u>
T61	WHITE STOPBAR
	<u>THERMOPLASTIC PAVEMENT MARKING SYMBOLS (90 MILS)</u>
T70	LEFT TURN ARROW
T71	RIGHT TURN ARROW
T79	MERGE ARROW
T103	24" YIELD LINE TRIANGLE
T117	FISHHOOK W/CIRCLE LEFT/STRAIGHT ARROW
T118	FISHHOOK W/CIRCLE LEFT/RIGHT/STRAIGHT ARROW
	<u>POLYUREA (6")</u>
V20	WHITE EDGELINE
V22	10 FT. WHITE SKIP
V30	YELLOW EDGELINE
V33	YELLOW DOUBLE CENTER

PLAN PREPARED BY:

Tim Arey, PE PROJECT ENGINEER
Larry Ashley DESIGN ENGINEER

Prepared In the Office of:



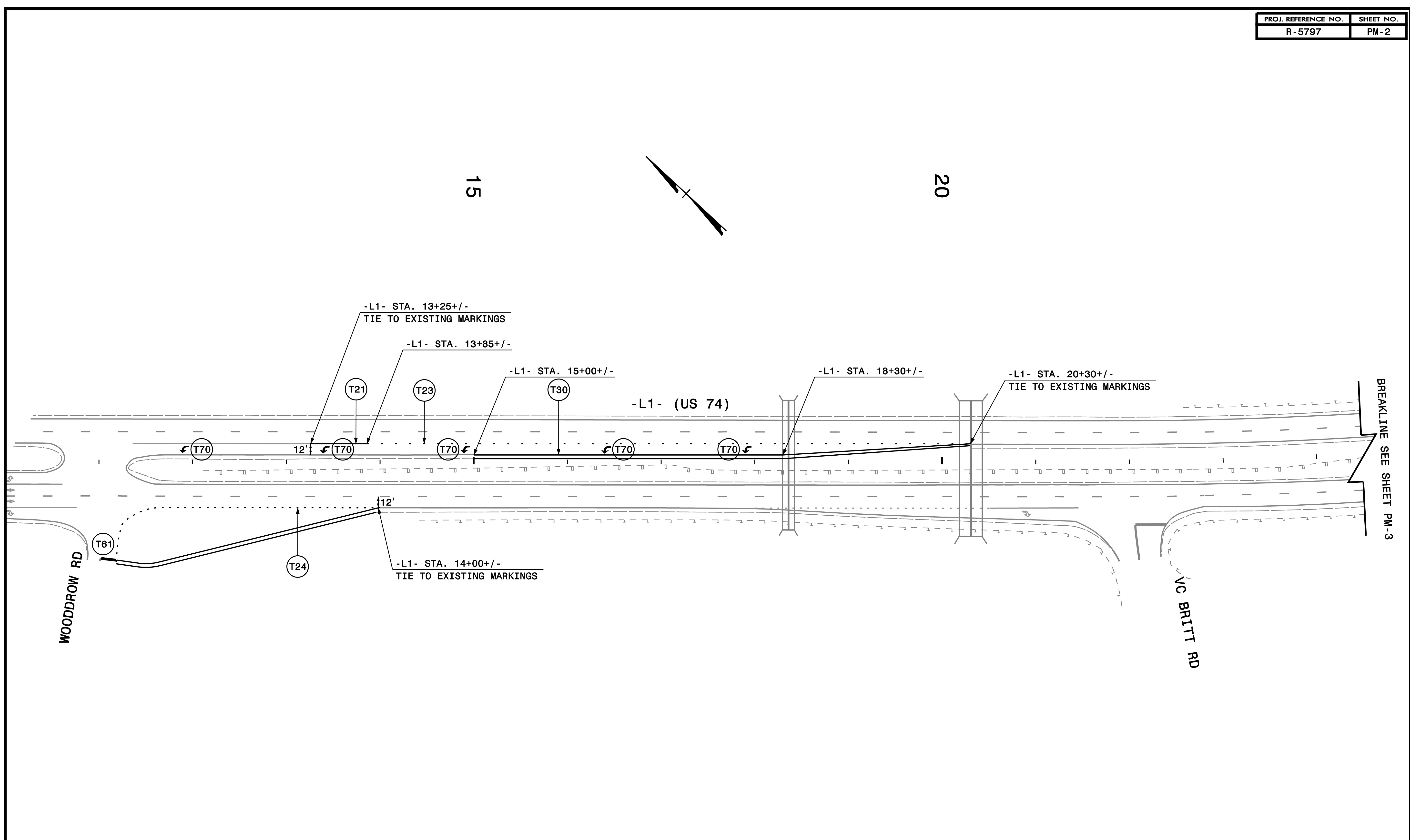

15

20

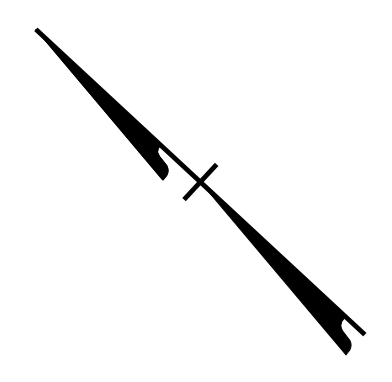

WOODROW RD

VC BRITT RD

BREAKLINE SEE SHEET PM-3

DOCUMENT NOT CONSIDERED FINAL
UNLESS ALL SIGNATURES COMPLETED

PLAN PREPARED IN THE OFFICE OF:

PROGRESSIVE
DESIGN GROUP, INC.

ENGINEERS • CONSULTANTS

APPROVED: *Tim Arney* DATE: 12/10/20

SEAL

FINAL PAVEMENT
MARKING PLAN

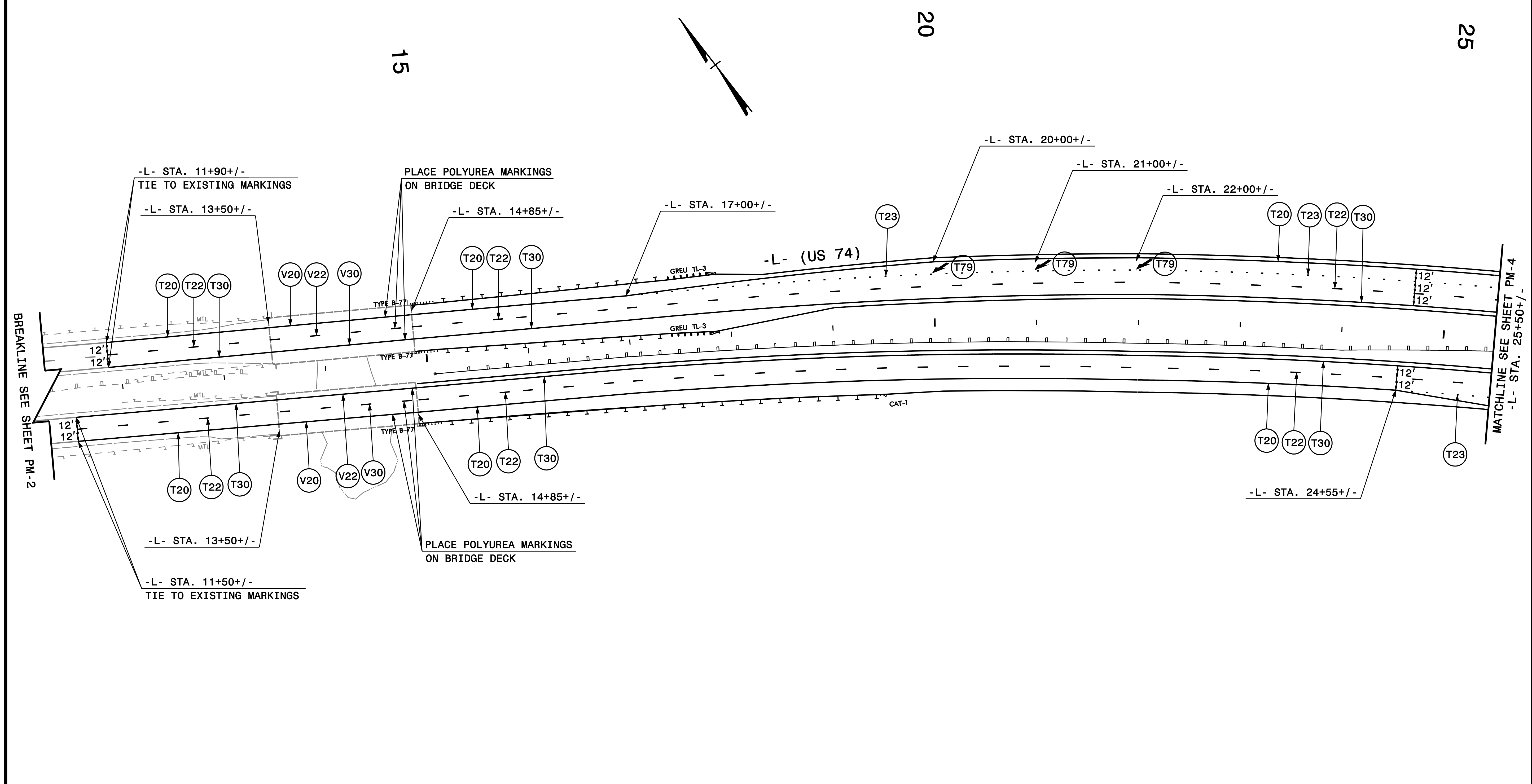

BREAKLINE SEE SHEET PM-2

MATCHLINE SEE SHEET PM-4
-L- STA. 25+50+/-

DOCUMENT NOT CONSIDERED FINAL
UNLESS ALL SIGNATURES COMPLETED

PLAN PREPARED IN THE OFFICE OF:

PROGRESSIVE
DESIGN GROUP, INC.

ENGINEERS • CONSULTANTS

APPROVED: *Tim Are* DATE: 12/30/20

SEAL

FINAL PAVEMENT
MARKING PLAN

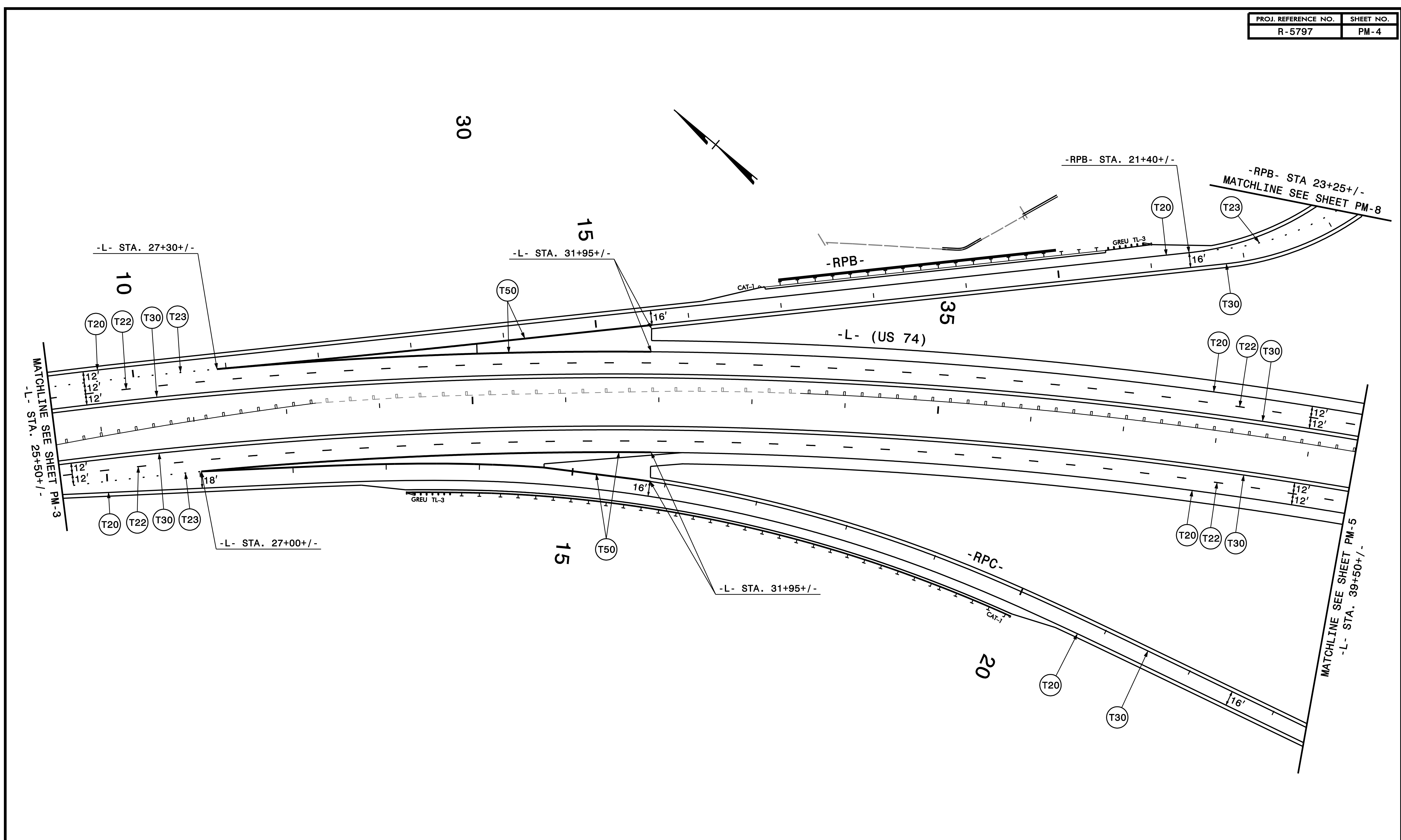

DOCUMENT NOT CONSIDERED FINAL
UNLESS ALL SIGNATURES COMPLETED

PLAN PREPARED IN THE OFFICE OF:

PROGRESSIVE
DESIGN GROUP, INC.

ENGINEERS • CONSULTANTS

APPROVED: *Jim Aug* DATE: 12/10/20

SEAL

FINAL PAVEMENT
MARKING PLAN

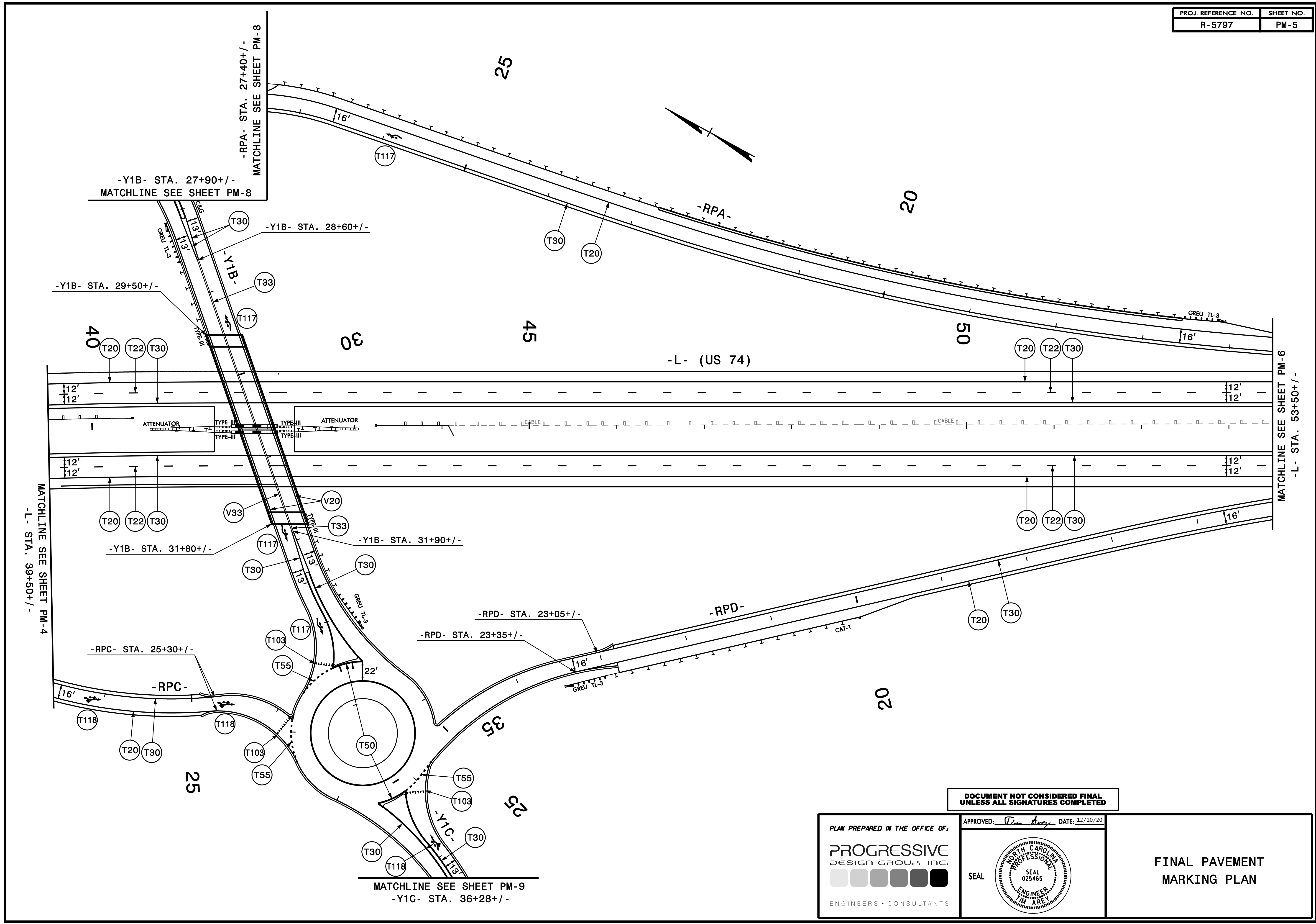

DOCUMENT NOT CONSIDERED FINAL UNLESS ALL SIGNATURES COMPLETED

PLAN PREPARED IN THE OFFICE OF:

PROGRESSIVE
DESIGN GROUP, INC.

ENGINEERS • CONSULTANTS

APPROVED: *[Signature]* DATE: 12/10/20

SEAL

SEAL
025465
ENGINEER
JIM ARE

FINAL PAVEMENT MARKING PLAN

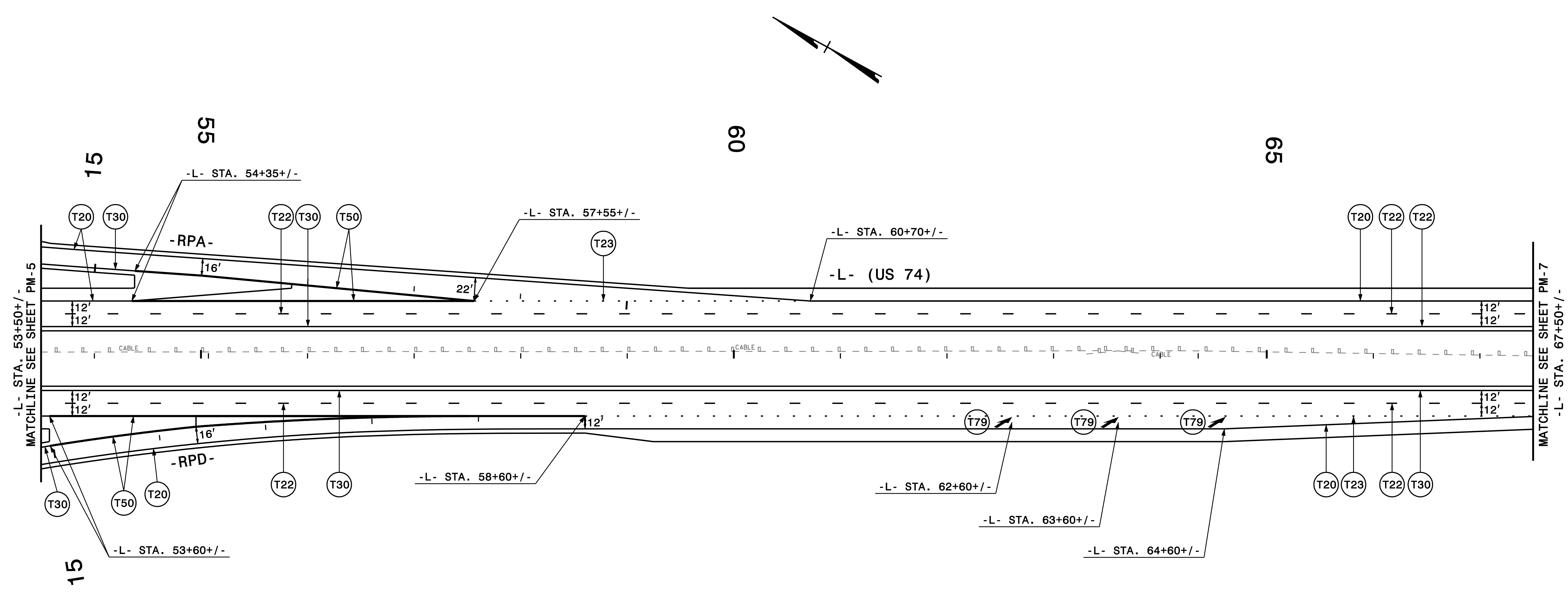

DOCUMENT NOT CONSIDERED FINAL
UNLESS ALL SIGNATURES COMPLETED

PLAN PREPARED IN THE OFFICE OF:

PROGRESSIVE
DESIGN GROUP, INC.

ENGINEERS • CONSULTANTS

APPROVED: *Tim Stey* DATE: 12/10/20

SEAL

FINAL PAVEMENT
MARKING PLAN

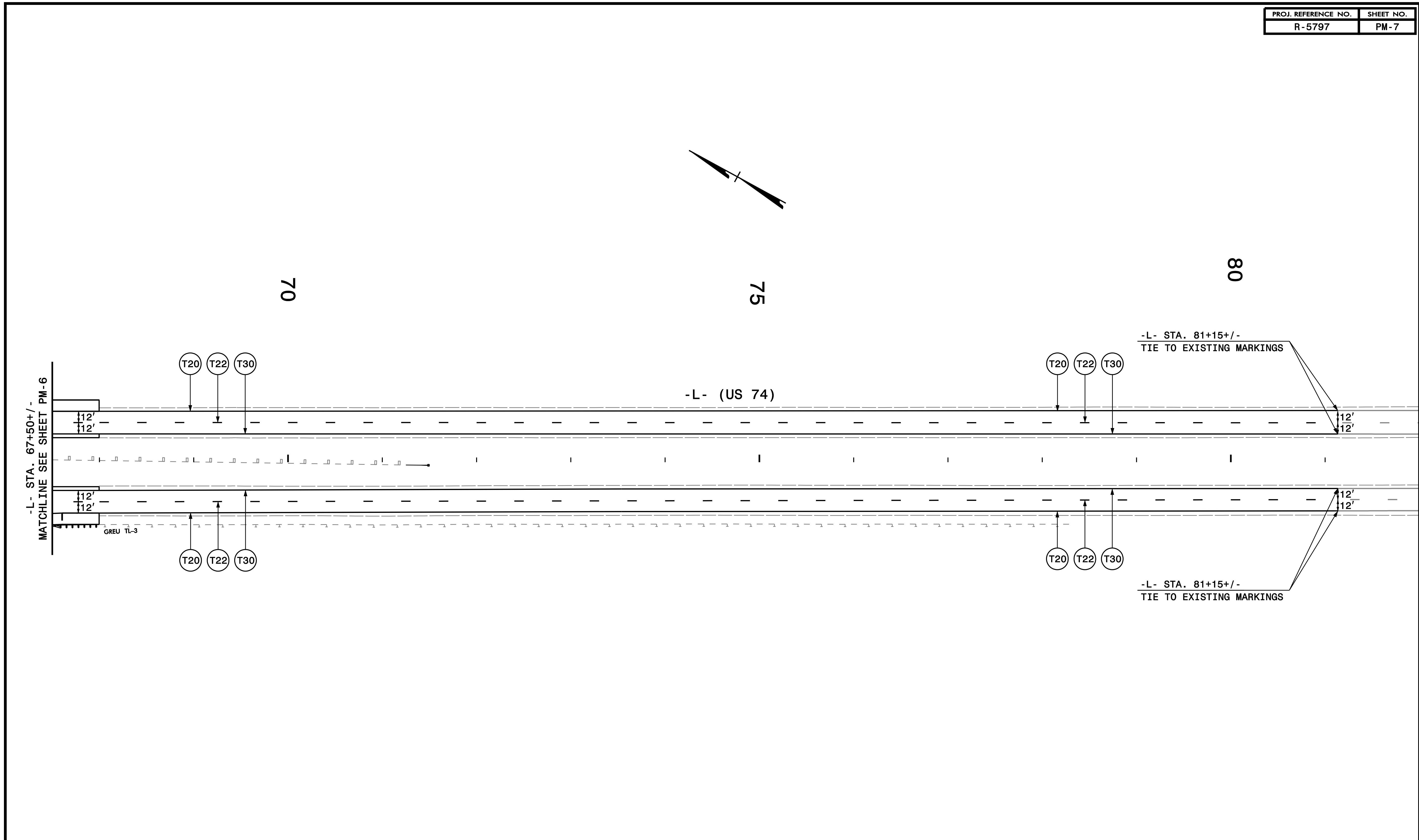

DOCUMENT NOT CONSIDERED FINAL
UNLESS ALL SIGNATURES COMPLETED

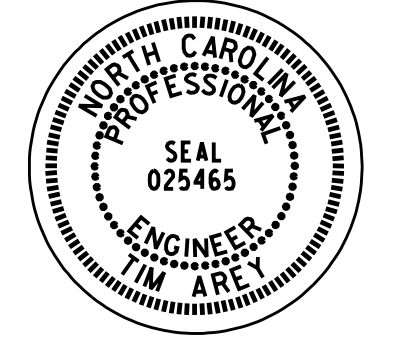
PLAN PREPARED IN THE OFFICE OF: PROGRESSIVE DESIGN GROUP, INC.  ENGINEERS • CONSULTANTS	APPROVED: <i>[Signature]</i> DATE: 12/10/20	FINAL PAVEMENT MARKING PLAN
	SEAL 	

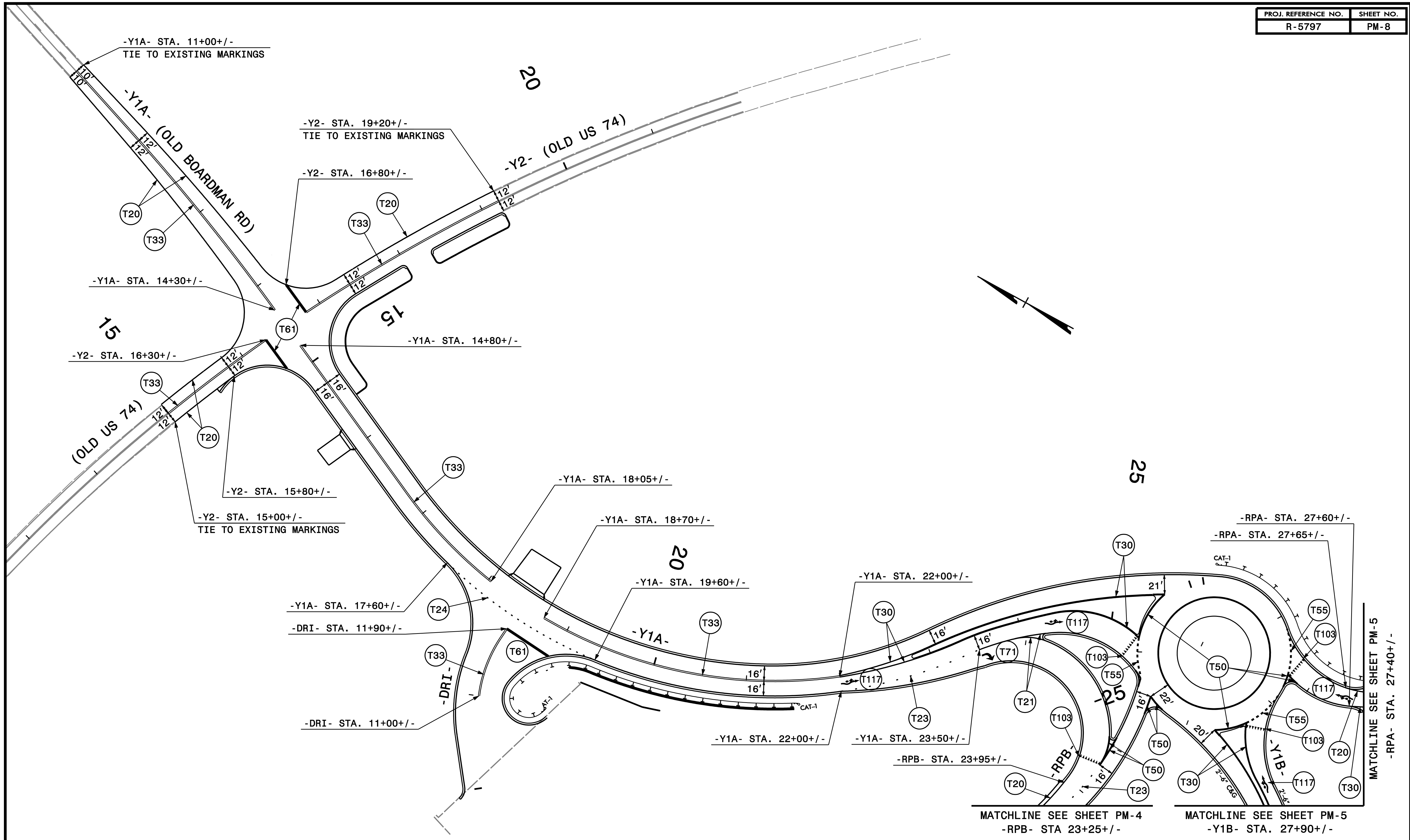

DOCUMENT NOT CONSIDERED FINAL UNLESS ALL SIGNATURES COMPLETED

PLAN PREPARED IN THE OFFICE OF:

PROGRESSIVE
DESIGN GROUP, INC.

ENGINEERS • CONSULTANTS

APPROVED: *Tim King* DATE: 01/25/21

SEAL

FINAL PAVEMENT MARKING PLAN

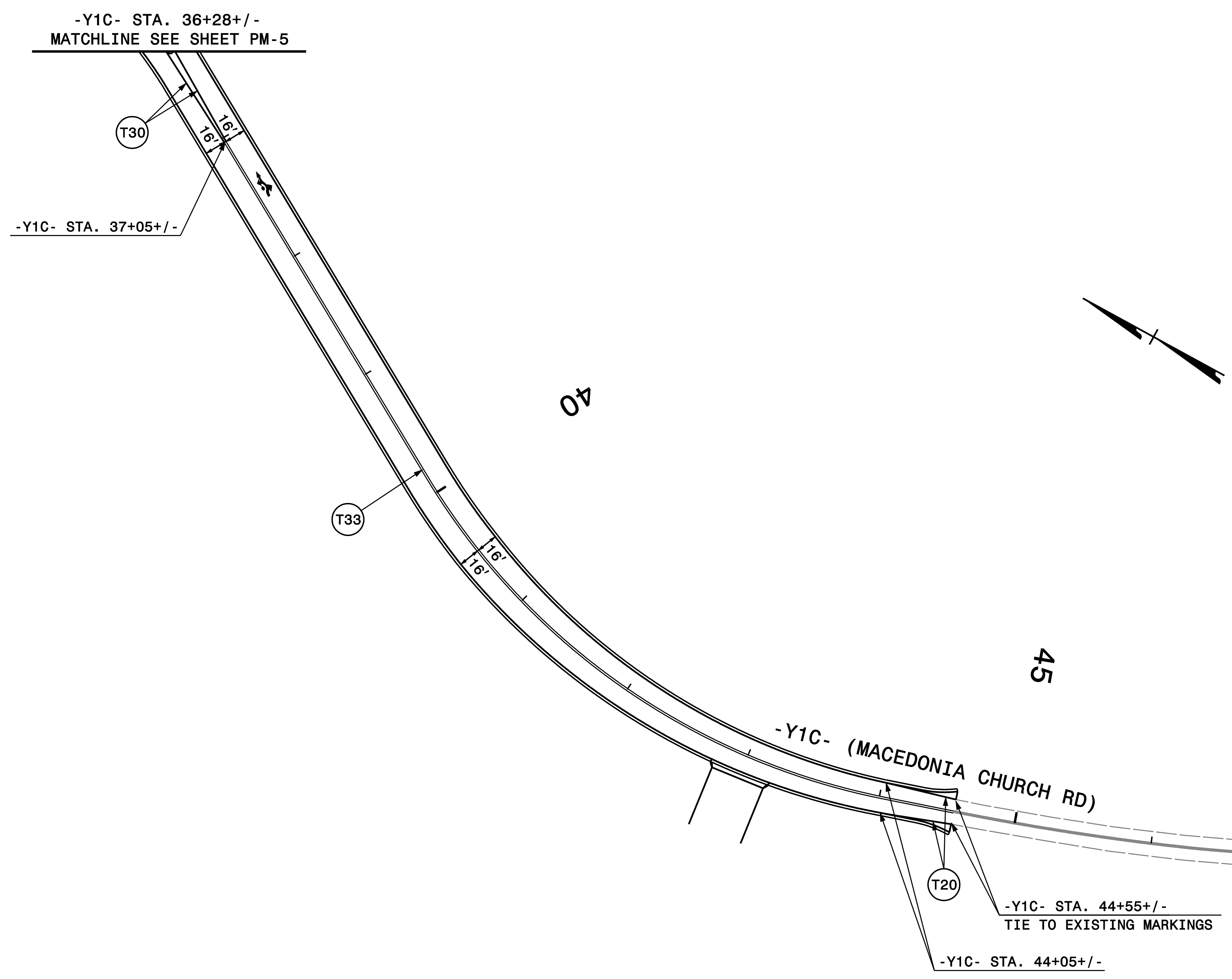

DOCUMENT NOT CONSIDERED FINAL
UNLESS ALL SIGNATURES COMPLETED

PLAN PREPARED IN THE OFFICE OF:

PROGRESSIVE
DESIGN GROUP, INC.

ENGINEERS • CONSULTANTS

APPROVED: *Tim Are* DATE: 12/10/20

SEAL

FINAL PAVEMENT
MARKING PLAN