

BM2 - BENCHTIE NAIL SET IN 48" PINE, STA. 28+80.51 -Y1B-, 81' RT., N 2495599 E 2015219, ELEV 88.56

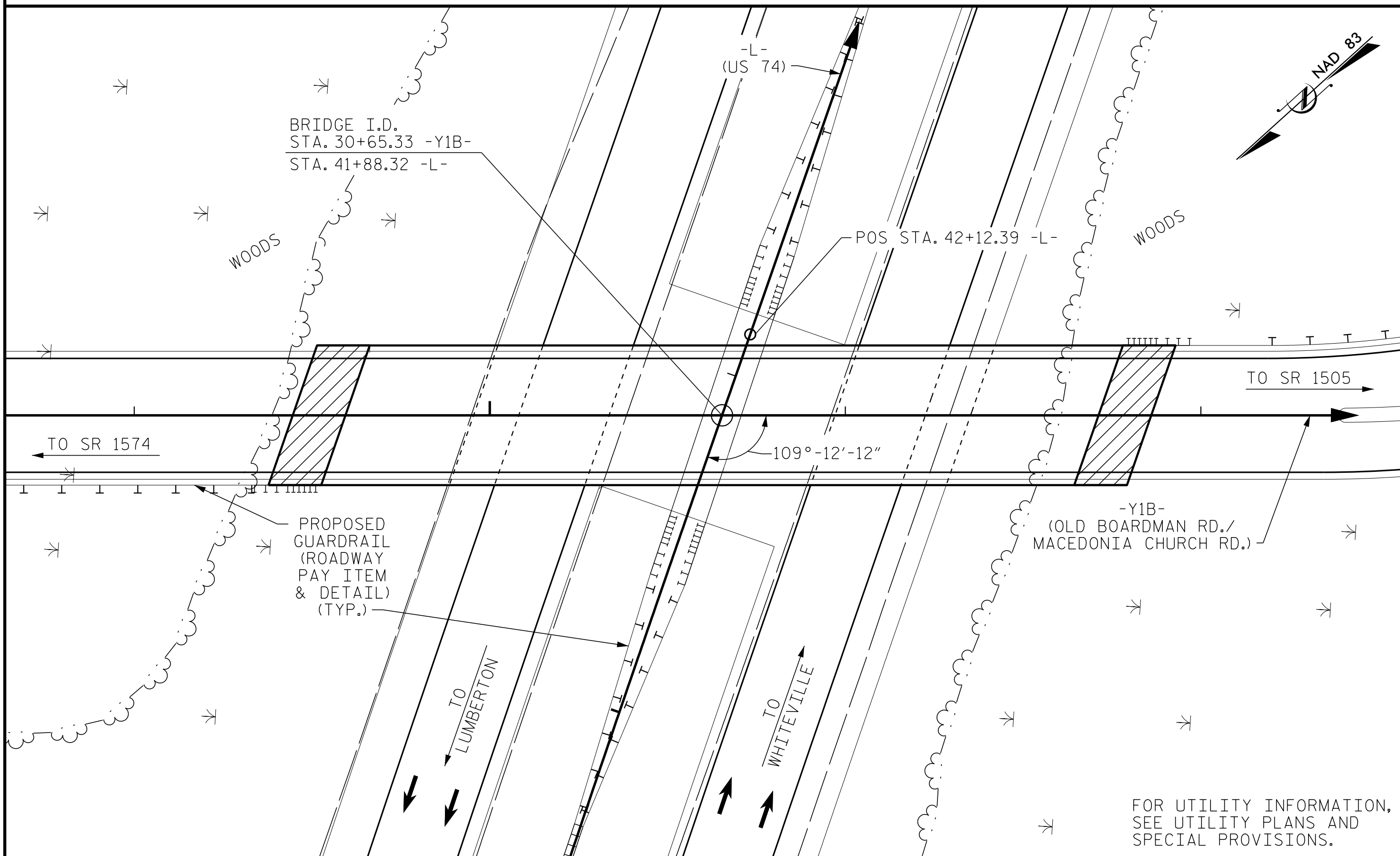

LOCATION SKETCH

NOTES :

- ASSUMED LIVE LOAD = HL-93 OR ALTERNATE LOADING.
- THIS BRIDGE HAS BEEN DESIGNED IN ACCORDANCE WITH THE AASHTO LRFD BRIDGE DESIGN SPECIFICATIONS.
- THIS BRIDGE IS LOCATED IN SEISMIC ZONE 2.
- FOR OTHER DESIGN DATA AND GENERAL NOTES, SEE SHEET SN.
- FOR SUBMITTAL OF WORKING DRAWINGS, SEE SPECIAL PROVISIONS.
- FOR FALSEWORK AND FORMWORK, SEE SPECIAL PROVISIONS.
- FOR CRANE SAFETY, SEE SPECIAL PROVISIONS.
- FOR GROUT FOR STRUCTURES, SEE SPECIAL PROVISIONS.
- FOR MAINTENANCE AND PROTECTION OF TRAFFIC BENEATH PROPOSED STRUCTURE, SEE SPECIAL PROVISIONS.
- PRESTRESSED CONCRETE DECK PANELS MAY BE USED IN LIEU OF METAL STAY-IN-PLACE FORMS IN ACCORDANCE WITH ARTICLE 420-3 OF THE STANDARD SPECIFICATIONS.
- REMOVABLE FORMS MAY BE USED IN LIEU OF METAL STAY-IN-PLACE FORMS IN ACCORDANCE WITH ARTICLE 420-3 OF THE STANDARD SPECIFICATIONS.
- NEEDLE BEAMS WILL NOT BE ALLOWED UNLESS OTHERWISE CALLED FOR ON THE PLANS OR APPROVED BY THE ENGINEER.
- FOR EROSION CONTROL MEASURES, SEE EROSION CONTROL PLANS.

TOTAL BILL OF MATERIAL

	FOUNDATION EXCAVATION FOR BENT	PDA TESTING	REINFORCED CONCRETE DECK SLAB	GROOVING BRIDGE FLOORS	CLASS A CONCRETE	BRIDGE APPROACH SLABS	REINFORCING STEEL	SPIRAL COLUMN REINFORCING STEEL	54" PRESTRESSED CONCRETE GIRDERS	PILE DRIVING EQUIPMENT SETUP FOR HP 12 X 53 STEEL PILES	HP 12 x 53 STEEL PILES	PILE REDRIVES	TWO BAR METAL RAIL	1'-2" x 2'-6" CONCRETE PARAPET	4" SLOPE PROTECTION	ELASTOMERIC BEARINGS	
	LUMP SUM	EACH	SQ.FT.	SQ.FT.	CU.YDS.	LUMP SUM	LBS.	LBS.	No.	LIN.FT.	EA.	NO.	LIN.FT.	EA.	LIN.FT.	SQ. YDS.	LUMP SUM
SUPERSTRUCTURE			7,870	7,653					8	788.00			381.16	397.47			
END BENT 1					38.0		4,907				8	496	4		265		
BENT 1					51.2		8,239	1,325			12	849	6				
END BENT 2					38.0		4,907				8	496	4		270		
TOTAL	LUMP SUM	1	7,870	7,653	127.2	LUMP SUM	18,053	1,325	8	788.00	28	1,841	14	381.16	397.47	535	LUMP SUM

PROJECT NO. R-5797  
COLUMBUS COUNTY  
STATION: 30+65.33 -Y1B-

SHEET 3 OF 3

P:\2017\1718610\_1-R-5797 Structures\Drawings\5797\_SMU\_GD3.dgn 12/16/2020 2:35:58 PM

DRAWN BY : D. HODGE DATE : 4/19  
CHECKED BY : G.M. GILLAND DATE : 4/19

DOCUMENT NOT CONSIDERED FINAL UNLESS ALL SIGNATURES COMPLETED

ENGINEER OF RECORD:  
  
 12/16/2020 13:07:38 PST  
 WETHERILL ENGINEERING  
 1223 Jones Franklin Rd.  
 Raleigh, N.C. 27606  
 Bus: 919 851 8077  
 Fax: 919 851 8107  
 LICENSE NO. F-0377

STATE OF NORTH CAROLINA  
 DEPARTMENT OF TRANSPORTATION  
 RALEIGH  
 GENERAL DRAWING  
 BRIDGE ON SR 1506  
 (OLD BOARDMAN RD./MACEDONIA CHURCH RD.) OVER US 74  
 BETWEEN SR 1574 AND SR 1505

REVISIONS						SHEET NO.
NO.	BY:	DATE:	NO.	BY:	DATE:	S-3
1			3			TOTAL SHEETS
2			4			33