

THE CONSTRUCTION SHOWN ON THIS SHEET SHALL BE COMPLETED WITHIN THE INTERMEDIATE CONTRACT TIME DESCRIBED IN PHASE III OF THE WRITTEN PHASING (SHEET TMP-3) WITH OLD BOARDMAN ROAD AND MACEDONIA CHURCH ROAD TRAFFIC PLACED ON THE OFFSITE DETOUR ROUTE SHOWN ON SHEET TMP-2C

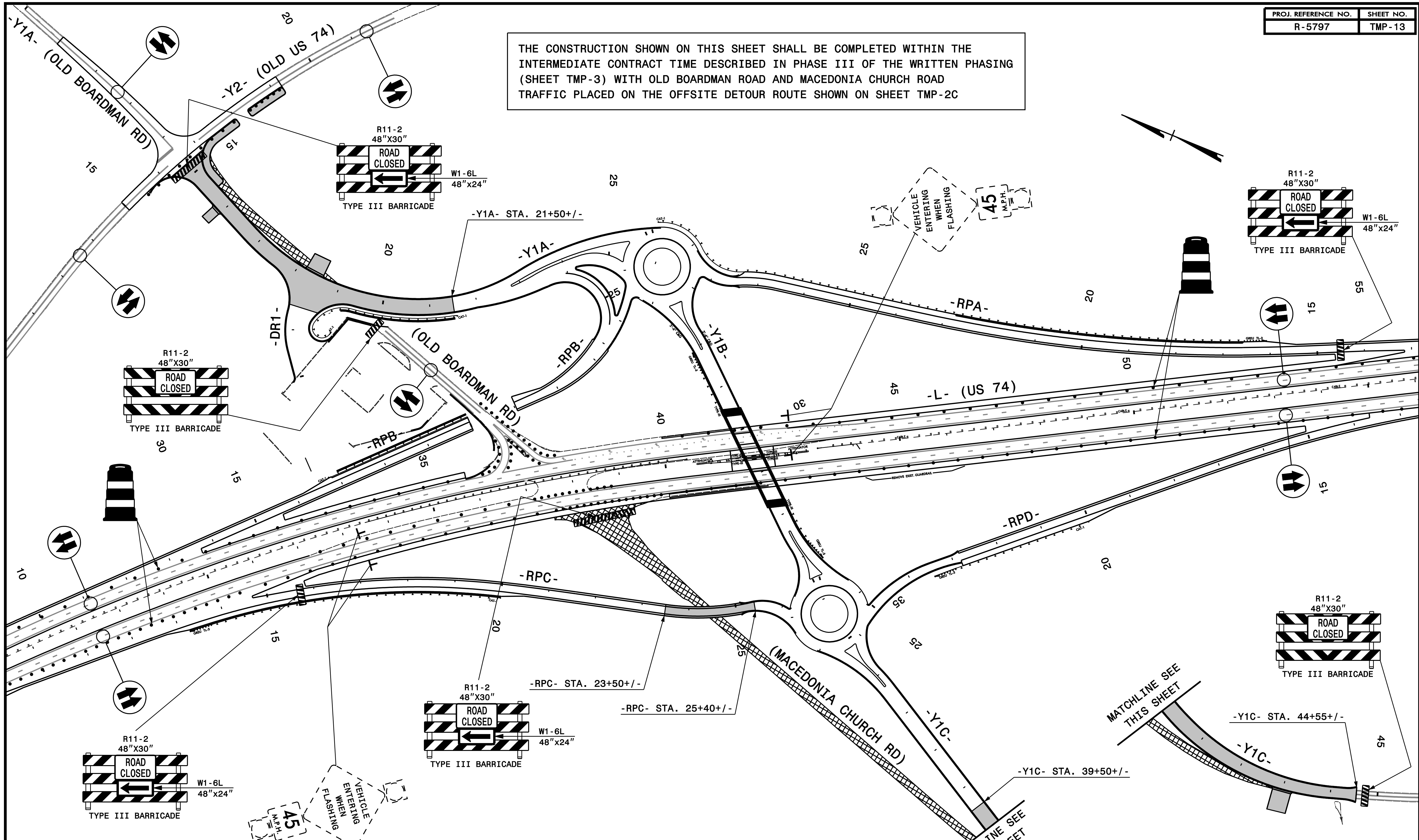

DOCUMENT NOT CONSIDERED FINAL
UNLESS ALL SIGNATURES COMPLETED

PLAN PREPARED IN THE OFFICE OF:
PROGRESSIVE
DESIGN GROUP, INC.
ENGINEERS • CONSULTANTS

APPROVED: *[Signature]* DATE: 02/03/21
SEAL
NORTH CAROLINA PROFESSIONAL ENGINEER
SEAL 025465
TIM ARE

TRANSPORTATION
MANAGEMENT PLAN
PHASE III OVERVIEW

ALL PAVEMENT MARKINGS ARE EXISTING OR FROM PREVIOUS PHASE UNLESS OTHERWISE NOTED. ALL TEMPORARY LANE WIDTHS ARE 11' UNLESS OTHERWISE NOTED.