

MESSAGE NO. 1
MCDONIA CH ROAD CLOSED
CHANGEABLE MESSAGE SIGN

MESSAGE NO. 2
1 MILE FOLLOW DETOUR
CHANGEABLE MESSAGE SIGN

MESSAGE NO. 1
MCDONIA CH ROAD CLOSED
CHANGEABLE MESSAGE SIGN

MESSAGE NO. 2
5 MILES FOLLOW DETOUR
CHANGEABLE MESSAGE SIGN

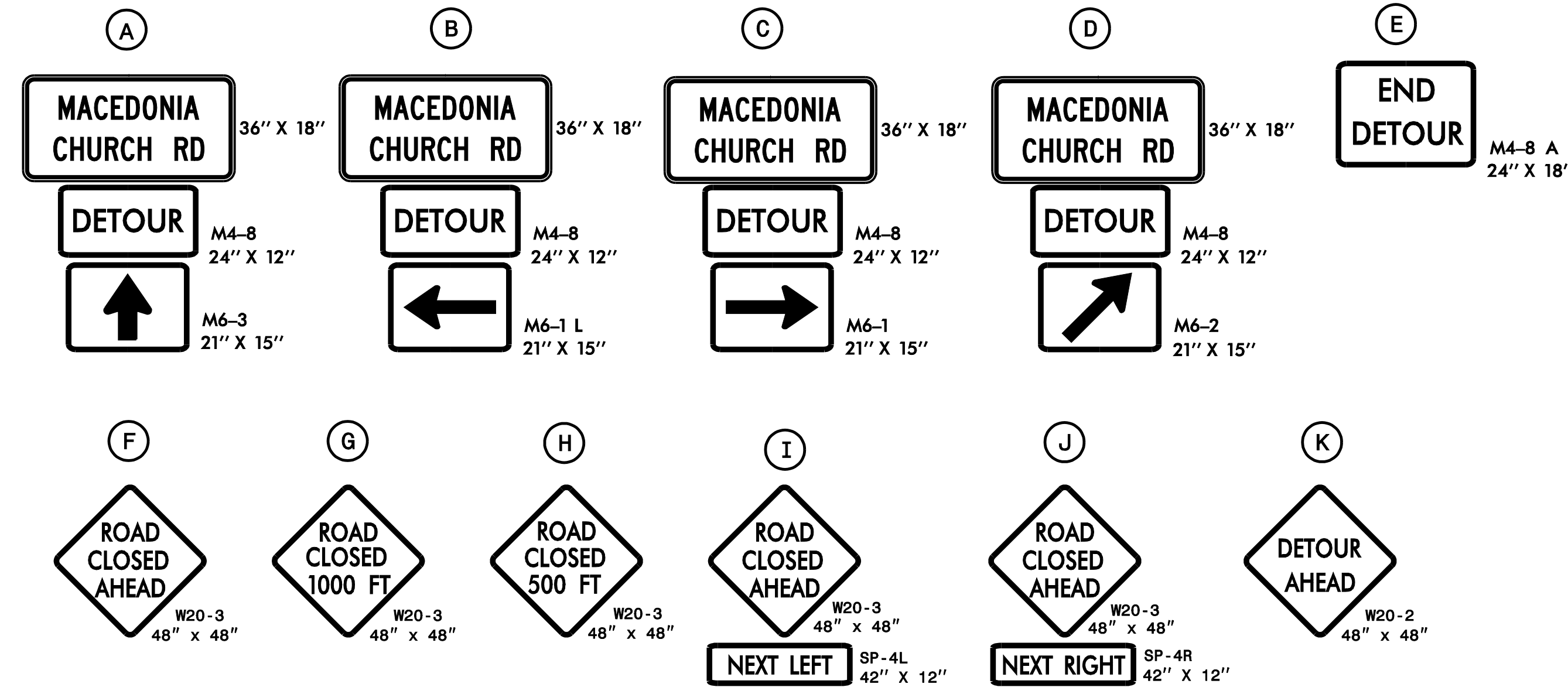

SIGN NUMBER: - BACKG COLOR: Fluorescent Orange DESIGN BY: CHECKED BY: DATE: Jan 25, 2021
 TYPE: STATIONARY COPY COLOR: Black PROJECT ID: DIV:

SYMBOL	X	Y	WID	HT

SIGN WIDTH: 3'-0"
 HEIGHT: 1'-6"
 TOTAL AREA: 4.5 Sq.Ft.
 BORDER TYPE: INSET
 RECESS: 0.375"
 WIDTH: 0.625"
 RADII: 1.5"
 NO. Z BARS: MAT'L: 0.125" (3.2 mm) ALUMINUM
 LENGTH:



USE NOTES: 1,2
 1. Legend and border shall be direct applied black non-reflective sheeting.
 2. Background shall be NC Grade B fluorescent retroreflective sheeting.

Spacing Factor is 1 unless specified otherwise

LETTER POSITIONS

Letter spacings are to start of next letter

Series/Size	M	A	C	D	E	O	N	I	A	Text Length
C 2000	6.1	3.1	2.9	2.6	2.8	3	2.9	1	2.6	23.8
C 2000	5.2	2.9	2.9	2.7	2.9	2.2	4	2.8	2.2	25.6

FILENAME: Offsite Sign Designs NORTH CAROLINA D.O.T. SIGN DETAIL

DOCUMENT NOT CONSIDERED FINAL UNLESS ALL SIGNATURES COMPLETED

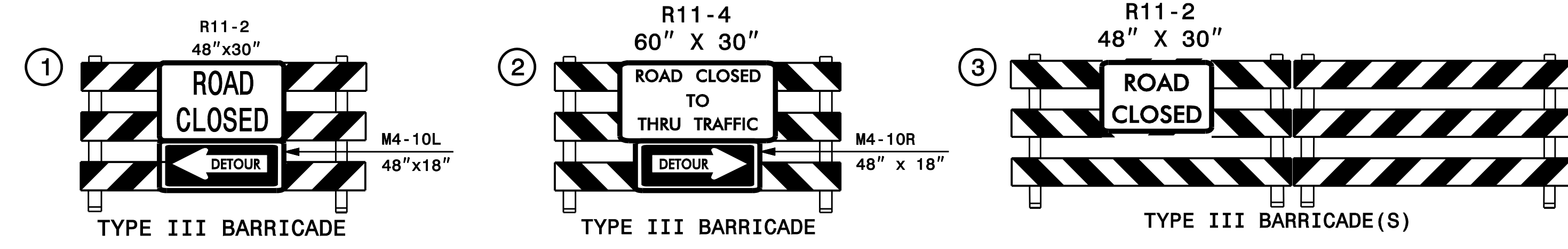

PLAN PREPARED IN THE OFFICE OF: **PROGRESSIVE DESIGN GROUP, INC.**
 ENGINEERS • CONSULTANTS

APPROVED: *[Signature]* DATE: 01/25/21
 SEAL: **NORTH CAROLINA PROFESSIONAL ENGINEER SEAL 025465**

TRANSPORTATION MANAGEMENT PLAN
 OFFSITE DETOUR ROUTE
 OLD BOARDMAN RD &
 MACEDONIA CHURCH RD