

PROJECT REFERENCE NO.	SHEET NO.
R-5020B	EC-22/CONST.II
RW SHEET NO.	
ROADWAY DESIGN ENGINEER	HYDRAULICS ENGINEER

FINAL GRADING  
EROSION CONTROL FOR  
CONSTRUCTION SHEET 11

MATCHLINE -RPC- STA. 19+50 SEE SHEET 14

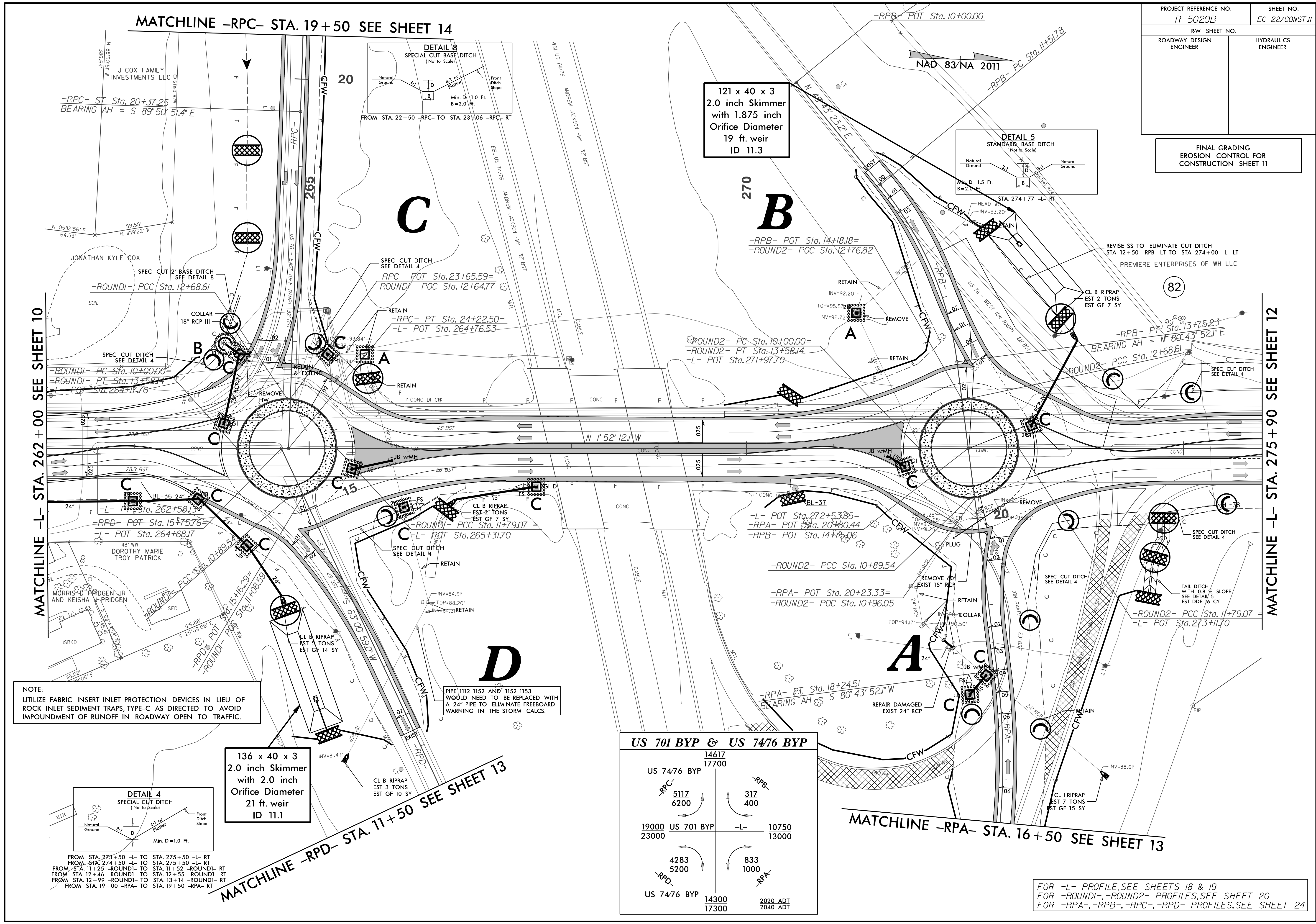

121 x 40 x 3  
2.0 inch Skimmer  
with 1.875 inch  
Orifice Diameter  
19 ft. weir  
ID 11.3

136 x 40 x 3  
2.0 inch Skimmer  
with 2.0 inch  
Orifice Diameter  
21 ft. weir  
ID 11.1

NOTE:  
UTILIZE FABRIC INSERT INLET PROTECTION DEVICES IN LIEU OF  
ROCK INLET SEDIMENT TRAPS, TYPE-C AS DIRECTED TO AVOID  
IMPOUNDMENT OF RUNOFF IN ROADWAY OPEN TO TRAFFIC.

PIPE 1112-1152 AND 1152-1153  
WOULD NEED TO BE REPLACED WITH  
A 24" PIPE TO ELIMINATE FREEBOARD  
WARNING IN THE STORM CALCS.

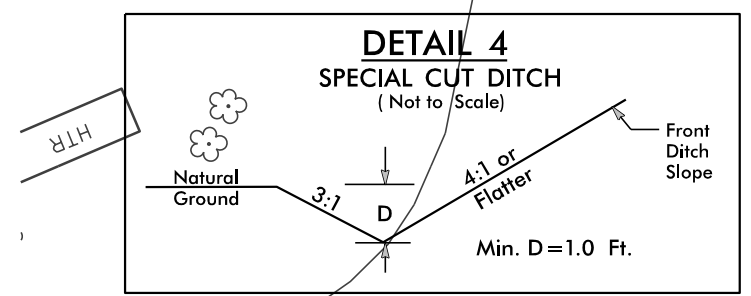

FROM STA. 273+50 -L- TO STA. 275+50 -L- RT  
FROM STA. 274+50 -L- TO STA. 275+50 -L- RT  
FROM STA. 11+25 -ROUND1- TO STA. 11+52 -ROUND1- RT  
FROM STA. 12+46 -ROUND1- TO STA. 12+55 -ROUND1- RT  
FROM STA. 12+99 -ROUND1- TO STA. 13+14 -ROUND1- RT  
FROM STA. 19+00 -RPA- TO STA. 19+50 -RPA- RT

US 701 BYP & US 7476 BYP			
	14617		
	17700		
US 7476 BYP			
-RPC-	5117		-RPB-
	6200		317
			400
19000	US 701 BYP	-L-	10750
23000			13000
	4283		833
	5200		1000
-RPD-			-RPA-
US 7476 BYP	14300		2020 ADT
	17300		2040 ADT

MATCHLINE -RPA- STA. 16+50 SEE SHEET 13

FOR -L- PROFILE, SEE SHEETS 18 & 19  
FOR -ROUND1-, -ROUND2- PROFILES, SEE SHEET 20  
FOR -RPA-, -RPB-, -RPC-, -RPD- PROFILES, SEE SHEET 24

MATCHLINE -L- STA. 262+00 SEE SHEET 10

MATCHLINE -L- STA. 275+90 SEE SHEET 12