

PROJECT REFERENCE NO.	SHEET NO.
R-5020B	EC-20/CONST.09
RW SHEET NO.	
ROADWAY DESIGN ENGINEER	HYDRAULICS ENGINEER

FINAL GRADING
EROSION CONTROL FOR
CONSTRUCTION SHEET 09

NOTE:
UTILIZE FABRIC INSERT INLET PROTECTION DEVICES IN LIEU OF
ROCK INLET SEDIMENT TRAPS, TYPE-C AS DIRECTED TO AVOID
IMPOUNDMENT OF RUNOFF IN ROADWAY OPEN TO TRAFFIC.

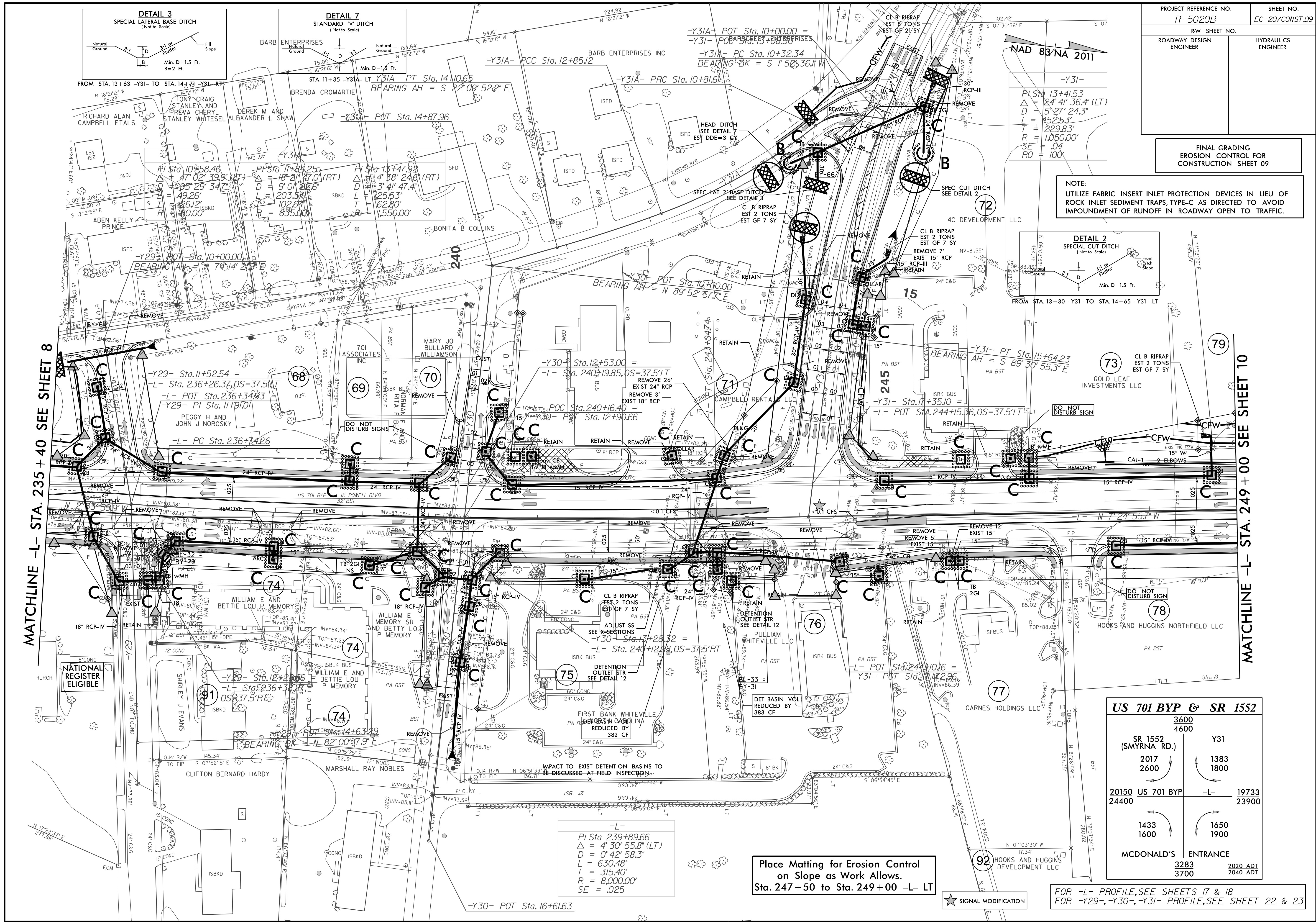
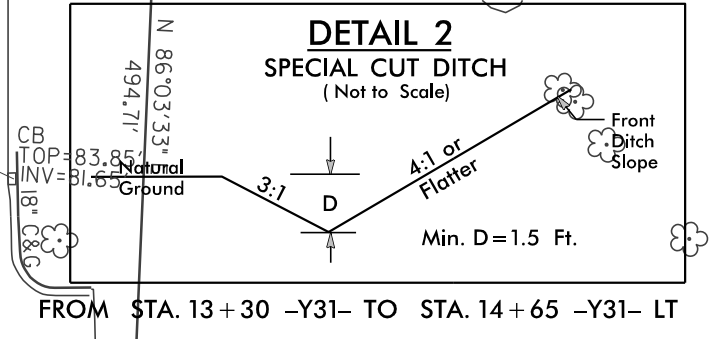
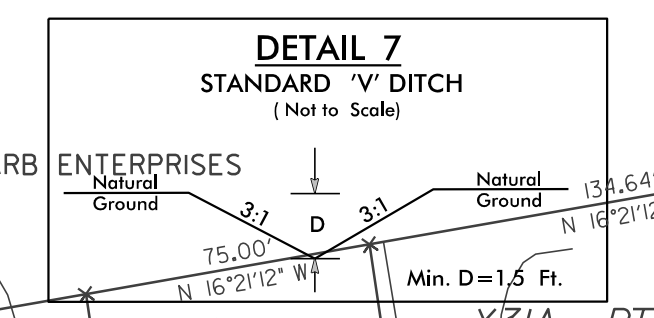
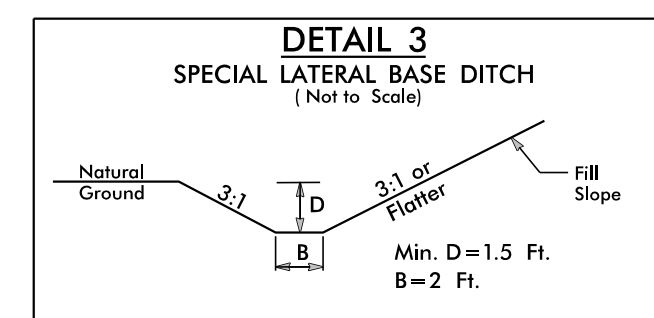

MATCHLINE -L- STA. 235 + 40 SEE SHEET 8

MATCHLINE -L- STA. 249 + 00 SEE SHEET 10

US 701 BYP & SR 1552			
3600	4600	-Y31-	
SR 1552 (SMYRNA RD.)			
2017	1383		
2600	1800		
20150	19733	-L-	
24400	23900		
1433	1650		
1600	1900		
MCDONALD'S ENTRANCE			
3283	2020 ADT		
3700	2040 ADT		

Place Matting for Erosion Control
on Slope as Work Allows.
Sta. 247 + 50 to Sta. 249 + 00 -L- LT

★ SIGNAL MODIFICATION

FOR -L- PROFILE, SEE SHEETS 17 & 18
FOR -Y29-, -Y30-, -Y31- PROFILE, SEE SHEET 22 & 23

-L-
PI Sta 239+89.66
Δ = 4° 30' 55.8" (LT)
D = 0° 42' 58.3"
L = 630.48'
T = 315.40'
R = 8,000.00'
SE = .025