

PROJECT REFERENCE NO.	SHEET NO.
R-5020B	EC-18/CONST.07
RW SHEET NO.	
ROADWAY DESIGN ENGINEER	HYDRAULICS ENGINEER

FINAL GRADING
EROSION CONTROL FOR
CONSTRUCTION SHEET 07

NOTE:
UTILIZE FABRIC INSERT INLET PROTECTION DEVICES IN LIEU OF
ROCK INLET SEDIMENT TRAPS, TYPE-C AS DIRECTED TO AVOID
IMPOUNDMENT OF RUNOFF IN ROADWAY OPEN TO TRAFFIC.

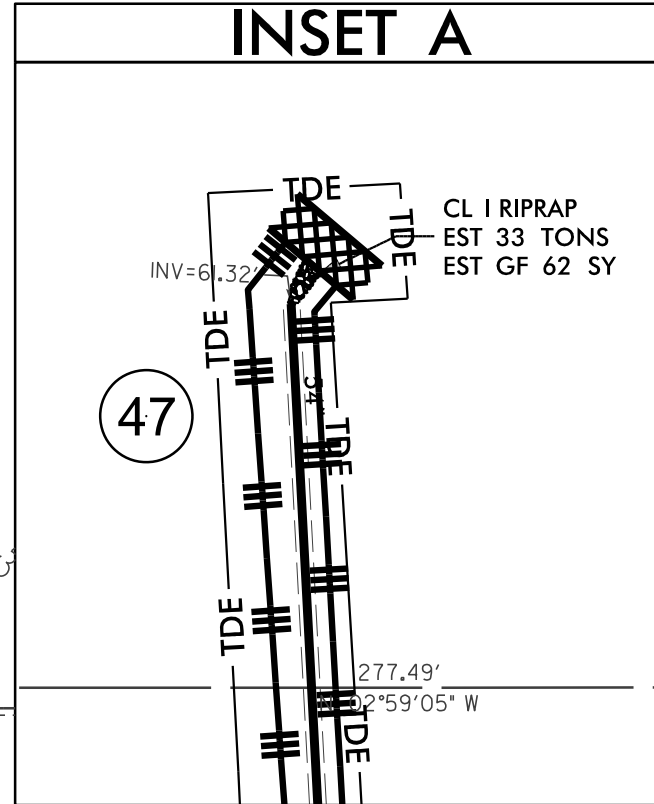
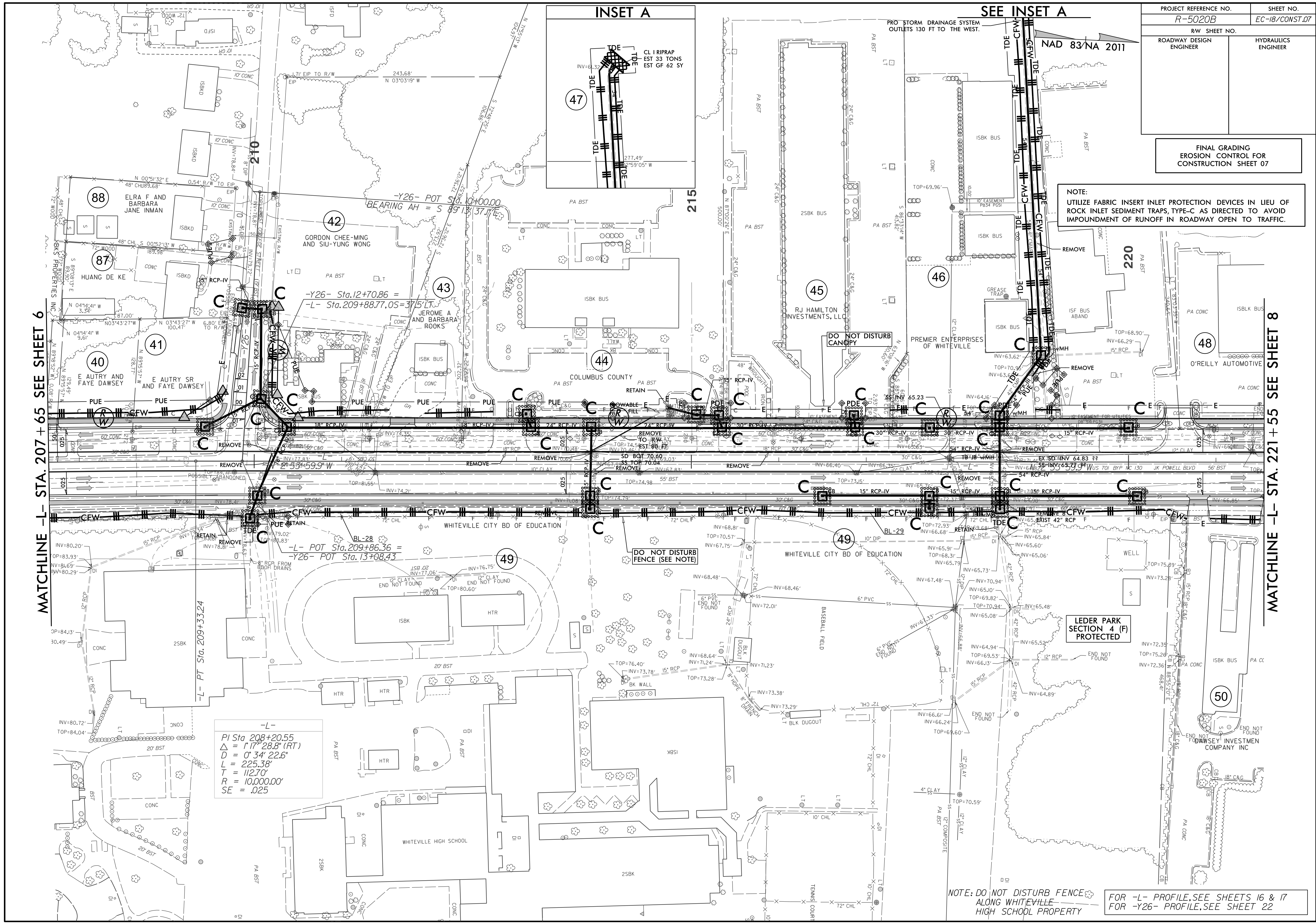

SEE INSET A

NAD 83/NA 2011

MATCHLINE -L- STA. 207 + 65 SEE SHEET 6

MATCHLINE -L- STA. 221 + 55 SEE SHEET 8

-L-
PI Sta. 208+20.55
Δ = 117° 28.8' (RT)
D = 0' 34' 22.6"
L = 225.38'
T = 112.70'
R = 10,000.00'
SE = .025

NOTE: DO NOT DISTURB FENCE
ALONG WHITEVILLE
HIGH SCHOOL PROPERTY

FOR -L- PROFILE, SEE SHEETS 16 & 17
FOR -Y26- PROFILE, SEE SHEET 22