

PROJECT REFERENCE NO.	SHEET NO.
R-5020B	EC-07/CONST.07
RW SHEET NO.	
ROADWAY DESIGN ENGINEER	HYDRAULICS ENGINEER

CLEARING AND GRUBBING  
EROSION CONTROL FOR  
CONSTRUCTION SHEET 07

NOTE:  
UTILIZE FABRIC INSERT INLET PROTECTION DEVICES IN LIEU OF  
ROCK INLET SEDIMENT TRAPS, TYPE-C AS DIRECTED TO AVOID  
IMPOUNDMENT OF RUNOFF IN ROADWAY OPEN TO TRAFFIC.

NOTE:  
PLACE TEMPORARY ROCK SEDIMENT DAMS TYPE - B  
AND TEMPORARY ROCK SILT CHECKS TYPE - A AT  
DRAINAGE OUTLETS.

NOTE: DO NOT DISTURB FENCE  
ALONG WHITEVILLE  
HIGH SCHOOL PROPERTY

FOR -L- PROFILE, SEE SHEETS 16 & 17  
FOR -Y26- PROFILE, SEE SHEET 22

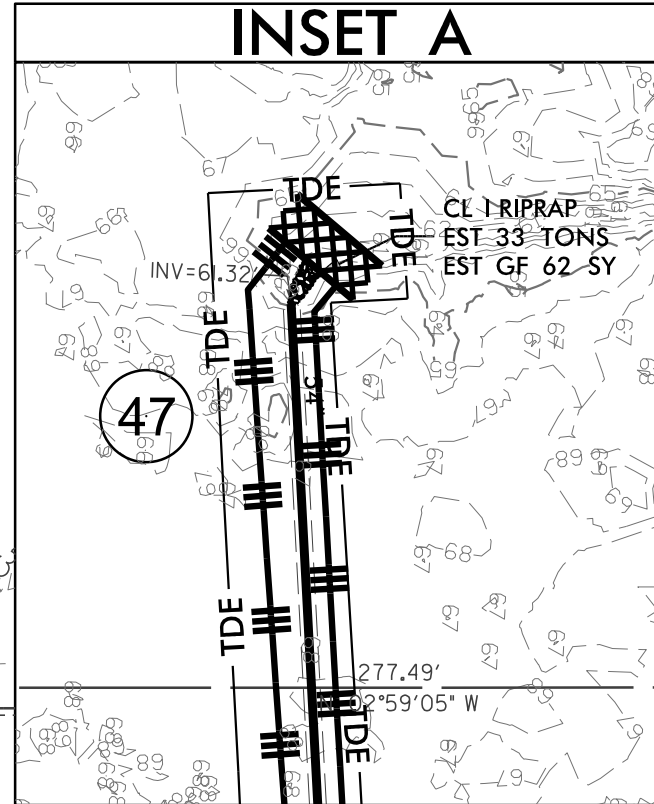
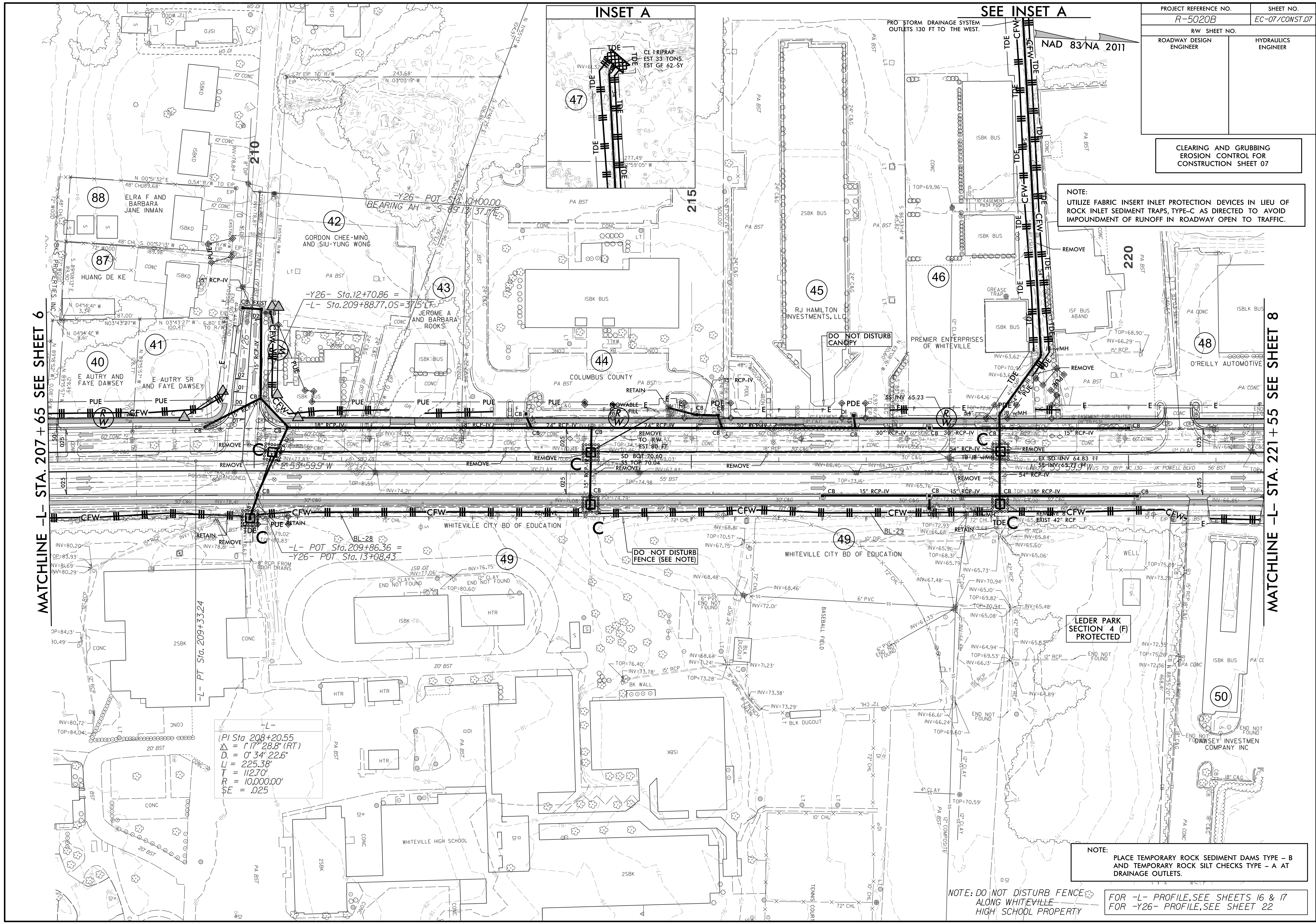

SEE INSET A

PRO STORM DRAINAGE SYSTEM  
OUTLETS 130 FT TO THE WEST.

NAD 83/NA 2011

MATCHLINE -L- STA. 207 + 65 SEE SHEET 6

MATCHLINE -L- STA. 221 + 55 SEE SHEET 8

-L-  
PI Sta. 208+20.55  
Δ = 117° 28.8' (RT)  
D = 0° 34' 22.6"  
L = 225.38'  
T = 112.70'  
R = 10,000.00'  
SE = .025

LEDER PARK  
SECTION 4 (F)  
PROTECTED

DO NOT DISTURB  
FENCE (SEE NOTE)

DO NOT DISTURB  
CANOPY

-Y26- POT Sta. 10+00.00  
BEARING AH = S 89° 18' 37.17\"/>

-Y26- Sta. 12+70.86 =  
-L- Sta. 209+88.77.05 = 37.5' LT

-L- POT Sta. 209+86.36 =  
-Y26- POT Sta. 13+08.43

-L- PT Sta. 209+33.24

88 ELRA F AND BARBARA JANE INMAN

87 HUANG DE KE

40 F AUTRY AND FAYE DAWSEY

41 F AUTRY SR AND FAYE DAWSEY

42 GORDON CHEE-MING AND SIU-YUNG WONG

43 JEROME A AND BARBARA ROOKS

44 COLUMBUS COUNTY

45 RJ HAMILTON INVESTMENTS, LLC

46 PREMIER ENTERPRISES OF WHITEVILLE

48 O'REILLY AUTOMOTIVE

49 WHITEVILLE CITY BD OF EDUCATION

50 LEDER PARK SECTION 4 (F) PROTECTED

WHITEVILLE HIGH SCHOOL

BASEBALL FIELD

BLK DUGOUT

TENNIS COURT

