

REFER TO ROADWAY STANDARD  
DRAWING 1101.03, SHEET 1 OF 9  
FOR APPLICABLE NOTES.

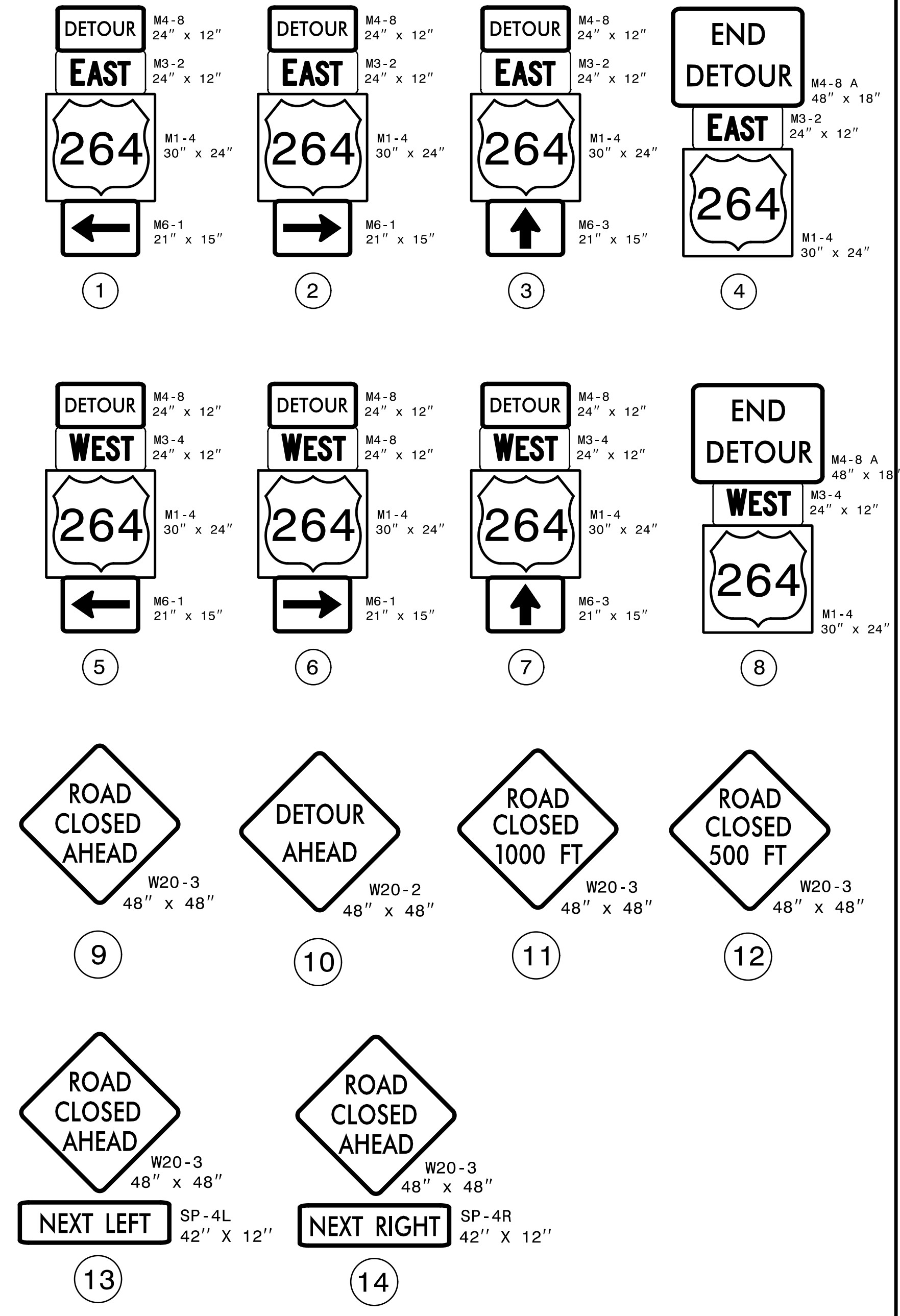

**DETOUR ROUTE**

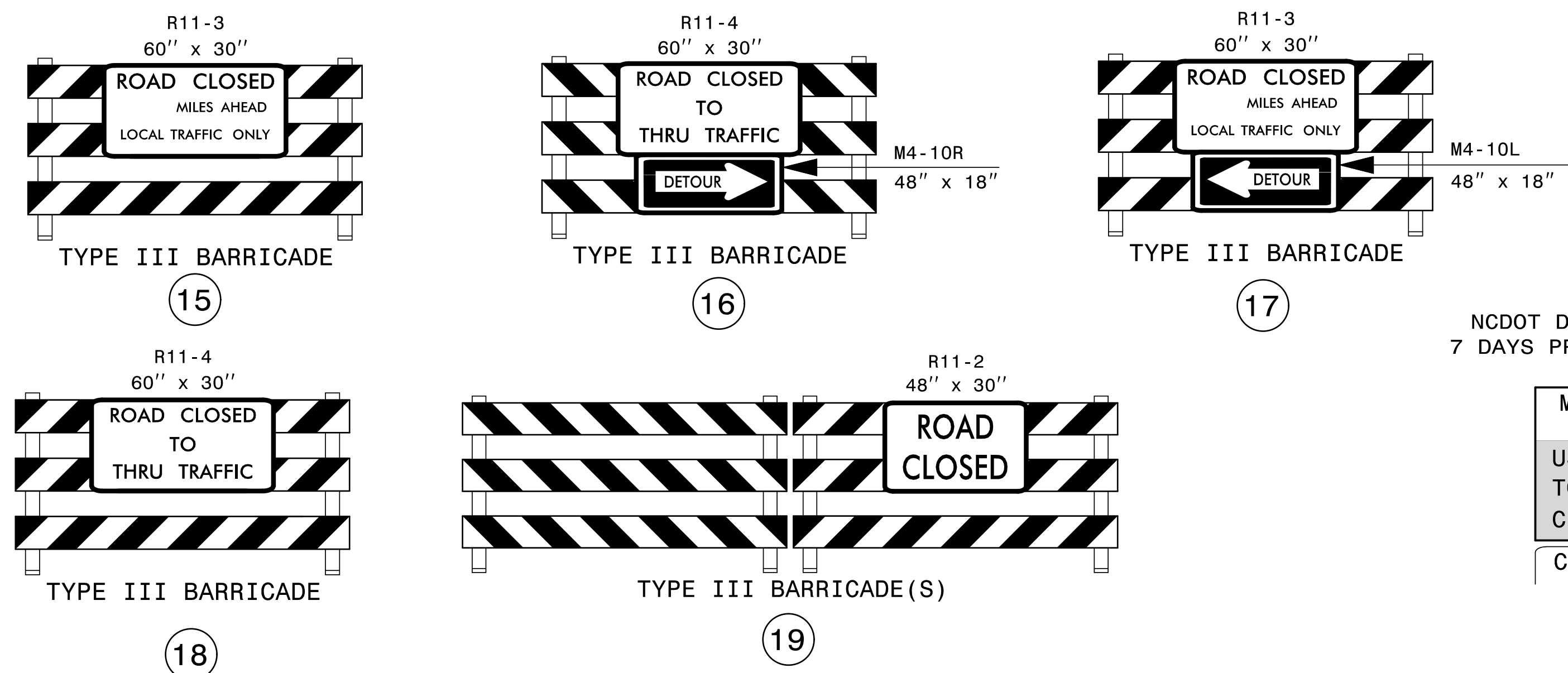

NCDOT DIVISION 2 TO INSTALL CMS  
7 DAYS PRIOR TO ROAD BEING CLOSED.

MESSAGE NO. 1	MESSAGE NO. 2
US 264	(DAY)
TO BE	(DATE)
CLOSED	

CHANGEABLE MESSAGE SIGN

APPROVED: *Tommy Aguilera, PE*  
DATE: 1/26/2021 | 9:29 AM  
SEAL  
NORTH CAROLINA PROFESSIONAL ENGINEER  
CLIFTON T. REGISTER  
028392

DIVISION OF HIGHWAYS  
STATE OF NORTH CAROLINA  
DEPARTMENT OF TRANSPORTATION  
WORK ZONE TRAFFIC CONTROL

**OFFSITE DETOUR ROUTE AND BARRICADE PLACEMENT**

1/12/2021 11:20:00 AM x:\ncdot\4414\Traffic\TrafficControl\4414\_TC\_TMP\_03\DETOUR.dgn User:tbvans