

PLACE CMS 2 WEEKS IN ADVANCED OF CLOSURE

MESSAGE NO. 1	MESSAGE NO. 2
MIZPAH CH RD TO CLOSE	DATE TO DATE

CHANGEABLE MESSAGE SIGN

DISPLAY DURING CLOSURE

MESSAGE NO. 1	MESSAGE NO. 2
MIZPAH CH RD CLOSED	FOLLOW DETOUR

CHANGEABLE MESSAGE SIGN

DISPLAY DURING CLOSURE

MESSAGE NO. 1	MESSAGE NO. 2
MIZPAH CH RD CLOSED	FOLLOW DETOUR

CHANGEABLE MESSAGE SIGN

PLACE CMS 2 WEEKS IN ADVANCED OF CLOSURE

MESSAGE NO. 1	MESSAGE NO. 2
MIZPAH CH RD TO CLOSE	DATE TO DATE

CHANGEABLE MESSAGE SIGN

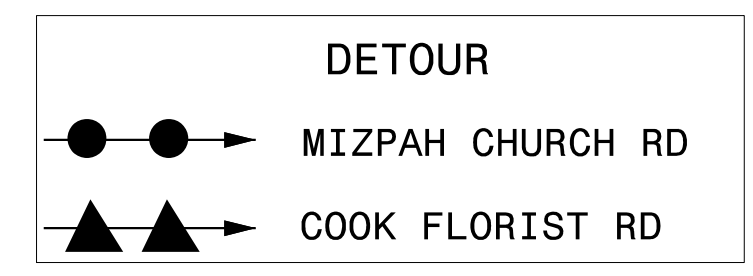
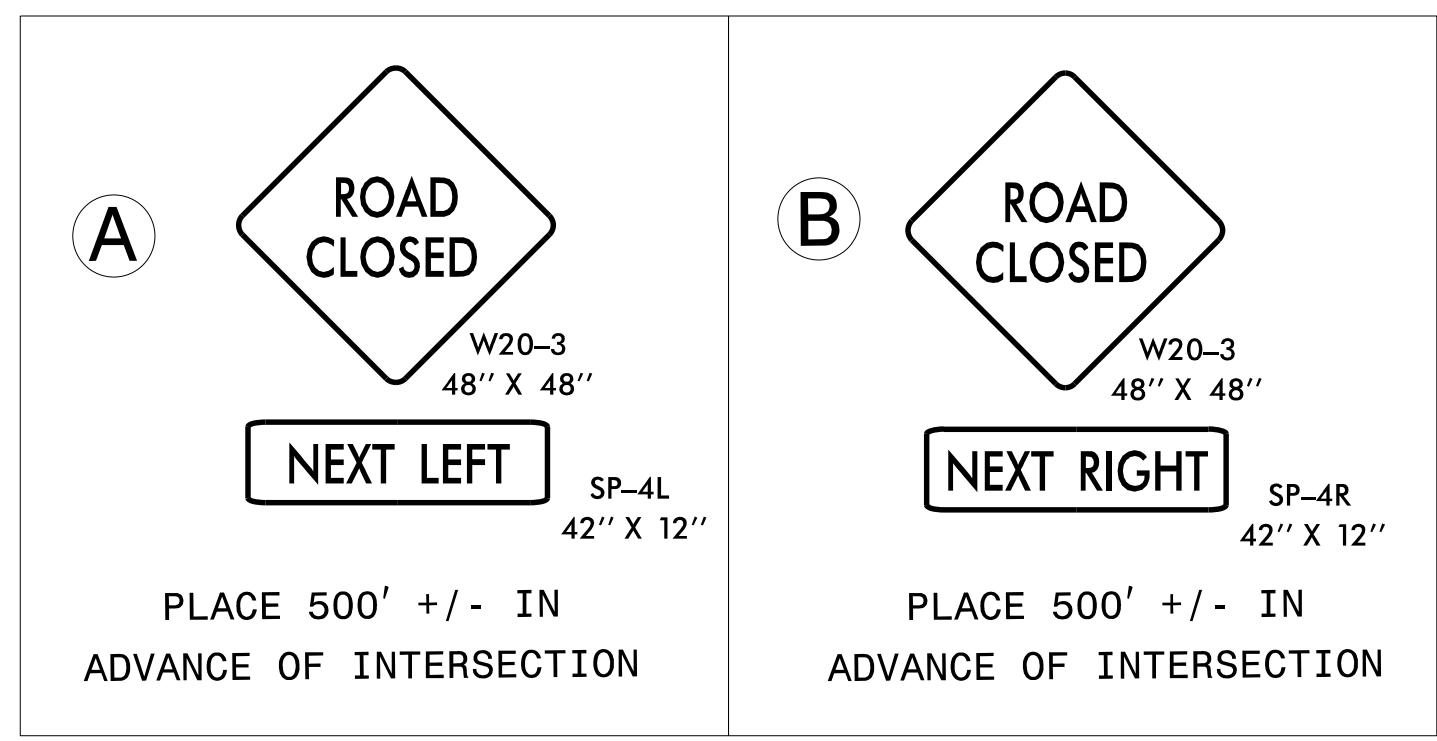

APPROVED: *Jeffrey A. Koontz*

DATE: 5/28/2020

DOCUMENT NOT CONSIDERED FINAL UNLESS ALL SIGNATURES COMPLETED

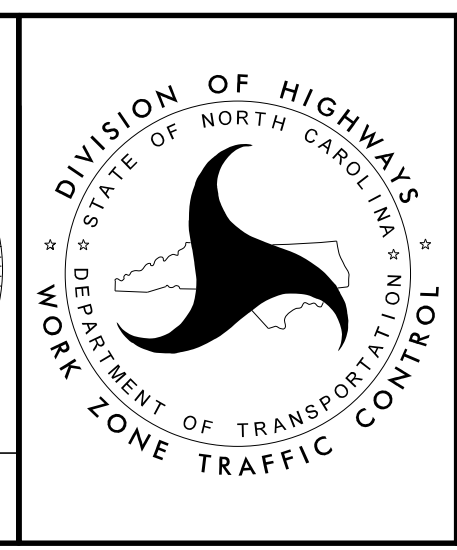

PHASE III OFF-SITE DETOUR

DEPARTMENT OF TRANSPORTATION  
WORK ZONE TRAFFIC CONTROL

5/28/2020  
 R:\Traffic\Traffic Control\TC\BR0042\_TC\_TMP\_PSH\_U3\_DETOUT.dgn  
 User:jeff.koontz