

PLAN - SILL LOCATION
SHOWING PLACEMENT OF SILLS

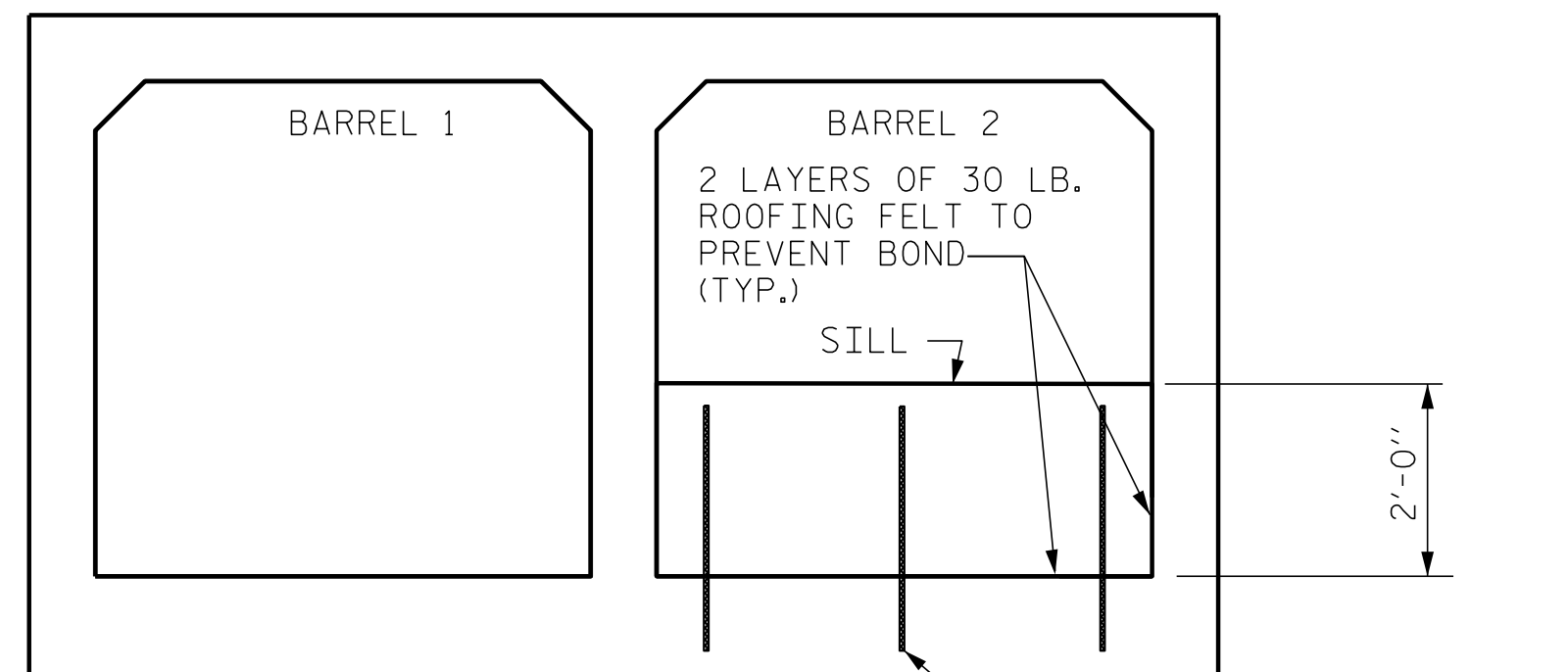

INLET ELEVATION
LOOKING DOWNSTREAM

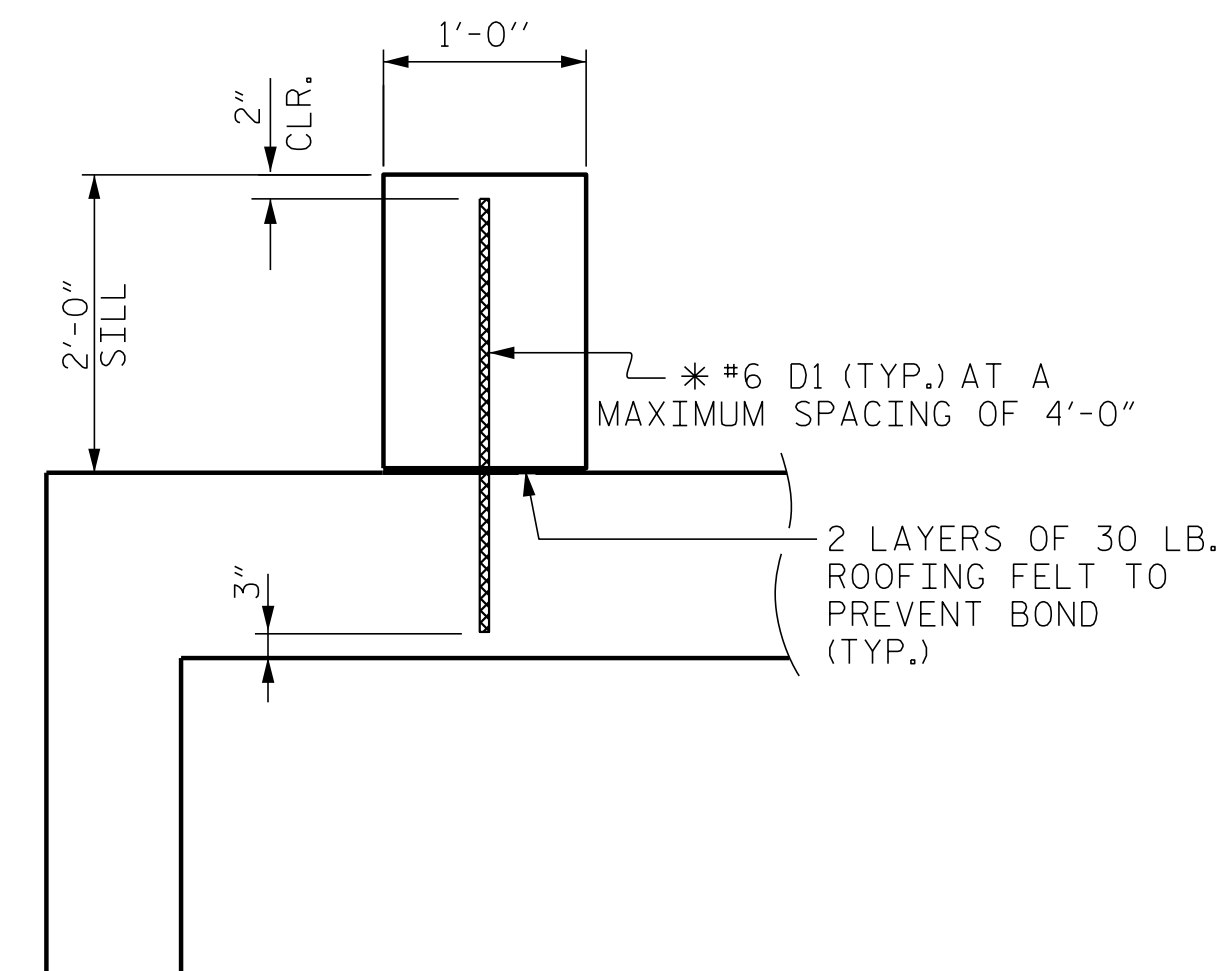

SECTION THROUGH SILL

* DOWELS MAY BE PUSHED INTO GREEN CONCRETE AFTER SLAB HAS BEEN FLOAT FINISHED.

CULVERT SILL DETAILS

PROJECT NO. W-5600
JOHNSTON COUNTY
STATION: 28+84.00 -Y7-

SHEET 7 OF 8

ENGINEER OF RECORD:
3/25/2019

Developed by
Buck Charles Hunt
ETHERILL
ENGINEERING

1223 Jones Franklin Rd.
Raleigh, N.C. 27606
Bus: 919 851 8077
Fax: 919 851 8107
LICENSE NO. F-0377

STATE OF NORTH CAROLINA
DEPARTMENT OF TRANSPORTATION
RALEIGH
**DOUBLE 10 FT. X 7 FT.
CONCRETE BOX CULVERT
106° SKEW**

REVISIONS						SHEET NO.
NO.	BY:	DATE:	NO.	BY:	DATE:	C3-7
1			3			TOTAL SHEETS 8
2			4			

DRAWN BY : B.C. HUNT DATE : 5-18
CHECKED BY : J.A. DILWORTH DATE : 5-18

DOCUMENT NOT CONSIDERED FINAL
UNLESS ALL SIGNATURES COMPLETED

P:\2017\171212101\W-5600\USTO\Structures\Culverts\CS14\DC\W5600_C514_WE I.cb222.dgn
 3/20/2019 1:31:43 PM