

### NOTES

THE COST OF THE BARRIER RAIL ON THE APPROACH SLAB SHALL BE INCLUDED IN THE LINEAR FOOT CONTRACT PRICE BID FOR "CONCRETE BARRIER RAIL".

THE BARRIER RAIL ON EACH APPROACH SLAB SHALL NOT BE CAST UNTIL ALL APPROACH SLAB CONCRETE HAS BEEN CAST AND HAS REACHED A MINIMUM COMPRESSIVE STRENGTH OF 3,000 PSI.

WHEN FOAM JOINT SEAL IS REQUIRED, THE JOINT IN THE APPROACH SLAB SHALL BE SAWED PRIOR TO THE CASTING OF BARRIER RAIL.

ALL REINFORCING STEEL IN BARRIER RAILS SHALL BE EPOXY COATED.

THE #5 S3 AND S4 BARS SHALL BE INSTALLED, USING AN ADHESIVE ANCHORING SYSTEM, AFTER SAWING THE JOINT. THE YIELD LOAD FOR THE #5 S3 AND S4 BARS IS 18.6 KIPS. FIELD TESTING FOR THE ADHESIVE BONDING SYSTEM IS NOT REQUIRED.

GROOVED CONTRACTION JOINTS, 1/2" IN DEPTH, SHALL BE TOOLED IN ALL EXPOSED FACES OF THE BARRIER RAIL AND IN ACCORDANCE WITH ARTICLE 825-10(B) OF THE STANDARD SPECIFICATIONS. THE CONTRACTION JOINT SHALL BE LOCATED AT THIRD POINTS.

### BILL OF MATERIAL

BARRIER RAIL ONLY					
BAR	NO.	SIZE	TYPE	LENGTH	WEIGHT
*B1	22	#5	STR	24'-7"	564
*S1	44	#5	1	5'-1"	233
*S2	44	#5	2	7'-0"	321
*S3	6	#5	3	4'-2"	26
*S4	6	#5	STR	4'-0"	25
* EPOXY COATED REINFORCING STEEL				LBS.	1,169
CLASS AA CONCRETE				C. Y.	6.8
CONCRETE BARRIER RAIL				50.00 LIN. FT.	

### BAR TYPES

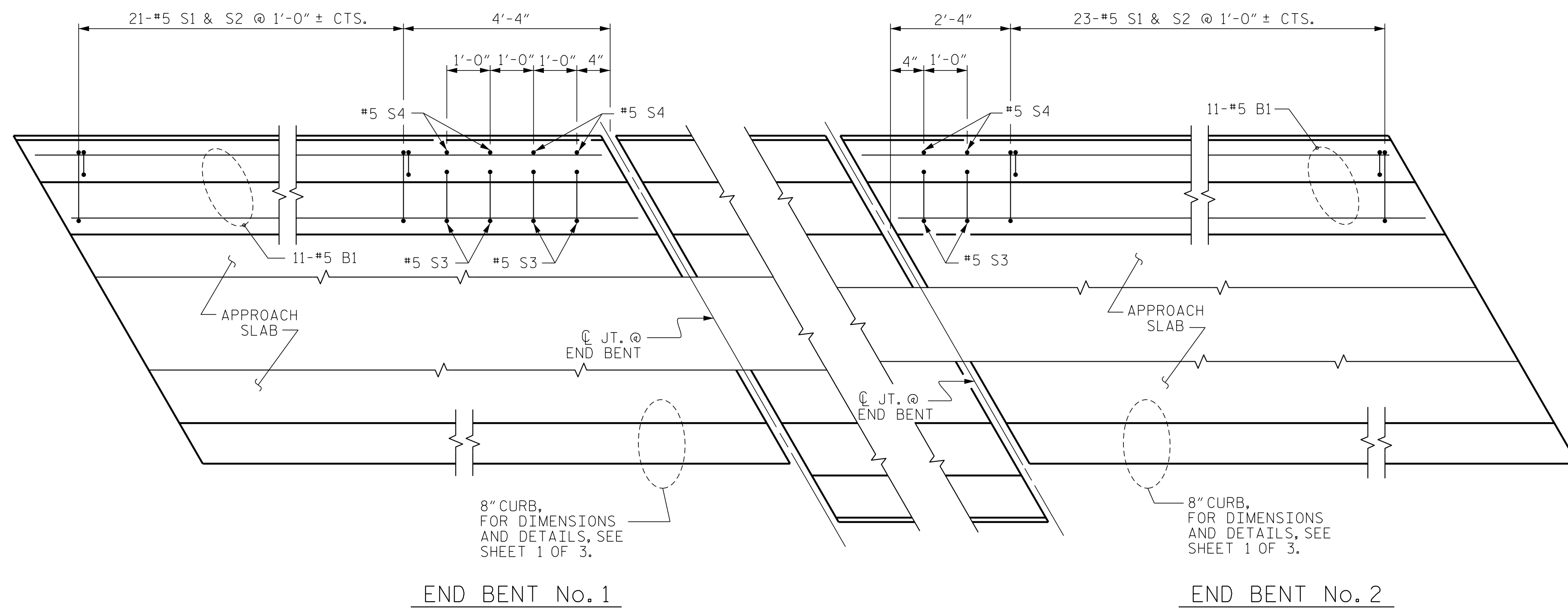
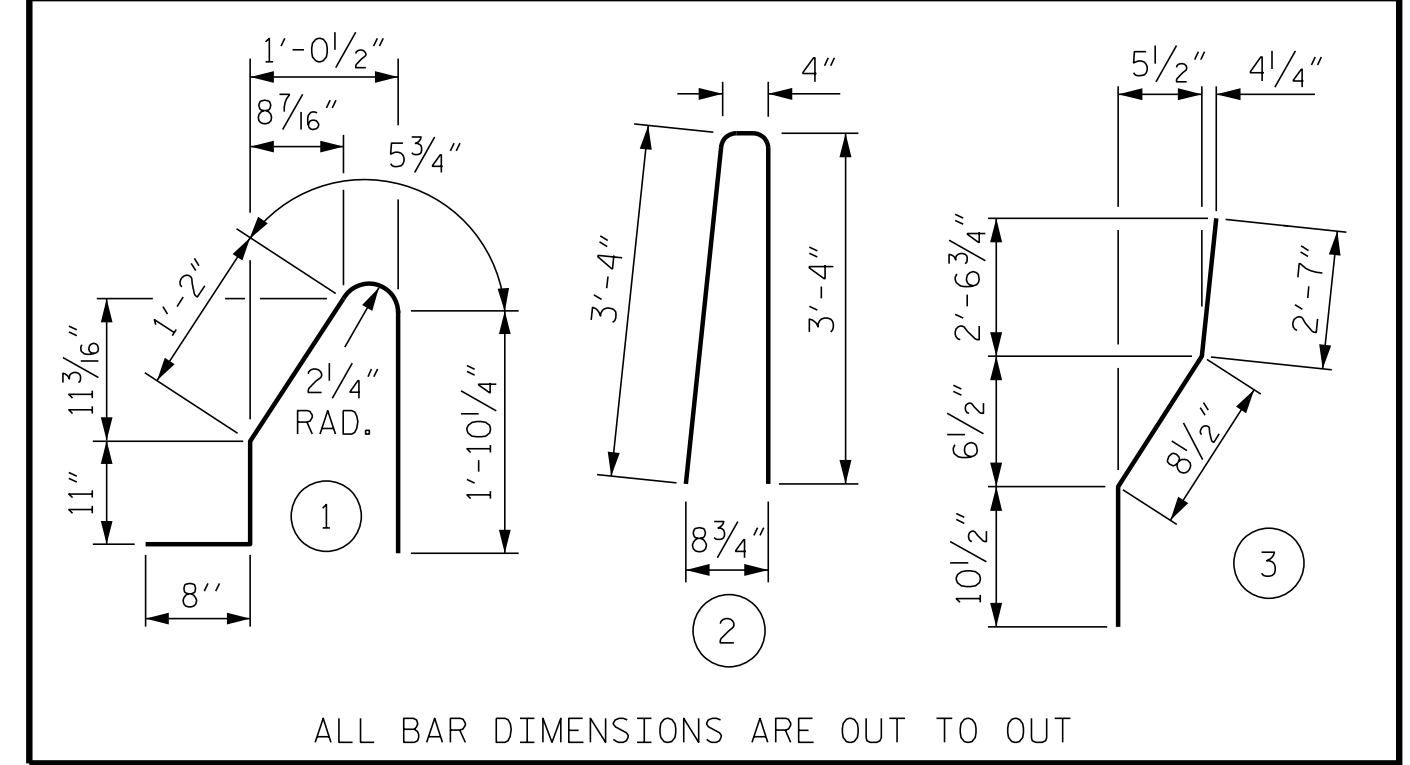

### PLAN OF BARRIER RAIL

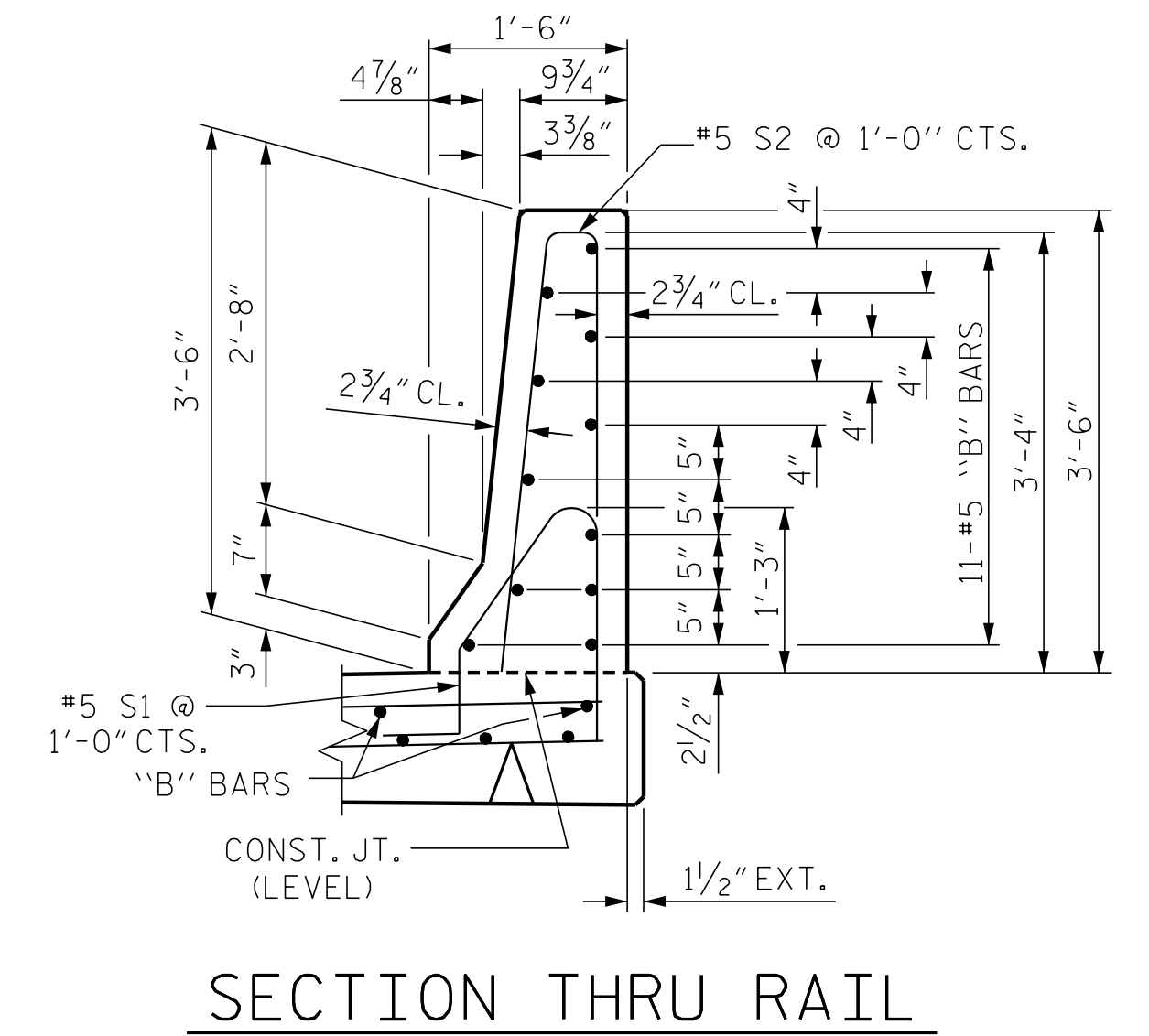

PROJECT NO. W-5600  
JOHNSTON COUNTY  
 STATION: 217+31.76 -L-

SHEET 2 OF 3

ASSEMBLED BY : D. HODGE DATE : 1/18  
 CHECKED BY : B.C. HUNT DATE : 2/18

DRAWN BY : FCJ 11/88 REV. 7/12 MAA/GM  
 3/20/2019 9:44:39 AM 11/88 REV. 6/13 MAA/GM  
 CHECKED BY : ARB 11/88 REV. 12/17 MAA/THC

DOCUMENT NOT CONSIDERED FINAL  
 UNLESS ALL SIGNATURES COMPLETED

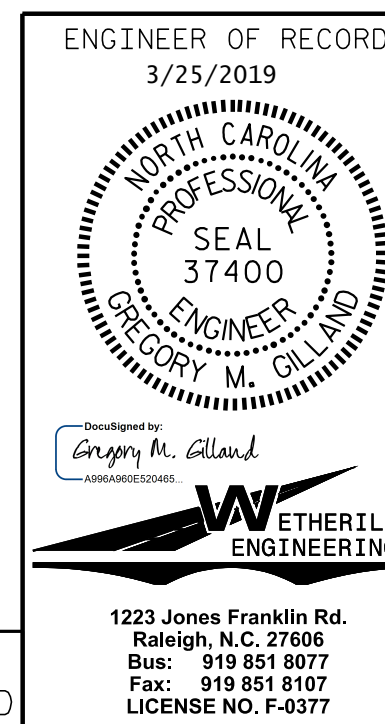

STATE OF NORTH CAROLINA  
 DEPARTMENT OF TRANSPORTATION  
 RALEIGH  
 STANDARD  
 BRIDGE APPROACH  
 SLAB DETAILS  
 (RIGHT LANE)

REVISIONS						SHEET NO.
NO.	BY:	DATE:	NO.	BY:	DATE:	TOTAL SHEETS
1			3			18
2			4			