

PLAN @ END BENT No. 1 PLAN @ END BENT No. 2

** DENOTES RADIAL DIMENSION ARC OFFSETS TO OUTSIDE EDGE OF APPROACH SLABS ARE NEGLIGIBLE, THEREFORE NOT SHOWN

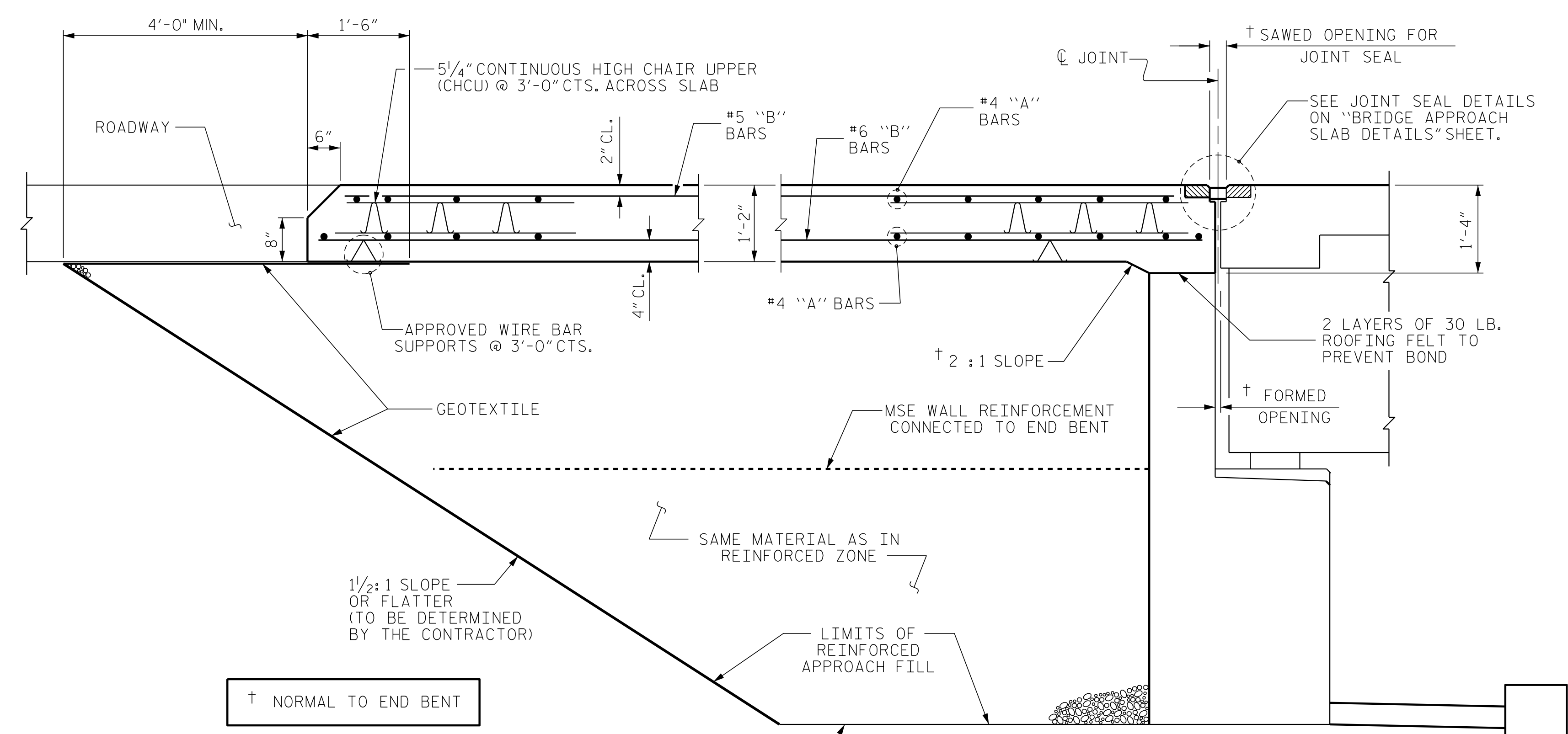

SECTION THRU SLAB

(TYPE III - REINFORCED APPROACH FILL)

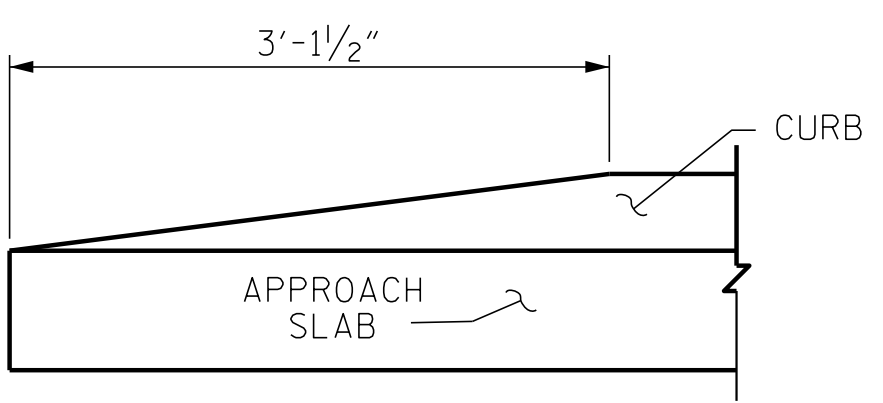
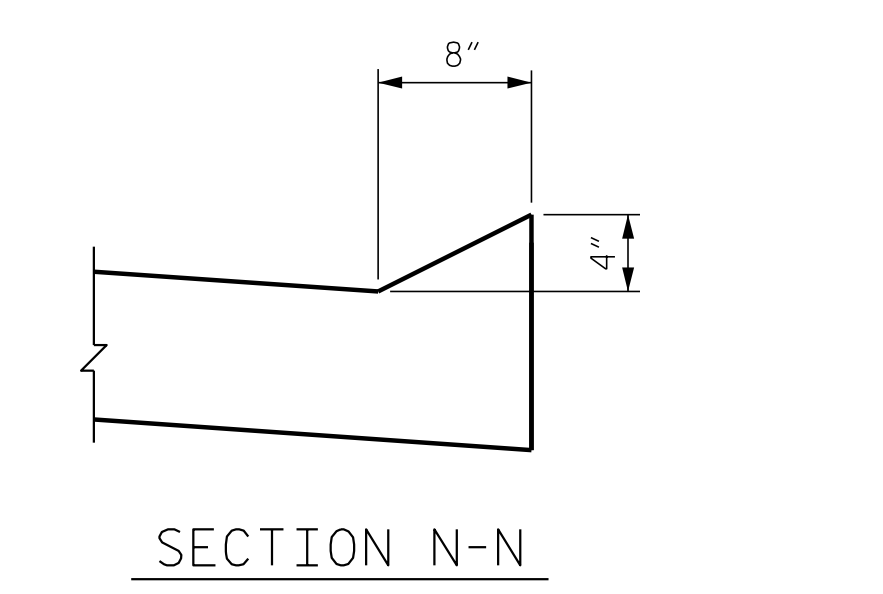

END OF CURB WITHOUT SHOULDER BERM GUTTER

NOTES

- FOR BRIDGE APPROACH FILL INCLUDING GEOTEXTILE, MSE WALL REINFORCEMENT AND BACKFILL MATERIAL SEE ROADWAY PLANS.
- GEOTEXTILE SHALL BE TYPE 1 IN ACCORDANCE WITH THE STANDARD SPECIFICATIONS SECTION 1056.
- BACKFILL MATERIAL SHALL BE THE SAME MATERIAL USED IN THE MSE REINFORCED ZONE.
- APPROACH SLAB SHALL NOT BE CONSTRUCTED PRIOR TO COMPLETION OF THE BRIDGE DECK.
- THE JOINT SHALL BE SAWS PRIOR TO THE CASTING OF THE BARRIER RAIL.
- AREA BETWEEN THE WINGWALL AND APPROACH SLAB SHALL BE GRADED TO DRAIN THE WATER AWAY FROM THE FILL FACE OF THE BRIDGE AND SHALL BE PAVED. SEE ROADWAY PLANS.
- WITH FOAM JOINT SEAL
- FOR FOAM JOINT SEALS, SEE SPECIAL PROVISIONS.
- THE NOMINAL UNCOMPRESSED SEAL WIDTH OF THE FOAM JOINT SEAL SHALL BE 2".
- FOR ELASTOMERIC CONCRETE, SEE SPECIAL PROVISIONS.

BILL OF MATERIAL					
APPROACH SLAB AT END BENT 1					
BAR	NO.	SIZE	TYPE	LENGTH	WEIGHT
*A1	50	#4	STR	26'-4"	880
A2	52	#4	STR	26'-2"	909
*B1	92	#5	STR	24'-0"	2303
B2	92	#6	STR	24'-7"	3397
REINFORCING STEEL					LBS. 4,306
*EPOXY COATED REINFORCING STEEL					LBS. 3,183
CLASS AA CONCRETE					C. Y. 50.0
APPROACH SLAB AT END BENT 2					
BAR	NO.	SIZE	TYPE	LENGTH	WEIGHT
*A1	50	#4	STR	26'-4"	880
A2	52	#4	STR	26'-2"	909
*B1	92	#5	STR	24'-0"	2303
B2	92	#6	STR	24'-7"	3397
REINFORCING STEEL					LBS. 4,306
*EPOXY COATED REINFORCING STEEL					LBS. 3,183
CLASS AA CONCRETE					C. Y. 50.0

FOR BARRIER RAIL QUANTITIES ON APPROACH SLAB, SEE SHEET 2 OF 3

SPlice LENGTHS		
BAR SIZE	EPOXY COATED	UNCOATED
#4	2'-0"	1'-9"
#5	2'-6"	2'-2"
#6	3'-10"	2'-7"

P:\2017\1712101\W-5600_USTO\Structures\DGN\L-over-y9-dgn (LEFT LANE)\WE I.dgn
 3/20/2019 8:40:15 AM

ASSEMBLED BY : D. HODGE	DATE : 1/18
CHECKED BY : B.C. HUNT	DATE : 2/18
DRAWN BY : EEM 3/95	REV. 12/21/11 MAA/GM
CHECKED BY : VAP 3/95	REV. 6/13 MAA/GM
	REV. 12/17 MAA/THC

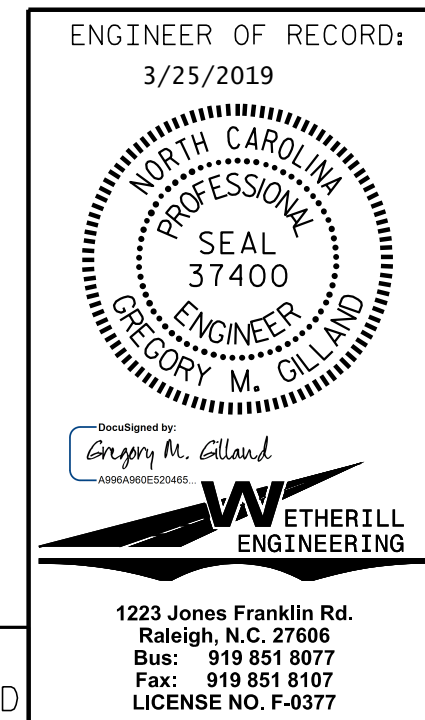

PROJECT NO. W-5600
JOHNSTON COUNTY
 STATION: 217+31.76 -L-
 SHEET 1 OF 3

STATE OF NORTH CAROLINA DEPARTMENT OF TRANSPORTATION RALEIGH					
STANDARD BRIDGE APPROACH SLAB FOR FLEXIBLE PAVEMENT (LEFT LANE)					
REVISIONS					
NO.	BY:	DATE:	NO.	BY:	DATE:
1			3		
2			4		
SHEET NO. S1-25					TOTAL SHEETS 27

DOCUMENT NOT CONSIDERED FINAL UNLESS ALL SIGNATURES COMPLETED