

TIP PROJECT: W-5600

CONTRACT: C204359

STATE OF NORTH CAROLINA
DIVISION OF HIGHWAYS

JOHNSTON COUNTY

LOCATION: US 70 FROM EAST OF US 70 BUSINESS TO WEST OF NEUSE RIVER.

TYPE OF WORK: CCTV AND DYNAMIC MESSAGE SIGN INSTALLATION

STATE	STATE PROJECT REFERENCE NO.	SHEET NO.
N.C.	W-5600	ITS-1
STATE PROJ. NO.	F.A. PROJ. NO.	DESCRIPTION
50056.3.1	HSIP-0070(163)	CONST.

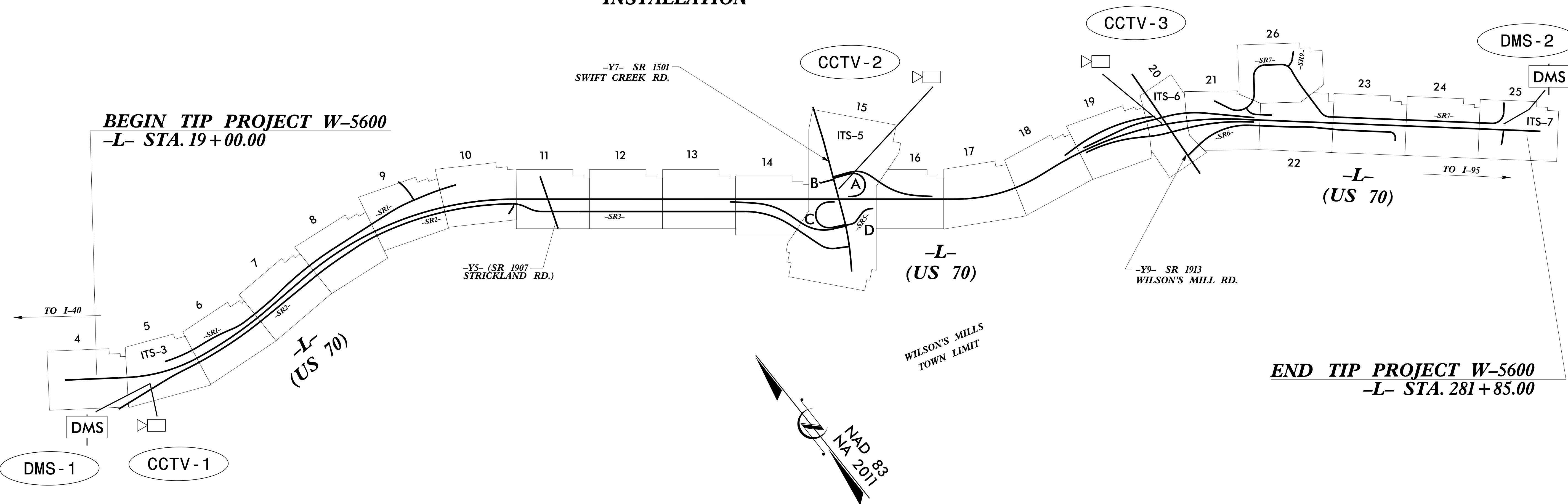

2018 STANDARD SPECIFICATIONS	
PROJECT LENGTH PROJECT LENGTH = 4.978 MILES	
LETTING DATE: SEPTEMBER 15, 2020	
INDEX OF SHEETS	
SHEET ITS 1	TITLE SHEET
SHEET ITS 2	CONSTRUCTION NOTES AND LEGEND
SHEET ITS 3-8	ITS PLANS
SHEET ITS 9-12	TYPICAL DETAILS

ROADWAY STANDARD DRAWINGS	
THE FOLLOWING ROADWAY STANDARDS AS APPEAR IN "ROADWAY STANDARD DRAWINGS" ROADWAY DESIGN UNIT - N.C. DEPARTMENT OF TRANSPORTATION - RALEIGH, N.C., DATED JANUARY 2018 ARE APPLICABLE TO THIS PROJECT AND BY REFERENCE HEREBY ARE CONSIDERED A PART OF THESE PLANS:	
STD. NO.	TITLE
1700.01	ELECTRICAL SERVICE OPTIONS
1700.02	ELECTRICAL SERVICE GROUNDING
1715.01	UNDERGROUND CONDUIT-TRENCHING
1716.01	JUNCTION BOXES
1720.01	WOOD POLES
1751.01	CONTROLLER AND CABINETS
1751.02	CONTROLLER AND CABINETS

NC DOT CONTACT:
TRANSPORTATION MOBILITY AND SAFETY
M.A. ASLAMI, P.E.
STATE ITS & SIGNALS
MANAGEMENT ENGINEER



ENGLISH
ALL DIMENSIONS IN THESE PLANS ARE IN FEET UNLESS OTHERWISE NOTED

2018 STANDARD SPECIFICATION

SEAL
NORTH CAROLINA
PROFESSIONAL ENGINEER
ANDREW J. SKUCE
050152

DocuSigned by:
Andrew J. Skuce
026288CB85C464

6/3/2020