

PROJECT REFERENCE NO.	SHEET NO.
W-5600	EC-6A/CONST.6
RW SHEET NO.	
ROADWAY DESIGN ENGINEER	HYDRAULICS ENGINEER

CULVERT CONSTRUCTION SEQUENCE STA. 45+66 -L-

PHASE I

- 1: INSTALL SPECIAL STILLING BASINS AND IMPERVIOUS DIKS 1, 2 & 3. DIVERT FLOW INTO BARREL 'A' AND BARREL 'B'.
- 2: REMOVE EXISTING WINGWALL FROM THE INLET AND OUTLET OF BARREL 'C'.
- 3: EXTEND BARREL 'C'. CONSTRUCT PORTION OF BARREL 'C' HEADWALL AND WINGWALL. CONSTRUCT LOW FLOW CHANNEL IMPROVEMENTS.
- 4: REMOVE IMPERVIOUS DIKES 1, 2 & 3.

PHASE II

- 1: INSTALL IMPERVIOUS DIKS 4 & 5 AND DIVERT FLOW INTO BARREL 'C'.
- 2: REMOVE EXISTING WINGWALL FROM THE INLET OF BARREL 'A'.
- 3: EXTEND BARREL 'A' AND BARREL 'B'. CONSTRUCT PORTIONS OF HEADWALLS AND WINGWALLS. CONSTRUCT HIGH FLOW CHANNEL IMPROVEMENTS.
- 4: FINALIZE CONSTRUCTION OF -L-, -SR1- AND -SR2- ALIGNMENTS. REMOVE IMPERVIOUS DIKES 4 & 5. REMOVE SPECIAL STILLING BASINS.
- 5: COMPLETE ROADWAY

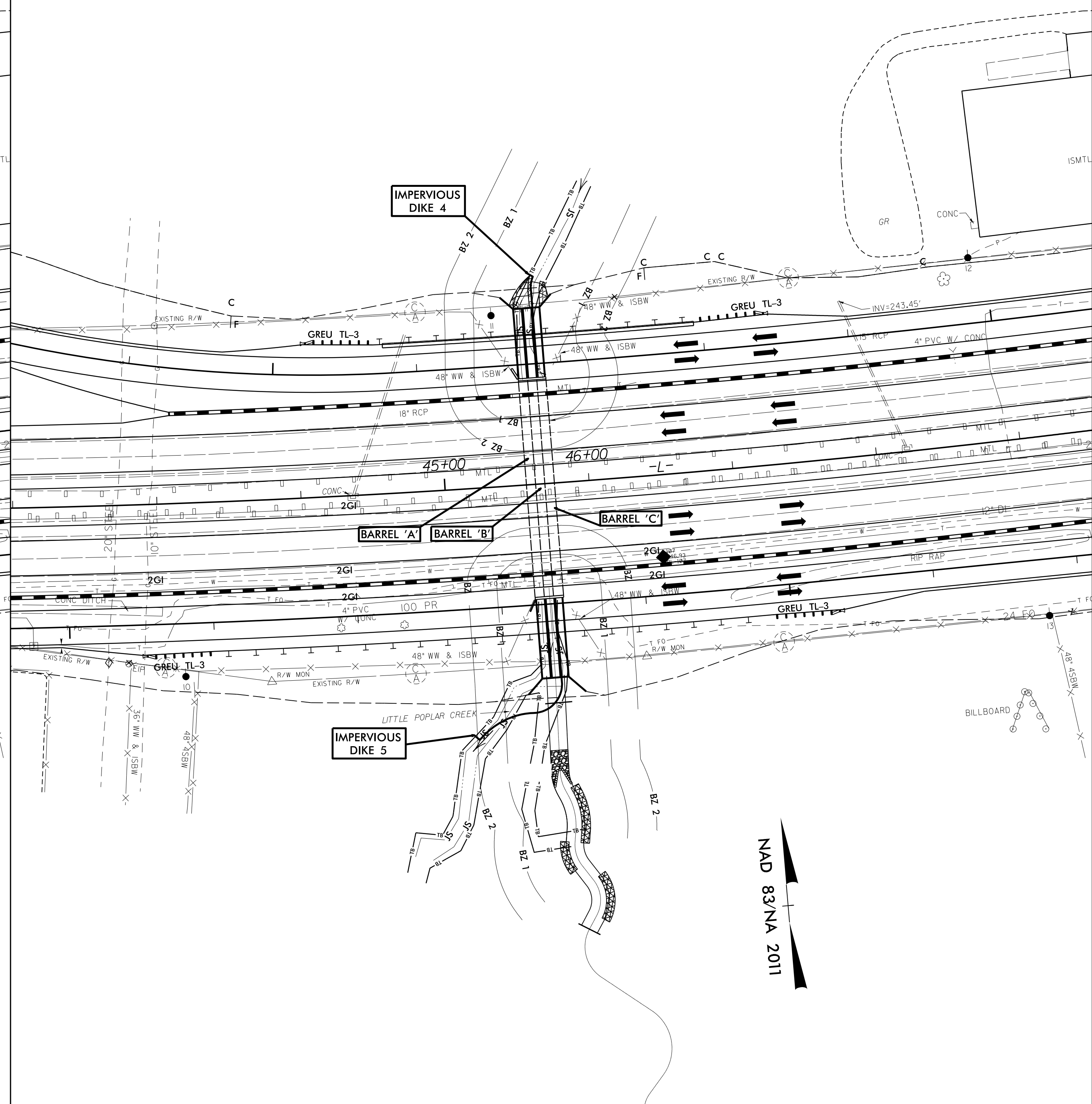
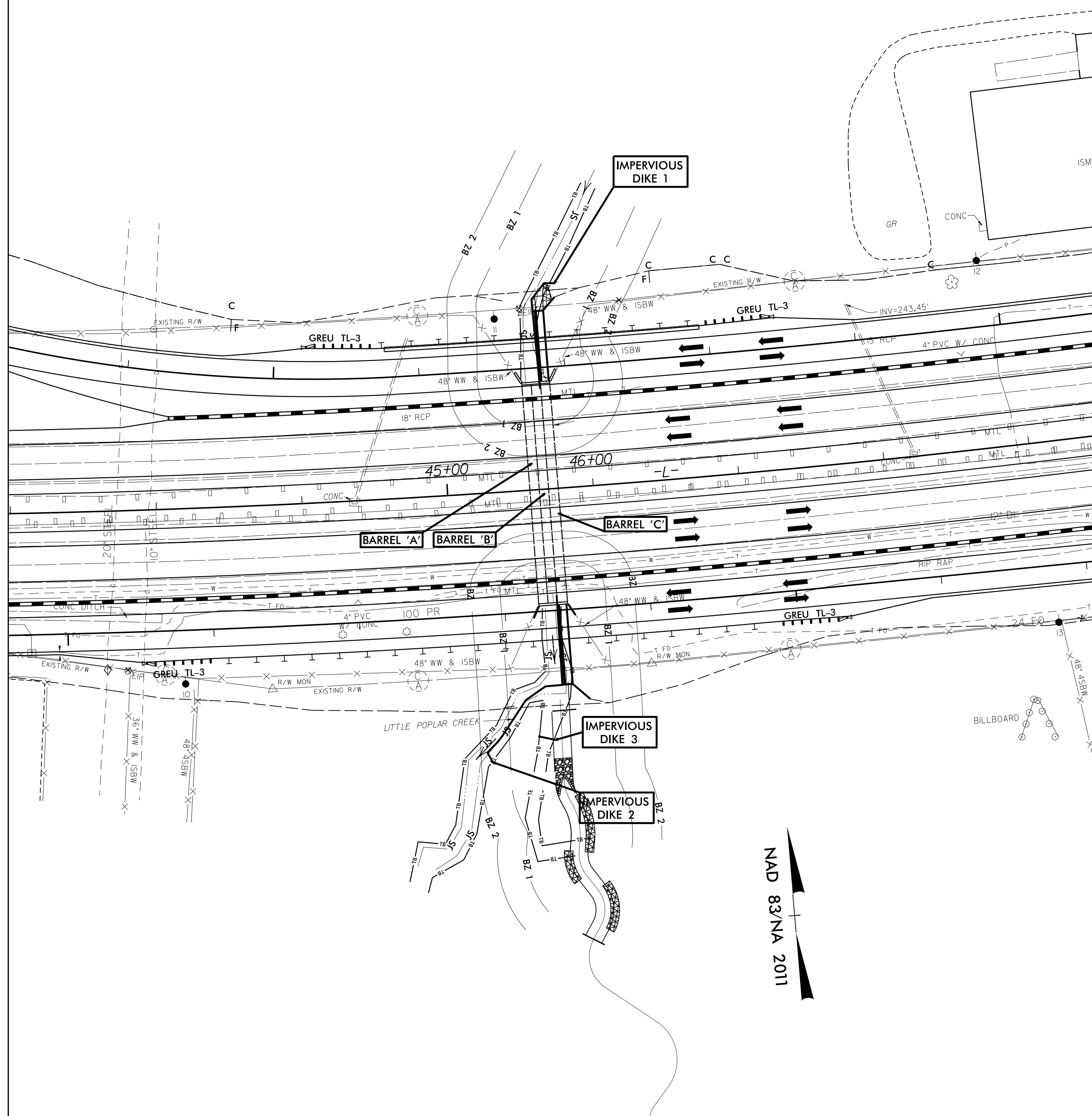

NAD 83/NA 2011

NAD 83/NA 2011