

**NOTES:**

FOR HOLE REPAIRS, SEE SPECIAL PROVISIONS.  
FOR PAY ITEMS, SEE SHEET 14 OF 14.

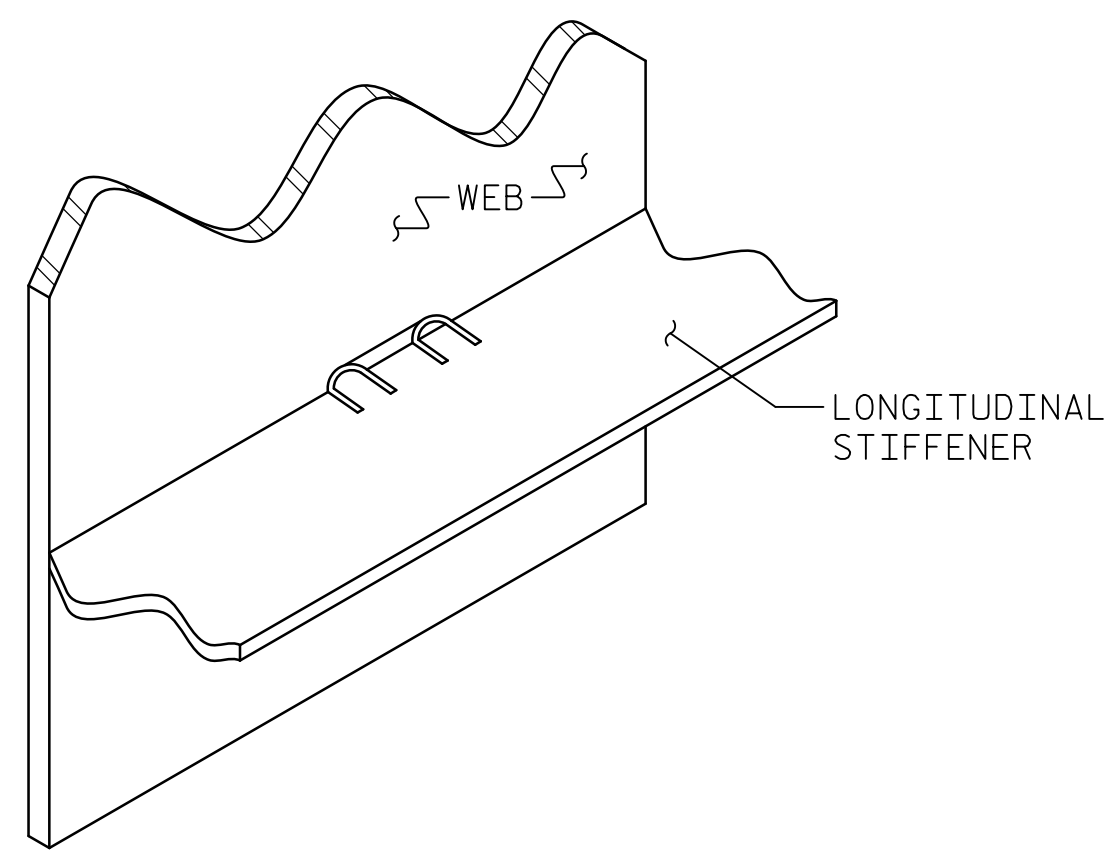

EXISTING HOLE

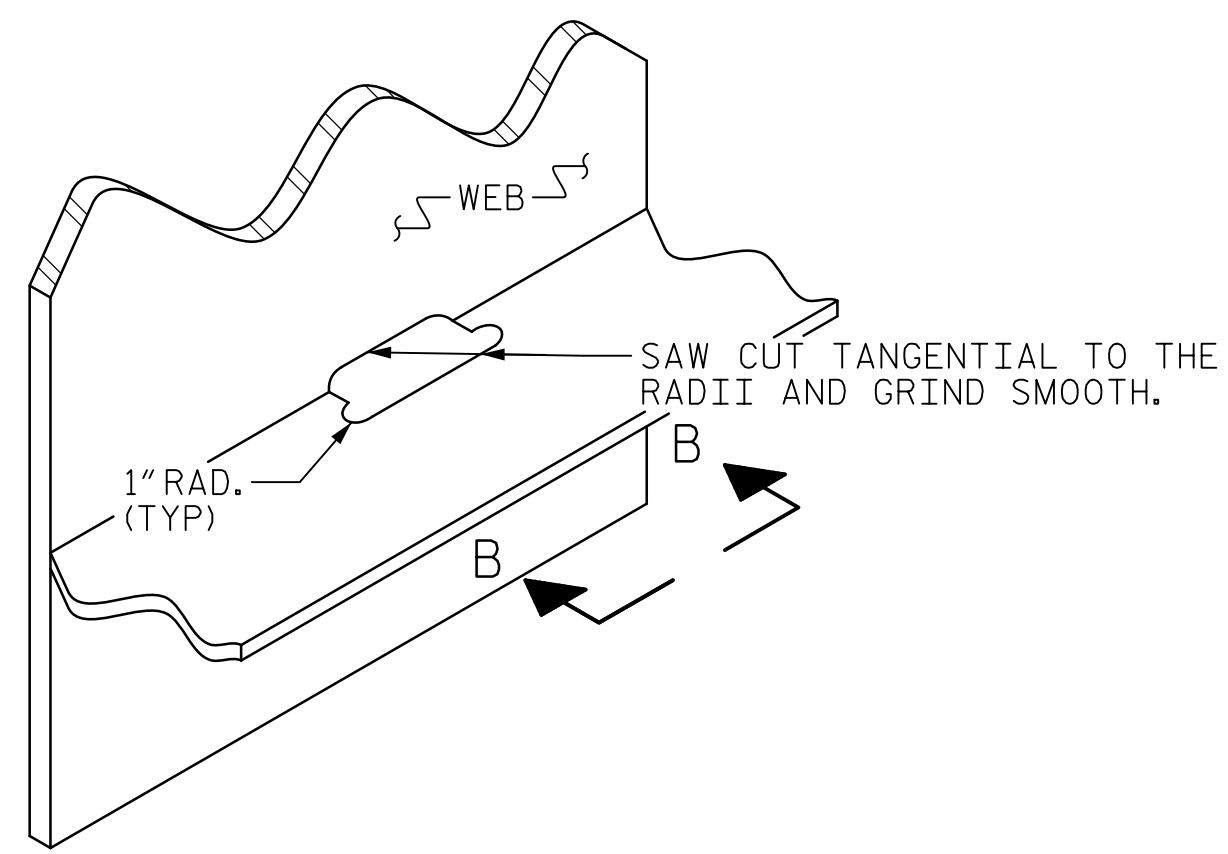

REPAIR

ISOMETRIC VIEW

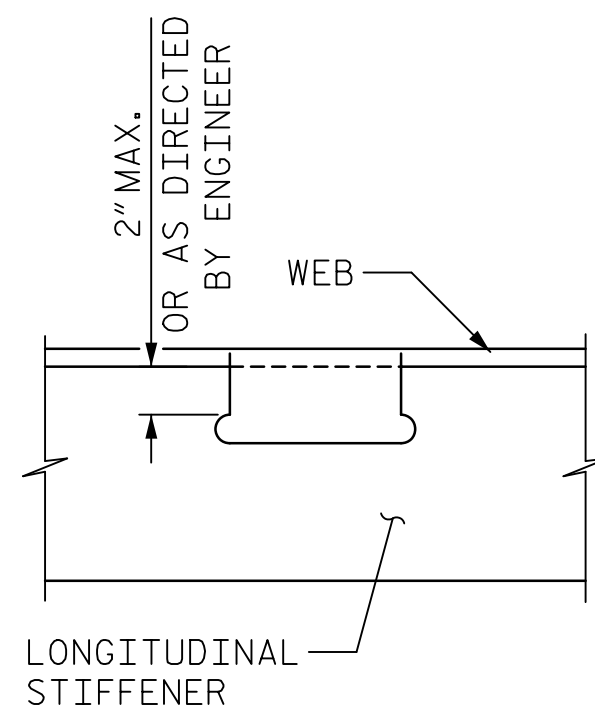

PLAN

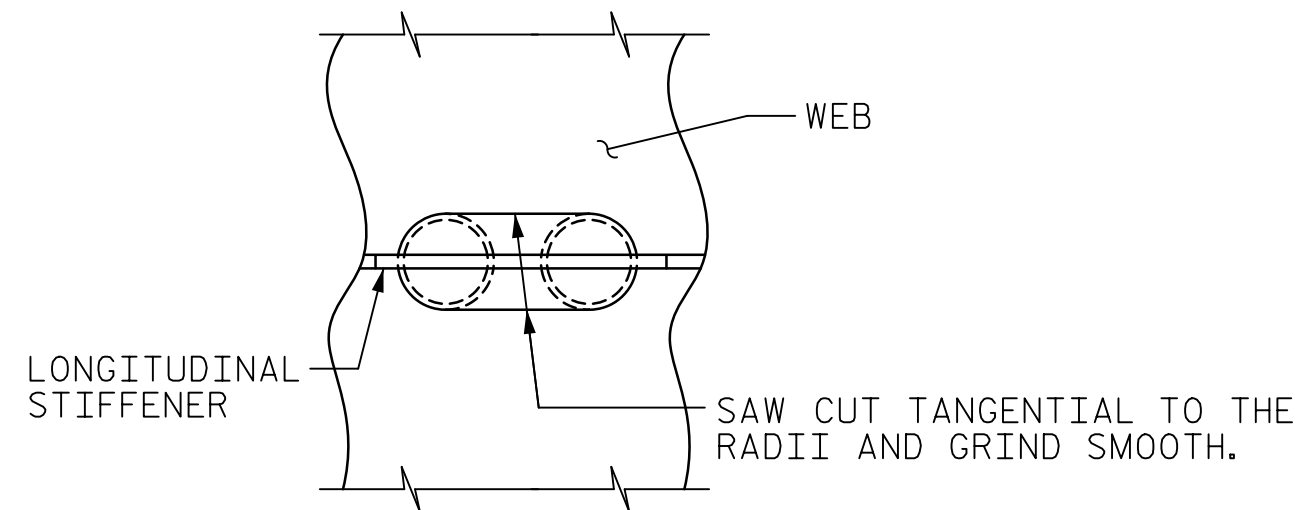

VIEW B-B

**HOLE REPAIR TYPE III**

FOR REPRESENTATION ONLY. REPAIR SHALL BE PERFORMED AT EACH LOCATION NOTED. FOR REPAIR LOCATIONS, SEE PHOTO LOCATION LEGEND.

**REPAIR PROCEDURE**

1. DRILL 1" RADIUS AT THE TERMINATION OF THE EXISTING OUTSIDE CUTS IN THE LONGITUDINAL STIFFENER.
2. SAW CUT BETWEEN THE HOLES IN THE WEB AND THE STIFFENER TANGENTIAL TO THE RADII OF THE HOLES.
3. GRIND SMOOTH ADJACENT AREAS OF THE WEB, LONGITUDINAL STIFFENER, AND WELDS.

HR-III-1



PHOTO

**LOCATION:**

HR-III-1 GIRDER 1, SPAN C, IN WEB AT BOTTOM LONGITUDINAL STIFFENER, 6'-1" WEST OF PANEL POINT 16: (2) 2" Ø HOLES AT APPROXIMATELY 3" SPACING CONNECTED BY SAW CUT

DATE: 2/28/2020 TIME: 10:54:40 AM

USER: MrcH\resmond DOB: R:\Structures\04 Drawings\01\_165\_15BPR20\_SML\_S9a.dgn

PROJECT NO. 15BPR.20  
HENDERSON COUNTY  
STATION: 35+30.22 -L-

SHEET 9 OF 14

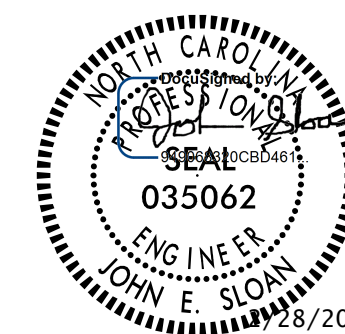

STATE OF NORTH CAROLINA  
DEPARTMENT OF TRANSPORTATION  
RALEIGH

REHABILITATION

STRUCTURAL STEEL  
REPAIRS

REVISIONS

NO.	BY:	DATE:	NO.	BY:	DATE:
1			3		
2			4		

SHEET NO.  
S-89  
TOTAL SHEETS  
129

DRAWN BY : M. TOM DATE : 2/2019  
CHECKED BY : G. COLS DATE : 2/2019  
DESIGNED BY : J. SLOAN DATE : 2/2019  
DESIGN CHECKED BY : E. ZHOU DATE : 2/2019

**HOLE REPAIRS TYPE III**  
FOR REPRESENTATION ONLY

DOCUMENT NOT CONSIDERED  
FINAL UNLESS ALL  
SIGNATURES COMPLETED