

DATE: 2/27/2020
TIME: 3:58:28 PM

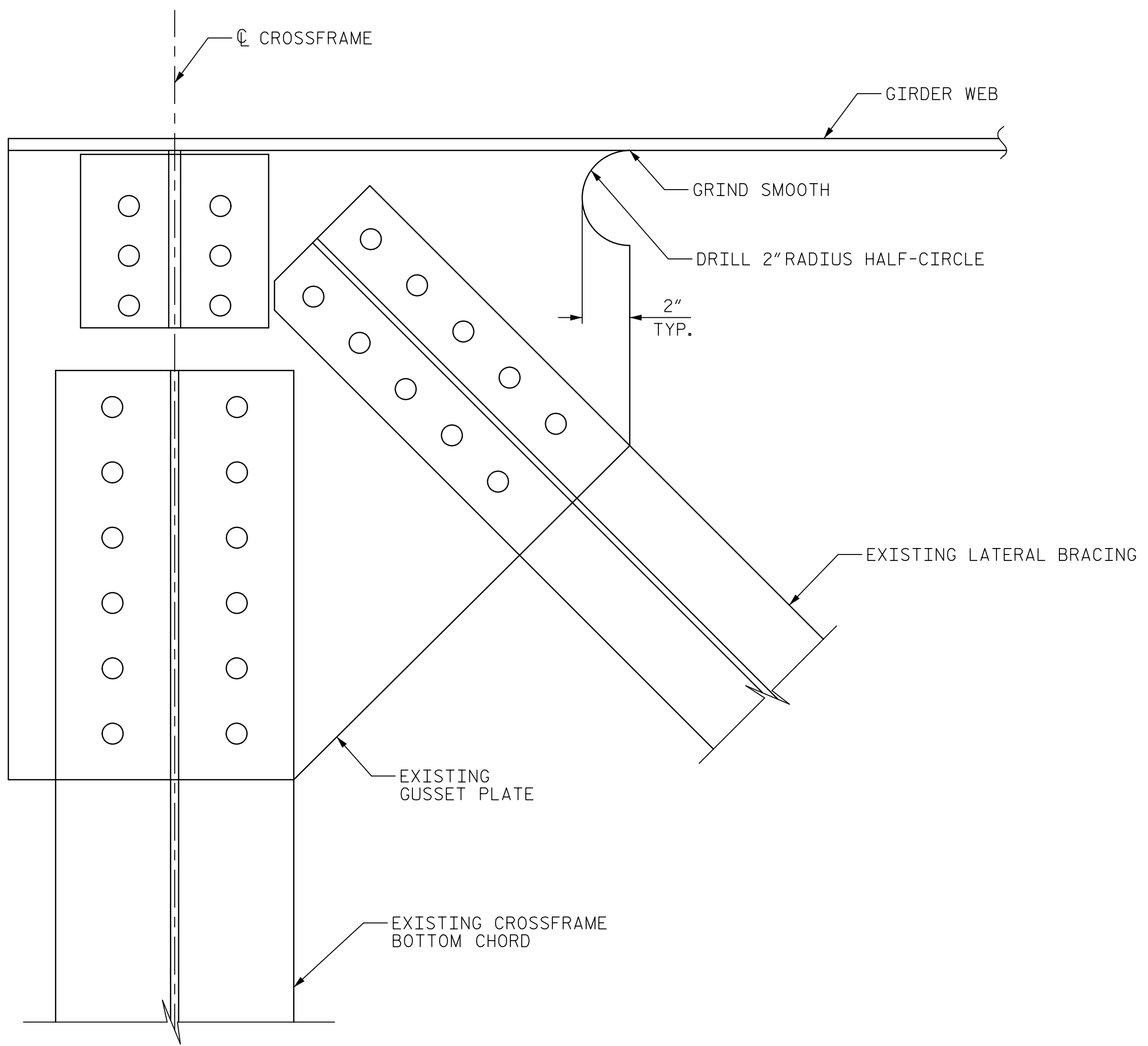

PLAN VIEW OF GUSSET PLATE RETROFIT

AT CROSSFRAMES A1, A5, 1, 37, E1 AND E5

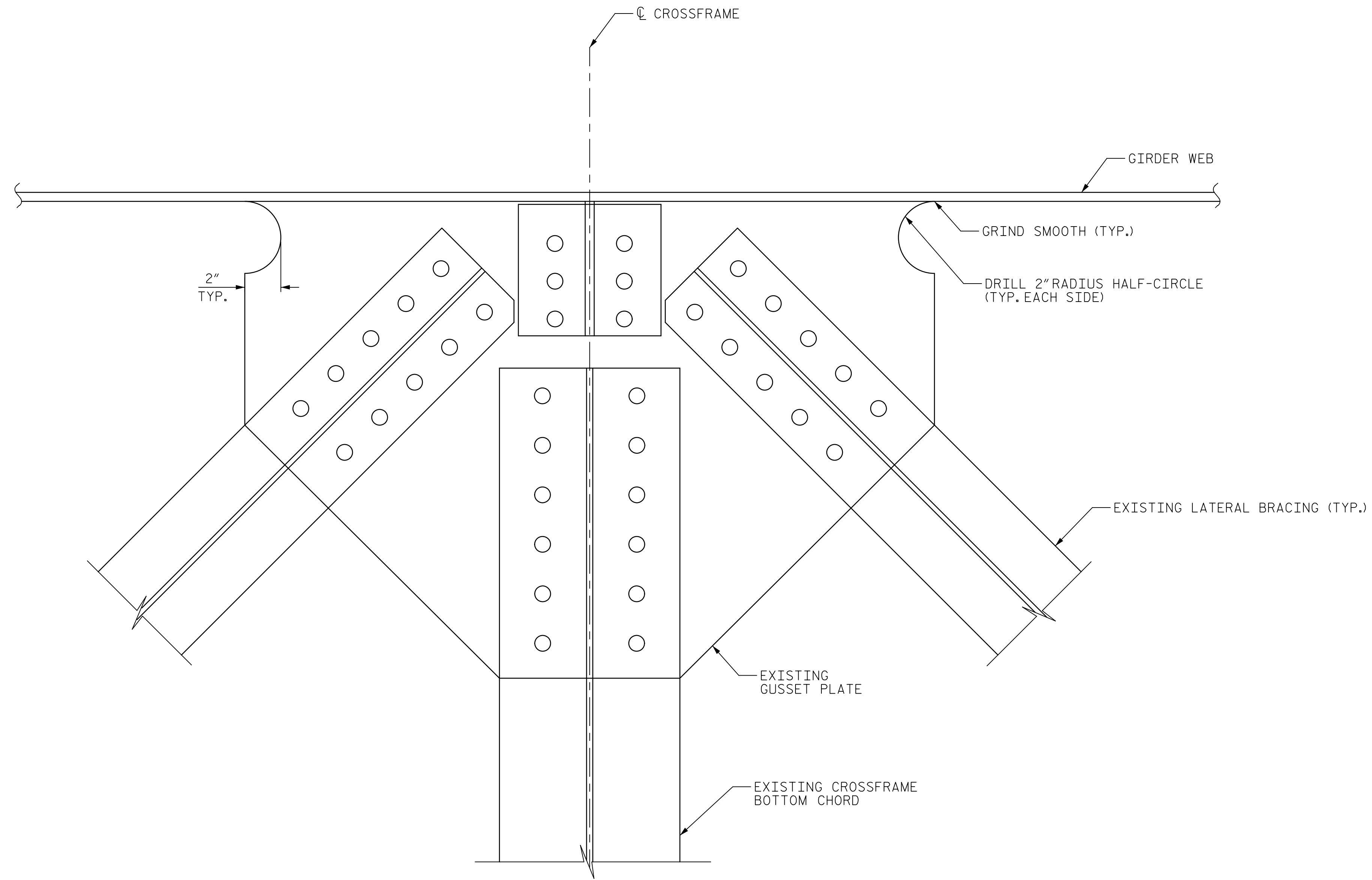

PLAN VIEW OF GUSSET PLATE RETROFIT

AT CROSSFRAMES A2-A4, 2-36 AND E2-E4

NOTES:

- DRILL HALF-CIRCLES TO PERFORM RETROFIT AT ALL GUSSET PLATES ON THE BRIDGE, SPANS A THRU E AND GIRDERS 1 THRU 4. DO NOT SAW CUT, PLASMA CUT, OR FLAME CUT HALF-CIRCLES.
- THE RADIUS OF CURVATURE OF THE HALF-CIRCLE SHALL BE TANGENTIAL TO THE FACE OF THE GIRDER WEB AND TERMINATE FLUSH WITH THE WEB.
- GRIND WELDS, GIRDER WEBS, AND GUSSET PLATES SMOOTH IN THE VICINITY OF THE RETROFIT AND AT THE TERMINATION OF THE RADIUS. GRIND THE HALF-CIRCLE SMOOTH OF JAGGED EDGES.
- COMPLETE GUSSET PLATE RETROFIT AT ALL FOUR GIRDERS PRIOR TO POURING THE STAGE I DECK. COMPLETE GUSSET PLATE RETROFIT PRIOR TO PAINTING OR COATING THE GUSSET PLATE.

CONTRACTOR SHALL BE PAID AS A LUMP SUM UNDER THE PAY ITEM "GUSSET PLATE RETROFIT."

FOR ADDITIONAL REQUIREMENTS, SEE SPECIAL PROVISIONS.

DRAWN BY : M. CATER	DATE : 10/2019
CHECKED BY : J. SLOAN	DATE : 10/2019
DESIGNED BY : E. ZHOU	DATE : 10/2019
DESIGN CHECKED BY : J. SLOAN	DATE : 10/2019

PROJECT NO. 15BPR.20
HENDERSON COUNTY
 STATION: 35+30.22 -L-

SHEET 10 OF 14



STATE OF NORTH CAROLINA
 DEPARTMENT OF TRANSPORTATION
 RALEIGH
 REHABILITATION
GUSSET PLATE RETROFIT

DOCUMENT NOT CONSIDERED
 FINAL UNLESS ALL
 SIGNATURES COMPLETED

REVISIONS						SHEET NO.
NO.	BY:	DATE:	NO.	BY:	DATE:	S-90
1			3			TOTAL SHEETS
2			4			129

USER: Arch/Resourced/Drawings/01_165_16BPR20_SML_S10.dgn