

NOTES:

FOR HOLE REPAIRS, SEE SPECIAL PROVISIONS.

FOR PAY ITEMS, SEE SHEET 14 OF 14.

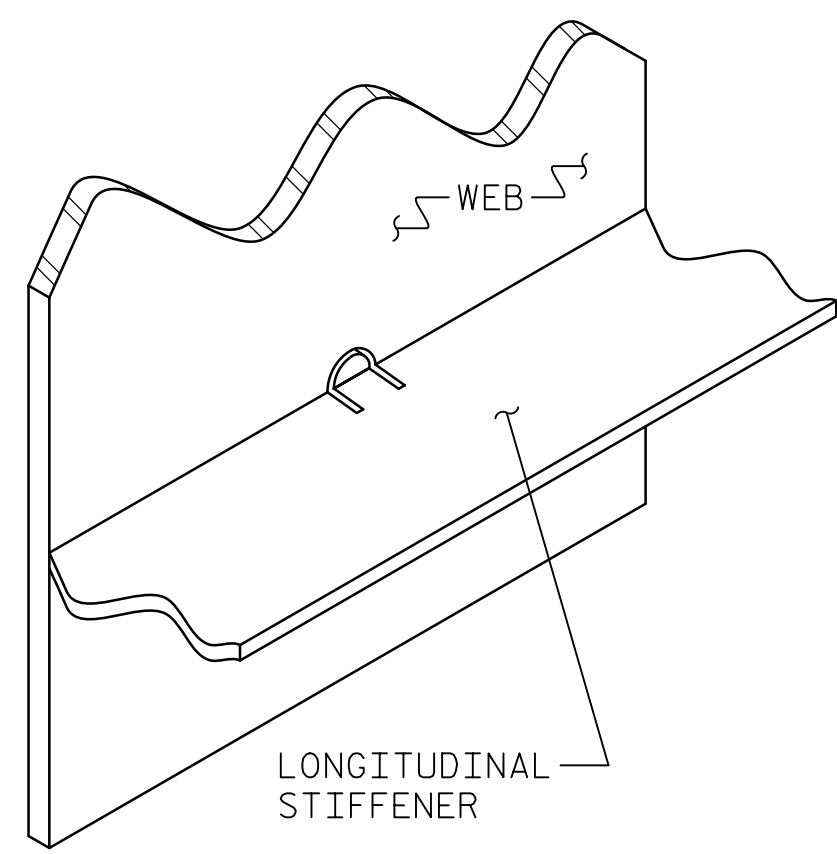

EXISTING HOLE

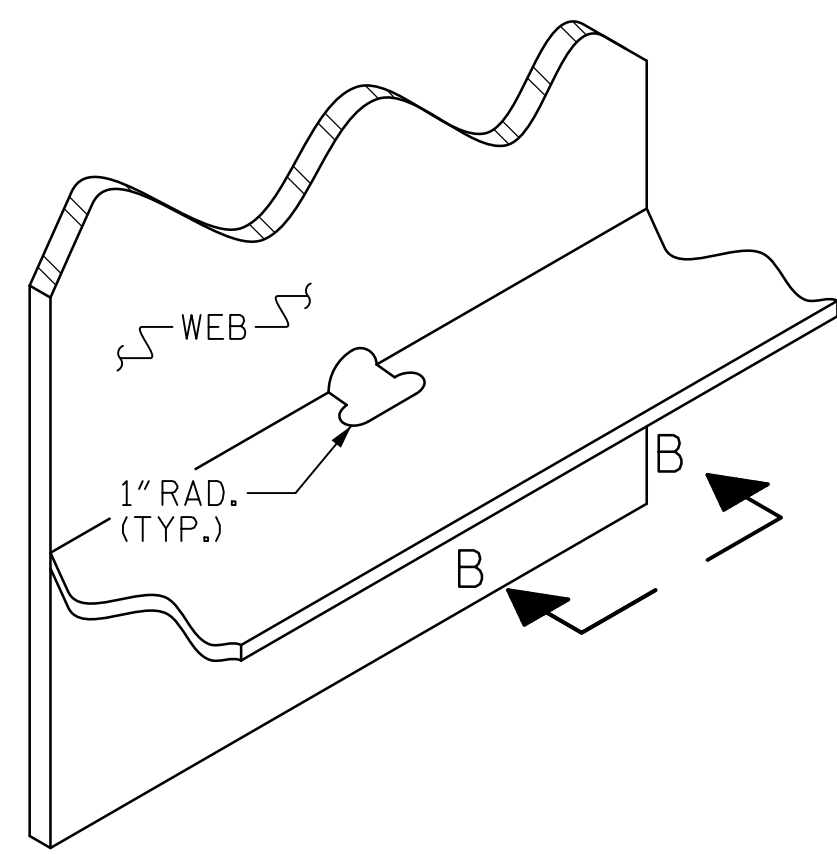

REPAIR

ISOMETRIC VIEW

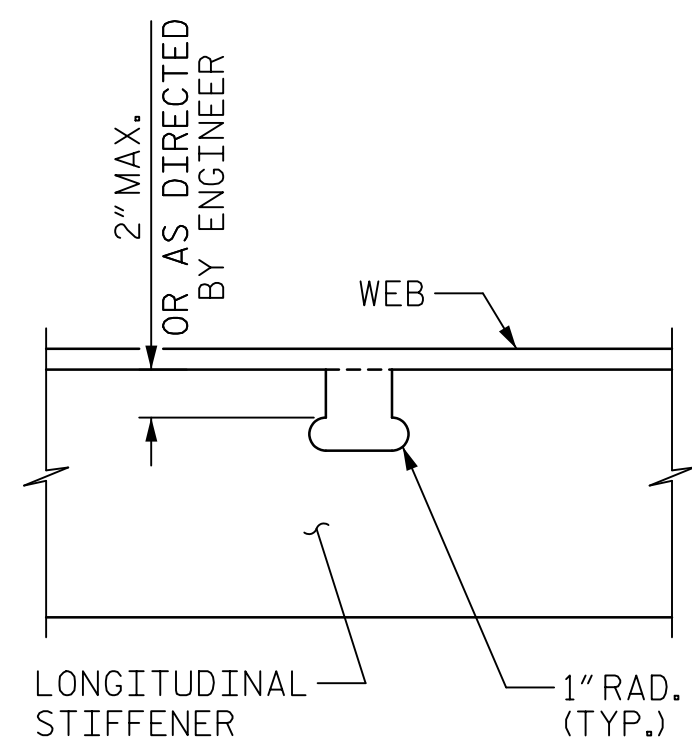

PLAN

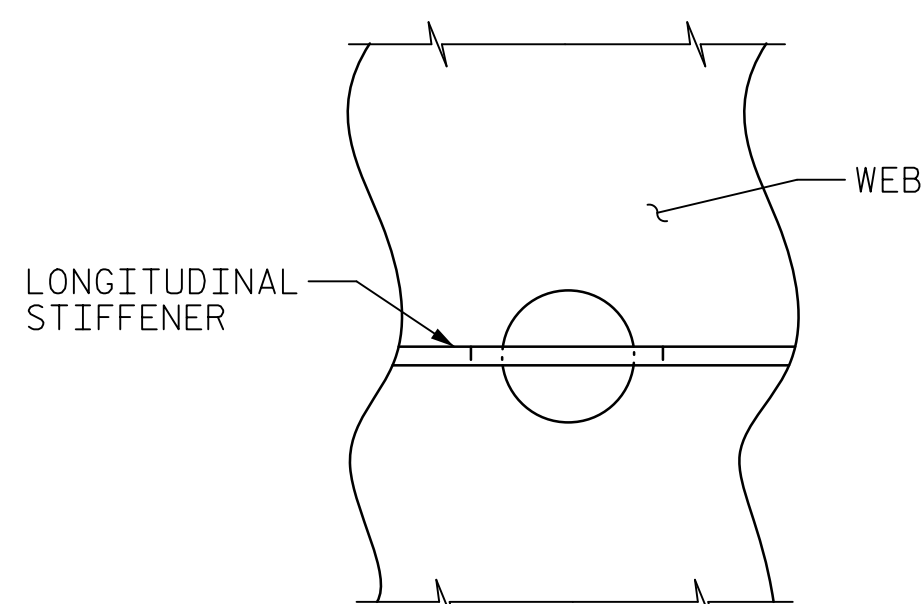

VIEW B-B

HOLE REPAIRS TYPE I

FOR REPRESENTATION ONLY, REPAIR SHALL BE PERFORMED AT EACH LOCATION NOTED, FOR REPAIR LOCATIONS, SEE PHOTO LEGEND ON SHEET 7.

REPAIR PROCEDURE

1. DRILL 1" RADIUS HOLES AT THE TERMINATION OF THE EXISTING CUTS IN THE LONGITUDINAL STIFFENER.
2. SAW CUT BETWEEN HOLES TANGENTIAL TO THE RADIUS OF THE HOLE.
3. GRIND SMOOTH ADJACENT AREAS OF THE WEB, LONGITUDINAL STIFFENER, AND WELDS.

HR-I-1



HR-I-5



HR-I-2



HR-I-6



HR-I-3



HR-I-7



HR-I-4



PROJECT NO. 15BPR.20

HENDERSON COUNTY

STATION: 35+30.22 -L-

SHEET 6 OF 14

AECOM
AECOM TECHNICAL SERVICES OF NC, INC.
701 CORPORATE CENTER DRIVE, SUITE 475
RALEIGH, NC 27607
(919) 854-6200 www.aecom.com
AECOM License No. F-0342

STATE OF NORTH CAROLINA
Professional Engineer
JOHN E. SLOAN
035062
2/28/2020

STATE OF NORTH CAROLINA
DEPARTMENT OF TRANSPORTATION
RALEIGH

REHABILITATION

STRUCTURAL STEEL
REPAIRS

REVISIONS

NO.	BY:	DATE:	NO.	BY:	DATE:
1			3		
2			4		

SHEET NO.

S-86

TOTAL SHEETS

129

DOCUMENT NOT CONSIDERED
FINAL UNLESS ALL
SIGNATURES COMPLETED

DATE: 2/28/2020
TIME: 10:24:49 AM

USER: MerchAssessm... Drawings\401_159_15BPR20_SML_SReg.dgn

DRAWN BY : M. TOM DATE : 2/2019
CHECKED BY : G. COLS DATE : 2/2019
DESIGNED BY : J. SLOAN DATE : 2/2019
DESIGN CHECKED BY : E. ZHOU DATE : 2/2019