

* WEB GAP DETAIL, SEE "WEB GAP RETROFIT DETAILS" SHEETS.

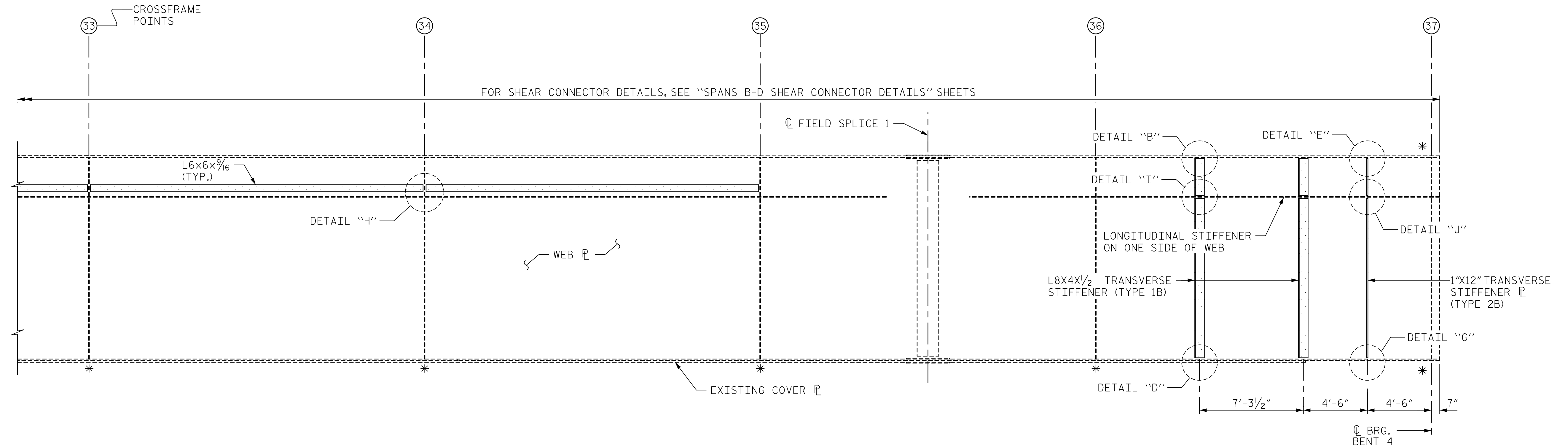

PARTIAL SPAN D

GIRDERS 2 & 4 NORTH FACE SHOWN.
GIRDERS 1 & 3 SOUTH FACE SIMILAR (MIRRORED).

NOTES:

FOR DETAILS "B", "D", AND "I" SHOWING TYPE 1 TRANSVERSE STIFFENERS, SEE TYPE 1 TRANSVERSE STIFFENER SHEET.

FOR DETAILS "E", "J", AND "G" SHOWING TYPE 1 TRANSVERSE STIFFENERS, SEE TYPE 1 TRANSVERSE STIFFENER SHEET.

FOR DETAIL "H", SEE SHEET 2 OF 11.

PROJECT NO. 15BPR.20
HENDERSON COUNTY
STATION: 35+30.22 -L-

SHEET 10 OF 11

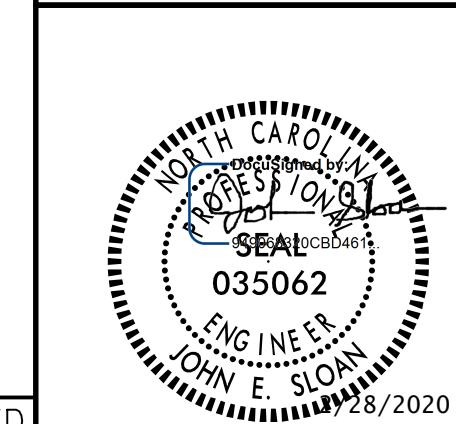

STATE OF NORTH CAROLINA
DEPARTMENT OF TRANSPORTATION
RALEIGH

SUPERSTRUCTURE

PARTIAL SPAN D
GIRDER ELEVATION

REVISIONS

NO.	BY:	DATE:	NO.	BY:	DATE:
1			3		
2			4		

SHEET NO.
S-60
TOTAL SHEETS
129

DOCUMENT NOT CONSIDERED
FINAL UNLESS ALL
SIGNATURES COMPLETED

DRAWN BY : M.K. TOM	DATE : 1/2019
CHECKED BY : J.E. SLOAN	DATE : 2/2019
DESIGNED BY : N. BROWN/D. TUTTLE	DATE : 2/2019
DESIGN CHECKED BY : J. SLOAN/J. LIU	DATE : 2/2019

DATE: 2/27/2020
TIME: 3:27:45 PM

USER: NorthCarolina\jls_15BPR.20_SML_GCD.dgn
DGN: R:\Structures\04 Drawings\01\15BPR.20_SML_GCD.dgn