

5/14/99

PROJECT REFERENCE NO.	SHEET NO.
15BPR.20	EC-05/CONST.05
RW SHEET NO.	

Prepared in the Office of: **AECOM** NC FIRM LICENSE No. F-0342
701 Corporate Center Drive, Suite 415
Raleigh, NC 27607
(919) 854-6200 • (919) 854-6259(FAX)

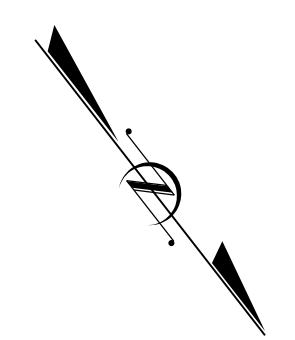
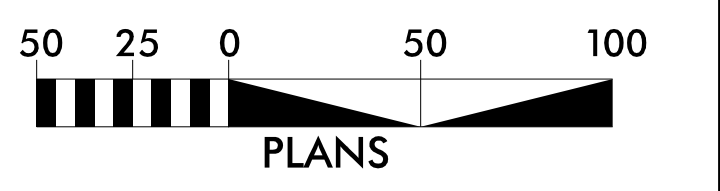

Curve EBLI	Curve -L-I	Curve WBLI
PI = 106+99.65	PI = 17+03.83	PI = 207+08.01
DELTA = 34° 24' 12.03" (LT)	DELTA = 34° 24' 12.03" (LT)	DELTA = 34° 24' 12.03" (LT)
D = 2' 59' 23"	D = 2' 58' 07"	D = 2' 56' 53"
T = 593.32'	T = 597.50'	T = 601.68'
L = 1150.77'	L = 1158.87'	L = 1166.98'
R = 1916.50'	R = 1930.00'	R = 1943.50'
PC = 101+06.34	PC = 11+06.34	PC = 201+06.34
PT = 112+57.10	PT = 22+65.21	PT = 212+73.31
V = 60 MPH	V = 60 MPH	V = 60 MPH

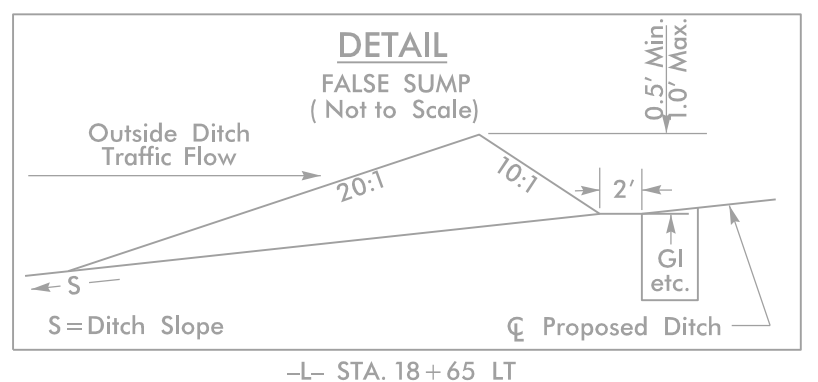
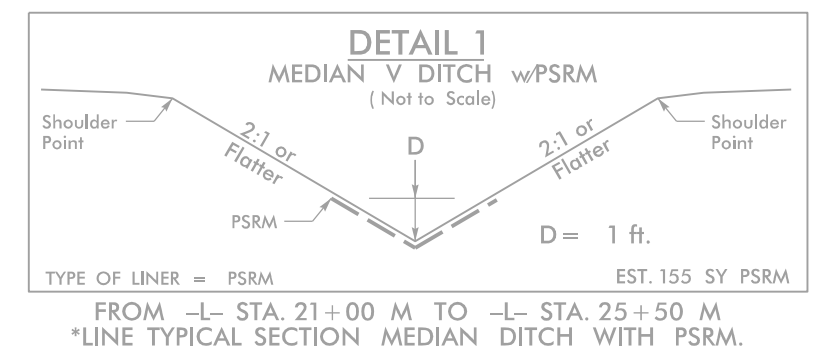

NOTE:
PLACE TEMPORARY ROCK SEDIMENT DAMS TYPE - B AND TEMPORARY ROCK SILT CHECKS TYPE - A AT DRAINAGE OUTLETS.

Utilize Fabric Insert Inlet Protection Devices in Lieu of Rock Inlet Sediment Traps, Type -C as Directed to Avoid Impoundment of Runoff in Roadway Open to Traffic.

CLEARING AND GRUBBING EROSION CONTROL FOR CONSTRUCTION SHEET 5

REQUEST VIDEO OF PIPES PROPOSED TO RETAIN AS NOTED, CHECK FOR STRUCTURAL INTEGRITY.

DRAINAGE INLET SPACING AND CONFIGURATION IS INTENDED TO SUPPORT 4 LANE SECTION. ADDITIONAL INLETS WILL BE REQUIRED FOR FUTURE EXPANSION TO 6 LANE SECTION.

NOTE: PROPOSED BOXES MAY REQUIRE TEMPORARY STEEL PLATE COVERS DURING PHASING OPERATIONS

MATCHLINE - SEE SHEET EC-04
EBL STA 107+50
WBL STA 207+50
-L- STA 17+45.53

MATCHLINE - SEE SHEET EC-06
EBL STA 119+50
WBL STA 219+50

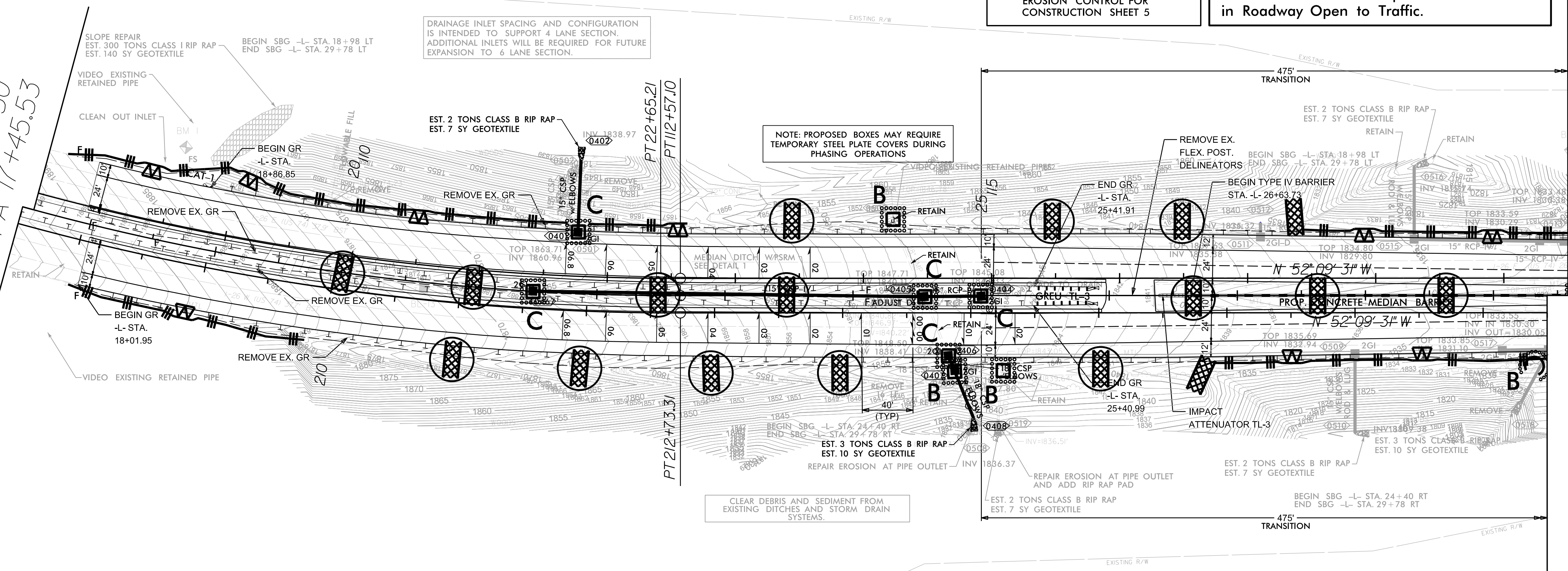

R:\Environ\on\design\15bpr\20_reu_EC05.dgn
11:47:36 AM
5/14/99

FOR EBL PROFILE SEE SHEET 7
FOR WBL PROFILE SEE SHEET 7