

PROJECT REFERENCE NO. 15BPR.20	SHEET NO. 6
ROADWAY DESIGN ENGINEER <i>Glenn Edens</i> 18470	HYDRAULICS ENGINEER <i>M. D. Buscemi</i> 037863
Prepared in the Office of: AECOM NC FIRM LICENSE No: F-0542 701 Corporate Center Drive, Suite 475 Raleigh, NC 27603 (919) 854-6200 / (919) 854-6299 (FAX)	
DOCUMENT NOT CONSIDERED FINAL UNLESS ALL SIGNATURES COMPLETED	

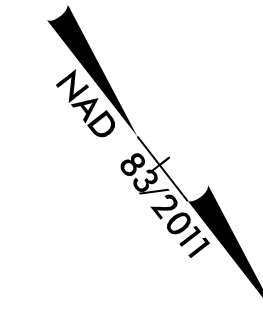

MATCHLINE - SEE SHEET 5
 EBL STA 119+50
 WBL STA 219+50
 -L- STA 29+58.11

MATCHLINE - SEE SHEET 7
 EBL STA 131+50
 WBL STA 231+50
 -L- STA 41+58.11

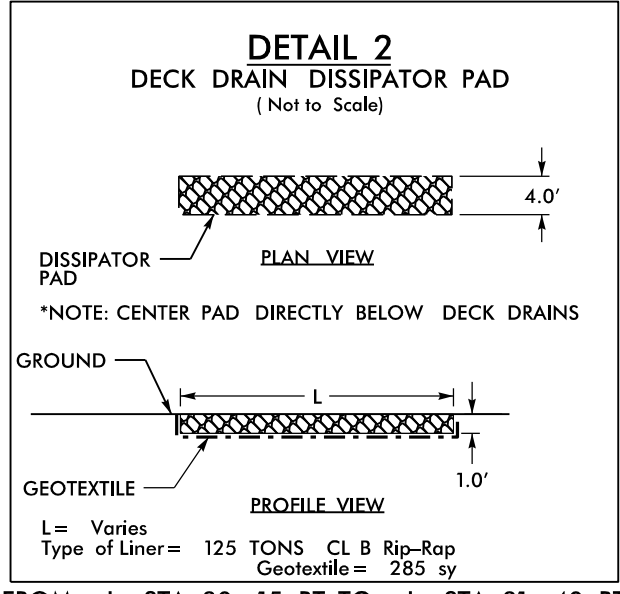
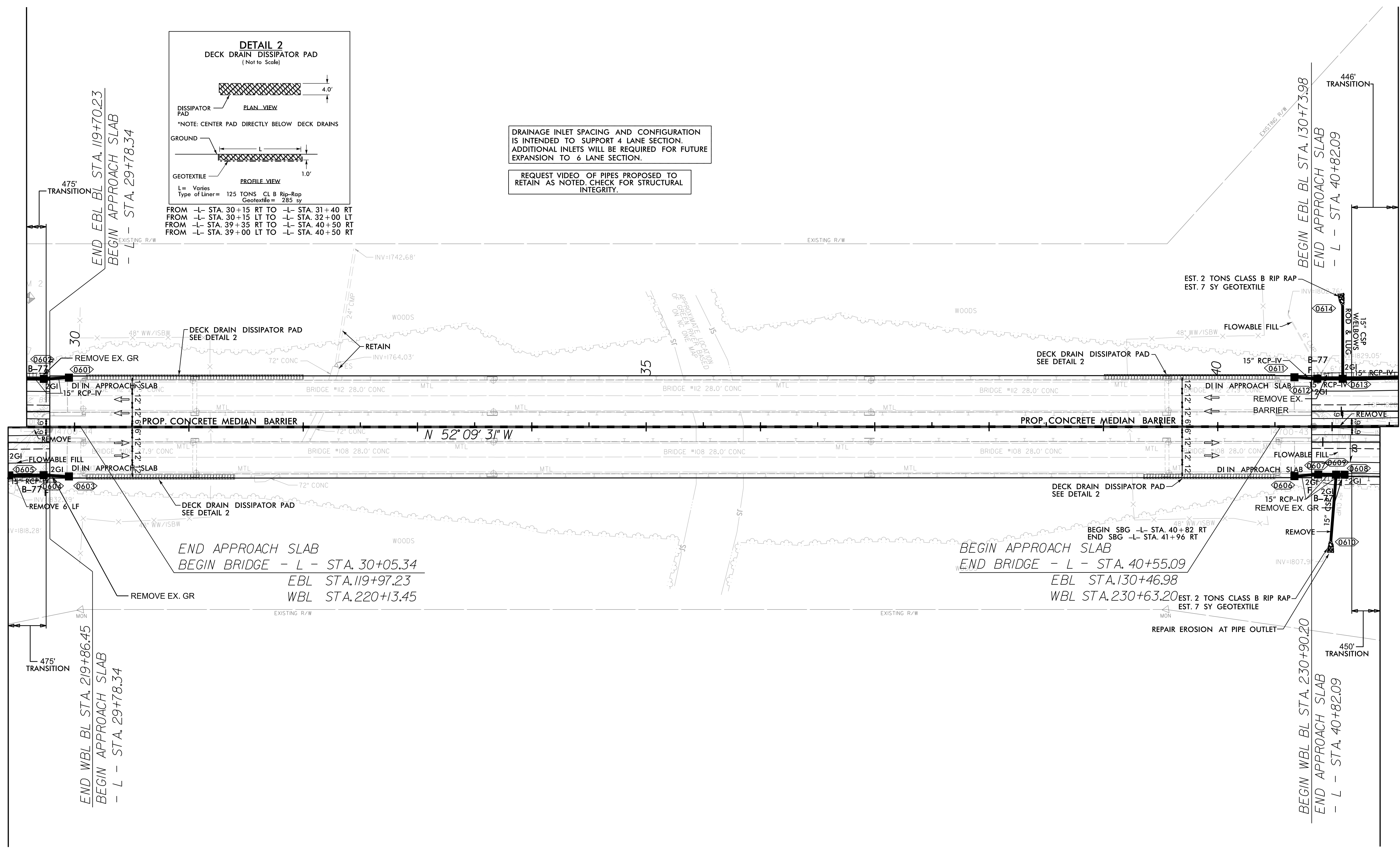

DRAINAGE INLET SPACING AND CONFIGURATION IS INTENDED TO SUPPORT 4 LANE SECTION. ADDITIONAL INLETS WILL BE REQUIRED FOR FUTURE EXPANSION TO 6 LANE SECTION.

REQUEST VIDEO OF PIPES PROPOSED TO RETAIN AS NOTED. CHECK FOR STRUCTURAL INTEGRITY.

FOR EBL PROFILE SEE SHEET 9
 FOR -L- PROFILE SEE SHEET 9
 FOR WBL PROFILE SEE SHEET 9
 FOR BRIDGE PLANS SEE STRUCTURAL DRAWINGS S-1 THRU S-123