

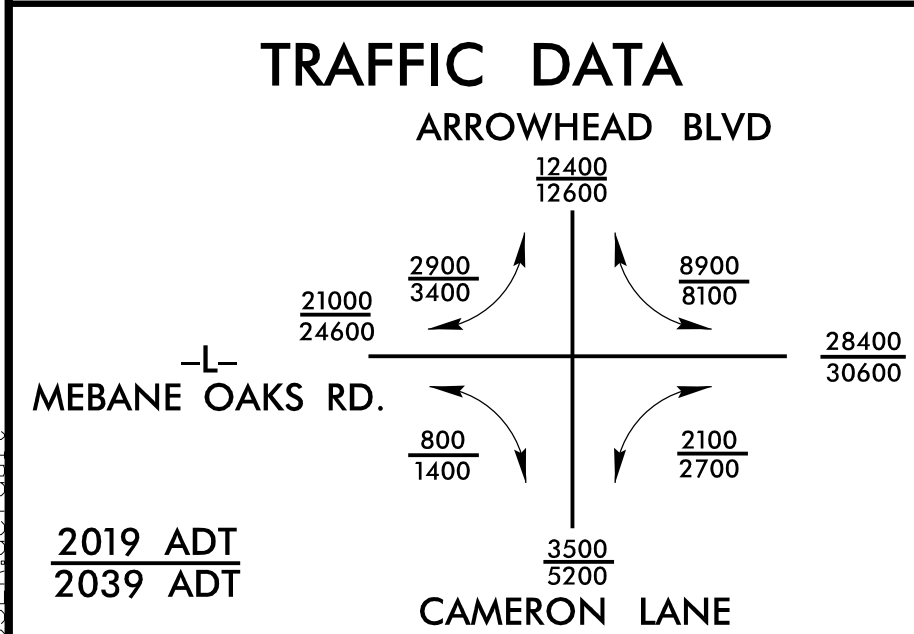

PROJECT REFERENCE NO. I-5711		SHEET NO. EC-09/CONST.04	
RW SHEET NO.		HYDRAULICS ENGINEER	
ROADWAY DESIGN ENGINEER		HYDRAULICS ENGINEER	

NOTE: UTILIZE FABRIC INSERT INLET PROTECTION DEVICES IN LIEU OF ROCK INLET SEDIMENT TRAPS, TYPE C TO AVOID IMPOUNDMENT OF WATER IN ROADWAY OPEN TO TRAFFIC

-L-
PI Sta 19+55.91
 $\Delta = 5' 55" 08.8" (LT)$
 $D = 1' 29' 59.6"$
 $L = 394.64'$
 $T = 197.49'$
 $R = 3,820.00'$
 $e = 3\% (Exist)$
 $R.O. = 265' (53' Inc)$

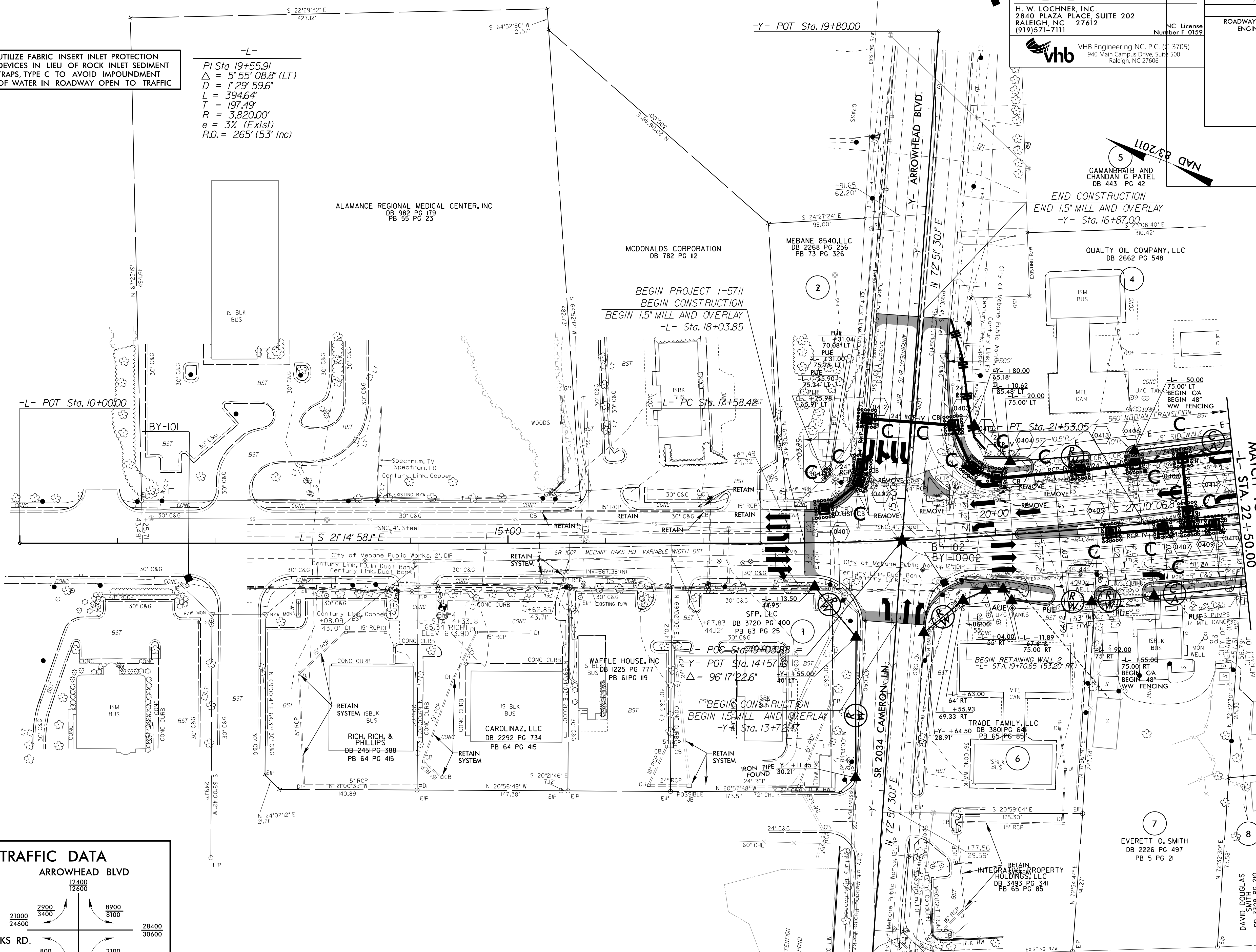

★ TRAFFIC SIGNAL

NOTE: ALL DRIVE RADII ARE 10' UNLESS OTHERWISE NOTED.