

5/14/2021

# INTERSECTION DETAIL -L- SR 1007 (MEBANE OAKS RD), -Y4- (WALMART ENTRANCE) AND WILSON ROAD CONNECTOR

PROJECT REFERENCE NO. 1-5711	SHEET NO. 2B-5
RW SHEET NO.	
ROADWAY DESIGN ENGINEER 2/9/2021	

**DOCUMENT NOT CONSIDERED FINAL  
UNLESS ALL SIGNATURES COMPLETED**

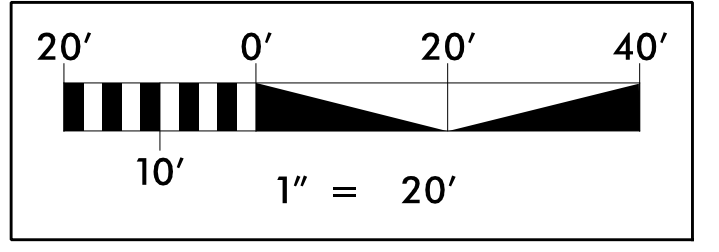
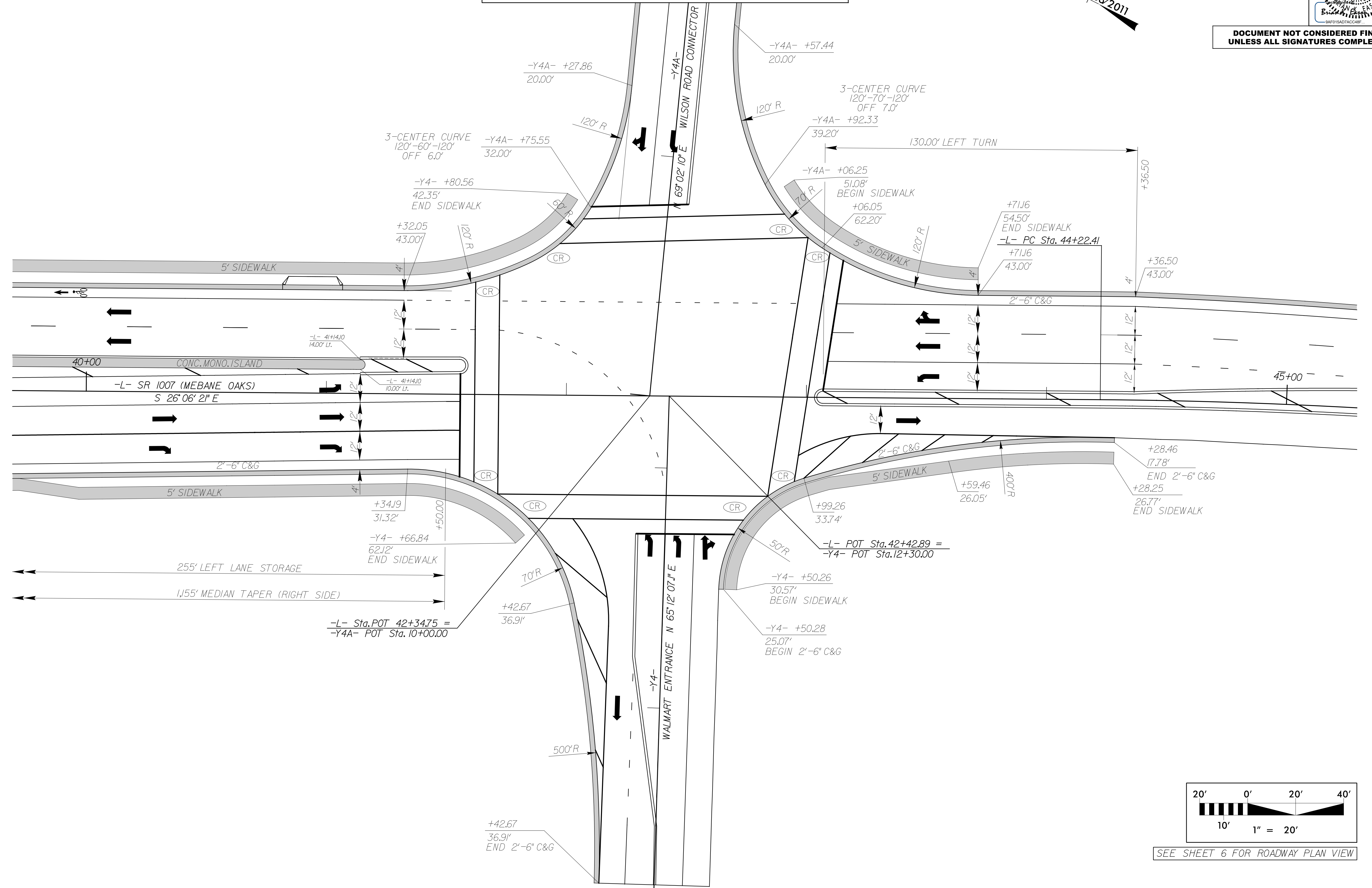
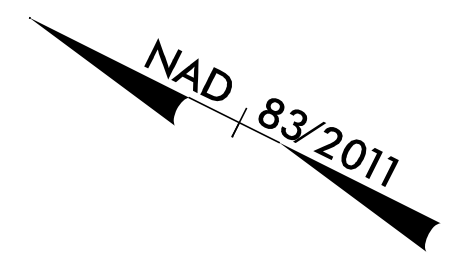

SEE SHEET 6 FOR ROADWAY PLAN VIEW

12/19/2020 RDPY\_DET\_02B-5.dgn  
RKH/PH