

UTILITIES BY OTHERS

NOTE:
 ALL UTILITY WORK SHOWN ON THIS SHEET WILL BE DONE BY OTHERS. NO PAYMENT WILL BE MADE TO THE CONTRACTOR FOR UTILITY WORK SHOWN ON THIS SHEET.

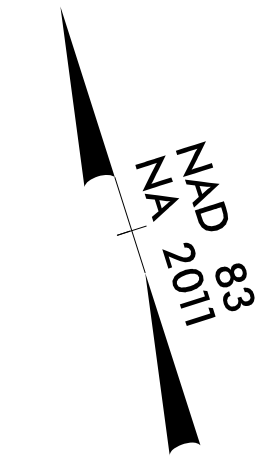

6
 M. KEITH BUTNER
 DB 2829 PG 2942
 DB 2829 PG 2936

7
 STEPHEN A HUBBARD
 SUSAN K HUBBARD
 DB 1822 PG 2457

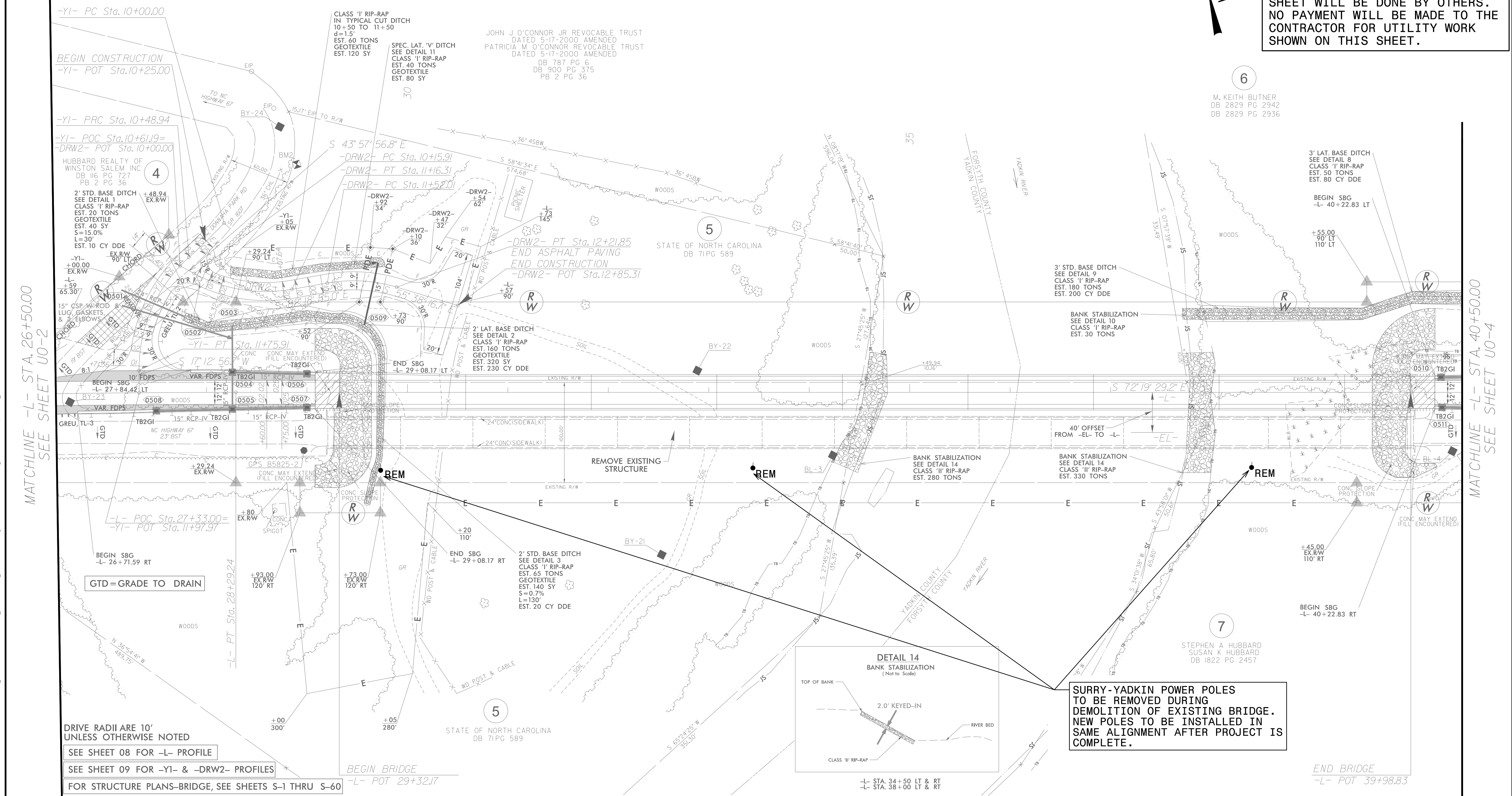

24 MAY 2010 11:24 C:\PROJECTS\2010\A20108000\00_TCS-B-5825\Design\Utilities\Engineering\UBO\Proj\B-5825_Ut_rdy05_U003_psh.dgn

DRIVE RADII ARE 10'
 UNLESS OTHERWISE NOTED
 SEE SHEET 08 FOR -L- PROFILE
 SEE SHEET 09 FOR -YI- & -DRW2- PROFILES
 FOR STRUCTURE PLANS-BRIDGE, SEE SHEETS S-1 THRU S-60

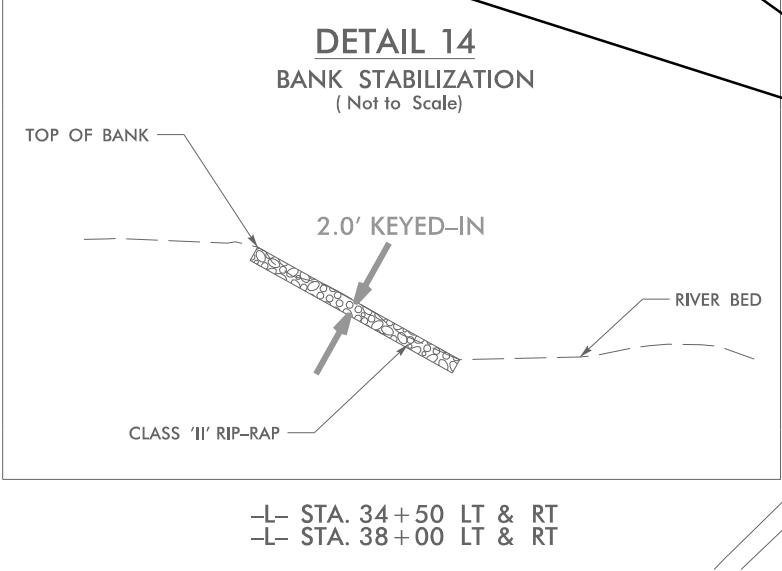

SURRY-YADKIN POWER POLES TO BE REMOVED DURING DEMOLITION OF EXISTING BRIDGE. NEW POLES TO BE INSTALLED IN SAME ALIGNMENT AFTER PROJECT IS COMPLETE.

UBO PLANS ARE FOR INFORMATION ONLY AND ARE NOT TO BE USED FOR CONSTRUCTION. ALL PROPOSED RELOCATION INFORMATION SHOWN ON THE UBO PLANS WAS PROVIDED BY 3RD PARTIES. HINDE ENGINEERING, INC. ASSUMES NO RESPONSIBILITY OR LIABILITY FOR THE ACCURACY OR VALIDITY OF 3RD PARTY INFORMATION PROVIDED.

