

PROJECT REFERENCE NO. B-5825	SHEET NO. 06
ROADWAY DESIGN ENGINEER MARCUS LOWERY SEAL 027418	HYDRAULICS ENGINEER BENJAMIN HENCHIR SEAL 044158
4/8/2020 1:04 PM EDT	4/8/2020 10:04 AM PDT
DOCUMENT NOT CONSIDERED FINAL UNLESS ALL SIGNATURES COMPLETED	
TGS ENGINEERS 706 HILLSBOROUGH ST., SUITE 200 RALEIGH, NC 27603 PH (919) 773-8887 CORP. LICENSE NO.: C-0275	

END TIP PROJECT B-5825
-L- POC Sta. 54+00.00

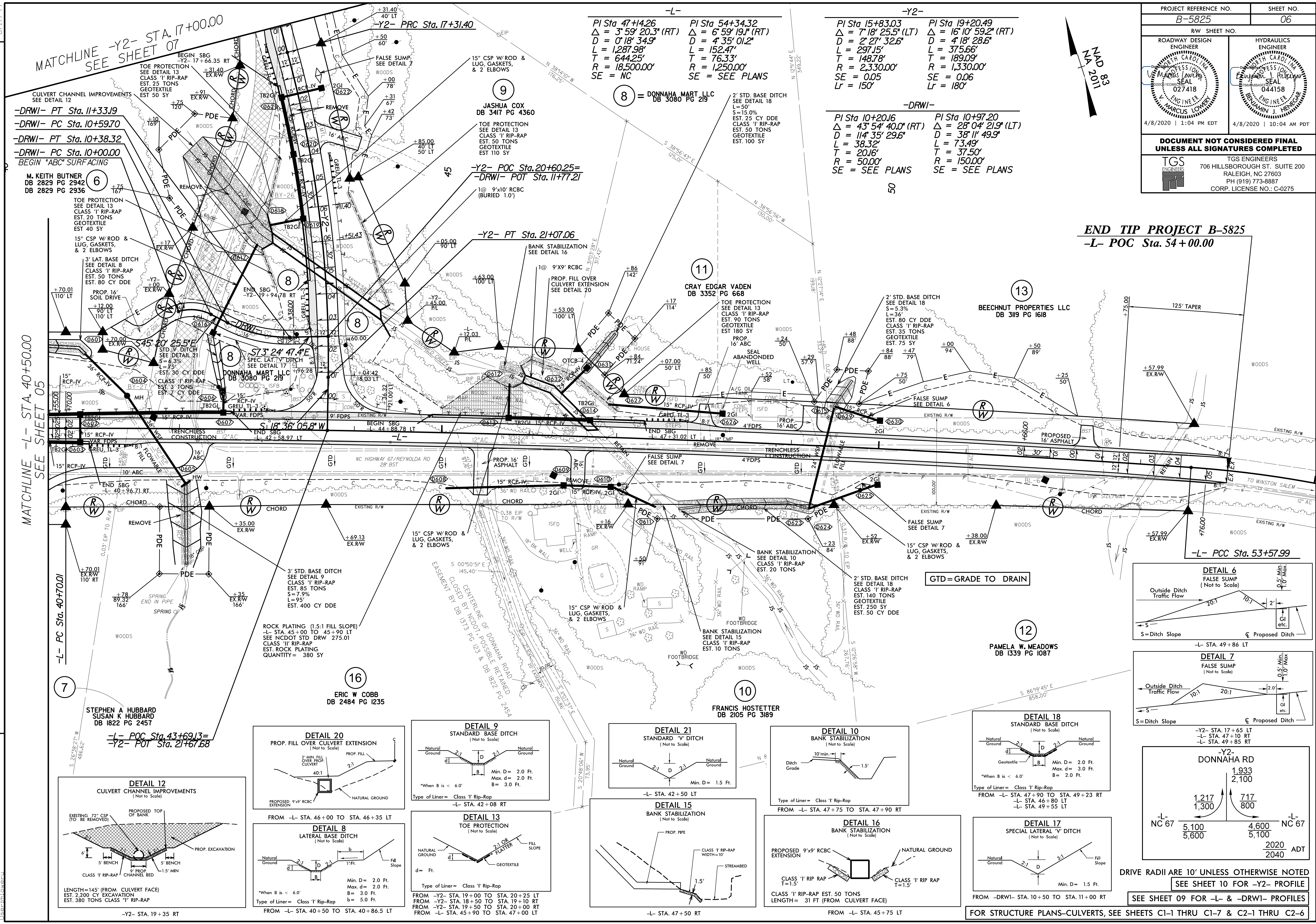

MATCHLINE -L- STA. 40+50.00
SEE SHEET 05

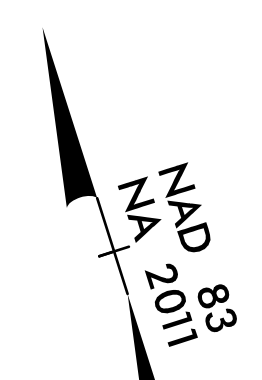

PI Sta 47+14.26 $\Delta = 3' 59' 20.3''$ (RT) $D = 0' 18' 34.9''$ $L = 1,287.98'$ $T = 644.25'$ $R = 18,500.00'$ SE = NC	PI Sta 54+34.32 $\Delta = 6' 59' 19.2''$ (RT) $D = 4' 35' 01.2''$ $L = 152.47'$ $T = 76.33'$ $R = 1,250.00'$ SE = SEE PLANS	PI Sta 15+83.03 $\Delta = 7' 18' 25.5''$ (LT) $D = 2' 27' 32.6''$ $L = 297.15'$ $T = 148.78'$ $R = 2,330.00'$ SE = 0.05	PI Sta 19+20.49 $\Delta = 16' 10' 59.2''$ (RT) $D = 4' 18' 28.6''$ $L = 375.66'$ $T = 189.09'$ $R = 1,330.00'$ SE = 0.06
PI Sta 10+20.16 $\Delta = 43' 54' 40.0''$ (RT) $D = 114' 35' 29.6''$ $L = 38.32'$ $T = 20.16'$ $R = 50.00'$ SE = SEE PLANS		PI Sta 10+97.20 $\Delta = 28' 04' 21.9''$ (LT) $D = 38' 11' 49.9''$ $L = 73.49'$ $T = 37.50'$ $R = 150.00'$ SE = SEE PLANS	

-DRWI- PT Sta. 11+33.19
-DRWI- PC Sta. 10+59.70
-DRWI- PT Sta. 10+38.32
-DRWI- PC Sta. 10+00.00
BEGIN "ABC" SURFACING

M. KEITH BUTNER
DB 2829 PG 2942
DB 2829 PG 2936

TOE PROTECTION
SEE DETAIL 13
CLASS '1' RIP-RAP
EST. 20 TONS
GEOTEXTILE
EST. 40 SY

15" CSP W/ROD & LUG, GASKETS, & 2 ELBOWS

3' LAT. BASE DITCH
SEE DETAIL 8
CLASS '1' RIP-RAP
EST. 50 TONS
DDE
EST. 80 CY DDE

PROP. 16" SOIL DRIVE
EST. 12.00
90' LT
110' LT

15" RCP-IV
EST. 12.00
90' LT
110' LT

15" RCP-IV
EST. 12.00
90' LT
110' LT

15" RCP-IV
EST. 12.00
90' LT
110' LT

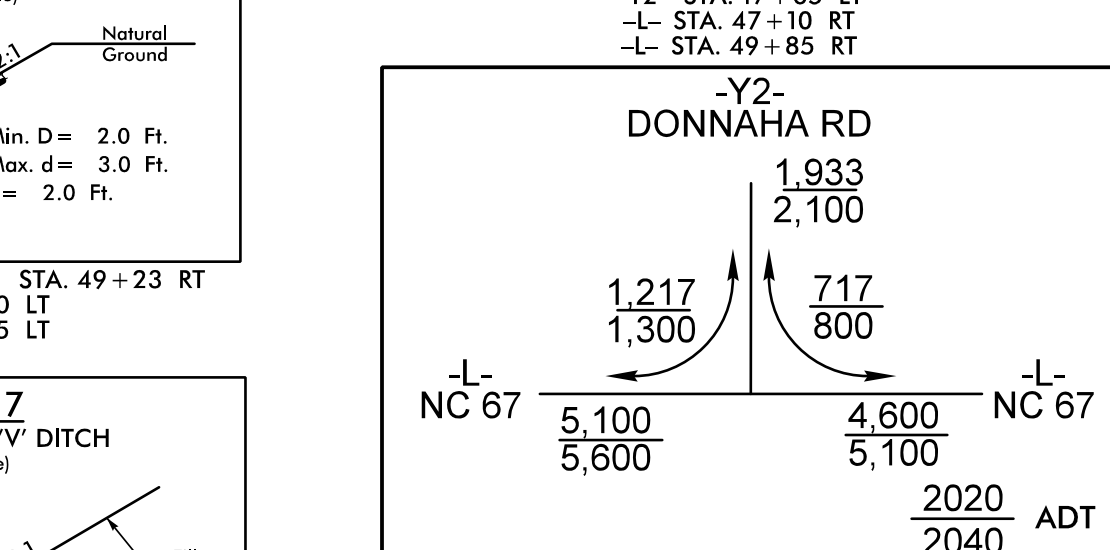
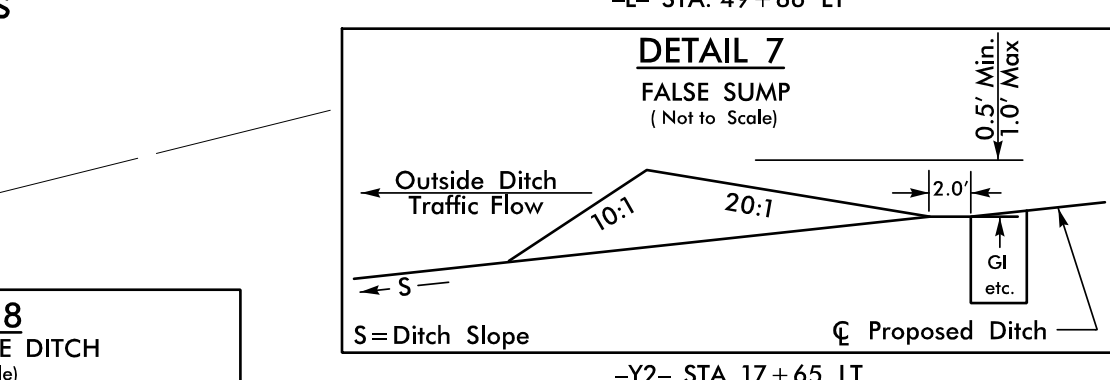
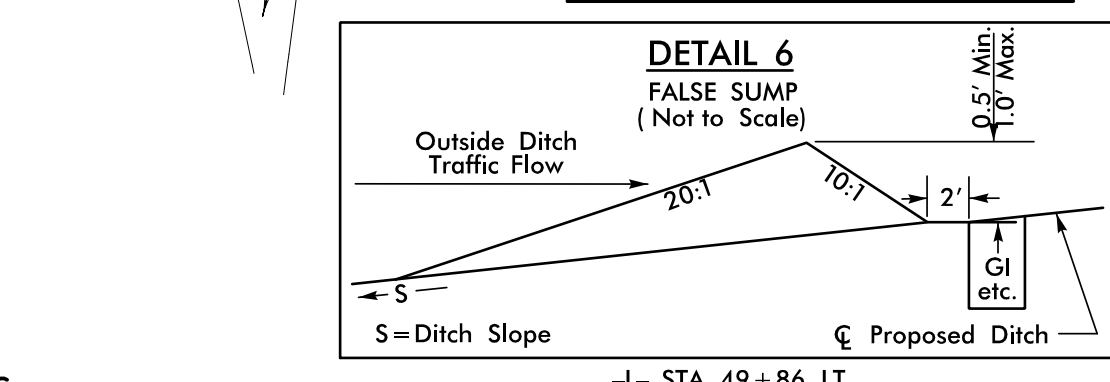
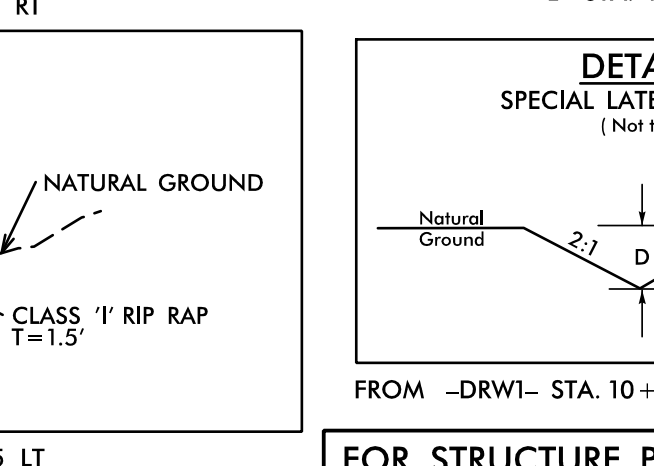
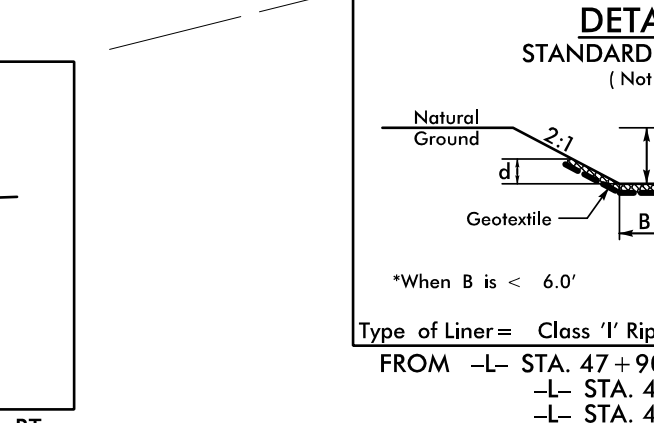
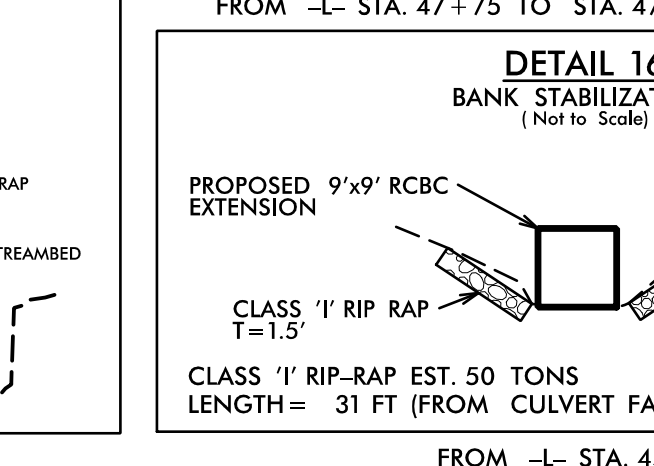
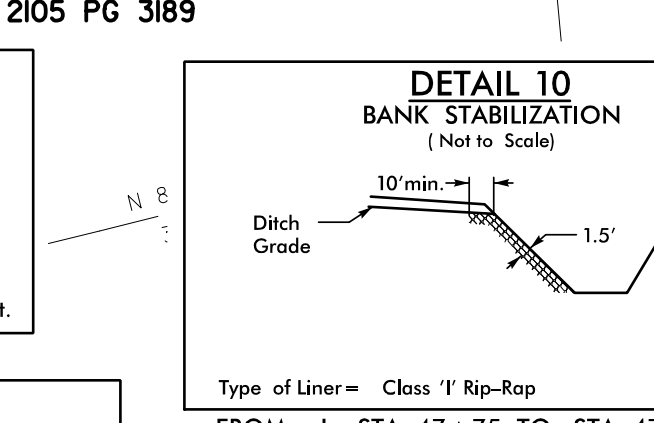
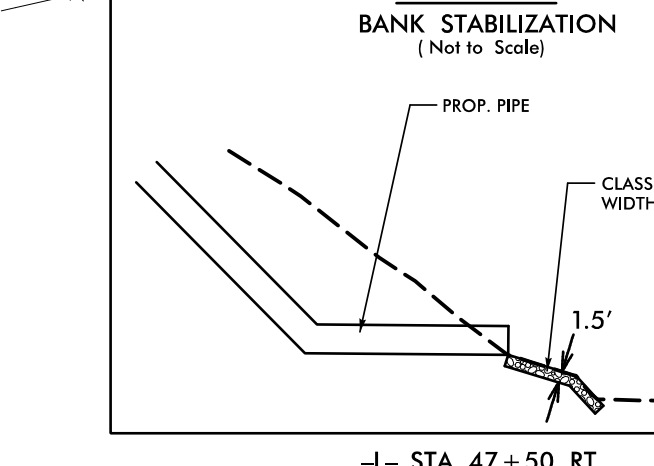
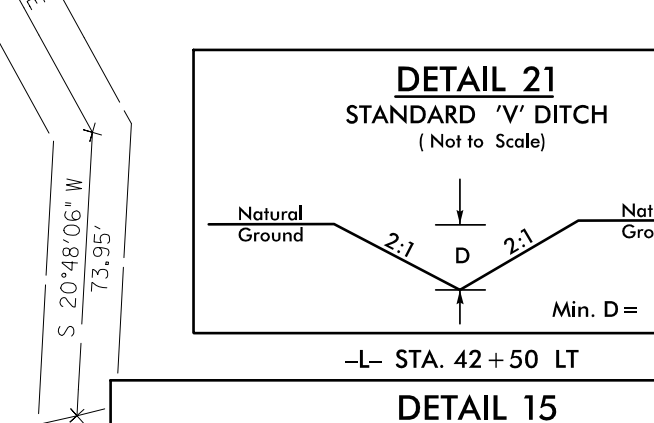
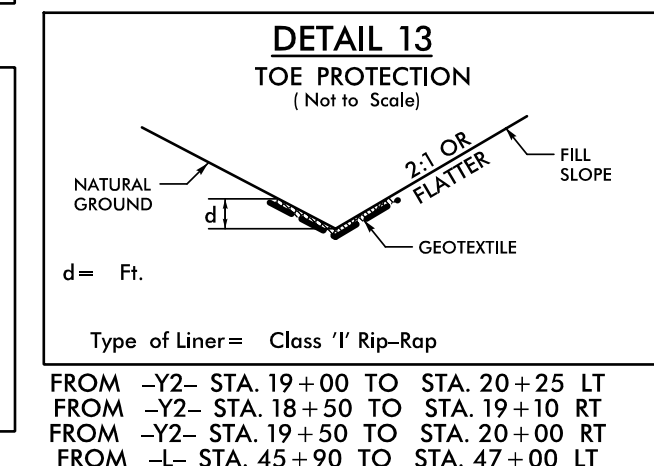
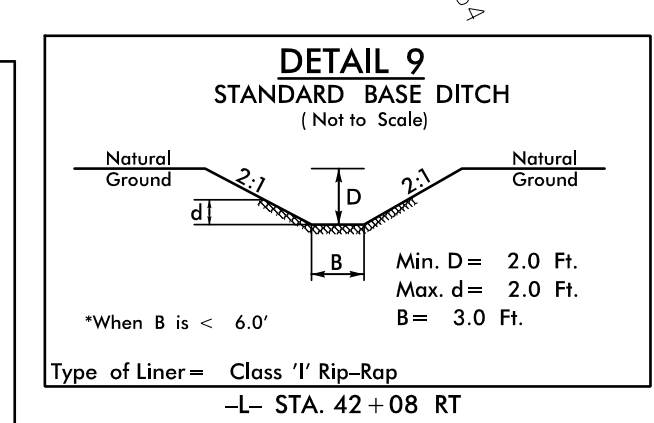
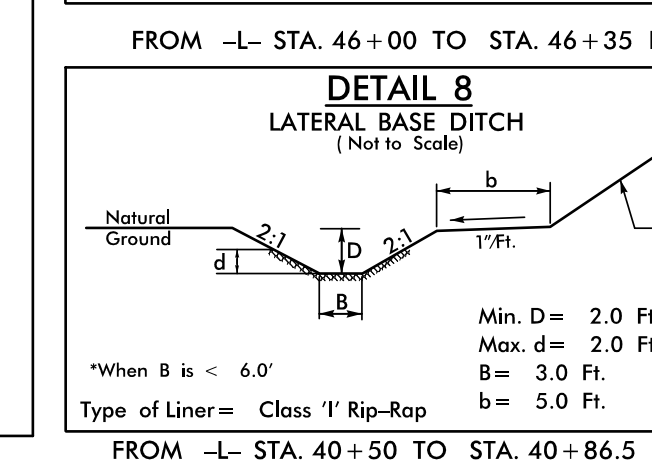
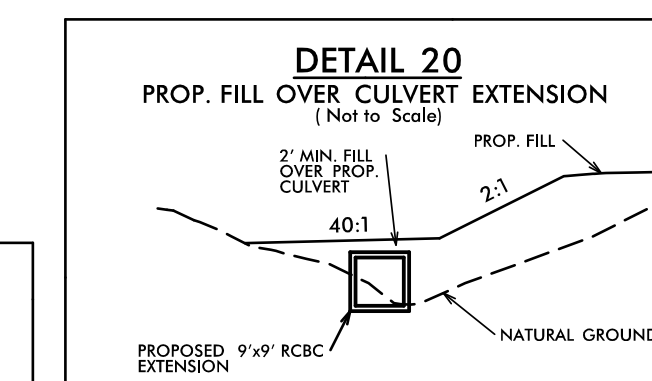

DRIVE RADII ARE 10' UNLESS OTHERWISE NOTED
SEE SHEET 10 FOR -Y2- PROFILE
SEE SHEET 09 FOR -L- & -DRWI- PROFILES
FOR STRUCTURE PLANS-CULVERTS, SEE SHEETS C1-1 THRU C1-7 & C2-1 THRU C2-6

LENGTH=145' (FROM CULVERT FACE)
EST. 2,200 CY EXCAVATION
EST. 380 TONS CLASS "1" RIP-RAP

-Y2- STA. 19+35 RT

-L- POC Sta. 43+69.13 =
-Y2- POT Sta. 21+67.68

-L- STA. 49+86 LT

-L- STA. 49+85 RT

-L- STA. 49+55 LT

-L- STA. 47+90 RT

-L- STA. 46+80 LT

-L- STA. 49+55 LT

-L- STA. 49+86 LT

-L- STA. 49+85 RT

-L- STA. 49+55 LT

-L- STA. 47+90 RT

-L- STA. 46+80 LT

-L- STA. 49+55 LT

-L- STA. 49+86 LT

-L- STA. 49+85 RT

-L- STA. 49+55 LT

-L- STA. 47+90 RT

-L- STA. 46+80 LT

-L- STA. 49+55 LT

-L- STA. 49+86 LT

-L- STA. 49+85 RT

-L- STA. 49+55 LT

-L- STA. 47+90 RT

-L- STA. 46+80 LT

-L- STA. 49+55 LT

-L- STA. 49+86 LT

-L- STA. 49+85 RT

-L- STA. 49+55 LT

-L- STA. 47+90 RT

-L- STA. 46+80 LT

-L- STA. 49+55 LT

-L- STA. 49+86 LT

-L- STA. 49+85 RT

-L- STA. 49+55 LT

-L- STA. 47+90 RT

-L- STA. 46+80 LT

-L- STA. 49+55 LT

-L- STA. 49+86 LT

-L- STA. 49+85 RT

-L- STA. 49+55 LT

-L- STA. 47+90 RT

-L- STA. 46+80 LT

-L- STA. 49+55 LT

-L- STA. 49+86 LT

-L- STA. 49+85 RT

-L- STA. 49+55 LT

-L- STA. 47+90 RT

-L- STA. 46+80 LT

-L- STA. 49+55 LT

-L- STA. 49+86 LT

-L- STA. 49+85 RT

-L- STA. 49+55 LT

-L- STA. 47+90 RT

-L- STA. 46+80 LT

-L- STA. 49+55 LT

-L- STA. 49+86 LT

-L- STA. 49+85 RT

-L- STA. 49+55 LT

-L- STA. 47+90 RT

-L- STA. 46+80 LT

-L- STA. 49+55 LT

-L- STA. 49+86 LT

-L- STA. 49+85 RT

-L- STA. 49+55 LT

-L- STA. 47+90 RT

-L- STA. 46+80 LT

-L- STA. 49+55 LT

-L- STA. 49+86 LT

-L- STA. 49+85 RT

-L- STA. 49+55 LT

-L- STA. 47+90 RT

-L- STA. 46+80 LT

-L- STA. 49+55 LT

-L- STA. 49+86 LT

-L- STA. 49+85 RT

-L- STA. 49+55 LT

-L- STA. 47+90 RT

-L- STA. 46+80 LT

-L- STA. 49+55 LT

-L- STA. 49+86 LT

-L- STA. 49+85 RT

-L- STA. 49+55 LT

-L- STA. 47+90 RT

-L- STA. 46+80 LT

-L- STA. 49+55 LT

-L- STA. 49+86 LT

-L- STA. 49+85 RT

-L- STA. 49+55 LT

-L- STA. 47+90 RT

-L- STA. 46+80 LT

-L- STA. 49+55 LT

-L- STA. 49+86 LT

-L- STA. 49+85 RT

-L- STA. 49+55 LT

-L- STA. 47+90 RT

-L- STA. 46+80 LT

-L- STA. 49+55 LT

-L- STA. 49+86 LT

-L- STA. 49+85 RT

-L- STA. 49+55 LT

-L- STA. 47+90 RT

-L- STA. 46+80 LT

-L- STA. 49+55 LT

-L- STA. 49+86 LT

-L- STA. 49+85 RT

-L- STA. 49+55 LT

-L- STA. 47+90 RT

-L- STA. 46+80 LT

-L- STA. 49+55 LT

-L- STA. 49+86 LT

-L- STA. 49+85 RT

-L- STA. 49+55 LT

-L- STA. 47+90 RT

-L- STA. 46+80 LT

-L- STA. 49+55 LT

-L- STA. 49+86 LT

-L- STA. 49+85 RT

-L- STA. 49+55 LT

-L- STA. 47+90 RT

-L- STA. 46+80 LT

-L- STA. 49+55 LT

-L- STA. 49+86 LT

-L- STA. 49+85 RT

-L- STA. 49+55 LT

-L- STA. 47+90 RT

-L- STA. 46+80 LT

-L- STA. 49+55 LT

-L- STA. 49+86 LT

-L- STA. 49+85 RT

-L- STA. 49+55 LT

-L- STA. 47+90 RT

-L- STA. 46+80 LT

-L- STA. 49+55 LT

-L- STA. 49+86 LT

-L- STA. 49+85 RT

-L- STA. 49+55 LT

-L- STA. 47+90 RT

-L- STA. 46+80 LT

-L- STA. 49+55 LT

-L- STA. 49+86 LT

-L- STA. 49+85 RT

-L- STA. 49+55 LT

-L- STA. 47+90 RT

-L- STA. 46+80 LT

-L- STA. 49+55 LT

-L- STA. 49+86 LT

-L- STA. 49+85 RT

-L- STA. 49+55 LT

-L- STA. 47+90 RT

-L- STA. 46+80 LT

-L- STA. 49+55 LT

-L- STA. 49+86 LT

-L- STA. 49+85 RT

-L- STA. 49+55 LT

-L- STA.