

PROJECT REFERENCE NO. B-5825		SHEET NO. 04	
RW SHEET NO.			
ROADWAY DESIGN ENGINEER MARCUS LOVERE 027418 6/4/2020 10:23 AM EDT		HYDRAULICS ENGINEER MARCUS LOVERE 044158 6/4/2020 7:58 AM PDT	
DOCUMENT NOT CONSIDERED FINAL UNLESS ALL SIGNATURES COMPLETED			
TGS ENGINEERS 706 HILLSBOROUGH ST. SUITE 200 RALEIGH, NC 27603 PH (919) 773-8887 CORP. LICENSE NO.: C-0275			

-L-

PI Sta 17+89.96 Δ = 3° 18' 30.4" (LT) D = 0° 28' 38.9" L = 692.92' T = 346.55' R = 12,000.00' SE = NC	PI Sta 24+82.87 Δ = 3° 18' 30.4" (RT) D = 0° 28' 38.9" L = 692.92' T = 346.55' R = 12,000.00' SE = NC
---	---

BEGIN TIP PROJECT B-5825
-L- POT Sta. 14+00.00

1A
DONNA B LOVE
DB 547 PG 148
PB 2 PG 36
-L- PRC Sta. 21+36.32

4
HUBBARD REALTY OF WINSTON SALEM INC
DB 116 PG 727
PB 2 PG 36

1
DONNA B LOVE
DB 547 PG 148
PB 2 PG 36

5
STATE OF NORTH CAROLINA
DB 71PG 589

2
ALTON GEORGE
DB 1155 PG 72

3
G & E WHITE LLC
DB 1242 PG 494

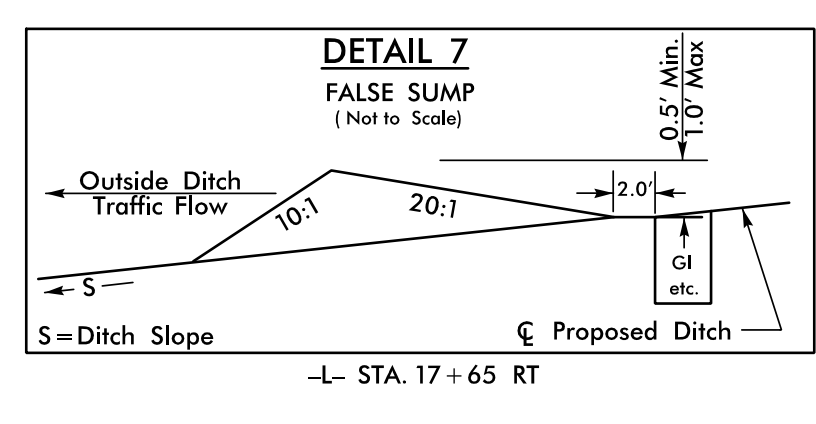
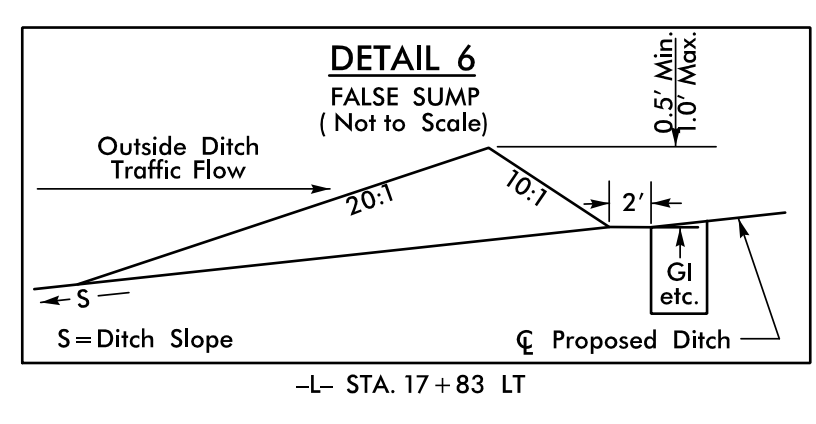
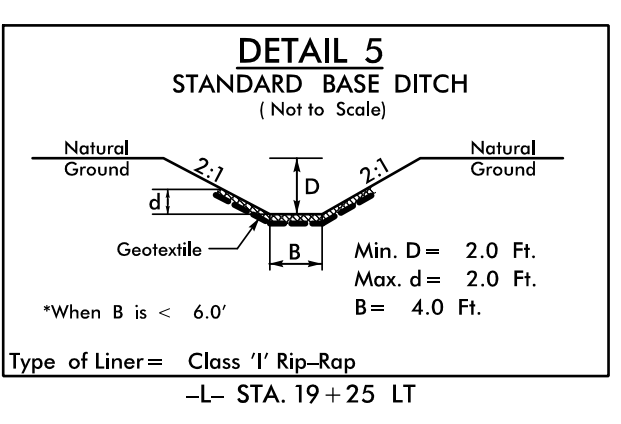
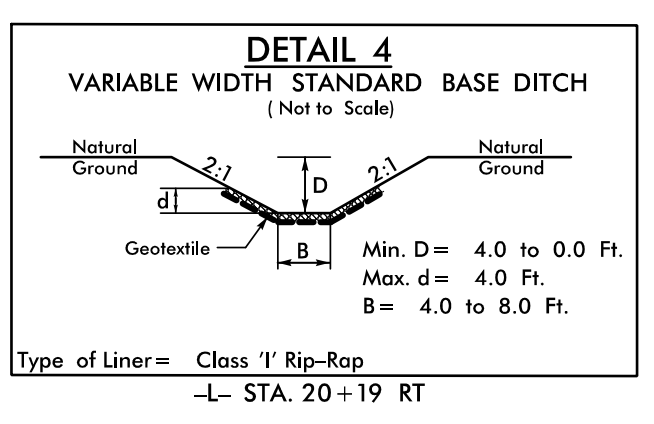
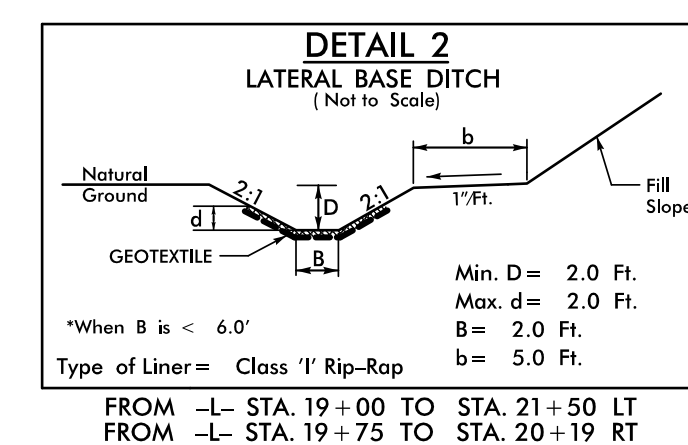
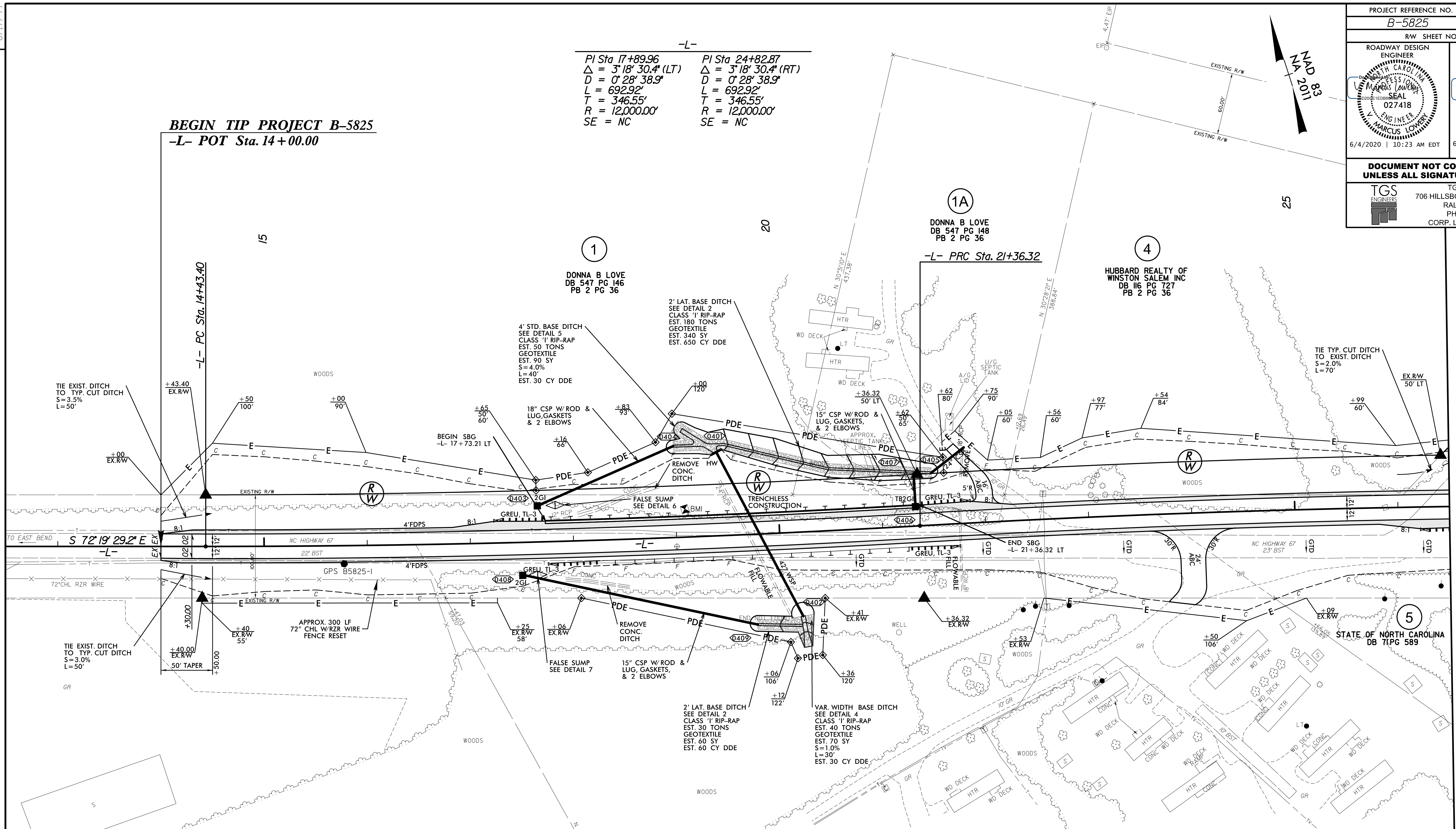

DRIVE RADII ARE 10' UNLESS OTHERWISE NOTED

SEE SHEET 08 FOR -L- PROFILE

MATCHLINE -L- STA. 26+50.00
SEE SHEET 05

REVISIONS

6/17/19

6/4/2020 B:\5825\Roadway\Proj\B5825_rdy\esh_14.dgn
M:\Users\mlovere\OneDrive\Documents\B5825\Roadway\Proj\B5825_rdy\esh_14.dgn